

- 5 Attached
- 8 Attached
- 4 Attached
- 2 Press fitting
- 3 Solder cup inside dia. (φ0.8)
- 3 Press fitting
- 1 Attached
- 7 Attached
- 6 Attached

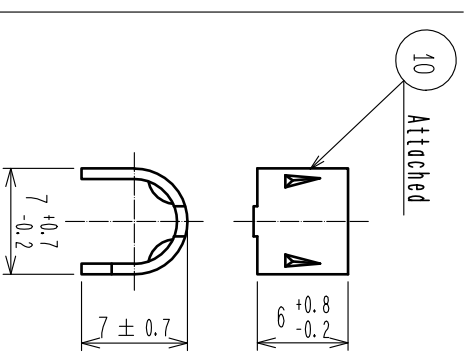

The contact arrangements from the mating face

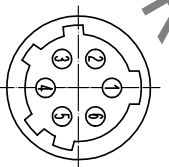

M1.5X0.75

Notes

- 1 The recommended clamp torque of ref.No.⑤ : 1.5~2N·m.
- 2 The recommended clamp torque of ref.No.⑨ : 0.1~0.15N·m.
- 3 Apply Loctite 243, HENKEL JAPAN or equivalent to the threaded portion of ref.No.① and ② in order to prevent loosening.
- 4 Rotation examples of ref. No. ① and ⑤ are shown.
- 5 Applicable tools
- 6 Claiming tool for ref.No.⑩: SR30-10PF-T(C/L450-0001-8-00)
- 7 Soldering and fastening tool:SR30-10P-104(C/L450-0004-6-00)
- 8 The cable pull and twisting strength and other characteristics may differ,depending on the cable structure,please confirm before the use. Also, please confirm the workability in advance, as it may be tight when passing the cable through the port No.⑩ bushing.

⑩ Attached

NO.	MATERIAL	FINISH . REMARKS	NO.	MATERIAL	FINISH . REMARKS
5	CR	(Black)	10	Brass	
4	Brass	Nickel plating	8	Steel	Chrome treatment (Trivalent chrome)
3	Polyacetal	(White)	7	Brass	Nickel plating
2	Brass	Silver plating 3μm min.	6	Brass	Nickel plating
1	Zinc alloy	Nickel plating			

UNITS	SCALE	COUNT	DESCRIPTION OF REVISIONS	DESIGNED	CHECKED	DATE
mm	2 : 1					

APPROVED	CHECKED	DESIGNED	DRAWN	DRAWING NO.	PART NO.	CODE NO.
TP. KOMATSU	HY. KOBAYASHI	HY. KISHI	KR. SUZUKI	20221201	SR30-10PF-6P(32)	CL0103-0319-0-32