

REVISION RECORD				
REV	ECO	DESCRIPTION	DRFT	CHKD

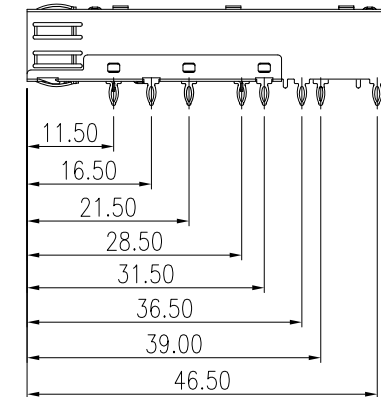
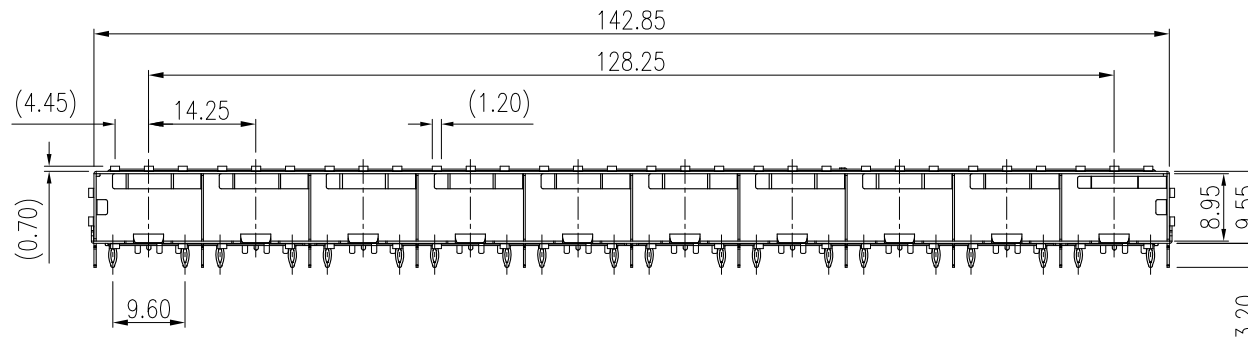
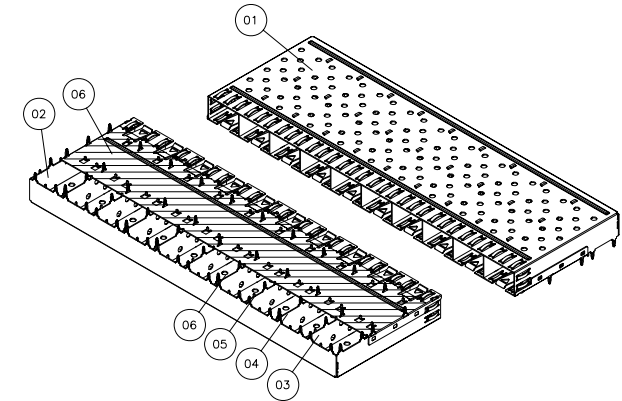
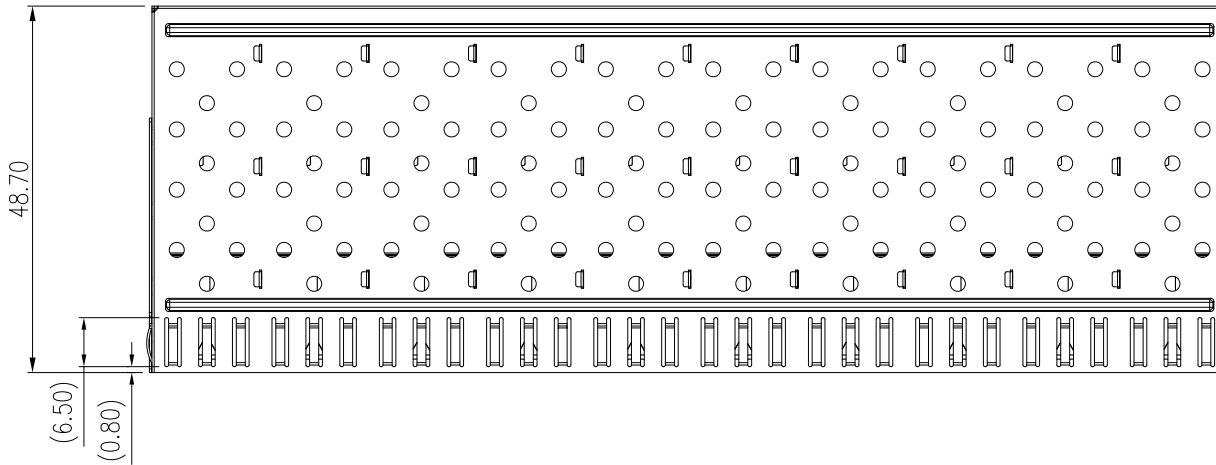

Qty per:		Tray	Carton
PART NUMBER : SFPCAGE006-L			
No.	DESCRIPTION	Q'ty	MATERIAL
01	CAGE TOP	1	COPPER ALLOY
02	CAGE BOTTOM	1	COPPER ALLOY
03	CAGE MIDDLE-1	3	COPPER ALLOY
04	CAGE MIDDLE-2	2	COPPER ALLOY
05	CAGE MIDDLE-3	1	COPPER ALLOY
06	CAGE MIDDLE-4	3	COPPER ALLOY
07	ISOLATION	1	

NOTE:
 MECHANICAL:
 SHIELD(CAGE) MATERIAL:
 1. THICKNESS=0.25mm, 0.30mm
 2. PLATED NICKEL 50u~80u

MM (INCH)	
TOLERANCES EXCEPT AS NOTED	
MM	±
.0 ± 0.2	±
.00 ± 0.15	±
.000 ± 0.075	±
ANGLES ± 0.5	
THIRD ANGLE PROJECTION	

RoHS Compliant			
TITLE: SFP CAGE 1B10			
DFTO: Laura Su	DRAWING NO. SFPCAGE006-L	SIZE: A3	REV: R3
DATE: 02/06/2007	/PART NO. SFPCAGE006-L	SHEET 1 OF 3	
SCALE: N/A	DO NOT SCALE DRAWING		

REVISION RECORD				
REV	ECO	DESCRIPTION	DRFT	CHKD

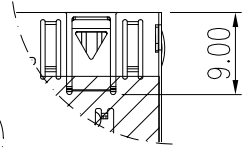
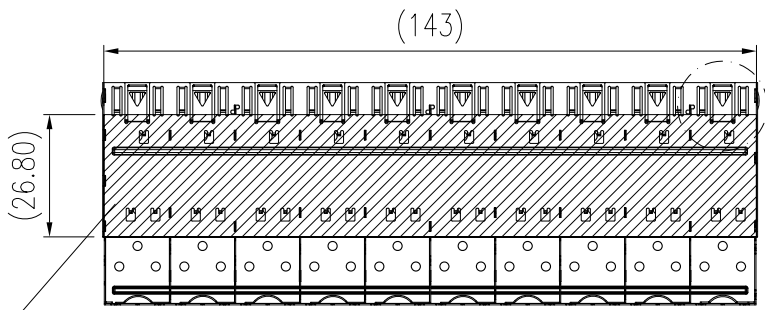
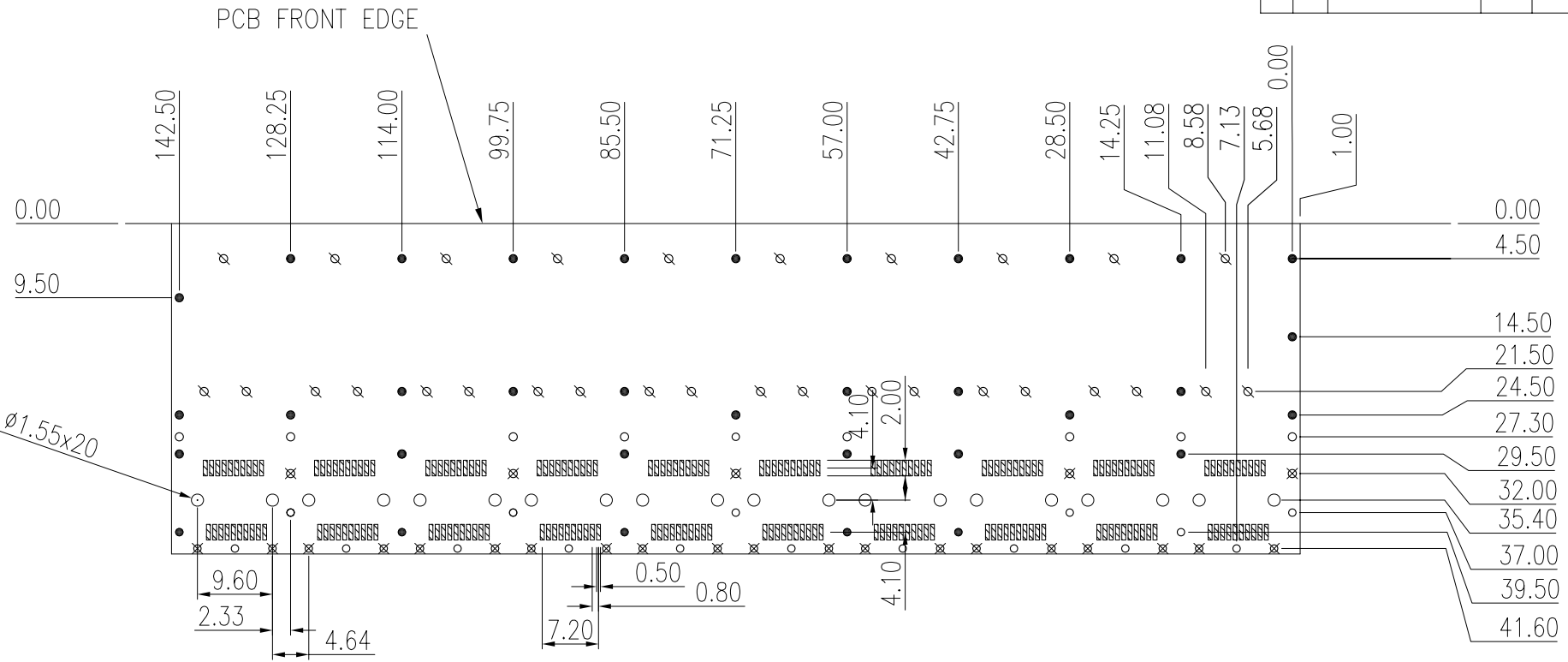

	QUANTITY	DIA.	INSERTION
⊗	30	Ø1.05	
●	35	Ø1.05	WIDE PRESS FIT
⊗	25	Ø0.95	NARROW PRESS FIT
○	25	Ø0.95	

ISOLATION (PASTE ON SFP CAGE BOTTOM)
 MATERIAL: MYLAR PAPER or "KAPTON", T= 0.05~0.1mm MAX.
 INSULATION RESISTANCE: AROUND 100V.
 TEMPERATURE REQUIREMENT: NO HIGH-TEMPERATURE.

DETACHED LISTS	← MM (INCH) →	RoHS Compliant			
	TOLERANCES EXCEPT AS NOTED	TITLE			
	MM	SFP CAGE 1B10			
	.0 ± 0.2 ± .00 ± 0.15 ± .000 ± 0.075 ±	DFTO Laura Su DRAWING NO. SFPCAGE006-L SIZE A3 REV R3			
ANGLES ± 0.5	DATE 02/06/2007 /PART NO. SFPCAGE006-L		DO NOT SCALE DRAWING SHEET 2 OF 3		
	SCALE : N/A		SHEET 2 OF 3		

REVISION RECORD				
REV	ECO	DESCRIPTION	DRFT	CHKD

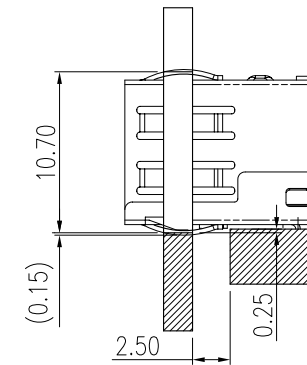
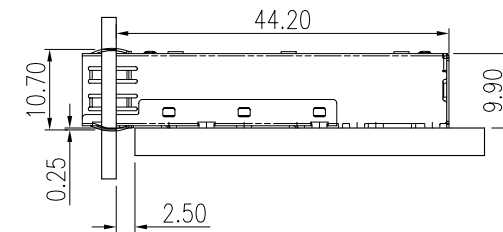
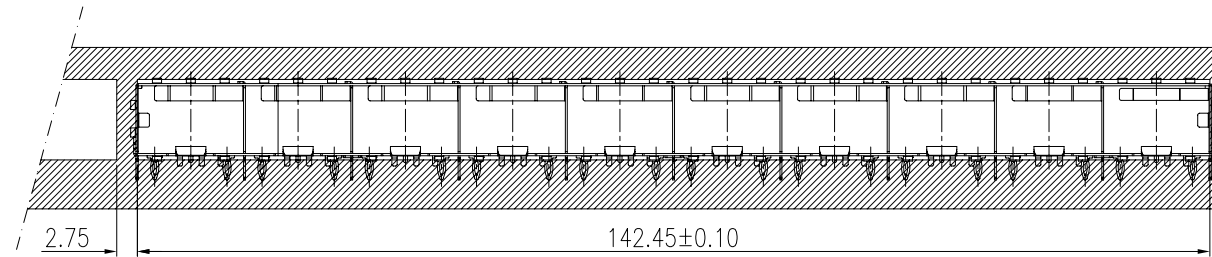

SFP CAGE 1BY10

DETACHED LISTS	← MM (INCH) →	RoHS Compliant			
	TOLERANCES EXCEPT AS NOTED				
	MM	±	TITLE SFP CAGE 1BY10		
	.0 ± 0.2	±			
.00 ± 0.15	±	DFTO Laura Su	DRAWING NO. SFPCAGE006-L	SIZE A3	REV R3
.000 ± 0.075	±	DATE 02/06/2007	/PART NO. SFPCAGE006-L	SHEET 3 OF 3	
ANGLES ± 0.5		SCALE : N/A	DO NOT SCALE DRAWING		
THIRD ANGLE PROJECTION					