

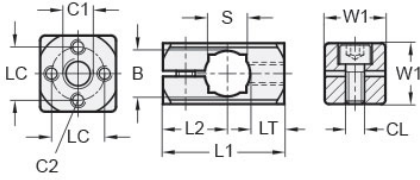

MT16-CSBC-M8-A

Ruland Sensor Bracket Clamp Connector, Thru Hole 16mm, Thread M8, L 40mm, Aluminum



Description

Ruland MT16-CSBC-M8-A is a sensor bracket clamp connector with a 16mm thru hole diameter, M8 center thread, M4 cross threads, 20mm width/height, and 40mm overall length. It is made with aluminum and has stainless steel cap screws. These clamp connectors are designed to fit with sensor brackets and mounting brackets with the same threading. Adjustable lever clamp kits with the same thread size can be attached to this clamp connector. The width/height of the bracket clamp must also be equal to the sleeve and stud length of the adjustable lever clamp kit. All bracket clamps from Ruland are RoHS3 and REACH compliant.

Product Specifications

Thru Hole Diameter B	16 mm	Thru Hole Tolerance	+0.11/-0 mm
Center Thread C1	M8	Cross Thread C2	M4 x 4
Thread Depth LT	11.5 mm	Center To Center LC	14 mm
Edge To Center L2	20.5 mm	Width & Height W1	20 mm
Overall Length L1	40 mm	Clamp Screw CL	M6
Weight (lbs)	0.066100	Material Specification	Aluminum
Manufacturer	JW Winco/ Otto Ganter	UPC	634529245774
Country of Origin	Germany	Tariff Code	7609.00.0000
UNSPC	31162908		