

DV2130

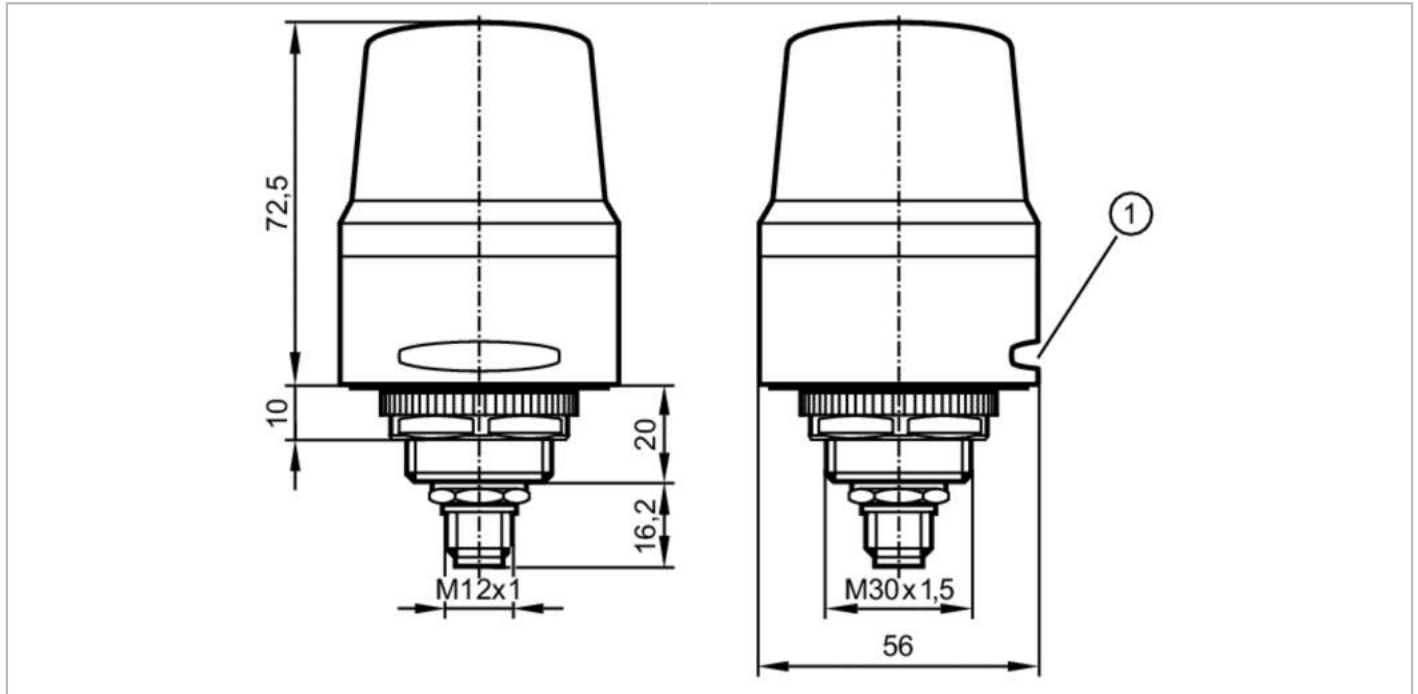

1-segment signal lamp

LED-Lamp/IO-Link/Buzzer



Application		
Application	signalling machine conditions	
Electrical data		
Operating voltage	[V]	18...30 DC; (to SELV/PELV ; "supply class 2" to cURus)
Nominal voltage DC	[V]	24
Current consumption	[mA]	< 90
Switch-on peak current	[mA]	400
Switch-on peak current duration	[ms]	50
Interfaces		
Communication interface	IO-Link	
Transmission type	COM2 (38,4 kBaud)	
IO-Link revision	1.1	
SDCI standard	IEC 61131-9	
SIO mode	yes	
Required master port type	A	
Min. process cycle time	[ms]	2.3
Supported DeviceIDs	Type of operation	DeviceID
	Default	1085
Operating conditions		
Ambient temperature	[°C]	-25...50
Storage temperature	[°C]	-40...75
Max. relative air humidity	[%]	90
Max. height above sea level	[m]	4000
Protection	IP 65	

DV2130



1-segment signal lamp

LED-Lamp/IO-Link/Buzzer

Pollution degree	2
------------------	---

Mechanical data

Weight [g]	166.5
Dimensions [mm]	Ø 56 / L = 72.5
Materials	housing: PC

Displays / operating elements

Display	LED segment, red / green / yellow / blue / lilac / cyan / white
Acoustic signal	buzzer
Max. sound pressure [dB]	90

Accessories

Accessories (optional)	mounting base, E89060
	wall bracket, E89061
	Mounting adapter, E89063
	bracket with lateral cable entry, E89064
	mounting tube, E89065
	mounting tube, E89066
	mounting tube, E89067
	mounting base, E89080

Remarks

Remarks	For further information please see the operating instructions.
Pack quantity	1 pcs.

Electrical connection - plug

Connector: M12; coding: A

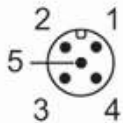

IO-Link

1	UB+
2	not used
3	UB-
4	IO-Link
5	not used

standard mode

1	IN1 red
2	IN2 green
3	GND
4	buzzer
5	IN3 blue

DV2130



1-segment signal lamp

LED-Lamp/IO-Link/Buzzer

Diagrams and graphs

base mounting

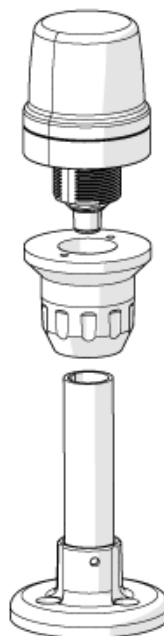

wall mounting

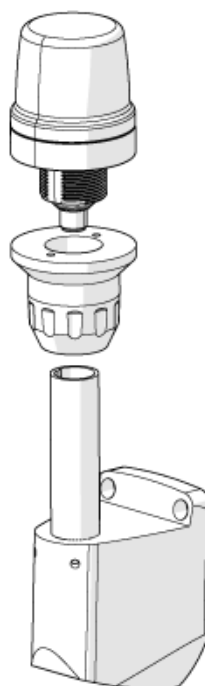

DV2130



1-segment signal lamp

LED-Lamp/IO-Link/Buzzer

light intensity distribution curve

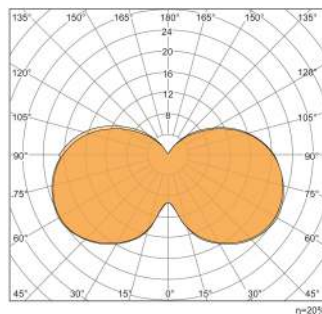

light intensity distribution curve: red

1000 lm

operating efficiency = 20%

light intensity distribution curve

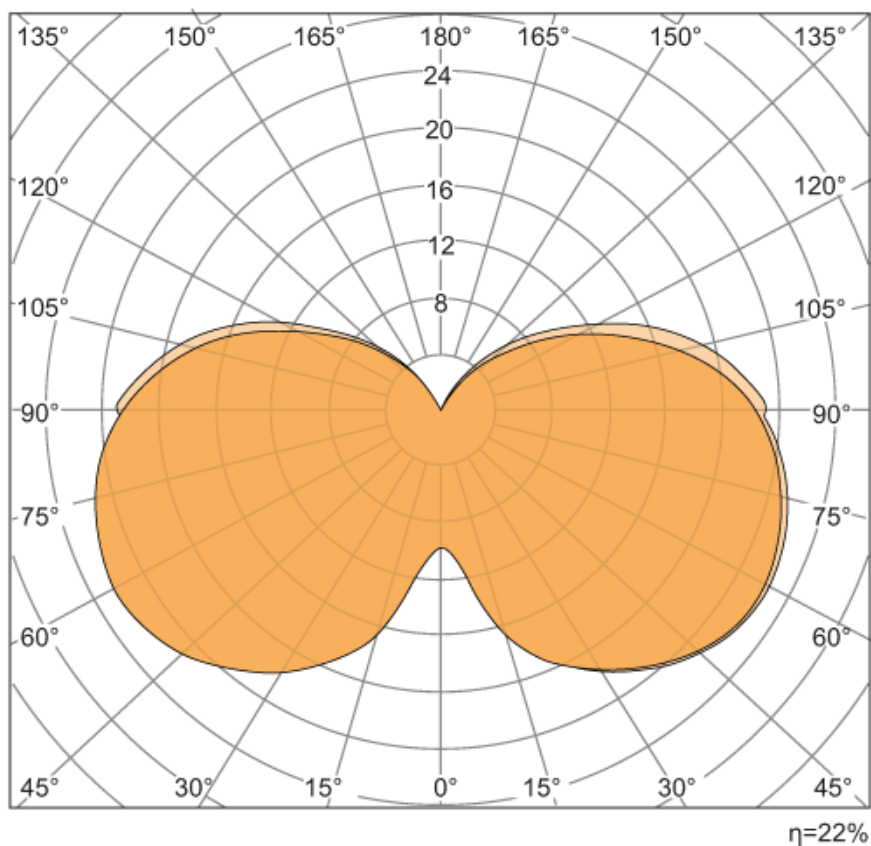

light intensity distribution curve: green

1000 lm

operating efficiency = 22%

DV2130



1-segment signal lamp

LED-Lamp/IO-Link/Buzzer

light intensity distribution curve

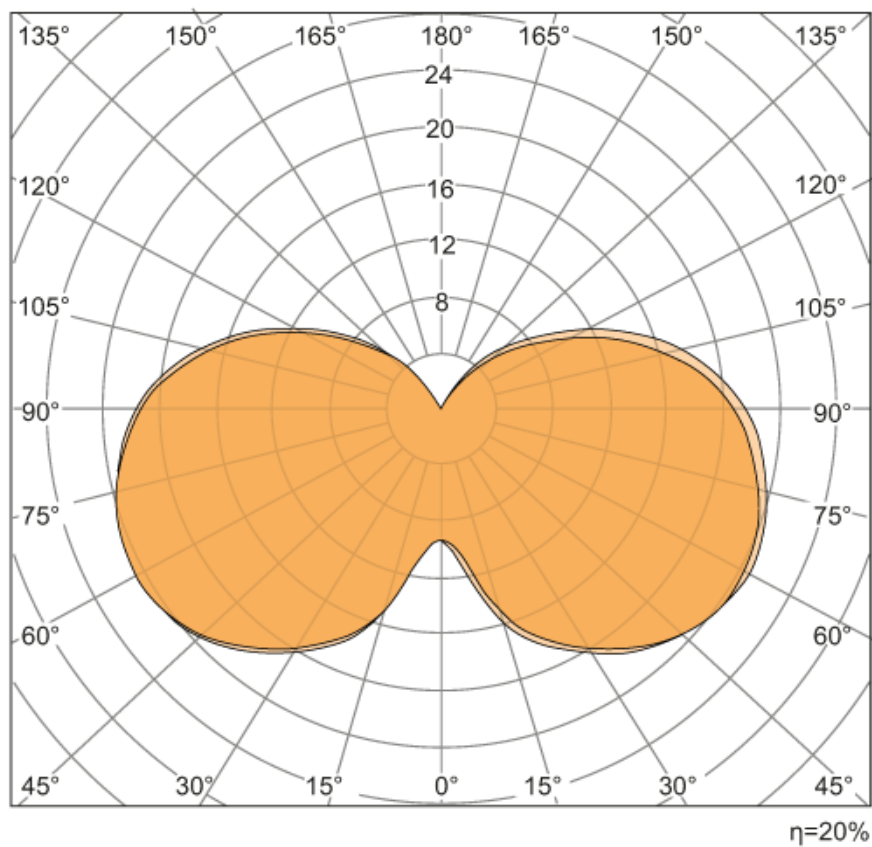

light intensity distribution curve: blue

1000 lm

operating efficiency = 20%