

NOTES:

1. MATERIAL: 0.008" TIN PLATED STEEL PER ASTM A623/A624
2. PARTS PER REEL: 220

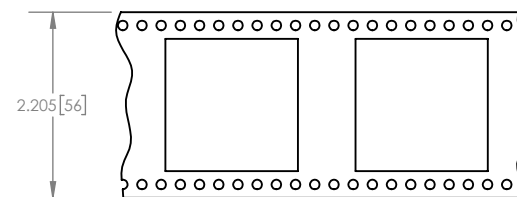
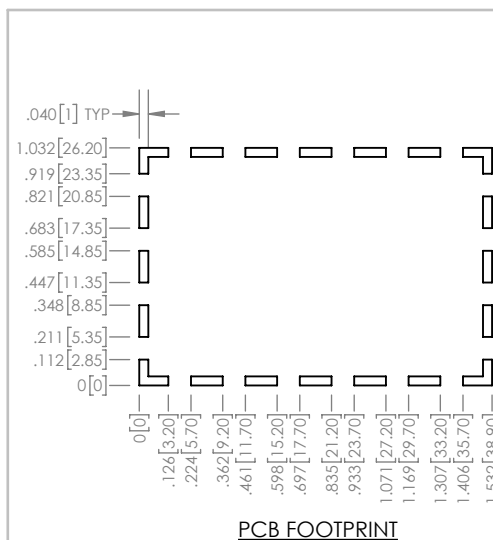
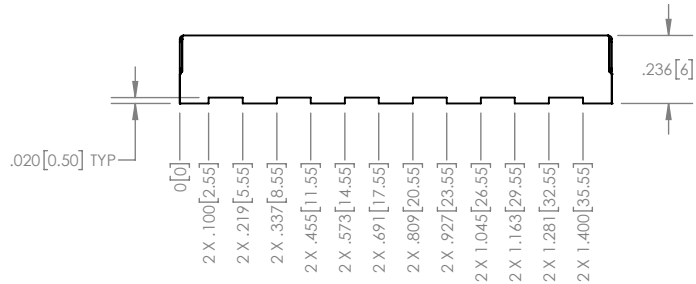
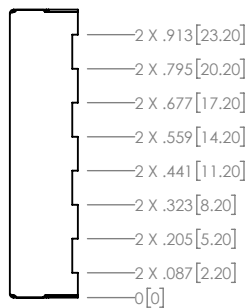
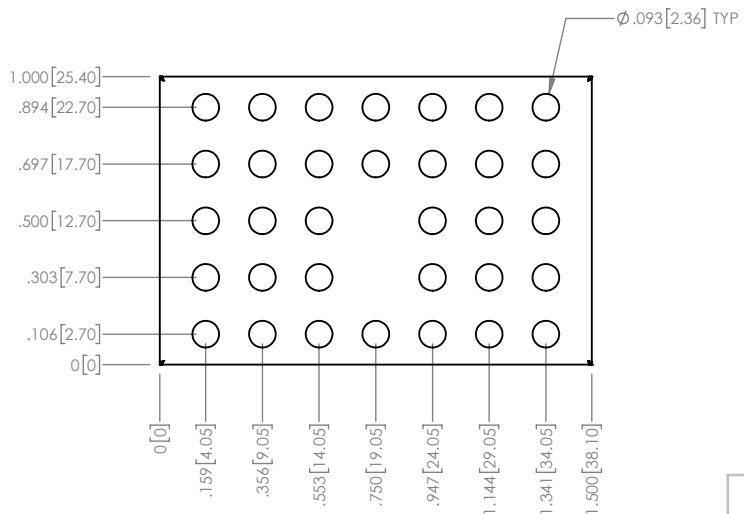
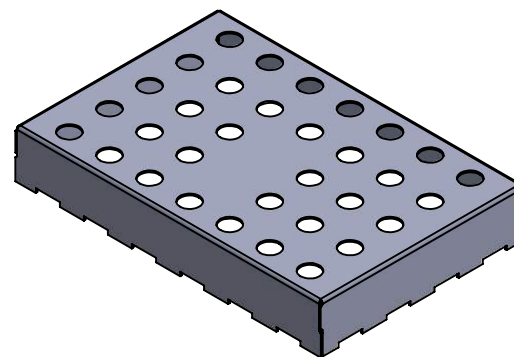

TAPE AND REEL

PROPRIETARY NOTICE: THESE DRAWINGS, LISTS OR SPECIFICATIONS ARE THE CONFIDENTIAL INFORMATION AND/OR TRADE SECRETS OF 3G SHIELDING SPECIALTIES (P), AND ISSUED IN STRICT CONFIDENCE EXCEPT AS AUTHORIZED BY 3G SHIELDING SPECIALTIES IN WRITING. THESE DRAWINGS, LISTS OR SPECIFICATIONS SHALL NOT BE REPRODUCED, TRANSMITTED, USED FOR DESIGN, MANUFACTURE OR SALE OF EQUIPMENT OR USED FOR ANY OTHER PURPOSES WITHOUT WRITTEN EVALUATION.

UNLESS OTHERWISE SPECIFIED
U/M INCHES TOLERANCE ± 0.005

ROHS COMPLIANCE 2011/65/EU

DATE 16-01-26



PART NUMBER	REV.
PIC-S-105	0
DESCRIPTION	SHIELD CAN
SCALE	SHEET 1 OF 1
1.5:1	