

APPROVED: _____
 DATE: _____ TITLE: _____

Rev	AWO #	Description	Date	Appr
-		RELEASED	7/25/19	
A		UPDATE SPEC.	8/1/19	LH/RC

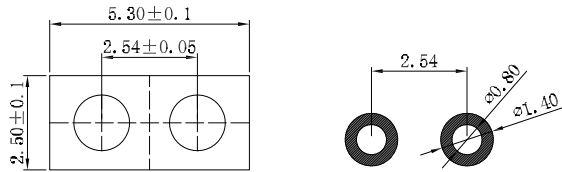

RECOMMENDED PCB LAYOUT

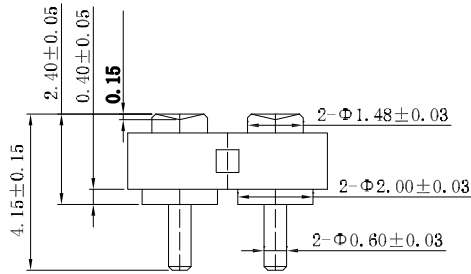

PH1-3F-02-FVP-24415-C1
 Insulator: PPA

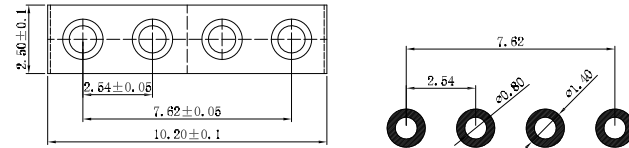

RECOMMENDED PCB LAYOUT

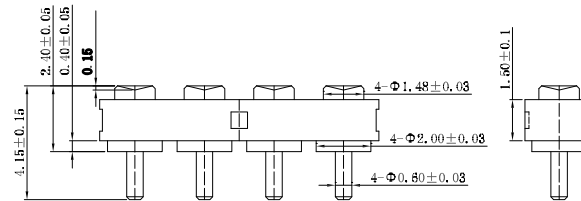

PH1-3F-04-FVP-24415-C1
 Insulator: PA46

SPECIFICATIONS:

Material:
 Insulator: (PA9T/PPA/PA46) Hi-Temp Thermoplastic, rated UL 94V-0, Color: Black
 Contacts: Copper Alloy
 Plating:
 3u" Gold over Nickel underplate overall
Electrical:
 Voltage rating (Per Contact): 12 Volts
 Current rating (Per Contact): 3A max
 Contact resistance : 20 mohms max
 Insulation resistance: 100 Mohms min
 Dielectric withstanding voltage: 1,000 VRMS @ 60HZ
 Temperature Rating:
 Operating temperature: -30°C to +85°C
Environmental:
 Lead free, RoHS compliant.



UNLESS OTHERWISE SPECIFIED
 ALL DIMENSIONS ARE MILLIMETERS
 TOLERANCES: EXCEPT AS NOTED

MM	ANGLE
X. ± 0.20	X' ± 2°
.X ± 0.15	.X' ± 0.5°
.XX ± 0.10	

ADAM TECH INTERCONNECTS 909 Rahway Avenue,
 Union, NJ 07083
 Phone: 908-687-5000
 Fax: 908-687-5710

APPROVALS		DATE
DRAWN	LH	7/25/19
CHECKED	RC	7/25/19
APPROVED		

TITLE		
CUSTOM LENGTH TUBE SINGLE ROW STRIPS 1.50MM INSULATOR HEIGHT, DIP LOADED		
SIZE	PART NO.	REV.
X	PH1-3F-XX-FVP-24415-C1	A
REF: S00185C	SCALE: NTS	SHEET 1 OF 3

6

5

4

3

2

1

APPROVED: _____

DATE: _____ TITLE: _____

Rev	AWO #	Description	Date	Appr
-----	-------	-------------	------	------

SEE SHT 1 OF 3 FOR REVISION

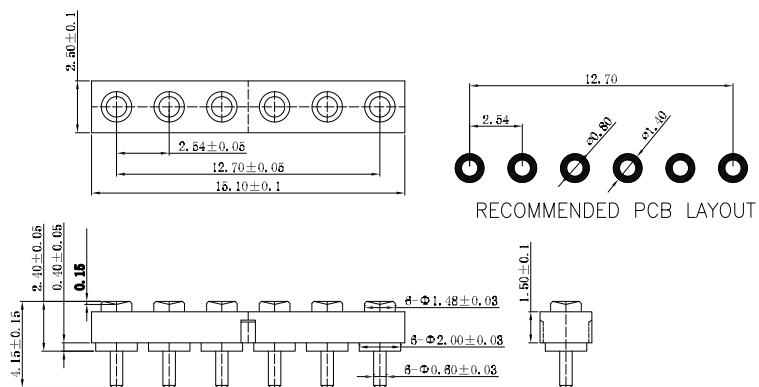

PH1-3F-06-FVP-24415-C1
Insulator: PA46

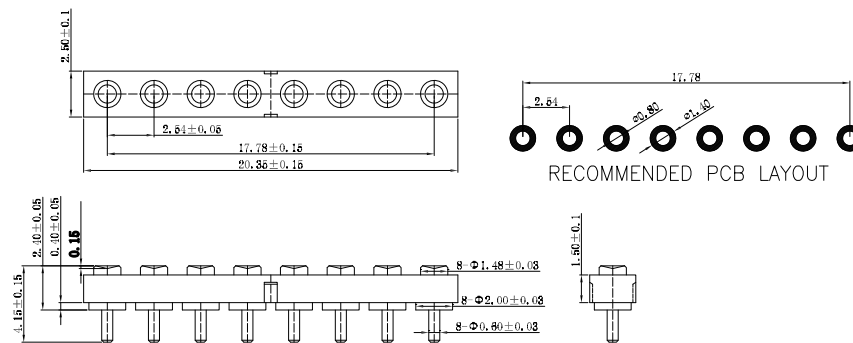

PH1-3F-08-FVP-24415-C1
Insulator: PA46

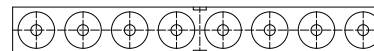
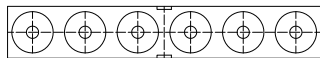

UNLESS OTHERWISE SPECIFIED
ALL DIMENSIONS ARE MILLIMETERS
TOLERANCES: EXCEPT AS NOTED

MM	ANGLE
X. ± 0.20	X' ± 2°
.X ± 0.15	.X' ± 0.5°
.XX ± 0.10	

ADAM TECH
INTERCONNECTS

909 Rahway Avenue,
Union, NJ 07083
Phone: 908-687-5000
Fax: 908-687-5710

TITLE: CUSTOM LENGTH TUBE SINGLE ROW STRIPS
1.50MM INSULATOR HEIGHT, DIP LOADED

APPROVALS		DATE
DRAWN	LH	7/25/19
CHECKED	RC	7/25/19
APPROVED		

SIZE	PART NO.	REV.
X	PH1-3F-XX-FVP-24415-C1	A
REF: S00185C	SCALE: NTS	SHEET 2 OF 3



6

5

4

3

2

1

6

5

4

3

2

1

APPROVED: _____

DATE: _____ TITLE: _____

Rev	AWO #	Description	Date	Appr
-----	-------	-------------	------	------

SEE SHT 1 OF 3 FOR REVISION

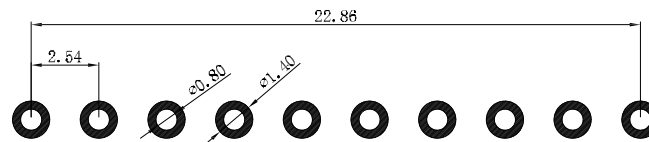
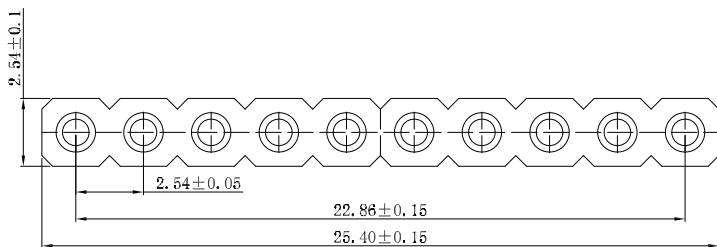

RECOMMENDED PCB LAYOUT

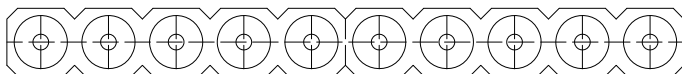
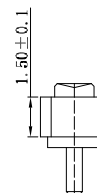
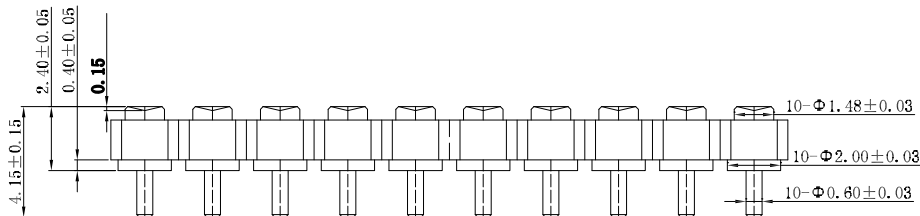

PH1-3F-10-FVP-24415-C1
Insulator: PA9T

UNLESS OTHERWISE SPECIFIED
ALL DIMENSIONS ARE MILLIMETERS
TOLERANCES: EXCEPT AS NOTED

MM	ANGLE
X. ± 0.20	X° ± 2°
.X ± 0.15	.X° ± 0.5°
.XX ± 0.10	

ADAM TECH
INTERCONNECTS

909 Rahway Avenue,
Union, NJ 07083
Phone: 908-687-5000
Fax: 908-687-5710

TITLE: CUSTOM LENGTH TUBE SINGLE ROW STRIPS
1.50MM INSULATOR HEIGHT, DIP LOADED

APPROVALS		DATE
DRAWN	LH	7/25/19
CHECKED	RC	7/25/19
APPROVED		

SIZE X	PART NO. PH1-3F-XX-FVP-24415-C1	REV. A
REF: S00185C	SCALE: NTS	SHEET 3 OF 3



6

5

4

3

2

1