

THIS DOCUMENT IS THE PROPERTY OF
KEYSTONE ELECTRONICS CORP. AND
SHALL NOT BE REPRODUCED, DISTRIBUTED
OR USED AS A BASIS FOR MANUFACTURE
WITHOUT PRIOR WRITTEN PERMISSION
FROM KEYSTONE ELECTRONICS CORP.

ACTUAL SIZE

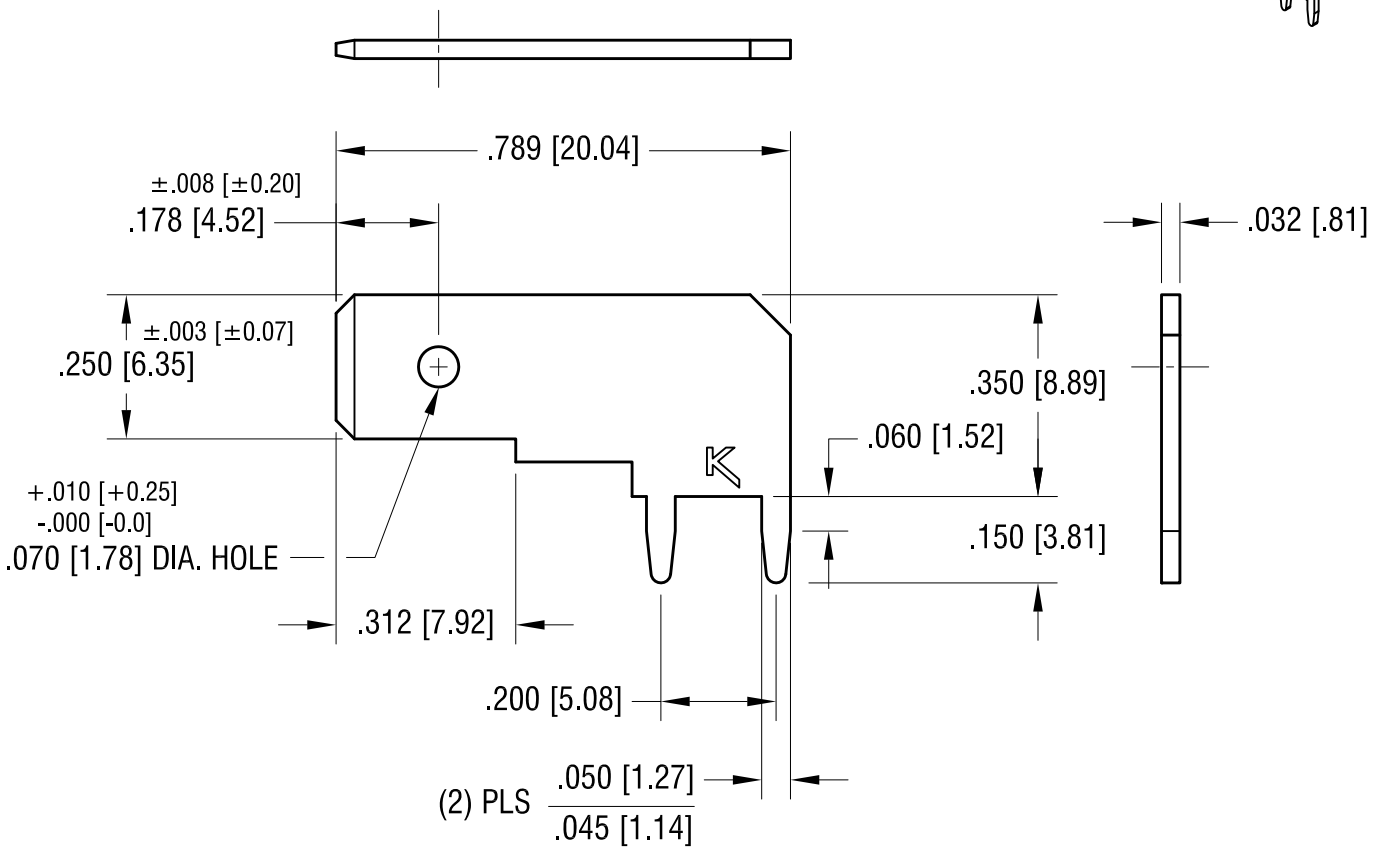
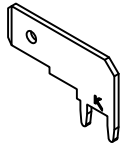

- NOTE:
1. MOUNTING HOLE SIZE: .052 [1.32] DIA.
 2. FILE NUMBER: E201546

8.21.12	CHANGE AS PER ECN 12-112	C
6.16.09	CHANGE AS PER ECN 09-073	B
5.13.94	REDRAWN	A
DATE	DESCRIPTION	REV.

KEYSTONE ELECTRONICS CORP.			
www.keyelco.com • NEW HYDE PARK NY 11040 • Tel (516)328-7500			
PART NAME		PC QUICK-FIT TERMINAL	
MATERIAL		.032 [0.81] TH'K BRASS	
FINISH	DRN BY	DATE	
MATTE TIN PLATE	BOONE	5.05.82	
	APP'D	SCALE	
	MR	3X	
TOLERANCES	INCH [MM]	CODE	DWG NO.
DECIMAL	± .005 [± 0.13]	C	1266
ANGULAR	± 1°		
UNLESS OTHERWISE SPECIFIED			