

PRODUCT NUMBER	PCB THICKNESS
91877-001	1.6MM
91877-002	2.4MM
91877-003	2.4MM
91877-001LF	1.6MM
91877-002LF	2.4MM

OBSOLETE USE 91877-002

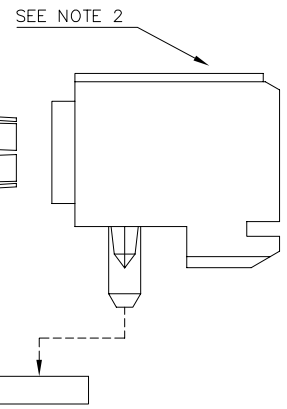
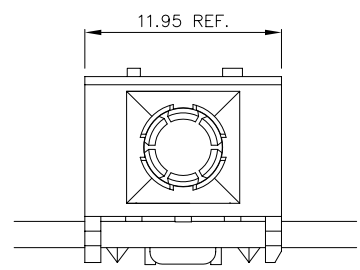
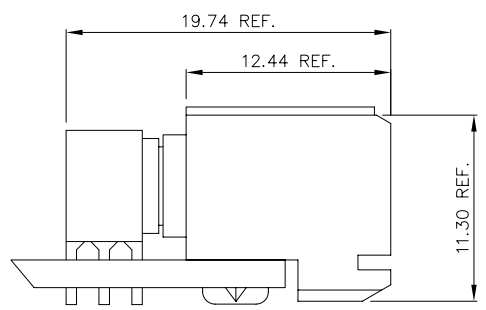
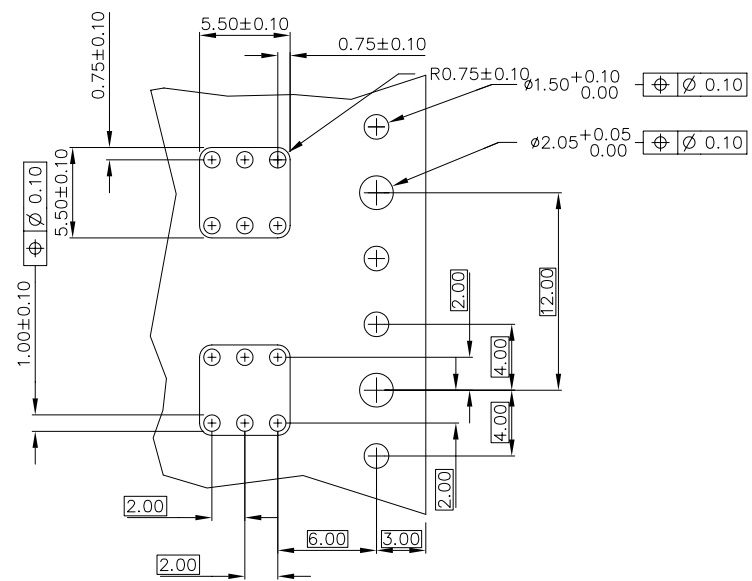
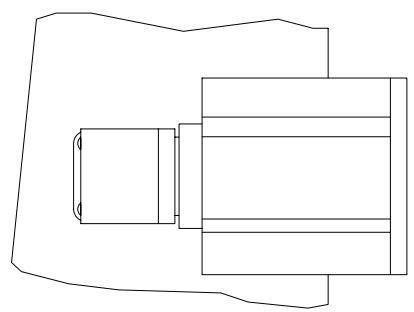

RECOMMENDED HOLE PATTERN
COMPONENT SIDE

NOTE:

- HOUSING SHOWN FOR APPLICATION CLARITY AND DOES NOT COME WITH R.A.RECEPTACLE POWER CONTACT
- 4 ROW HSG W/HEAT STAKE PEG: P/N 70292-101
4 ROW HSG W/PRESS PEG: P/N 89092-101
5 ROW HSG W/HEAT STAKE PEG: P/N 73477-101
5 ROW HSG W/PRESS PEG: P/N 73478-101
- RECEPTACLE CONTACT PLATING:
GOLD OVER NICKEL
- PLATING ON TAILS OF 91877-YYY IS SnPb
PLATING ON TAILS OF 91877-YYLF IS Sn (LEAD FREE)
- IF P/N IS "LF" THE PRODUCT MEETS EUROPEAN UNION DIRECTIVES AND OTHER COUNTRY REGULATION AS DESCRIBED IN GS-22-008.

mat'l. code		surface		tolerance		projection		product family	
-		ISO 1302 ✓		ISO 406 ISO 1101		mm		METRAL (tm)	
ltr	ecn	no	dr	date		tolerances unless otherwise specified		title	
B	v31676	SCS	9/08/93	angles	linear	xx ±.01/3	R.A. PASS-THRU POWER CONTACT		
C	v60188	CSC	2/02/96			xxx ±.005/.13	scale 1:1		
D	v01818	JWS	7/17/00	σ±2'	xxxx ±.0020/.050		sheet 1 of 1 size		
E	v02928	JWS	12/12/00	dr	STU STONER	11/01/91	91877 A3		
F	v04-1176	TAB	12/14/04	enr	R. DOUTRICH	11/01/91	type Product Customer Drawing		
G	M06-0156	MHT	4/13/06	chr	STU STONER	11/01/91			
H	M06-0286	MNR	7/27/06	appd	STU STONER	11/01/91			
sheet	revisor		H						
index	sheet	1							



FCIconnect.com

Copyright FCI

form: A3