

battery-powered LED SECURITY SPOTLIGHT

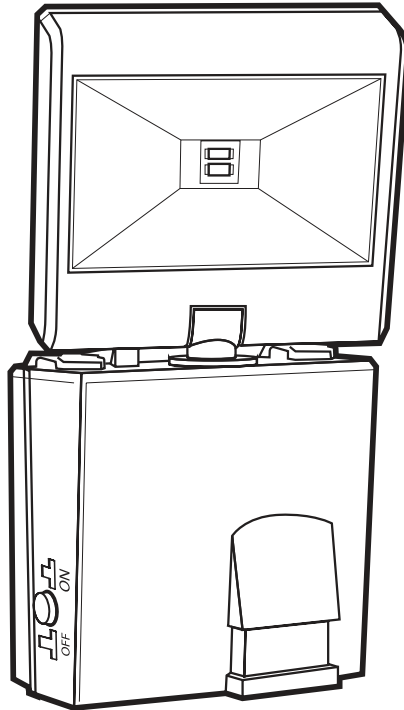

ASSEMBLY & OPERATING INSTRUCTIONS

ABOUT YOUR BATTERY POWERED LED SECURITY SPOTLIGHT

The LED Security Spotlight is perfect for lighting porches, doorways, or around the exterior of your home or business. The 2 super bright LEDs in the LED Security Spotlight have an estimated life of 30,000 hours so they should never need changing.

This LED Security Spotlight has an adjustable TIME dial that allows light duration of up to 60 seconds after the last detected motion. The LED Security Spotlight has a built-in motion sensor, which automatically turns on the light when movement of a heat source (such as people, animals, or cars) is detected in the area. The light remains on while motion continues to be detected in the area and turns off after a predetermined amount of time once the motion stops.

The LED Security Spotlight has a LUX setting which can be adjusted to control the functioning of the built-in photosensor so that the light only turns on at night.

The LED Security Spotlight requires 3 AA batteries (not included). The shorter the time period used, the longer the batteries will last. The spotlight may function irregularly or not at all at temperatures near or below freezing (20° F/-6° C) due to the functionality of alkaline batteries. Normal operation will return when the temperature rises.

INCLUDED PARTS:

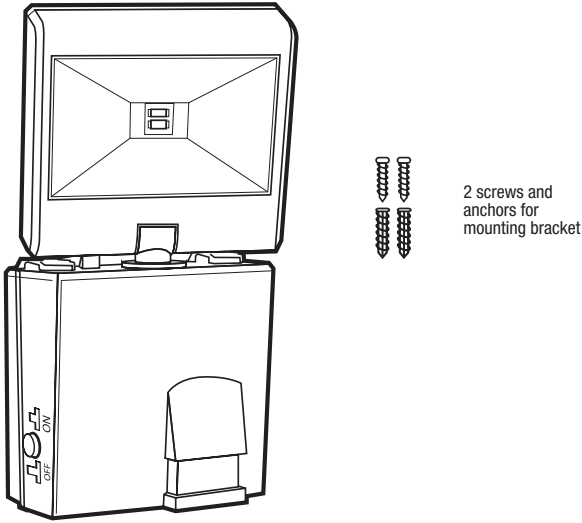

Adjustment dials are located on the underside of the main body. They are denoted by TIME and LUX stamps.

CHOOSING A LOCATION FOR YOUR LED SECURITY SPOTLIGHT

This LED Security Spotlight provides safety and security around your home. It is ideal for lighting up areas where electricity is not available such as porches, driveways, carports outside, garages and entrance areas.

When deciding where to mount the light, keep in mind that the motion sensor has a horizontal field of vision of 120° at a distance of up to 26 feet when the surrounding temperature is 75°F. The outside temperature will impact the detection distance. As temperatures get colder the motion sensor will become more sensitive and the range of the motion sensor will increase.

INSTALLING OR REPLACING THE BATTERIES

When the charging ability of the batteries decrease, you can replace them with brand new AA batteries. Follow the steps below when replacing the batteries.

1. First push the power button to turn the light off.
2. Remove the thumbscrew from the bottom of the LED Security Spotlight and slide the light up and off of the mounting bracket.
3. Carefully remove the old batteries from the battery tray and replace with brand new AA batteries. Ensure that the new batteries are plugged in with the correct +/- polarity orientation. (WARNING: Installing the batteries in the opposite direction could damage the unit.)
4. Slide the light back onto the mounting bracket and replace the thumbscrew.

NOTE: DO NOT DISPOSE OF BATTERIES IN GENERAL HOUSEHOLD TRASH OR INTO A FIRE SINCE THE BATTERIES MAY EXPLODE. CONSULT YOUR LOCAL REGULATIONS FOR CORRECT DISPOSAL OF BATTERIES. THE BATTERIES MAY ALSO BE RETURNED TO MAXSA INNOVATIONS AT 8412 CATHEDRAL FOREST DRIVE, FAIRFAX STATION, VA 22039. DO NOT TAKE APART THE BATTERIES SINCE THEY CONTAIN CORROSIVE CHEMICALS.

NOTE: DO NOT MIX OLD AND NEW BATTERIES. DO NOT MIX ALKALINE, STANDARD (CARBON-ZINC), OR RECHARGEABLE (NICKEL-CADMIUM) BATTERIES.

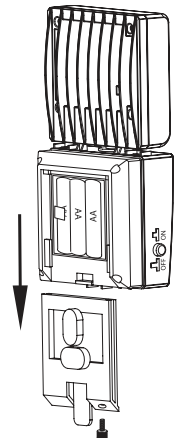

HOW TO INSTALL YOUR LED SECURITY SPOTLIGHT

Tools Required For Install

You will need a drill and a Phillips-head screwdriver.

Mount the LED Security Spotlight onto a solid surface, using the two (2) wood/sheet metal screws supplied. You may mount the LED Security Spotlight either vertically or horizontally.

1. Remove the mounting bracket from the back of the light. Do this by removing the thumbscrew, then grabbing the tab on the bottom of the mounting bracket and pulling it down and out of the light.
2. Align the mounting bracket on the wall and drill the first hole through the circular depression of the inside of the mounting bracket and into the wall. This is depression number 1 in the image below.
3. Next, drill through the lower, oval depression on the mounting bracket and into the wall. This is depression number 2 in the image below. Make sure your first hole in the mounting bracket is still lined up with the associated hole in the mounting surface before drilling the second hole.

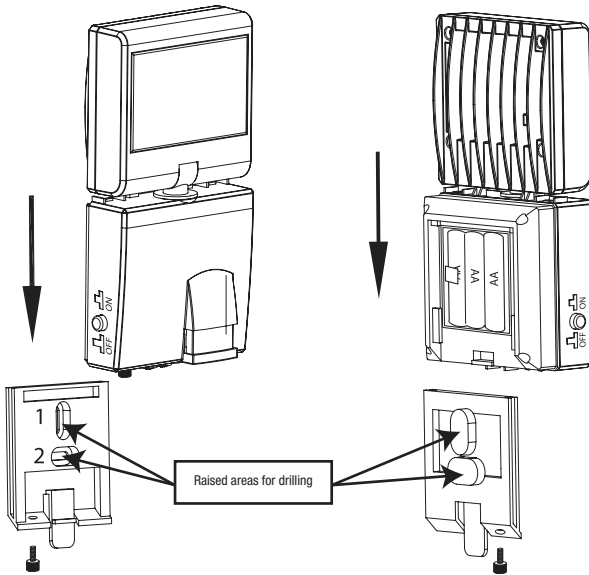

4. If drilling into cement, brick, or similar surfaces, put the mounting bracket down and use a slightly larger drill bit to make the holes in the mounting surface larger. Insert the included anchors in the larger holes.
5. Align the mounting bracket on the wall and install the two screws using a screwdriver.
6. Slide the unit back over the mounting bracket and put the thumbscrew back in place.

OPERATING YOUR LED SECURITY SPOTLIGHT

After installing new batteries in your LED Security Spotlight, click the button on the main body to turn the light ON.

When you do this, the light should activate immediately, regardless of lighting conditions or motion. This is a test activation to show there is power flowing from the batteries to the light. It should last roughly 30 seconds. After this test activation, the light will function based on the dial settings mentioned below. Your LED Security Spotlight is now ready for use.



On the bottom of the light body, there are 2 adjustment dials: TIME and LUX

The LED Security Spotlight has been factory preset as follows:

TIME - Set at 15 seconds.

LUX - Set for your LED Security Spotlight to activate at dusk when motion is detected.

If the above settings are not suitable for your application, then these may be adjusted as follows.

Time Period Adjustment

The time period control dial sets the duration that the LED Security Spotlight will remain illuminated after the last detected motion. The time period has an adjustable range of 10 seconds to 60 seconds.

To decrease the time period, move the dial toward the (-) symbol.

To increase the time period, move the dial toward the (+) symbol.

Test the time period by triggering the motion sensor and measure the time period the light stays on. Adjust the TIME control until the desired illumination duration is reached. A shorter TIME setting will conserve battery life. For best results, use the shortest TIME setting for your location as possible.

Light Level Adjustment

The LUX dial controls the natural light level that triggers the LED Security Spotlight and prevents it from operating during daylight hours. Your LED Security Spotlight comes preset for activation at dusk.

To adjust for activation before dusk, move the dial toward maximum (☼).

To adjust for activation after dusk, move the dial toward minimum (☾).

SAFETY TIPS

Do not immerse the LED Security Spotlight in water or other liquid.

STORAGE

If you wish to store your light indoors for more than two or three days, turn the power switch to the OFF position and remove the batteries to prevent damage to the batteries. Battery capacity may be reduced or damaged during prolonged storage

MAINTENANCE TIPS

The LED lights in your LED Security Spotlight will last up to 30,000 hours and should never need replacement. When the lights get too dim or stop working completely, it is time to replace the batteries. You can use any brand new AA batteries. To keep your LED Security Spotlight looking its best, keep the lens free of dust and deposits by wiping occasionally with a dry cloth or with warm soapy water.

Cold Weather Functionality

In temperatures below 20°F, performance of the batteries may be reduced.

Normal performance will return when the temperature rises

PROBLEM	POSSIBLE SOLUTIONS
<p>LED Security Spotlight will not switch on when there is movement in the detection area.</p>	<ul style="list-style-type: none"> • Ensure that the power button on the main body is in the ON position • Ensure that the LED Security Spotlight has been positioned so the motion sensor faces oncoming movement. • Ensure that the batteries still have power. • Check to see that the LUX control has not been set too far towards the minimum (☞). Setting the LUX control too far towards minimum (☞) will cause the LED Security Spotlight to turn on only in complete darkness. • Check to see that the motion sensor is not near night time light sources such as street lights.
<p>LED Security Spotlight switches on during the day</p>	<ul style="list-style-type: none"> • The LUX control may be set too far towards the maximum (☜) position. • Reposition the LED Security Spotlight so the motion sensor faces a different direction.
<p>LED Security Spotlight switches on for no apparent reason</p>	<ul style="list-style-type: none"> • Moving trees, traffic, pets, or birds may be getting in the area of detection. This may be unavoidable; however the sensor could be redirected to a spot where this is less likely to occur. • If there are reflective objects in the detection area such as windows, water, or white walls, you may need to redirect or possibly reposition the motion sensor. • Test the motion sensor by covering it completely with cardboard and waiting several minutes to make sure it does not detect motion. If the LED Security Spotlight still switches on, please contact MAXSA for further assistance.
<p>LED Security Spotlight quickly flashes on and off.</p>	<ul style="list-style-type: none"> • Battery charge may be low. See “Installing or Replacing the Batteries” on Pg 2 • Move the LUX control more towards the minimum (☞) position
<p>LED Security Spotlight is not as bright as normal</p>	<ul style="list-style-type: none"> • Battery charge may be low. See “Installing or Replacing the Batteries” on Pg 2

ONE YEAR LIMITED WARRANTY

1 YEAR LIMITED WARRANTY: MAXSA Innovations, LLC warrants to the original consumer/purchaser that this product shall be free of defects in material and workmanship under normal use and circumstances for a period of one (1) year from the date of original purchase for use. When the original consumer/purchaser returns the product pre-paid (consumer pays return shipping) to MAXSA Innovations, LLC, 8412 Cathedral Forest Drive, Fairfax Station, VA 22039; USA within the warranty period, and if the product is defective, MAXSA Innovations, LLC will at its option repair or replace such. This warranty shall constitute the sole liability of MAXSA Innovations, LLC concerning the product. MAXSA Innovations, LLC expressly disclaims all other warranties INCLUDING, WITHOUT LIMITATION, THE WARRANTIES OF MERCHANT ABILITY AND FITNESS FOR A PARTICULAR PURPOSE. NO PERSON, FIRM, OR CORPORATION IS AUTHORIZED TO ASSUME FOR MAXSA Innovations, LLC ANY OTHER LIABILITY IN CONNECTION WITH THE SALE AND USE OF THE PRODUCT. MAXSA Innovations, LLC and agents and distributors will bear no liability whatsoever for incidental or consequential damages or charges of any kind. Some states do not allow the reclosure or limitation of incidental or consequential damages, so the above disclaimer regarding incidental or consequential damages may not apply to you. This warranty is void if the product has been damaged or tampered with or if the product or any such parts have been opened. In all cases of damage during shipment, a claim must be filed with the shipping carrier and not with MAXSA Innovations, LLC. This warranty gives you specific legal rights; you may also have other rights which vary from state to state.

SPECIFICATIONS

Power Source:	Battery
Lumens:	100
Light Color:	6500K (Cool White or Daylight color)
Function:	Motion-Activated
Power Storage:	3 1.5V AA batteries (not included)
Light Duration:	10 - 60 seconds
Detection Angle:	120°
Max Detection:	26 feet (~ 8 meters)
Weatherproof Rating:	IP44

MADE IN CHINA

PLEASE SAVE THESE INSTRUCTIONS FOR FUTURE REFERENCE.



MAXSA Innovations, LLC.

8412 Cathedral Forest Dr
Fairfax station, VA 22039

Tel: 703-495-0661

www.maxsainnovations.com

info@maxsainnovations.com