

**Technical specification :**

Rated voltage:	60 V
IEC 61076-2-104	
Current rating:	3 A at 40°C
IEC 61076-2-104	
Insulation resistance:	>=100 MΩ
IEC 60512	
Pollution degree:	3/2
IEC 60664-1	
Degree of protection:	IP 67, in mated condition
IEC 60529	
Temperature range:	-30°C ... +80°C
EN 60512-11-10	-40°C
EN 60512-11-4	-40°C ... +85°C
Mating cycles:	>=100
IEC 60512-9a	

**Cable specification:**

Temperatur range:	
static	-20°C ... +80°C
flexibel	-5°C ... +80°C

**Materials:**

Contact:	CuZn, Ni b / Au 0,2 gal.
Contact carrier:	PA, UL 94 V-0
Sealing:	FPM
Coupling nut:	GD-Zn, Nickel plated
Moulding body:	TPU, UL 94 HB, grey

**Installation specification:**

Recommended torque:	0,4 Nm
Conec installation tool:	Torque wrench: 36-000200 Insert across flats 9: 36-000210

**Contact assignment:**

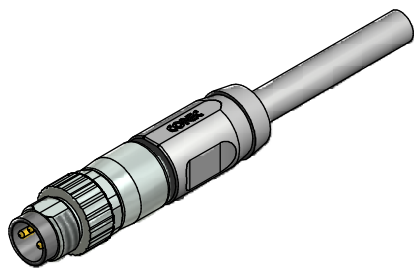
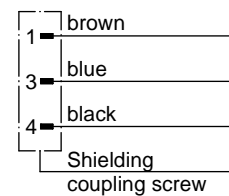

Part no:	Description:	Length L:	Cable:
42-10859	SAL - 8S - RS3 - 2 / G3	2m	PVC, UL 2464, grey, 3x0,25mm <sup>2</sup> Cable: 781-G32300
42-10860	SAL - 8S - RS3 - 3 / G3	3m	
42-10861	SAL - 8S - RS3 - 5 / G3	5m	
42-10862	SAL - 8S - RS3 - 10 / G3	10m	
42-xxxxx	SAL - 8S - RS3 - ... / G3	x	

DO NOT ALTER CAD DRAWING BY HAND RoHS & REACH compliant	Index: b 29.04.16 rob Ä6110 data sheet modified, moulding updated	dim. in mm	title: <b>Male connector M8x1 axial, 360°-shielding</b>	
		date      name		
	tolerance of cable:      L ≤ 4m: L + 40mm L > 4m: L + 1%	drawn 27.10.09      Franz	dwg no: <b>42K1A180</b>	
	general tolerance:      0            ± 0,50mm 0,0        ± 0,25mm 0,00      ± 0,10mm *            ± 5°	appd. 27.10.09      Burschik		
	THIS DRAWING MAY NOT BE COPIED OR REPRODUCED IN ANY WAY, AND MAY NOT BE PASSED ON TO A THIRD PARTY WITHOUT WRITTEN PERMISSION. OWNERSHIP AND COPYRIGHT OF CONEC GmbH			part no: <b>see table</b>