

REVISIONS			
REV	DESCRIPTION	DATE	APPROVED
01 ₀	RELEASED	5/13/98	<i>DCamello</i>

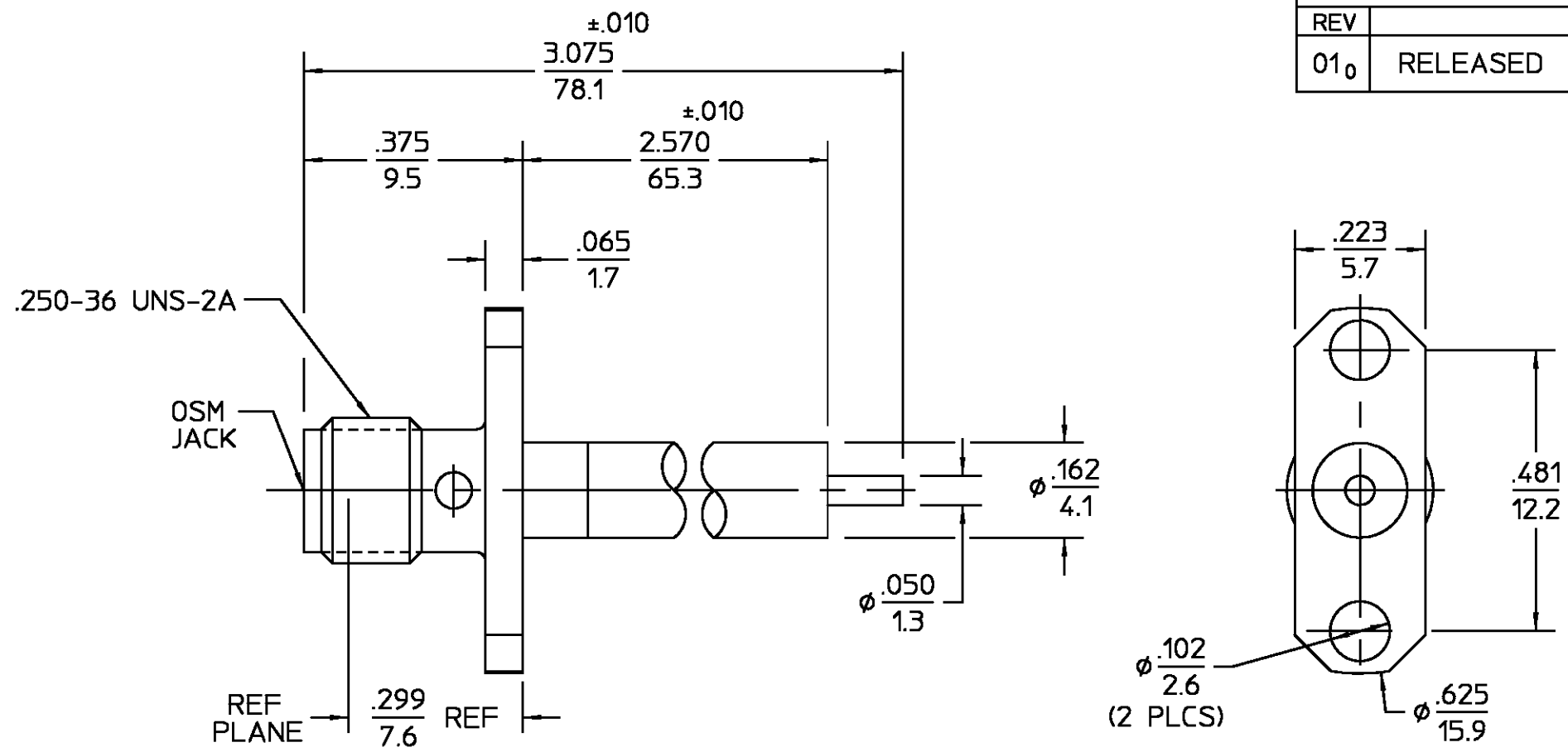

ELECTRICAL	MECHANICAL	ENVIRONMENTAL	HOUSING	MATERIAL	FINISH						
Nominal Impedance (Ohms) <u>50</u>	Interface Dimensions MIL-STD-348A, Fig. <u>310-2</u>	Temperature Rating <u>-65°C To +125°C</u>	STAINLESS STEEL PER ASTM-A484 AND ASTM-A582, TYPE 303	GOLD PLATE PER MIL-G-45204							
Frequency Range (GHz) DC to <u>18</u>	Recommended Mating Torque <u>7-10 in-Lbs</u>	Vibration MIL-STD-202, Method 204, Condition B	DIELECTRIC PTFE FLUOROCARBON PER ASTM-D-1457	N/A							
Volt Rating (VRMS MAX) @ Sea Level <u>335</u>	Mating Characteristics: Insertion (MAX Lbs) <u>2.0</u>	Shock MIL-STD-202, Method 213, Condition I	CENTER CONTACT BERYLLIUM COPPER PER ASTM-B-196 OR ASTM-B-197, ALLOY C17300, CONDITION H	GOLD PLATE PER MIL-G-45204							
VSWR <u>1.05 + .005f GHz</u>	Withdrawal (MIN Oz) <u>1.0</u>	Thermal Shock MIL-STD-202, Method 107, Condition B,									
Insertion Loss (dB MAX) <u>.03√f GHz</u>	Force to Engage and Disengage (In/Lbs MAX) <u>2</u>	Moisture Resistance MIL-STD-202, Method 106, Except Vibration									
RF Leakage (dB MIN) <u>-[60-f(GHz)]</u>	Center Contact Captivation Axial (Lbs) <u>6.0</u>	Shall Be Omitted									
Corona, 70,000 Ft (VRMS MIN) <u>250</u>	Radial (In/Oz) <u>4.0</u>	Corrosion - MIL-STD-202, Method 101, Condition B, 5% salt spray									
Dielectric Withstanding Voltage (VRMS MIN) @ Sea Level <u>1000</u>	Weight (Grams) <u>2.2</u>										
Contact Resistance (Milliohms MAX) Center Contact <u>3.0</u>											
Outer Contact <u>2.0</u>											
Cable to Housing <u>N/A</u>											
RF High Potential @ Sea Level (VRMS MIN @ 5 MHz) <u>670</u>											
LR.(Megohms MIN) <u>10,000</u>											
<p>.XXX = in XX.X = mm (REF)</p>			<p>UNLESS OTHERWISE SPECIFIED DIMENSIONS ARE IN INCHES TOLERANCE ON</p> <table border="1"> <tr> <td>FRAC.</td> <td>DEC.</td> <td>ANGLES</td> </tr> <tr> <td>± 1/64</td> <td>±.005</td> <td>± 1°</td> </tr> </table> <p>These drawings and specifications are the property of M/A-COM Incorporated and shall not be reproduced or copied or used in whole or in part as the basis for the manufacture or sale of item(s) without written permission.</p>			FRAC.	DEC.	ANGLES	± 1/64	±.005	± 1°
FRAC.	DEC.	ANGLES									
± 1/64	±.005	± 1°									
			<p>COMPONENT</p> <p>USE ASS'Y PROCEDURE</p> <p>NO. AP. <u>N/A</u></p>	<p>DRAWN BY PATLAN DATE 5/13/98</p> <p>CHECKED BY</p> <p>APPD BY <i>DCamello</i> 5/13/98</p>	<p>MATERIAL</p> <p>AMP Incorporated 140 Fourth Avenue Waltham, MA 02451-7599</p>						
			<p>TITLE OSM FLANGE MOUNT JACK RECEPTACLE STRAIGHT TERMINAL</p>								
			<p>SIZE B</p>	<p>CODE IDENT NO. 26805</p>	<p>2052-3995-00</p>						
			<p>SCALE 4:1</p>	<p>REV 01₀</p>							
			<p>SHEET 1 OF 1</p>								