

LEAD FREE PART NUMBER

SHELL	A±0.38	B±0.12	C±0.10	D±0.25	E±0.07	PART NUMBER
09	30.81	24.99	16.96	16.79	10.96	D09P24A.PL00LF
15	39.14	33.32	25.18	25.12	19.18	D15P24A.PL00LF
25	53.03	47.04	39.12	38.84	33.12	D25P24A.PL00LF
37	69.32	63.50	55.68	55.30	49.68	D37P24A.PL00LF

Plating: 4 --> flash AU
Plating: 6 --> 0.76µ AU

PC card drilling dimensions(after plating)
(thickness 1.60±0.20mm)

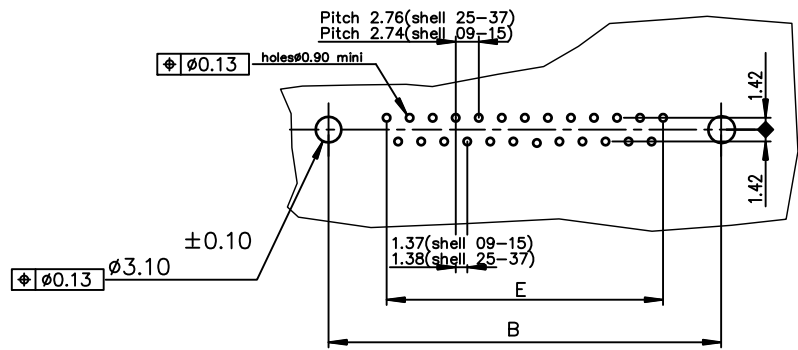

Notes:

1) The nut can protrude above the surface of insulator but maintaining the footprint dimension 6.0±0.15 mm.

GENERAL CHARACTERISTICS AND ROHS INFORMATIONS:
SEE DRAWING C01-8646-0000

mat'l. code		surface		tolerance		projection		product family	
-		ISO 1302		ISO 406 ISO 1101				D-SUB	
ltr		ecn no		dr		date		title	
H		ELX-I-21256		AB		2015/07/14		MALE CONNECTOR DELTA-D STRAIGHT - SOLDER TYPE	
				angles		linear		MM	
				0°±2'		.0±0.1 .00±0.1 .000±0.1		scale 2:1	
		dr		LELEON		1992/09/10		dwg no	
		engr		ALIAS BABU		2015/07/14		sheet 1 of 1	
		chr		MITHUN PAUL		2015/07/14		size	
		app		BIJU K PAUL		2015/07/14		A3	
sheet index		revision		H				type	
		sheet		1				Product Customer Drawing	



FCIconnect.com

Copyright FCI