

**TNC FEMALE - N FEMALE SQUARE FLANGE
STRAIGHT ADAPTER**

R191.514.000

Série : ADAPT

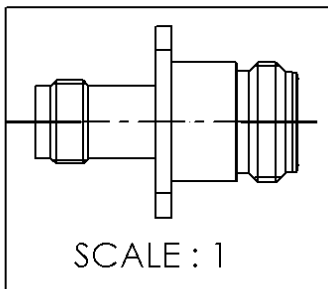
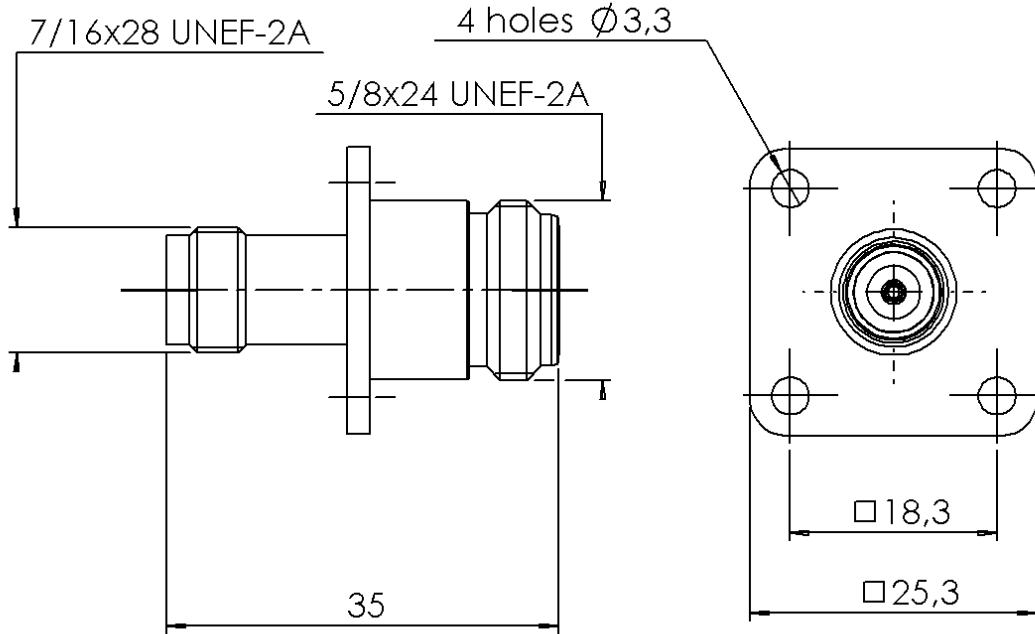

PANEL CUT OUT

| | mm | |
|---|-------|-------|
| | Maxi | mini |
| A | 16.3 | 16.2 |
| B | 3.35 | 3.15 |
| C | 18.35 | 18.15 |

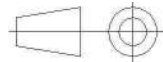
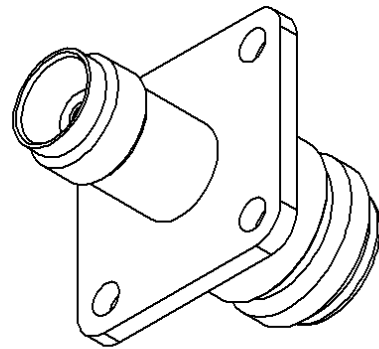

All dimensions are in mm.

| COMPONENTS | MATERIALS | PLATING (µm) |
|----------------|------------------|------------------------|
| BODY | BRASS | NICKEL 2 |
| CENTER CONTACT | BERYLLIUM COPPER | GOLD 0.5 OVER NICKEL 2 |
| OUTER CONTACT | BRASS | NICKEL 2 |
| INSULATOR | PTFE | |
| GASKET | - | - |
| OTHERS PARTS | - | - |
| - | - | - |
| - | - | - |

Issue : 0812 B

In the effort to improve our products, we reserve the rights to make changes judged to be necessary.



TNC FEMALE - N FEMALE SQUARE FLANGE

R191.514.000

STRAIGHT ADAPTER

Série : ADAPT

PACKAGING

| Standard | Unit | Other |
|----------|------|-------------------|
| 1 | | Contact us |

SPECIFICATION

LEA 03COANO-OTNC

ELECTRICAL CHARACTERISTICS

| | | |
|---------------------------------|----------------------|--------------------------|
| Impedance | 50 | Ω |
| Frequency | 0-11 | GHz |
| VSWR | 1.30 + 0,0000 | x F(GHz) Maxi |
| Insertion loss | 0.06 | \sqrt{F} (GHz) dB Maxi |
| RF leakage | - (101) | - F(GHz)) dB Maxi |
| Voltage rating | 500 | Veff Maxi |
| Dielectric withstanding voltage | 1500 | Veff mini |
| Insulation resistance | 5000 | M Ω mini |

ENVIRONMENTAL

| | | |
|---------------|-----------------|--------------|
| Operating | -65/+165 | $^{\circ}$ C |
| Hermetic seal | NA | Atm.cm3/s |
| Panel leakage | NA | |

MECHANICAL CHARACTERISTICS

| | | |
|----------------------------|-----------|-----------|
| Center contact retention | | |
| Axial force – Mating end | 18 | N mini |
| Axial force – Opposite end | 18 | N mini |
| Torque | NA | N.cm mini |

Recommended torque

| | | | |
|-----------|------------|-----------|------|
| Mating | N | 0 | N.cm |
| | TNC | 0 | N.cm |
| | - | 0 | N.cm |
| Panel nut | | NA | N.cm |

| | | |
|-------------|----------------|-------------|
| Mating life | 500 | Cycles mini |
| Weight | 33,0200 | g |

OTHER CHARACTERISTICS

Issue : 0812 B

In the effort to improve our products, we reserve the rights to make changes judged to be necessary.



RADIALL®