

NOTES

1. MATERIAL : BRASS , 0.45mm THICKNESS
2. PART NO. AND FINISH

PART NO.	MATERIAL NO.	FINISH	TRADE MARK
35725-2411	357252411	POST PLATED TIN	H MK2
35725-2410	357252410	POST PLATED TIN	MK2

H (TRADE MARK) : HIGH TENSION TIN-PLATED PRODUCT

3. APPLICABLE WIRE RANGE : AWG #18 - #14
4. RECOMMENDED LENGTH OF WIRE STRIP IS 6.0-6.8mm

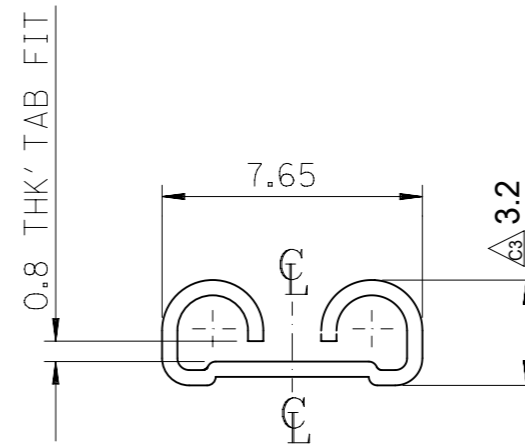

VIEW "A"

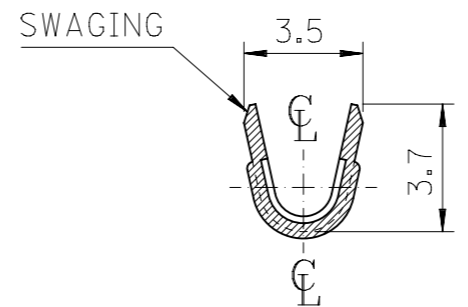

SEC' : B-B''

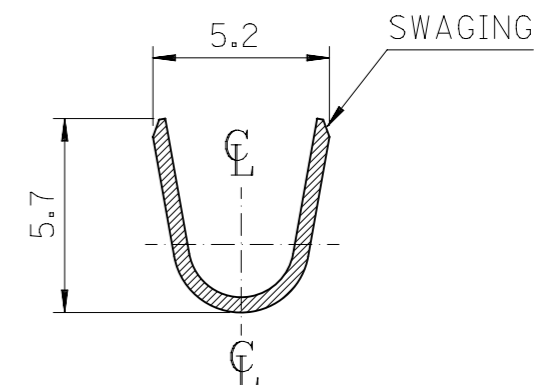

SEC' : C-C''

SYMBOLS		THIS DRAWING CONTAINS INFORMATION THAT IS PROPRIETARY TO MOLEX ELECTRONIC TECHNOLOGIES, LLC AND SHOULD NOT BE USED WITHOUT WRITTEN PERMISSION		CURRENT REV DESC:		molex	
▽ = 0	MM	SCALE	4.5:1	EC NO: 628958		.250 SLIP-ON	
▽ = 0	GENERAL TOLERANCES (UNLESS SPECIFIED)			DRWN: AKUMAR19		RECEPTACLE TERMINAL (SLOT TYPE)	
▽ = 0		MM	INCH	2018/08/21		PRODUCT CUSTOMER DRAWING	
▽ = 0	4 PLACES	±	±	CHK'D: GGA		DOCUMENT NUMBER	
▽ = 0	3 PLACES	±	±	2020/01/16		SD-35725-002	
▽ = 0	2 PLACES	± 0.2	±	APPR: GGA		DOC TYPE	
▽ = 0	1 PLACE	± 0.3	±	INITIAL REVISION:		DOC PART	
▽ = 0	0 PLACES	±	±	DRWN: HIMOON		REVISION	
▽ = 0	ANGULAR TOL		± °	2012/04/25		PSD 001 D	
▽ = 0	DRAFT WHERE APPLICABLE MUST REMAIN WITHIN DIMENSIONS			APPR:		MATERIAL NUMBER	
▽ = 0				THIRD ANGLE PROJECTION		CUSTOMER	
				DRAWING		SHEET NUMBER	
				A3-SIZE		1 OF 1	
				SERIES		GENERAL MARKET	
				35725		SEE TABLE	