

LOC		DIST		REVISIONS			
P	LTN	DESCRIPTION	DATE	DWN	APVD		
1		PROPOSED DESIGN	28JUN06	CZ	SY		
A1		REV PER ECR-06-020307	24JUG2006	CZ	SY		
A2		REV PER ECR-13-004638	20MAR2013	ML	SZ		

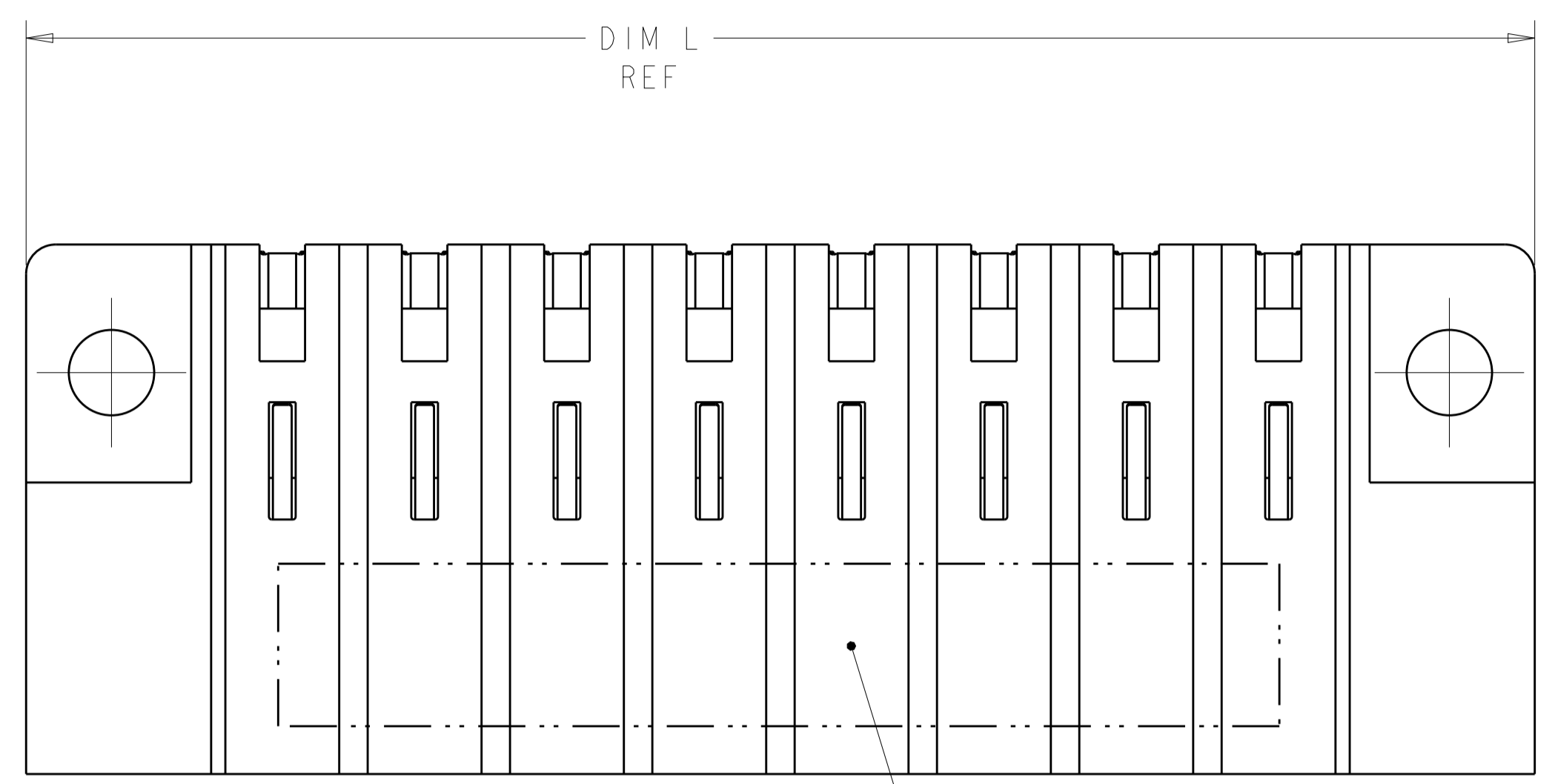

- ① "AMP", PART NUMBER, AND DATE CODE TO BE MARKED IN AREA SHOWN. PARTS UNDER 2.00 LONG MAY BE MARKED ON BOTH SIDES.
- ② MATERIAL: HOUSING - GLASS FILLED HIGH TEMP THERMO PLASTIC, UL94 V-0
POWER CONTACT - HIGH CONDUCTIVITY COPPER ALLOY
- ③ CONTACT PLATING: NOBLE METAL PLATING ON CONTACT FUNCTIONAL AREA OF POWER AND SIGNAL CONTACTS
- ④ MECHANICAL CONNECTOR KEEP OUT ZONE.
- ⑤ DATUM AND BASIC DIMENSIONS ESTABLISHED BY CUSTOMER.
- ⑥ PCB - ALL HOLE DIAMETERS ARE FINISHED HOLE SIZES.
- ⑦ PCB - .0453 +/- .0010 DRILLED HOLES PLATES WITH .0003 MIN Sn OVER .001 TO .003 PLATING TO ACHIEVE A .040 DIA. HOLE.
- ⑧ VARIABLE DIMENSION SHOW ON VIEW (SHEET 2).
- ⑨ NOT RELEASE FOR PRODUCTION.

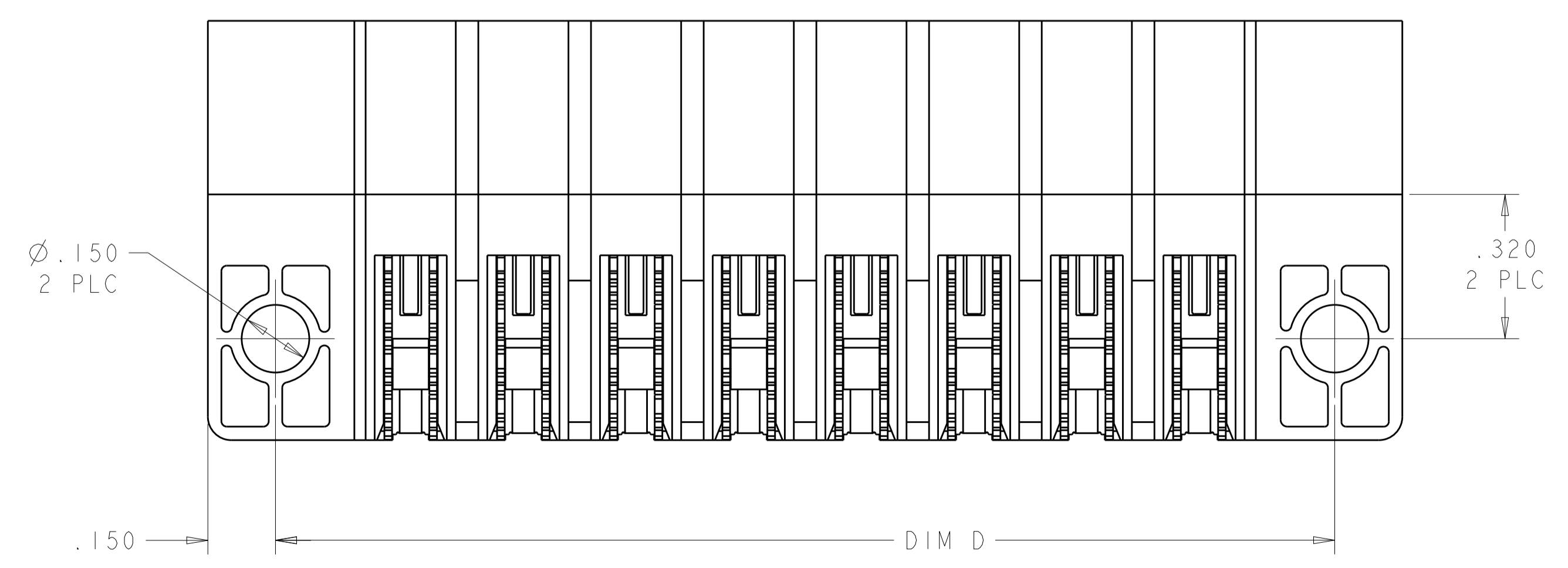
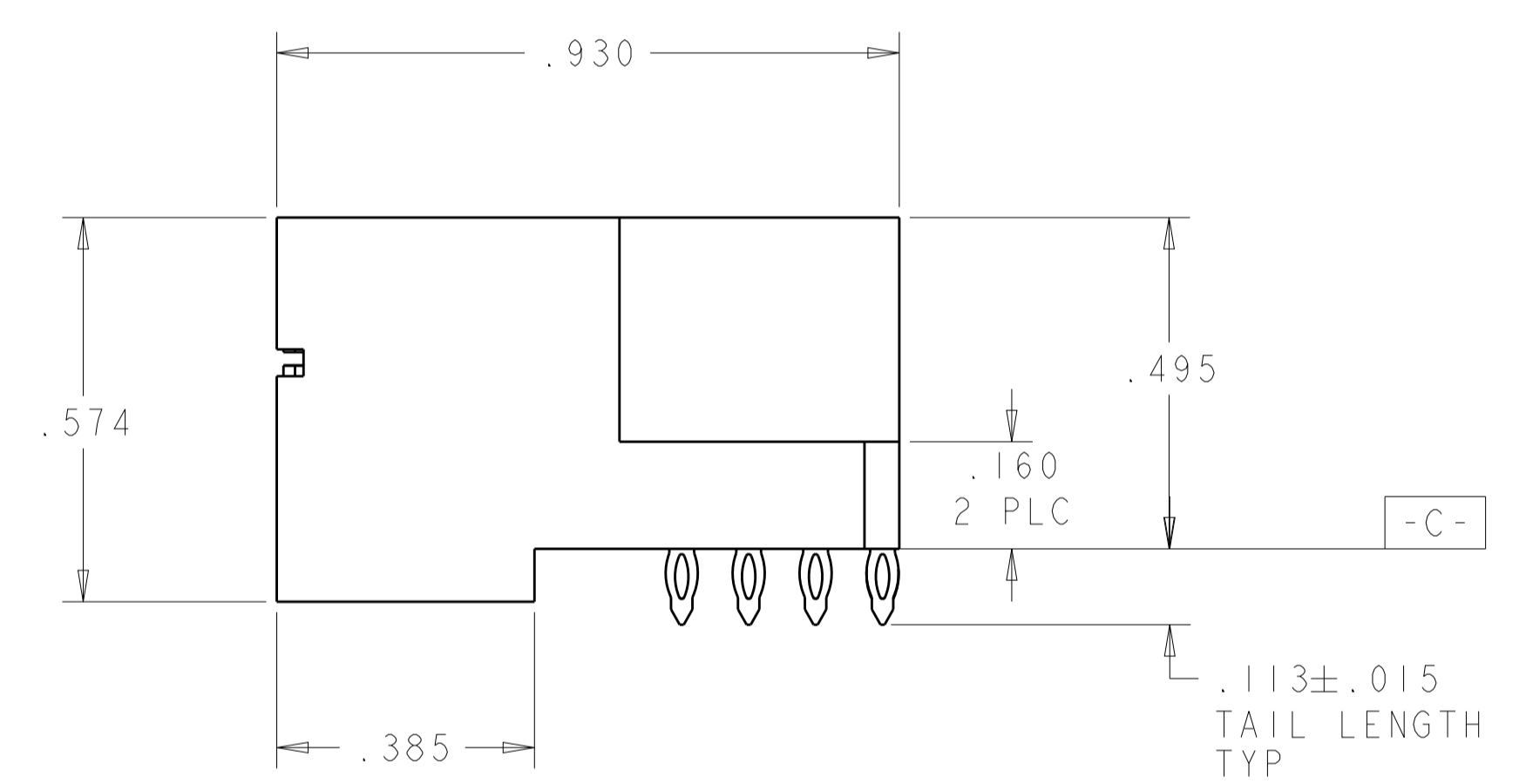
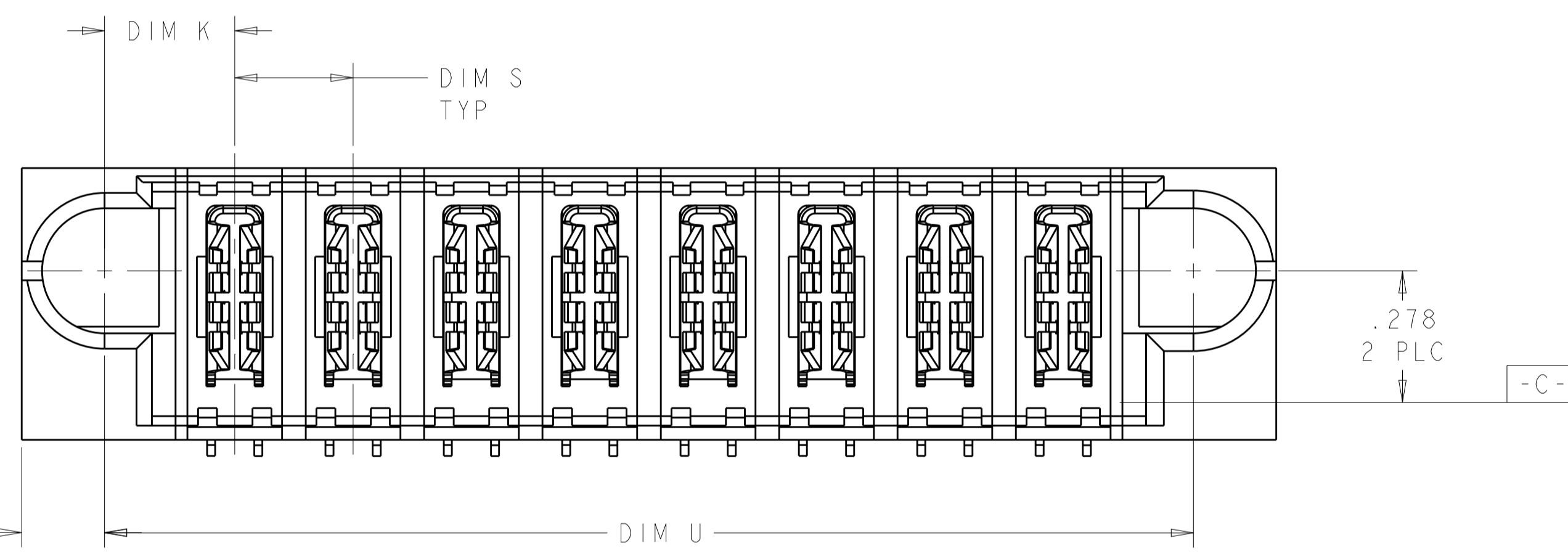

⑨	.250	2.550	2.600	.450	2.900	9P	6450623-3
	△	1.700	1.750	.425	2.050	6P	6450623-2
		.250	2.300	2.350	.450	8P	6450623-1
	DIM S	DIM U	DIM D	DIM K	DIM L	DESCRIPTION	PART NUMBER

<small>THIS DRAWING IS UNPUBLISHED. RELEASED FOR PUBLICATION. ALL RIGHTS RESERVED.</small> <small>THIS DRAWING IS UNPUBLISHED. RELEASED FOR PUBLICATION. ALL RIGHTS RESERVED.</small>		DWN: GECILY.ZHOU 28JUN06 CHK: S.ZHAO 28JUN06 APVD: S.YAO	Tyco Electronics incorporated Shanghai, P.R.China. 200233
DIMENSIONS: INCHES		TOLERANCES UNLESS OTHERWISE SPECIFIED: 0 PLC ±. 1 PLC ±.01 2 PLC ±.005 3 PLC ±.002 4 PLC ±.0020 ANGLES ±.7°	NAME: RIGHT ANGLE HEADER ASSEMBLY W/GUIDES PRODUCT SPEC: 108-1973 APPLICATION SPEC: SIZE: 114-13038 WEIGHT:
MATERIAL: FINISH:		CAGE CODE: A100779 DRAWING NO: 6450623 Customer Drawing	RESTRICTED TO:
AMP 4805 REV 31MAR2000		SCALE: 2:1	SHEET 1 OF 2 REV A2

LOC	DIST	REVISIONS			
P	LTN	DESCRIPTION	DATE	DWN	APVD
-	-	SEE SHEET 1	-	-	-

PART NUMBER	POWER							
	P1	P2	P3	P4	P5	P6	P7	P8
6450623-1	PT	PT	PT	PT	PT	PT	PT	PT
8P								

PART NUMBER	POWER					
	P1	P2	P3	P4	P5	P6
6450623-2	PT	PT	PT	PT	PT	PT
6P						

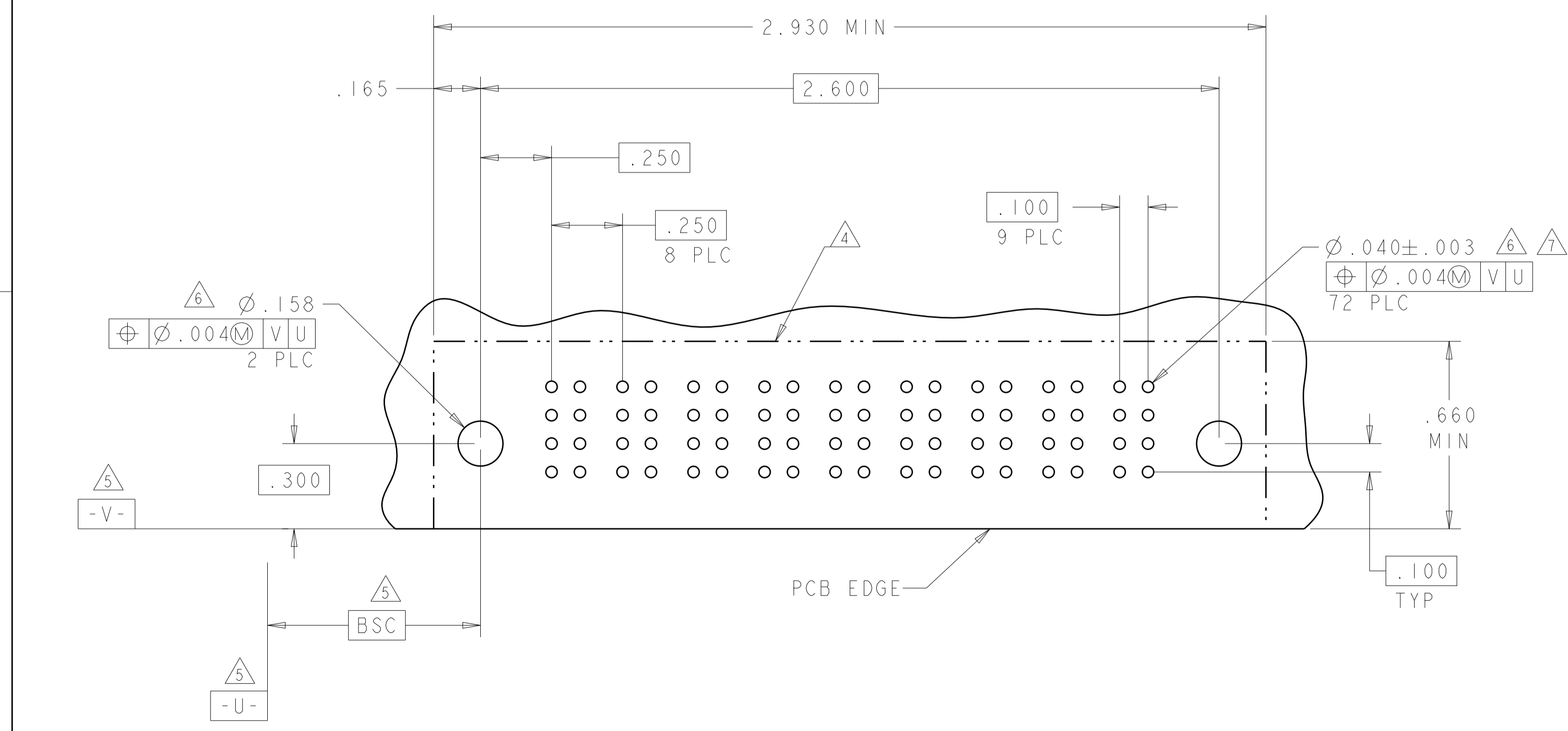
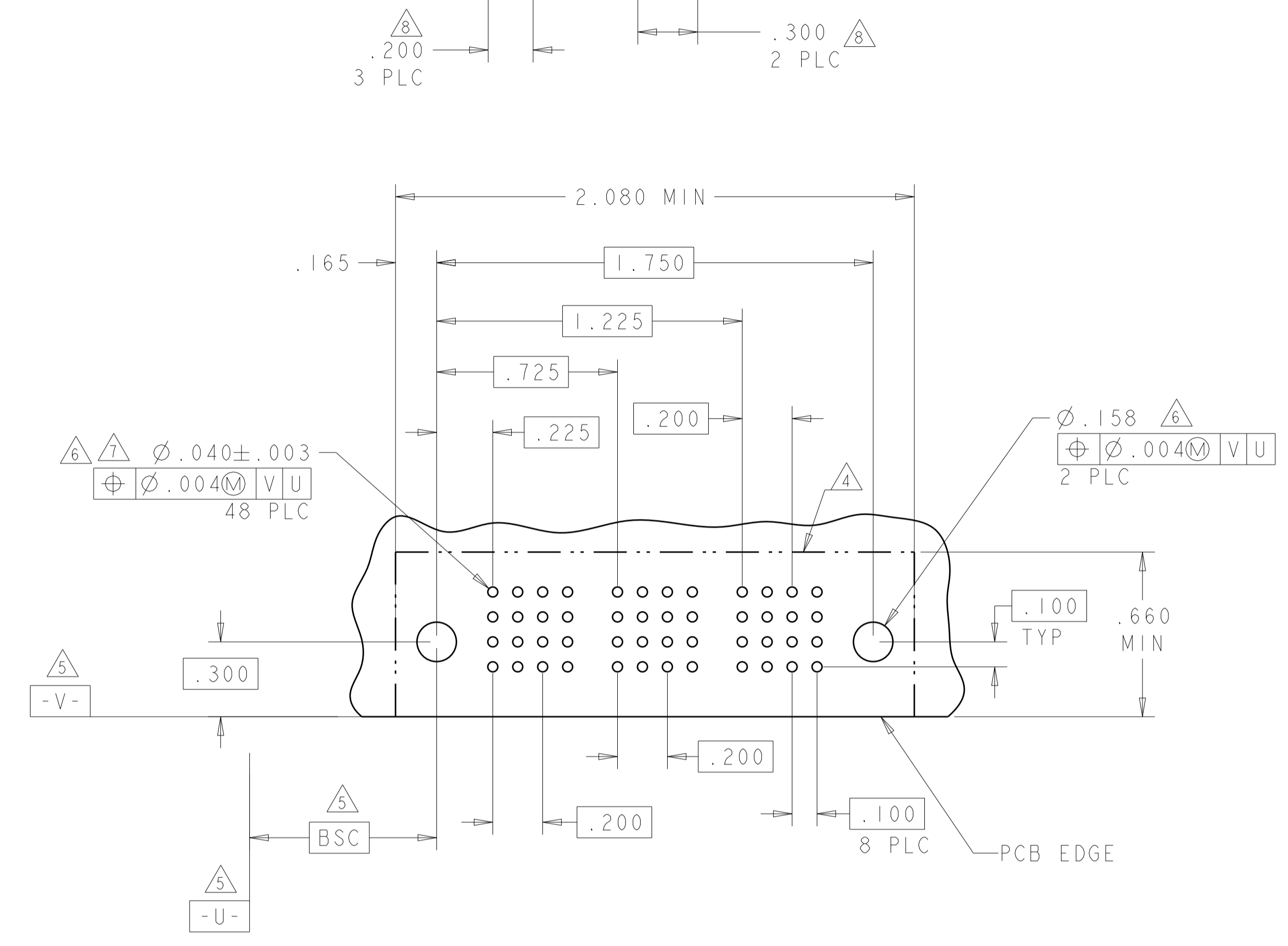
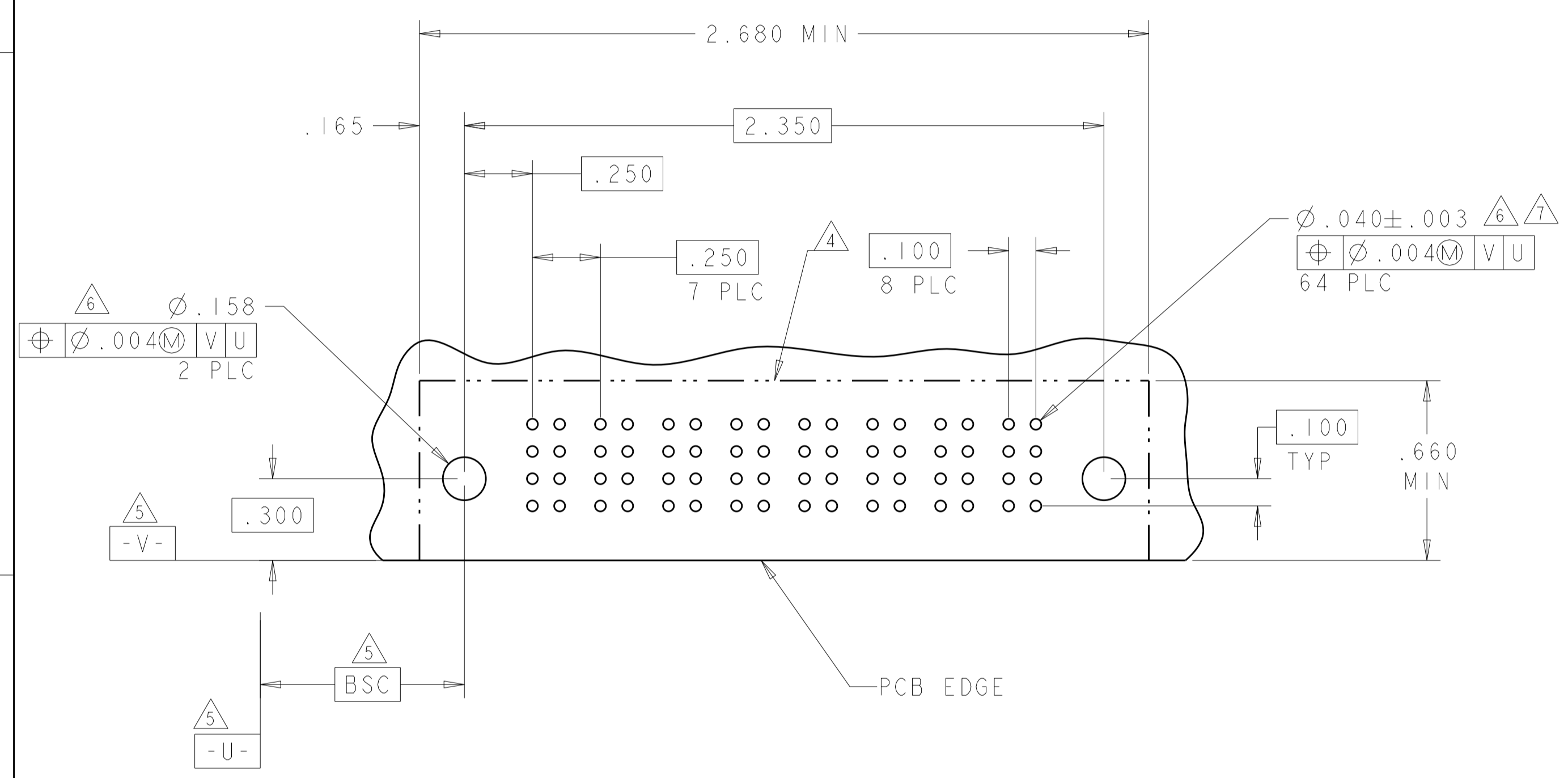

PART NUMBER	POWER								
	P1	P2	P3	P4	P5	P6	P7	P8	P9
6450623-3	PT	PT	PT	PT	PT	PT	PT	PT	PT
9P									

POWER CONTACT, STD	PT
DESCRIPTION	CODE

<small>THIS DRAWING IS UNPUBLISHED. RELEASED FOR PUBLICATION. IT IS THE PROPERTY OF TYCO ELECTRONICS CORPORATION. IT IS TO BE USED ONLY FOR THE PURPOSES AND IN THE QUANTITIES SPECIFIED IN THE ORDER. IT IS TO BE RETURNED TO TYCO ELECTRONICS CORPORATION IF NOT SO. CONTACT TYCO ELECTRONICS CORPORATION FOR THE LATEST REVISION.</small>		DWN: G. CECILY, ZHOU 28JUN06 CHK: S. ZHAO 28JUN06 APVD: S. YAO PRODUCT SPEC: 108-1973 APPLICATION SPEC: 114-13038 WEIGHT: - Customer Drawing	NAME: S. YAO Tyco Electronics incorporated Shanghai, P.R. China. 200233 RESTRICTED TO: A100779C=6450623 SCALE: 2:1 SHEET 2 OF 2 REV: A2
--	--	--	---