

THIS DRAWING IS UNPUBLISHED. RELEASED FOR PUBLICATION - N/A .
 © COPYRIGHT N/A By - ALL RIGHTS RESERVED.

LOC	DIST	REVISIONS					
DF	S0	P	LTR	DESCRIPTION	DATE	DWN	APVD
		E		REV PER ECO-12-007863	26APR12	PY	DE

- ① CAVITY LETTERS MARKED PER MIL-STD-130 WITH WHITE INK.
- ② AMP INFORMATION MARKED PER MIL-STD-130.
- ③ PIGTAILS ARE SOLDERED DIPPED.
- ④ INSULATION CUT, BUT NOT REMOVED.

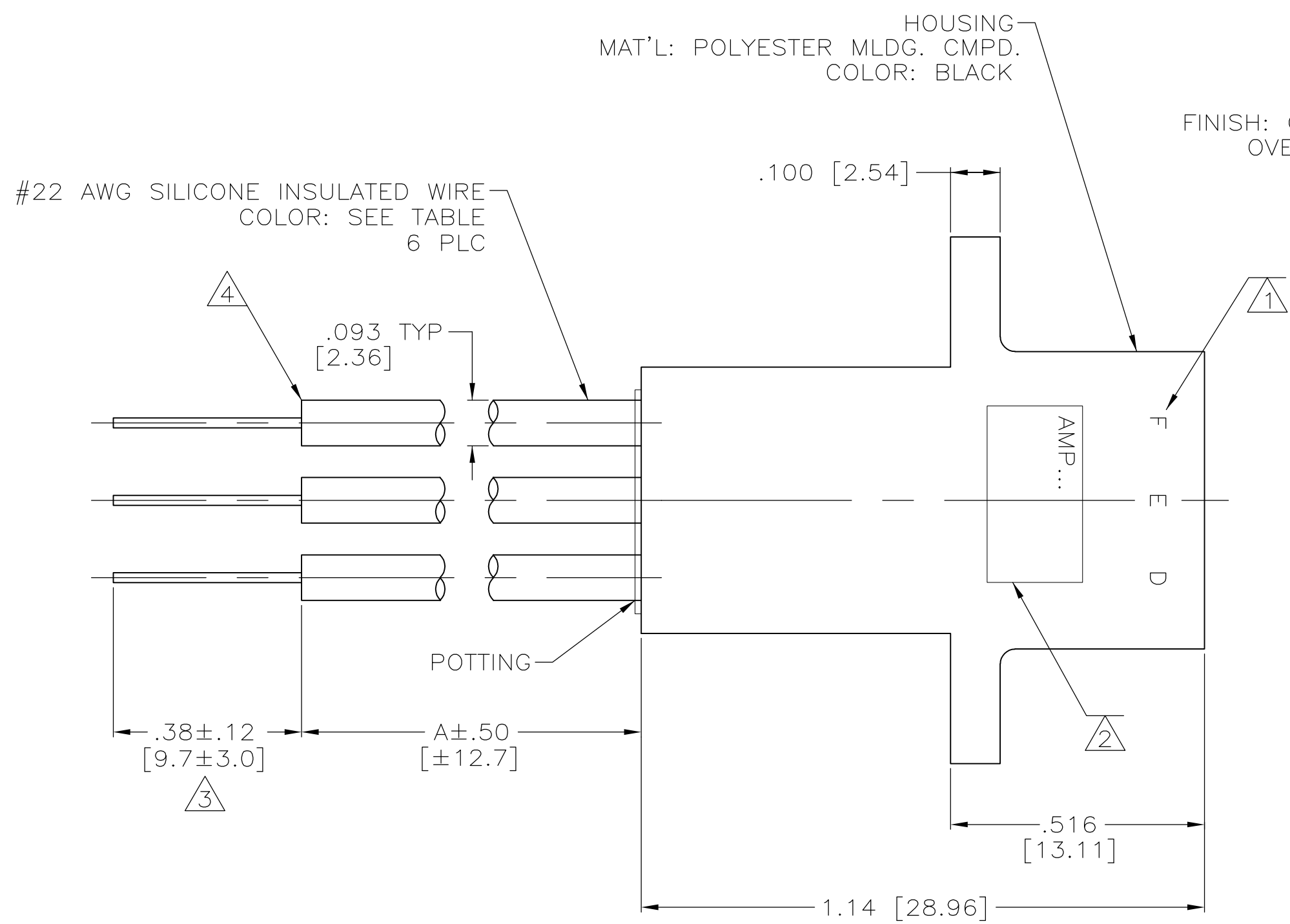

SOCKET CONTACT (QTY 6)
 MAT'L: LEADED COPPER
 FINISH: GOLD PLATED PER ASTM-B-488
 OVER NICKEL PER AMS-QQ-N-290

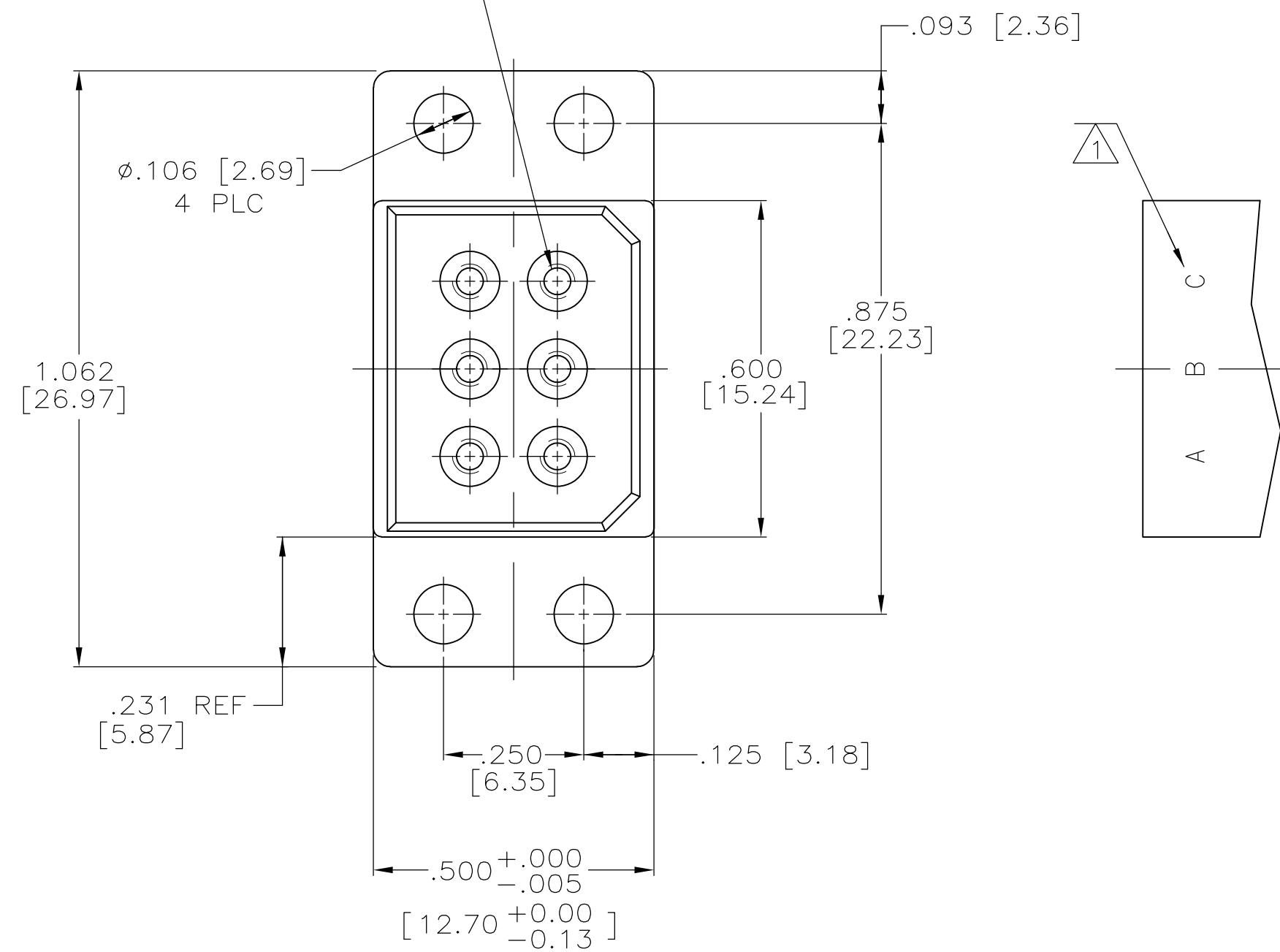

A	BROWN
B	RED
C	GREEN
D	BLUE
E	BLACK
F	WHITE

SCHEMATIC

	④	12.00 [304.8]	5-867473-1
OBSOLETE	③	36.00 [914.4]	867473-3
OBSOLETE	③	24.00 [609.6]	867473-2
	③	12.00 [304.8]	867473-1
REMARKS		"A" DIM	PART NO.

THIS DRAWING IS A CONTROLLED DOCUMENT.		DWN	C.C.THOMAS	31-MAY-00	 TE Connectivity	
DIMENSIONS: INCHES [mm]		CHK	D.EABY	31-MAY-00		
TOLERANCES UNLESS OTHERWISE SPECIFIED:		APVD	D.EABY	31-MAY-00		
0 PLC ± - 1 PLC ± - 2 PLC ± .03 [0.8] 3 PLC ± .015 [0.38] 4 PLC ± - ANGLES ± - FINISH SEE TABLE		PRODUCT SPEC				
MATERIAL	SEE TABLE	APPLICATION SPEC			NAME	RCPT ASSY 6 POSN WITH FLYING LEADS LGH
		WEIGHT	-		SIZE	A2
		CUSTOMER DRAWING			CAGE CODE	00779
		SCALE	4:1		DRAWING NO	C=867473
		SHEET	1 of 1		RESTRICTED TO	-
		REV	E			