

5

4

3

2

1

SPECIFICATION

Mating Cycles	500
Filter type	C
Capacitance	1000pf±20%
Working Voltage	100v
Current Rating	7.5A
Insulation Resistance	>1GΩ

FREQUENCY (MHz)	ATTENUATION (dB)
5	1dB
10	3dB
50	12dB
100	20dB
500	34dB
1000	30dB

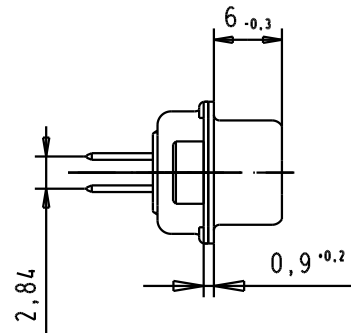
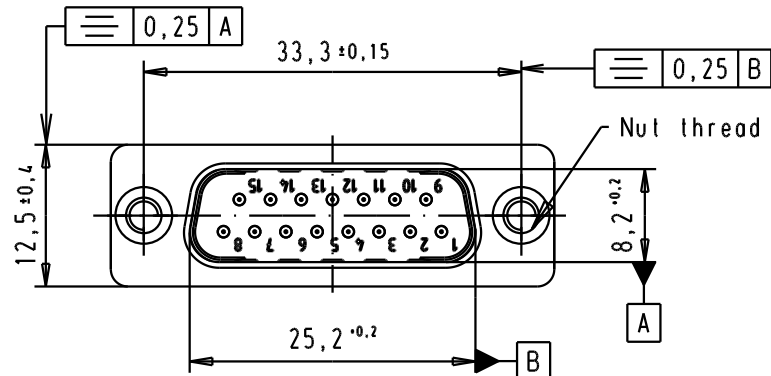

PCB Layout, Component side

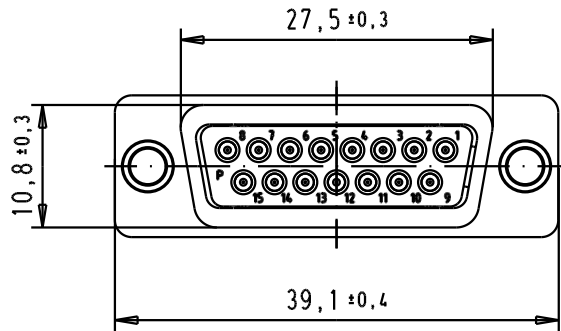
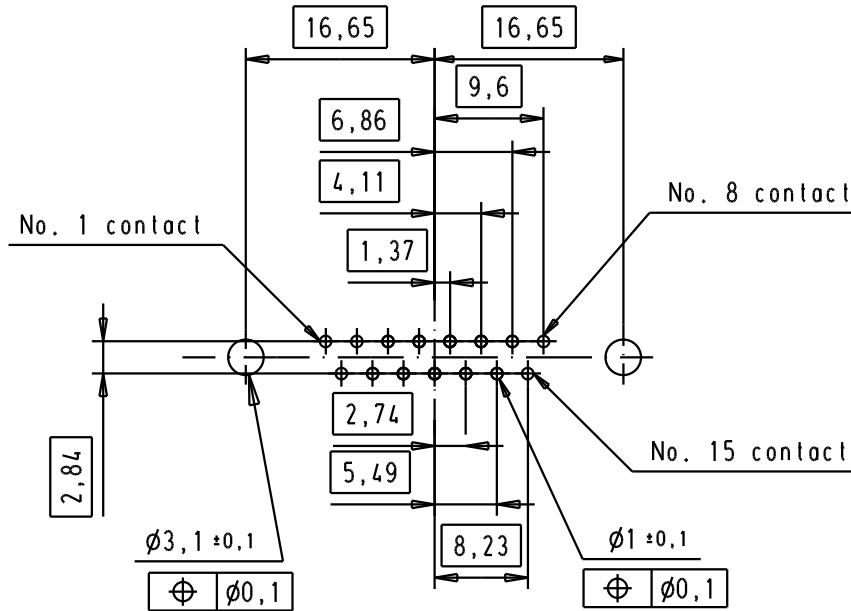
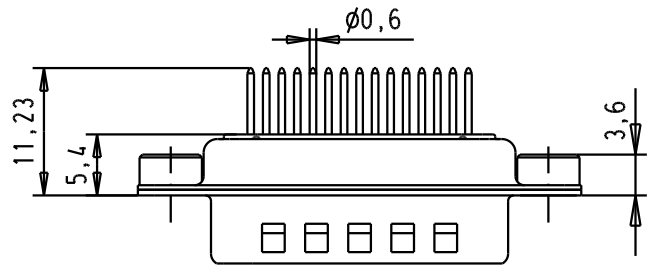

D

C

B

A

					Dat.		Name		<p>All Dim. in mm Orig. Size DIN A 4</p>	<p>D-Sub, male, straight, 15 Poles, solder pins, tin plated shell with dimples and clinch nuts</p>	<p>No?Ms lab/ Scale</p> <p>1.5:1</p>		
					Detail.		8- JUL -02					CV	
					Insp.								
					Stand.								
09642227238		M3		33079		29/08/05		JMDR				<p>TB 0964222723x</p>	
09642227237		UNC 4-40		31058		8- JUL -02		CV					
Part number		Nut thread		Mod.		Dat.		Name					
							HARTING EURL		F-95972 Paris		Sub.		
										Blatt/ Page		3 / 3	