

ACTUATOR CLOSE

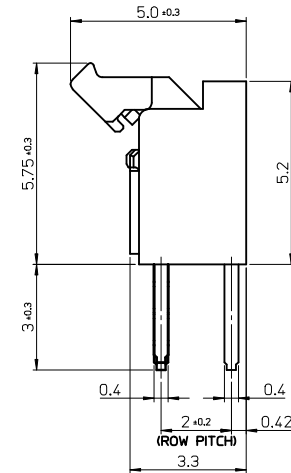

ACTUATOR OPEN  
DELIVERY POSITION

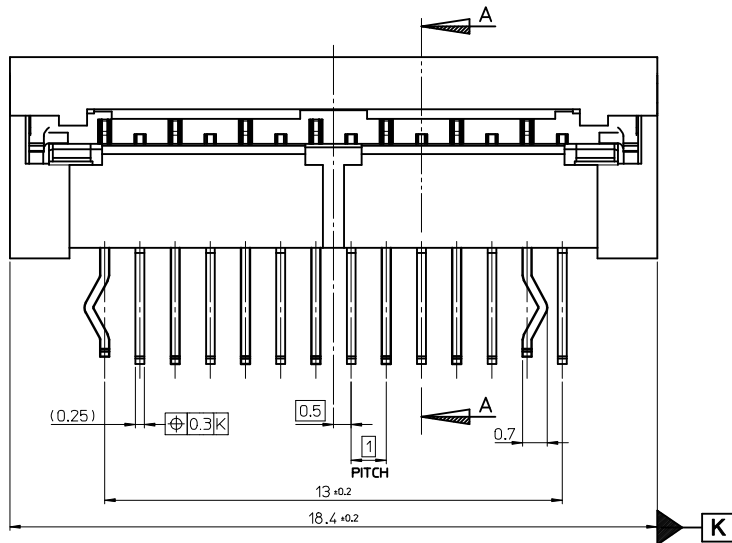
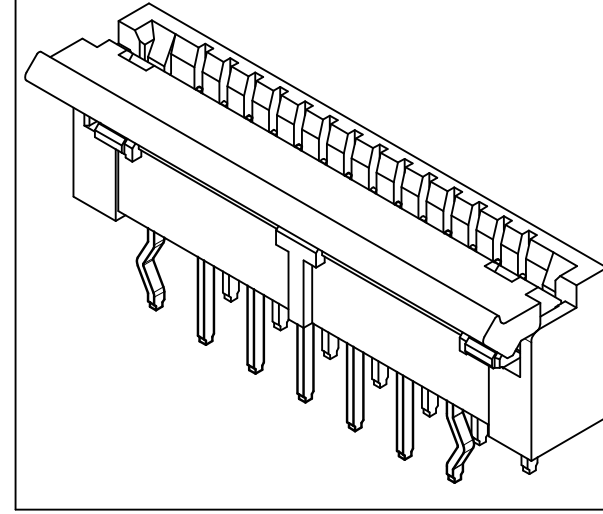
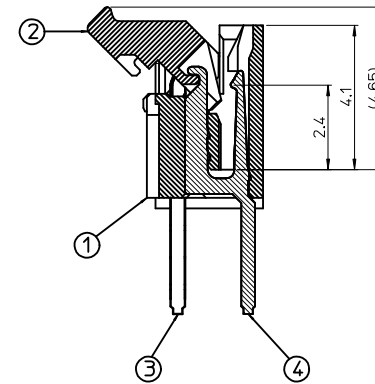

SECTION A-A

<PRODUCT NO.>

1041781418	14
ORDER NO.	CKT

NOTE

1. FINISH : 1.0 MIN TIN PLATING OVER NI.
2. DELIVERY POSITION : ACTUATOR OPEN
3. PACKING : TRAY

NO	PART NAME	Q'TY	MATERIAL	REMARKS
1	HOUSING	1	LCP, UL94V-0	NATURAL
2	ACTUATOR	1	PA46, GF 50%, UL94V-0	BLACK
3	EVEN TERMINAL	7	PHOSPHOR BRONZE, 0.25T	TIN OVER Ni
4	ODD TERMINAL	7	PHOSPHOR BRONZE, 0.25T	TIN OVER Ni

REVISED EC NO: KOR2014-0073 DRW:KYMHWANG 2013/11/26 CHKD: APPR:YSKIM02 2013/11/29 REV DESCRIPTION	QUALITY SYMBOLS	GENERAL TOLERANCES (UNLESS SPECIFIED)	DIMENSION STYLE	SCALE	DESIGN UNITS	THIRD ANGLE PROJECTION																																																																
	$\nabla=0$ $\nabla=0.2$	<table border="1"> <tr> <th></th> <th>mm</th> <th>INCH</th> </tr> <tr> <td>4 PLACES</td> <td>± ---</td> <td>± ---</td> </tr> <tr> <td>3 PLACES</td> <td>± ---</td> <td>± ---</td> </tr> <tr> <td>2 PLACES</td> <td>± 0.25</td> <td>± ---</td> </tr> <tr> <td>1 PLACE</td> <td>± 0.3</td> <td>± ---</td> </tr> </table>		mm	INCH	4 PLACES	± ---	± ---	3 PLACES	± ---	± ---	2 PLACES	± 0.25	± ---	1 PLACE	± 0.3	± ---	<table border="1"> <tr> <th>mm</th> <th>INCH</th> </tr> <tr> <td>± 0.1</td> <td>± 0.004</td> </tr> <tr> <td>± 0.2</td> <td>± 0.008</td> </tr> <tr> <td>± 0.3</td> <td>± 0.012</td> </tr> <tr> <td>± 0.4</td> <td>± 0.016</td> </tr> <tr> <td>± 0.5</td> <td>± 0.020</td> </tr> <tr> <td>± 0.6</td> <td>± 0.024</td> </tr> <tr> <td>± 0.8</td> <td>± 0.032</td> </tr> <tr> <td>± 1.0</td> <td>± 0.040</td> </tr> <tr> <td>± 1.2</td> <td>± 0.048</td> </tr> <tr> <td>± 1.5</td> <td>± 0.060</td> </tr> <tr> <td>± 2.0</td> <td>± 0.080</td> </tr> <tr> <td>± 2.5</td> <td>± 0.100</td> </tr> <tr> <td>± 3.0</td> <td>± 0.120</td> </tr> <tr> <td>± 4.0</td> <td>± 0.160</td> </tr> <tr> <td>± 5.0</td> <td>± 0.200</td> </tr> <tr> <td>± 6.0</td> <td>± 0.240</td> </tr> <tr> <td>± 8.0</td> <td>± 0.320</td> </tr> <tr> <td>± 10.0</td> <td>± 0.400</td> </tr> </table>	mm	INCH	± 0.1	± 0.004	± 0.2	± 0.008	± 0.3	± 0.012	± 0.4	± 0.016	± 0.5	± 0.020	± 0.6	± 0.024	± 0.8	± 0.032	± 1.0	± 0.040	± 1.2	± 0.048	± 1.5	± 0.060	± 2.0	± 0.080	± 2.5	± 0.100	± 3.0	± 0.120	± 4.0	± 0.160	± 5.0	± 0.200	± 6.0	± 0.240	± 8.0	± 0.320	± 10.0	± 0.400	<table border="1"> <tr> <th>DATE</th> <th>TITLE</th> </tr> <tr> <td>DRAWN BY</td> <td>SMK1M01</td> </tr> <tr> <td>DATE</td> <td>2013/10/15</td> </tr> <tr> <td>CHECKED BY</td> <td></td> </tr> <tr> <td>DATE</td> <td></td> </tr> </table>	DATE	TITLE	DRAWN BY	SMK1M01	DATE	2013/10/15	CHECKED BY		DATE		1:1	METRIC	THIRD ANGLE PROJECTION
		mm	INCH																																																																			
	4 PLACES	± ---	± ---																																																																			
3 PLACES	± ---	± ---																																																																				
2 PLACES	± 0.25	± ---																																																																				
1 PLACE	± 0.3	± ---																																																																				
mm	INCH																																																																					
± 0.1	± 0.004																																																																					
± 0.2	± 0.008																																																																					
± 0.3	± 0.012																																																																					
± 0.4	± 0.016																																																																					
± 0.5	± 0.020																																																																					
± 0.6	± 0.024																																																																					
± 0.8	± 0.032																																																																					
± 1.0	± 0.040																																																																					
± 1.2	± 0.048																																																																					
± 1.5	± 0.060																																																																					
± 2.0	± 0.080																																																																					
± 2.5	± 0.100																																																																					
± 3.0	± 0.120																																																																					
± 4.0	± 0.160																																																																					
± 5.0	± 0.200																																																																					
± 6.0	± 0.240																																																																					
± 8.0	± 0.320																																																																					
± 10.0	± 0.400																																																																					
DATE	TITLE																																																																					
DRAWN BY	SMK1M01																																																																					
DATE	2013/10/15																																																																					
CHECKED BY																																																																						
DATE																																																																						
		DRAFT WHERE APPLICABLE MUST REMAIN WITHIN DIMENSIONS	SEE TABLE	1.0 PITCH FFC CONNECTOR VERTICAL & DIP TYPE ASS'Y 14P																																																																		
			APPROVED BY	DATE	MOLEX INCORPORATED DOCUMENT NO. SD-104178-001																																																																	
			YSK1M02	2013/11/12	SHEET NO. 1 OF 2																																																																	
			THIS DRAWING CONTAINS INFORMATION THAT IS PROPRIETARY TO MOLEX INCORPORATED AND SHOULD NOT BE USED WITHOUT WRITTEN PERMISSION																																																																			

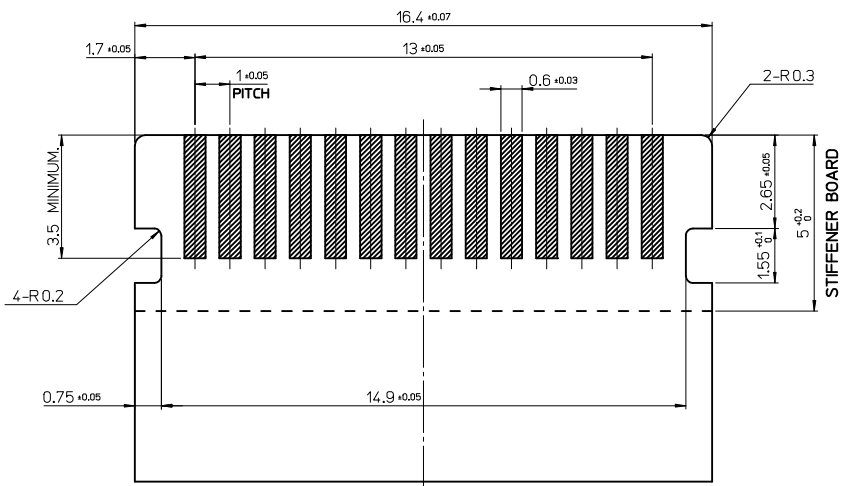

CONTACT SIDE

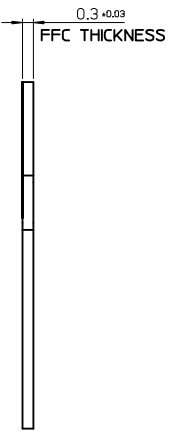

FFC THICKNESS

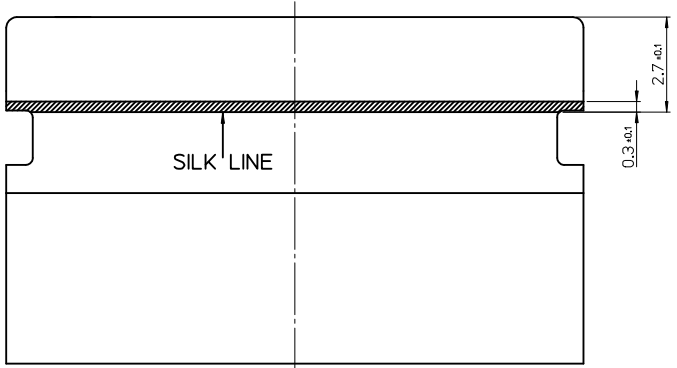

BACK SIDE

1. RECOMMENDED FFC SPECIFICATION  
WHEN FFC FULLY INSERT →  
SILK LINE : INVISIBLE

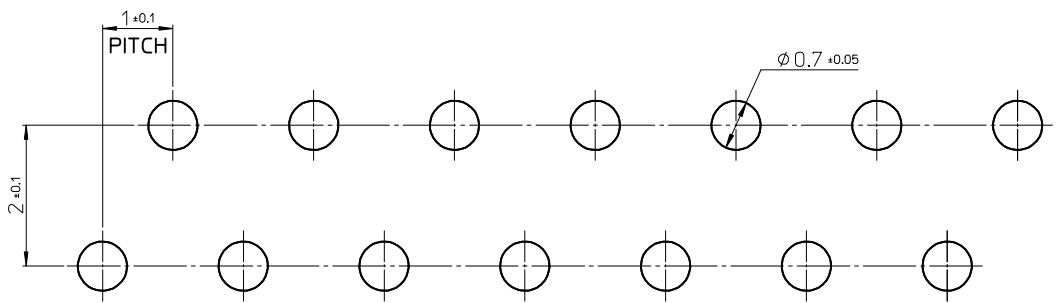

RECOMMENDED PCB PATTERN LAYOUT

PCB THICKNESS : 1.6T

<PRODUCT NO.>

1041781418	14
ORDER NO.	CKT

<b>REVISED</b> EC NO: KOR2014-0073 DRAWN: KYHWANG 2013/11/26 CHKD: APPR: YSK1M02 2013/11/29 REV:	QUALITY SYMBOLS	GENERAL TOLERANCES (UNLESS SPECIFIED)	DIMENSION STYLE	SCALE	DESIGN UNITS	THIRD ANGLE PROJECTION																		
	▽=0 ▽=0	<table border="1"> <tr> <th></th> <th>mm</th> <th>INCH</th> </tr> <tr> <td>4 PLACES</td> <td>± 0.15</td> <td>± 0.006</td> </tr> <tr> <td>3 PLACES</td> <td>± 0.20</td> <td>± 0.008</td> </tr> <tr> <td>2 PLACES</td> <td>± 0.25</td> <td>± 0.010</td> </tr> <tr> <td>1 PLACE</td> <td>± 0.30</td> <td>± 0.012</td> </tr> <tr> <td colspan="3">ANGULAR ± 1°</td> </tr> </table>		mm	INCH	4 PLACES	± 0.15	± 0.006	3 PLACES	± 0.20	± 0.008	2 PLACES	± 0.25	± 0.010	1 PLACE	± 0.30	± 0.012	ANGULAR ± 1°			<b>MM ONLY</b> DRAWN BY: SMK1M01 DATE: 2013/10/15 CHECKED BY: DATE:	1:1	METRIC	TITLE: 1.0 PITCH FFC CONNECTOR VERTICAL & DIP TYPE ASS'Y 14P MOLEX INCORPORATED DOCUMENT NO. SD-104178-001
		mm	INCH																					
	4 PLACES	± 0.15	± 0.006																					
3 PLACES	± 0.20	± 0.008																						
2 PLACES	± 0.25	± 0.010																						
1 PLACE	± 0.30	± 0.012																						
ANGULAR ± 1°																								
DRAFT WHERE APPLICABLE MUST REMAIN WITHIN DIMENSIONS	APPROVED BY: YSK1M02 DATE: 2013/11/12 MATERIAL NO.	SEE TABLE SIZE: A2	THIS DRAWING CONTAINS INFORMATION THAT IS PROPRIETARY TO MOLEX INCORPORATED AND SHOULD NOT BE USED WITHOUT WRITTEN PERMISSION	SHEET NO. 2 OF 2																				