

THIS DRAWING IS A CONTROLLED DOCUMENT

RELEASED FOR PUBLICATION JULY 1988  
BY AMP INCORPORATED ALL RIGHTS RESERVED  
COPYRIGHT 1988

DIST 66 \* Trademark of AMP Incorporated

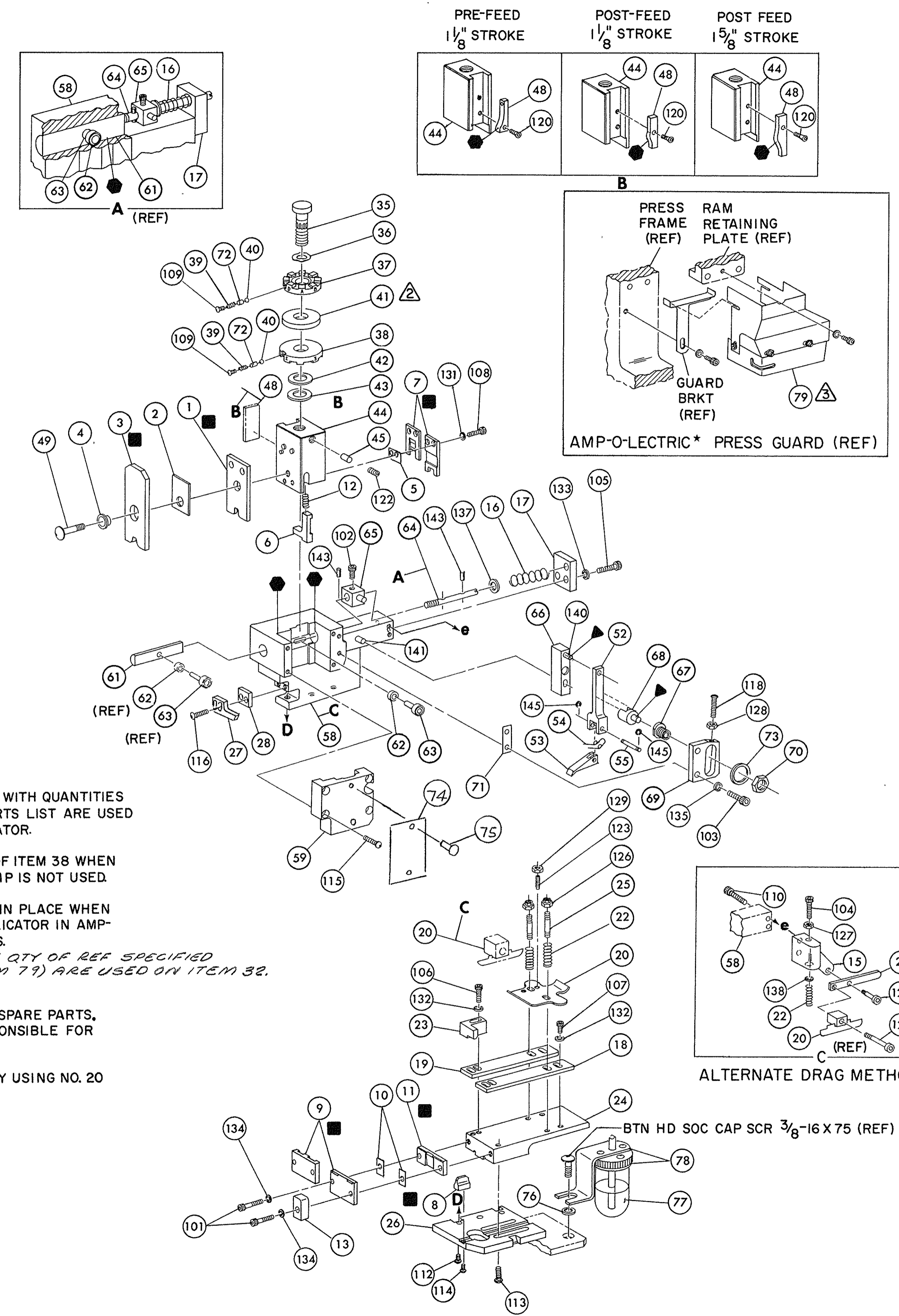

- NOTES:**
- ONLY THE ITEMS WITH QUANTITIES SPECIFIED ON PARTS LIST ARE USED ON THIS APPLICATOR.
  - USED IN PLACE OF ITEM 38 WHEN INSULATION CRIMP IS NOT USED.
  - GUARD MUST BE IN PLACE WHEN OPERATING APPLICATOR IN AMP-O-LECTRIC PRESS.
  - PARTS WITH QTY OF REF SPECIFIED (EXCEPT ITEM 79) ARE USED ON ITEM 32.
- KEY:**
- RECOMMENDED SPARE PARTS, CUSTOMER RESPONSIBLE FOR REPLACEMENT.
  - LUBRICATE DAILY USING NO. 20 MACHINE OIL.
  - GREASE LIGHTLY.

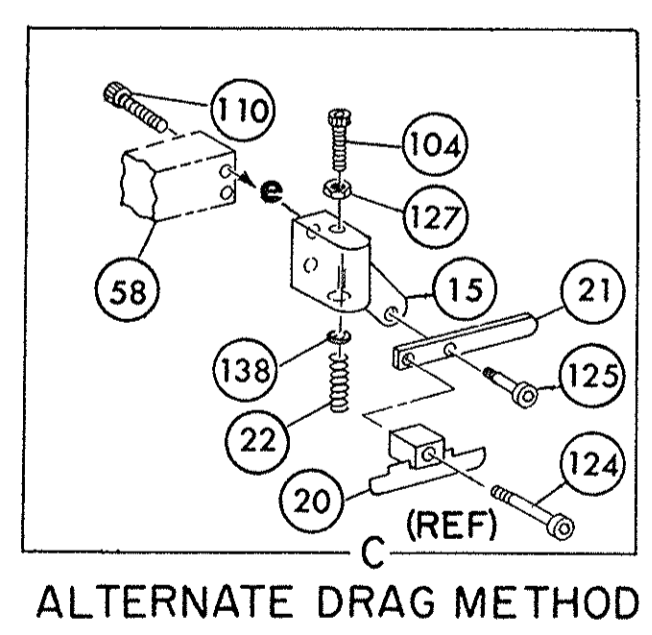

REF	QTY	PART NO	DESCRIPTION	ITEM NO
REF		21045-3	RING, RETAINING 'C' (.187 DIA) FEED PIN	145
REF		5-21028-1	PIN, SLOT SPG (.12 DIA X .50) FD ADJ ROD	143
REF		1-21030-7	PIN, DOWEL (.187 DIA X 1.50) HOUSING	141
REF		1-21030-1	PIN, DOWEL (.187 DIA X .50) LEVER	140
REF		22260-5	WASHER, FLAT (NO 6) DRAG SPRING	139
REF		21899-4	WASHER, FLAT (5/16 DIA) SCR ADJ	137
REF		21024-5	WASHER, LOCK (NO 10) FEED ADJ PLATE	136
2	1	21024-5	WASHER, LOCK (NO 10) SHEAR PLATES	135
REF		21024-5	WASHER, LOCK (NO 10) FEED ROD GUIDE	134
4		21024-4	WASHER, LOCK (NO 8) STRIP GUIDE	133
2		21024-4	WASHER, LOCK (NO 8) SHEAR BLADE	132
2	1	690191-1	PLUG, NYLON	131
2	1	455674-1	RAM	130
REF		21018-4	NUT, HEX MACH (4-40) DRAG	129
REF		21068-5	NUT, HEX MACH (6-32) FD ADJ PLATE	128
REF		21018-7	NUT, HEX MACH (10-32) DRAG SPRING	127
2		21022-2	NUT, HEX SELF-LKG (8-32) DRAG STUD	126
REF		5-21004-7	SCR, SKT HD SHLD (250 DIA X .25) DRAG ARM	125
REF		21004-5	SCR, SKT HD SHLD (250 DIA X 1.00) DRAG	124
2	1	4-21078-8	SCR, SKT SET OVAL POINT (4-40 X .75) DRAG	123
1		21009-2	SCR, SKT SET (1/4-20 X 25) (LOC-WEL) RAM	122
1		2-21003-0	SCR, FLAT HD SKT CAP (6-32 X .50) CAM	121
REF		3-21064-2	SCR, RD HD MACH (6-32 X 1.50) FEED ADJ	120
2		2-21002-2	SCR, BTN HD SKT CAP (8-32 X .50) STRIPPER	118
REF		2-21002-9	SCR, BTN HD SKT CAP (10-32 X .75) HSG CAP	117
1		22733-8	SCR, BTN HD SKT CAP (8-32 X .38) (LOC-WEL) ANVIL	116
4		3-21002-3	SCR, BTN HD SKT CAP (1/4-20 X .50) STR GDE PL	115
REF		1-24073-9	SCR, BTN HD SKT CAP (1/4-20 X .75) BASE PL	114
REF		2-21000-4	SCR, SKT HD CAP (6-32 X 1.00) DRAG ADAPTOR	113
2		23030-1	SCR, SKT HD CAP (6-32 X .25) (LOC-WEL) CP DISC	112
2		2-21000-7	SCR, SKT HD CAP (8-32 X .50) SHEAR BLADE	111
3		2-21000-6	SCR, SKT HD CAP (8-32 X .38) STRIP GUIDE	110
1		2-21000-6	SCR, SKT HD CAP (8-32 X .38) STRIP GUIDE	109
REF		3-21000-7	SCR, SKT HD CAP (10-32 X .75) FD ROD GUIDE	108
REF		3-21000-9	SCR, SKT HD CAP (10-32 X 1.00) DRAG SPRING	107
REF		3-21000-6	SCR, SKT HD CAP (10-32 X .62) FD ADJ PLATE	106
REF		3-21000-4	SCR, SKT HD CAP (10-32 X .38) PIVOT BLK	105
2		3-21000-8	SCR, SKT HD CAP (10-32 X .88) SHEAR PLATE	104
REF		455745-1	GUARD, WINDOW	103
REF		465184-9	LUBRICATOR ASSY	102
REF		455985-1	OIL, LUBRICATING	101
REF		454406-1	SPACER, LUB BRACKET	79
2		21017-2	SCR, DRIVE (#2 X .19) ID PLATE	78
1		461264-1	PLATE, ID	77
REF		458109-1	WASHER, FLAT (SPECIAL)	76
2		690603-1	SPRING, ASSIST	75
REF		690517-1	SPACER	74
REF		22594-8	NUT, HEX	73
REF		240628-1	PLATE, ADJ	72
REF		240626-1	SHAFT, PIVOT	71
REF		240633-1	BUSHING	70
REF		455680-1	LEVER, INTERMEDIATE	69
REF		240629-1	BLOCK, PIVOT	68
REF		240632-2	SCREW, ADJ	67
REF		240659-3	PIN, CAM ROLLER	66
REF		240658-1	CAM, ROLLER	65
REF		454398-1	ROD, FEED	64

QTY	PART NO	DESCRIPTION	ITEM NO
62		CRIMPING DATA	
61	A	PAD LTR	60392
60	B	CRIMP HEIGHT	60393
	C	WIRE SIZE	60394
	D	WIRE STRIP LENGTH	
		CRIMP SIZE TYPE FEED APPL INST	
		WIRE .110 F	A18039
		INSUL .155 0	
		WIRE RANGE 20-16	
		INSULATION RANGE .100-140	
		PRESS NO	
		REMARKS	
			AMPOMATOR

REMARKS	NO	REV
APPL USED ON MACHINE PART NO	MACH SERIAL NO	DISTRIBUTION
CUSTOMER NAME	APPL SERIAL NO	ORIGINAL
ADDRESS	PURCHASE ORDER	CUSTOMER COPY
CITY	ENG APP	FIELD ENG COPY

REV	DATE	DESCRIPTION
1	0150-0849-00	CE 12-00 SET UP PAGE 10-1
2	0150-0447-75	CE 01/85 458638-1398
3	ECN A187628	DR 3-22-77 APP 3.22-77
4	REV PER ECN R24970	3-78
5	REV PER ECN R2453	3-78
6	REV PER ECN R1916	10-70
7	REV PER ECN R1811	10-70

AMP INCORPORATED Harrisburg, Pa.

MINIATURE QUICK CHANGE APPLICATOR

END FEED (RING & HOOP)

CUSTOMER AND ASSEMBLY DRAWING