

APPROVED: \_\_\_\_\_  
 DATE: \_\_\_\_\_ TITLE: \_\_\_\_\_

Rev	AWO #	Description	Date	Appr
-		RELEASED	5/19/08	
A		REVISED SPEC.	10/25/11	
B		REDRAWN	11/01/11	
C		REDRAWN	10/16/15	AY/TW
D		UPDATE SPEC.	11/5/18	AY/RC
E		UPDATE SPEC.	1/27/21	OW/EY
F		UPDATE CHART	8/5/22	SS

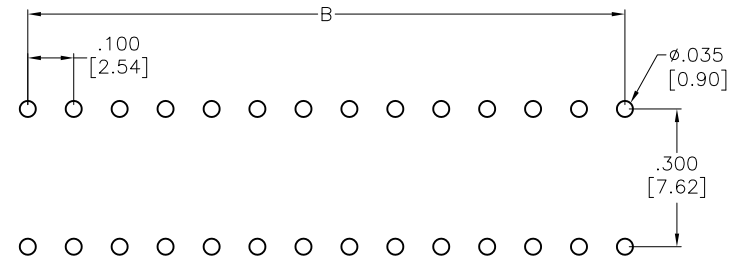

RECOMMENDED PCB LAYOUT

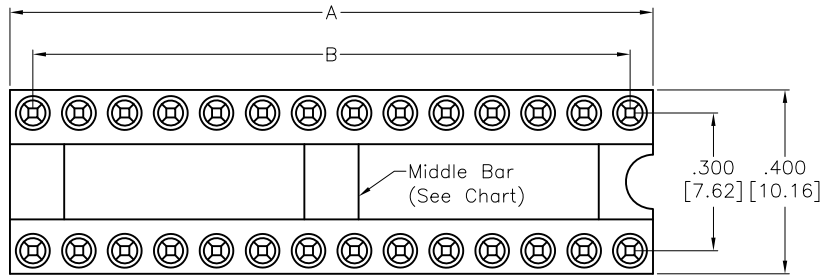
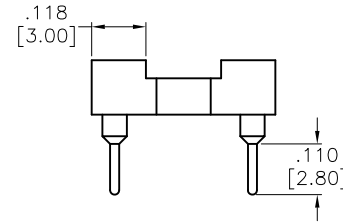
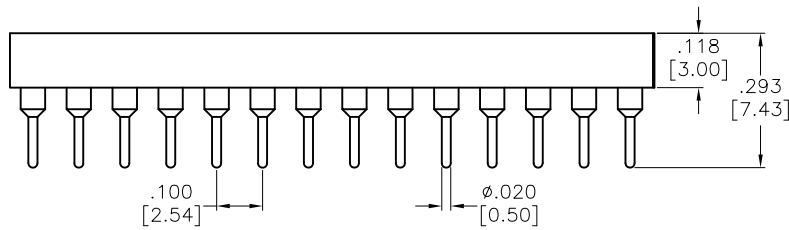

**SPECIFICATIONS:**  
 Material:  
 Insulator: (PPS) Hi-Temp Thermoplastic, rated UL 94V-0  
 Insulator color: Black  
 Pin (Outer Sleeve): Brass  
 Clip (Contact 4 finger): Beryllium Copper  
 Plating:  
 Inner contact: Gold flash over Nickel underplate  
 Outer sleeve: Tin over Nickel underplate overall  
 Electrical:  
 Operating voltage: 60VAC/DC  
 Current rating: 3 Amps/contact max.  
 Current resistance:  $\cong 4\text{m}\Omega$  / contact  
 Insulation resistance:  $\cong 1,000\text{M}\Omega$  at 100 V  
 Mechanical:  
 Operating temperature: Gold plated:  $-55^\circ\text{C}$  to  $+105^\circ\text{C}$   
 Tin plated:  $-40^\circ\text{C}$  to  $+105^\circ\text{C}$   
 Average insertion force:  $< 250\text{g}$   
 With steel pin of  $\varnothing.017$  [0.43mm]  
 Average withdrawal force:  $> 20\text{g}$  min.  
 With steel pin of  $\varnothing.017$  [0.43mm]  
 Mechanical life: 200 Cycle min.  
 Environmental:  
 Lead free, RoHS compliant



P/N	POSITION	A	B	MIDDLE BAR
ICM-306-1-GT-HT	6	.300 [7.62]	.200 [5.08]	WITHOUT
ICM-308-1-GT-HT	8	.400 [10.16]	.300 [7.62]	
ICM-310-1-GT-HT	10	.500 [12.70]	.400 [10.16]	
ICM-312-1-GT-HT	12	.600 [15.24]	.500 [12.70]	
ICM-314-1-GT-HT	14	.700 [17.78]	.600 [15.24]	
ICM-316-1-GT-HT	16	.800 [20.32]	.700 [17.78]	
ICM-318-1-GT-HT	18	.900 [22.86]	.800 [20.32]	WITH
ICM-320-1-GT-HT	20	1.000 [25.40]	.900 [22.86]	
ICM-324-1-GT-HT	24	1.200 [30.48]	1.100 [27.94]	
ICM-328-1-GT-HT	28	1.400 [35.56]	1.300 [33.02]	

UNLESS OTHERWISE SPECIFIED  
 ALL DIMENSIONS ARE INCHES [MM]  
 TOLERANCES: EXCEPT AS NOTED

INCHES		HOLES	
.X	$\pm .10$	$\varnothing X$	$\pm .10$
.XX	$\pm .020$	$\varnothing XX$	$\pm .015$
.XXX	$\pm .015$	$\varnothing XXX$	$\pm .010$

APPROVALS		DATE
DRAWN	SS	5/19/08
CHECKED		
APPROVED		

**ADAM TECH** 909 Rahway Avenue,  
 Union, NJ 07083  
 Phone: 908-687-5000  
 Fax: 908-687-5710

TITLE: **SCREW MACHINE IC SOCKET**  
**.300" ROW SPACING**

SIZE	PART NO.	REV.
X	ICM-3XX-1-GT-HT	F

REF: S00145C SCALE: NTS SHEET 1 OF 1