

ELECTRICAL CHARACTERISTICS	
PARAMETERS	MAX (Unless otherwise noted)
Storage Temperature Range	-55°C ~ +125°C
Frequency Stability Overall (1 hour after reflow)	±2.0 PPM
Frequency Stability Overall (including 20 years aging) ¹	±4.6 PPM
Vs Supply Voltage	±0.2 PPM
Vs Load (±10%)	±0.2 PPM
Supply Voltage (V _{DD})	3.3V ± 5%
Input Current (I _{DD})	6 mA
Rise Time (10% ~ 90% V _{DD}) (T _R)	5nS
Fall Time (90% ~ 10% V _{DD}) (T _F)	5nS
Output Symmetry (50% V _{DD})	45% ~ 55%
Output Voltage (HCMOS)	
Output Low (V _{OL})	10%V _{DD}
Output High (V _{OH})	90%V _{DD} Min
Output Load	15pF Nom
Start-up Time (T _S)	2 mS
V _c Input Impedance	100kohms Min
Phase Noise (12.8 MHz)	
@100Hz	-120dBc Typ.
@1kHz	-140dBc Typ.
@10kHz	-148dBc Typ.
Maximum Soldering Temp / Time	260°C / 10 Seconds
Moisture Sensitivity Level (MSL)	1
Termination Finish	Au

AVAILABLE FREQUENCIES		
10.000MHz	12.800MHz	19.200MHz
19.440MHz	20.000MHz	24.576MHz
25.000MHz	26.000MHz	30.720MHz
38.880MHz	40.000MHz	

¹ Inclusive of initial frequency tolerance, operating temperature range, 20 years aging, Input voltage change, load change, shock and vibration.

The above specifications, having been carefully prepared and checked, is believed to be accurate at the time of publication; however, no responsibility is assumed by Fox Electronics for inaccuracies.

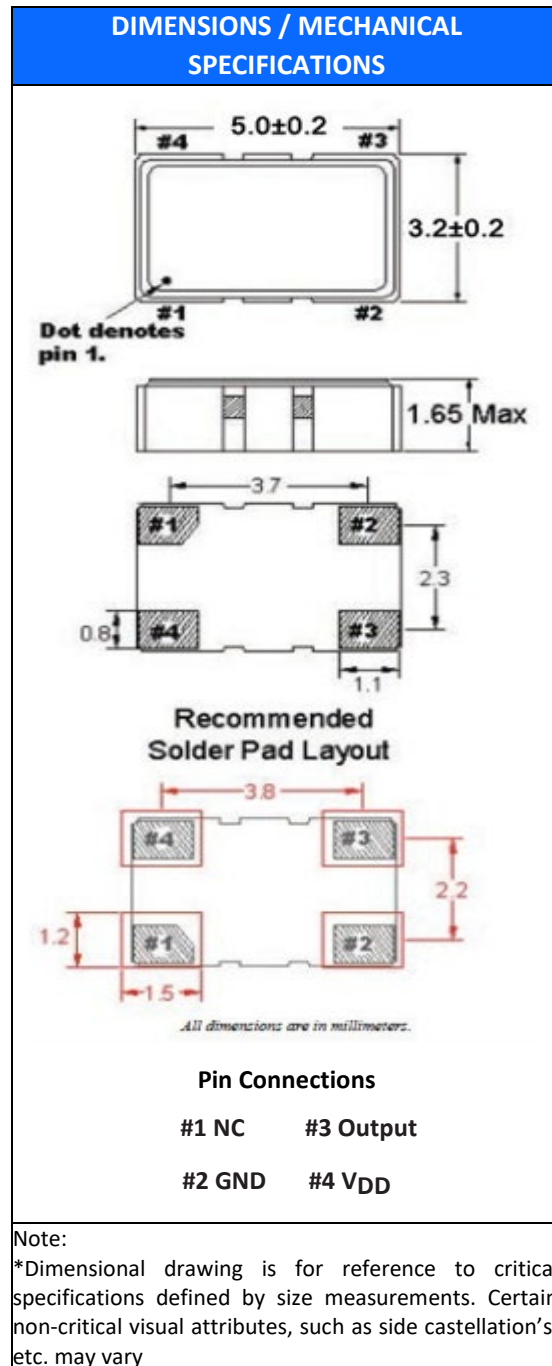

FT5SN

(Former FOX321 Series)

5.0mm x 3.2mm

SMD Stratum III HCMOS TCXO **FOX**



TAPE SPECIFICATIONS (mm)							REEL SPECIFICATIONS (mm)						
A	B	C	D	E	F	REEL QTY	G	H	I	J	K	L	M
ø1.5	4.0	8.0	5.5	12.0	1.7	-T1 = 1,000	2.0	ø13	ø21	ø80	ø180	13..0	2.0

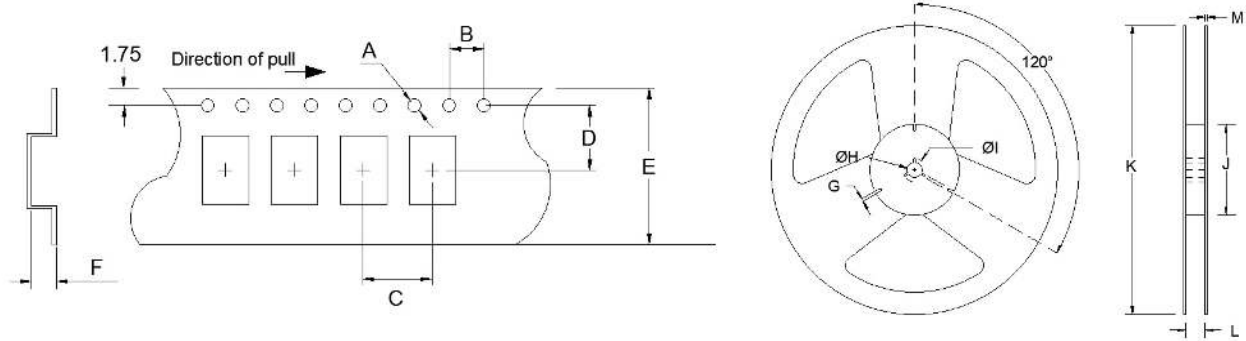

Available Options & Part Identification for VCTCXO Model T5SN¹

Sample PN: FT5SNBKF25.0-T1

F	T5SN	B	K	F	25.0	-T1
<u>Fox</u>	<u>Model Number</u> T5SN = TCXO	<u>Voltage</u> B = +3.3V±5%	<u>Stability</u> G = ±100 PPB K = ±0.28 PPM	<u>Operating Temperature</u> F = -20 to +70°C M = -40 to +85°C	<u>Frequency (MHz)</u>	<u>Values Added Options</u> Blank = Bulk T1 = 1,000 pcs

Reliability Test Conditions

Please contact Abracon Quality Assurance department