

10139781- A A B C D E G V F F

AA	POSITION
02	2X10
04	2X20
06	2X30
08	2X40
10	2X50
12	2X60
14	2X70
16	2X80
18	2X90
20	2X100

B	FOR PLUG, SEE DWG. NO.10139085	
COMBINATION OF MATED HEIGHT	Plug 1 	Plug 4
Recep 1 		
Recep 2 		
Recep 3 		
Recep 4 		

G	PACKAGING
/	STANDARD, NOT PRINT DATE CODE
P	PRINT DATE CODE

E	PACKAGING
1	TRAY WITH METAL CAP
2	T&R WITH METAL CAP
Q	T&R WITHOUT CAP
6	T&R WITH KAPTON TAPE

D	POLARIZATION PEG
0	YES
2	NO

MANDATORY CODE	V
STANDARD, NOT MANDATORY P/N	/
ONLY FOR DEDICATED CUSTOMER	T

C	PLATING: CONTACT AREA / SOLDER TAIL AREA	FF
4	GOLD 0.2um MIN / PURE MATT TIN 2.5um MIN NICKEL UNDERPLATE OVERALL 1.27um.	LF
5	GOLD 0.38um MIN / MATT PURE TIN 2.5um MIN NICKEL UNDERPLATE OVERALL 1.27um MIN	LF
6	GOLD FLASH OVER PALLADIUM-NICKEL 0.69um/PURE MATT TIN NICKEL UNDERPLATE OVERALL 1.27um.	LF
D	GOLD 0.38um MIN / GOLD FLASH NICKEL UNDERPLATE OVERALL 1.27um MIN	LF

- NOTES:
- MATERIAL
HOUSING: LCP UL,NATURAL 94V-0
TERMINAL: COPPER ALLOY
 - PLATING: AS SHOWN IN TABLE.
 - PRODUCT SPEC PLEASE REFER TO GS-12-1354 .
 - SEE GS-15-551 AND GS-14-816 FOR THE DETAILS OF PACKAGING.
 - PACKAGING OPTION 2: "NOT ALL SIZES AVAILABLE; CHECK WITH FACTORY".
 - THIS PRODUCT MEETS THE EUROPEAN UNION DIRECTIVES AND OTHER COUNTRY REGULATIONS AS DESCRIBED IN GS-22-008.
 - THE HOUSING WITH WITHSTAND EXPOSURE UP TO 260° PEAK TEMPERATURE FOR 30 SECONDS IN A CONVECTION, INFRA-RED OR VAPOR REFLOW OVEN.
 - A SYMBOL WILL BE NEXT TO ANY DIMENSION, VIEW OR NOTE WHICH HAS BEEN MODIFIED WITH THE CURRENT DRAWING REVISION.

spec ref	-	dr	Eric Huang	2016/08/02	projection	mm	size	A3	scale	1:1	
tolerance std	ISO 406 ISO 1101	eng	Bob Gu	2020/12/02		← →	ecn no	ELX-N-38183-1			
TOLERANCES UNLESS OTHERWISE SPECIFIED		chr	-	-			rel level	Released			
surface	linear	appr	Tim Yao	2020/12/04	product family	-	dwg no	10139781		rev	J
ISO 1302	angular	Amphenol FCI		BERGSTAK+ 0.8mm							
				RECEPTACLE CONN							
					cat. no.	-	Product - Customer Drw			sheet 1 of 7	

Amphenol FCI

© 2016 AFCI

PRODUCT NO.	NUMBER OF POSITIONS	DIMENSION		
		A	B	C
10139781-041*****	2X20	15.2	21.8	20.2
10139781-061*****	2X30	23.2	29.8	28.2
10139781-081*****	2X40	31.2	37.8	36.2
10139781-101*****	2X50	39.2	45.8	44.2
10139781-121*****	2X60	47.2	53.8	52.2
10139781-141*****	2X70	55.2	61.8	60.2
10139781-161*****	2X80	63.2	69.8	68.2
10139781-181*****	2X90	71.2	77.8	76.2
10139781-201*****	2X100	79.2	85.8	84.2

DATE CODE: XXXXXX
 DAY(01~31)
 MONTH(01~12)
 YEAR(00~99)

DETAIL B
 SCALE 5:1

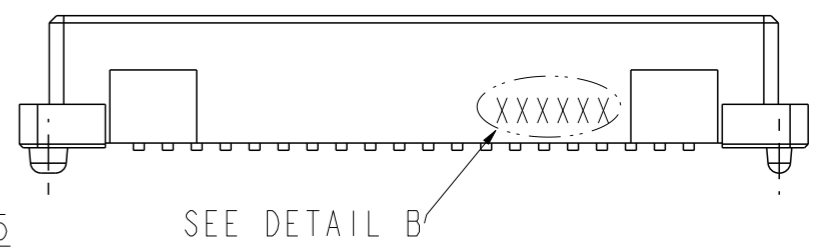
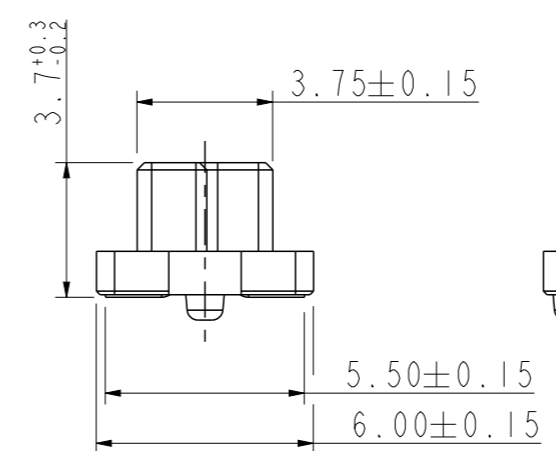
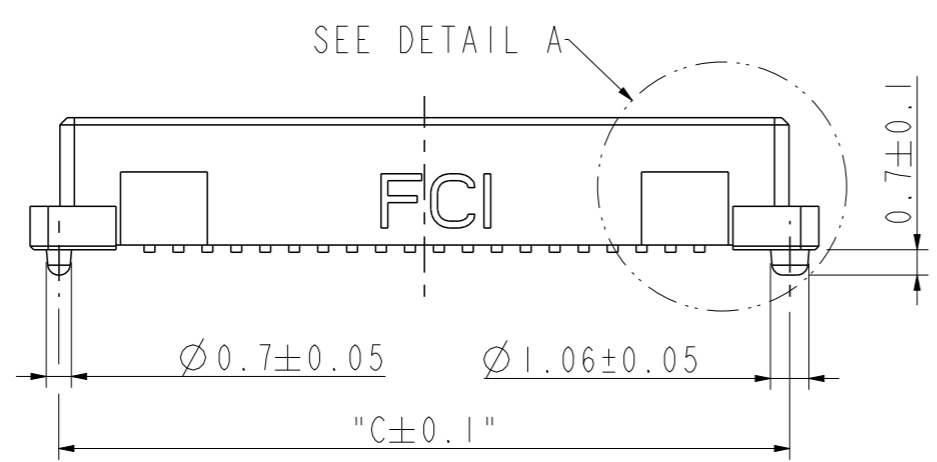
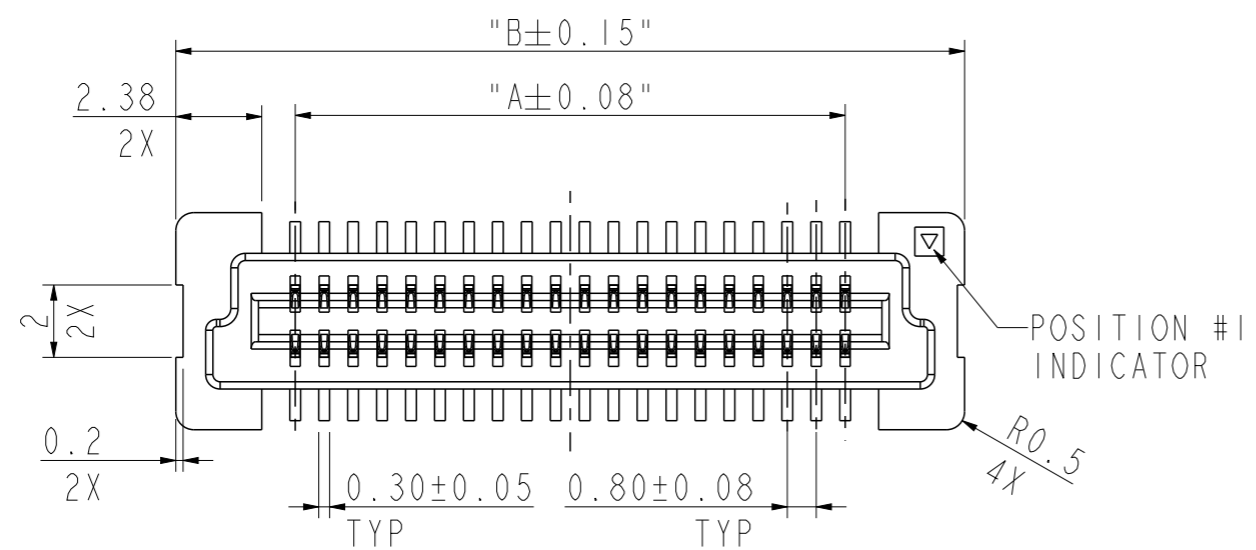
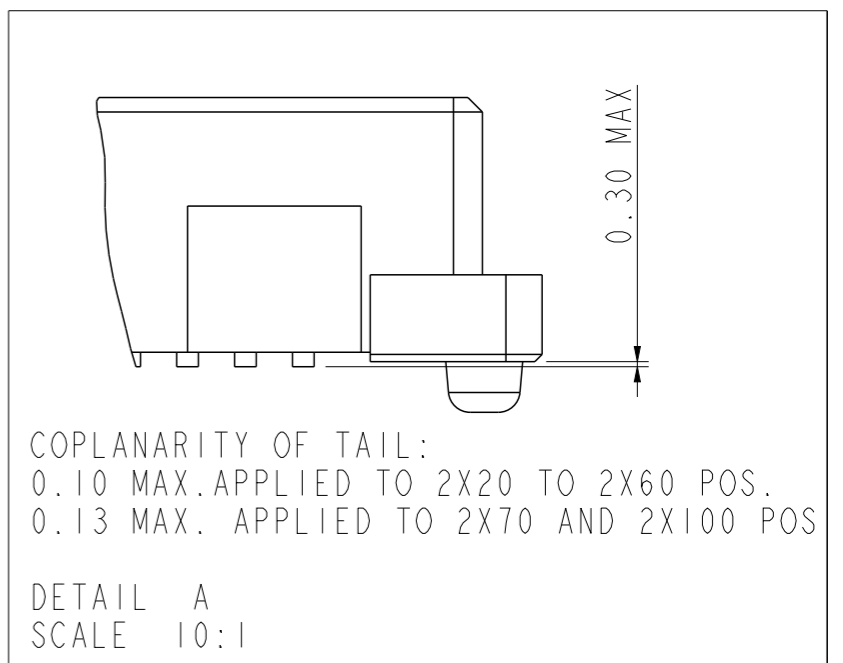

RECEPTACLE 1

spec ref	-	dr	Eric Huang	2016/08/02	projection	mm	size	A3	scale	1:1	
tolerance std	ISO 406 ISO 1101	eng	Bob Gu	2020/12/02			ecn no	ELX-N-38183-1	rel level		Released
surface	linear	chr	-	apppr			Tim Yao	2020/12/04	product family	-	rel level
	angular	0°	±2°	Amphenol FCI		BERGSTAK+ 0.8mm	dwg no	10139781	rev	J	
ISO 1302		cat. no.	-	Product - Customer Drw		sheet 2 of 7					

RECEPTACLE 1

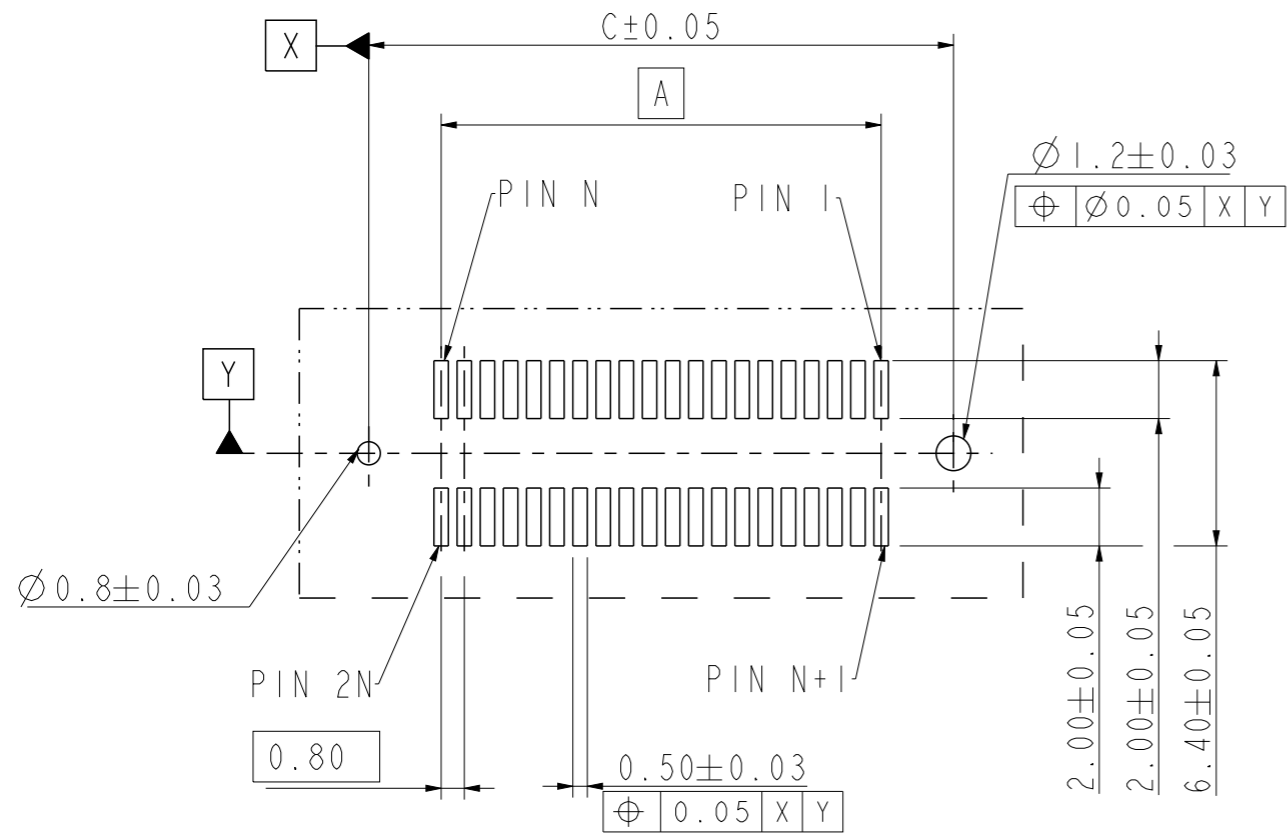

RECOMMENDED PCB LAYOUT WITH PEGS

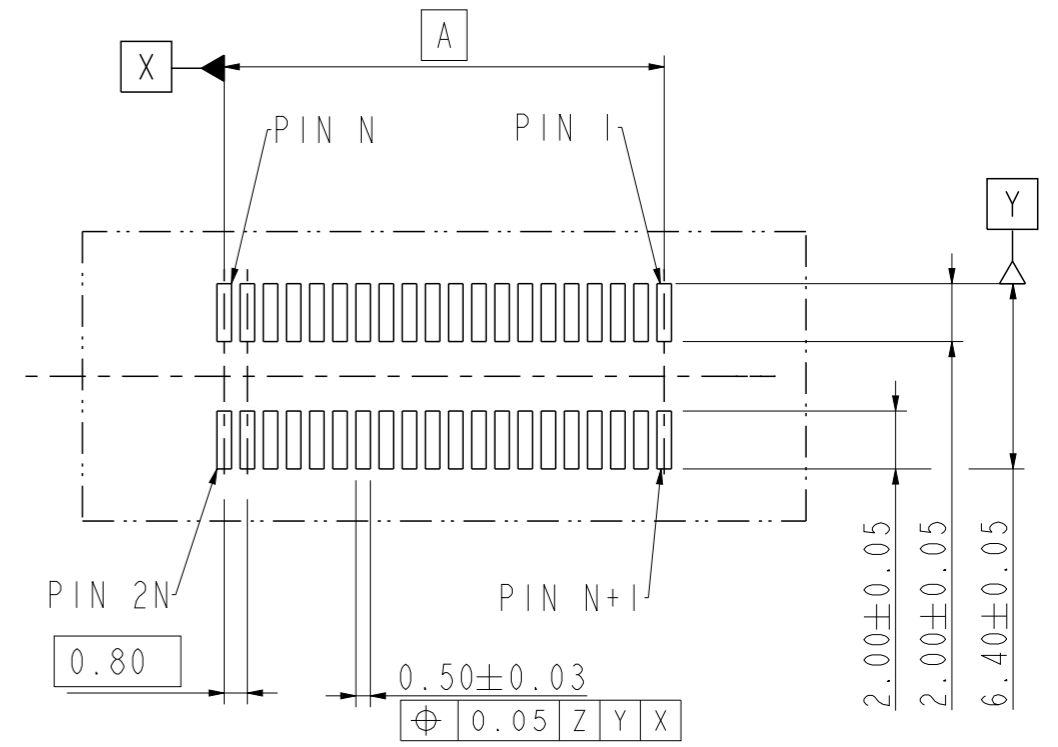

RECOMMENDED PCB LAYOUT WITHOUT PEGS

spec ref	-	dr	Eric Huang	2016/08/02	projection	mm	size	A3	scale	1:1	
tolerance std	ISO 406 ISO 1101	eng	Bob Gu	2020/12/02			ecn no	ELX-N-38183-1			
TOLERANCES UNLESS OTHERWISE SPECIFIED		chr	-	-			rel level	Released			
surface	linear	appr	Tim Yao	2020/12/04	product family	-	dwg no	10139781		rev	J
ISO 1302	angular			BERGSTAK+ 0.8mm	cat. no.	-	Product - Customer Drw	sheet 3 of 7			

PRODUCT NO.	NUMBER OF POSITIONS	DIMENSION		
		A	B	C
10139781-042*****	2X10	7.2	13.8	12.2
10139781-042*****	2X20	15.2	21.8	20.2
10139781-062*****	2X30	23.2	29.8	28.2
10139781-082*****	2X40	31.2	37.8	36.2
10139781-102*****	2X50	39.2	45.8	44.2
10139781-122*****	2X60	47.2	53.8	52.2
10139781-142*****	2X70	55.2	61.8	60.2
10139781-162*****	2X80	63.2	69.8	68.2
10139781-182*****	2X90	71.2	77.8	76.2
10139781-202*****	2X100	79.2	85.8	84.2

DATE CODE: XXXXXX
 DAY(01~31)
 MONTH(01~12)
 YEAR(00~99)

DETAIL D
 SCALE 5:1

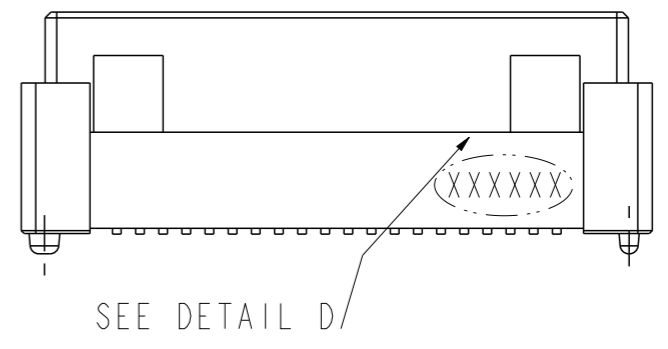
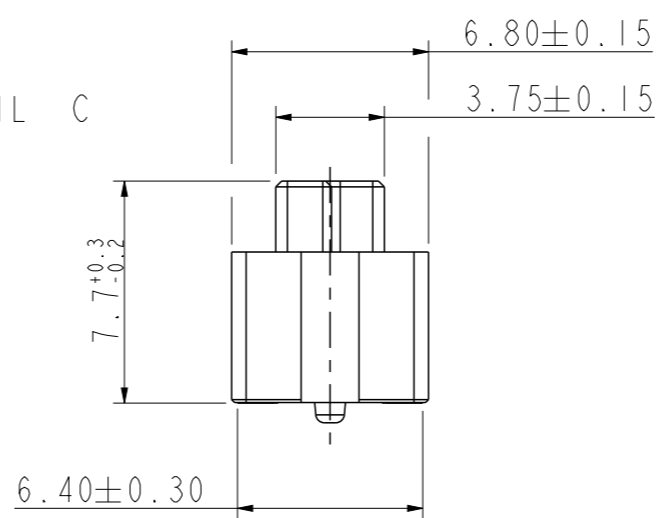
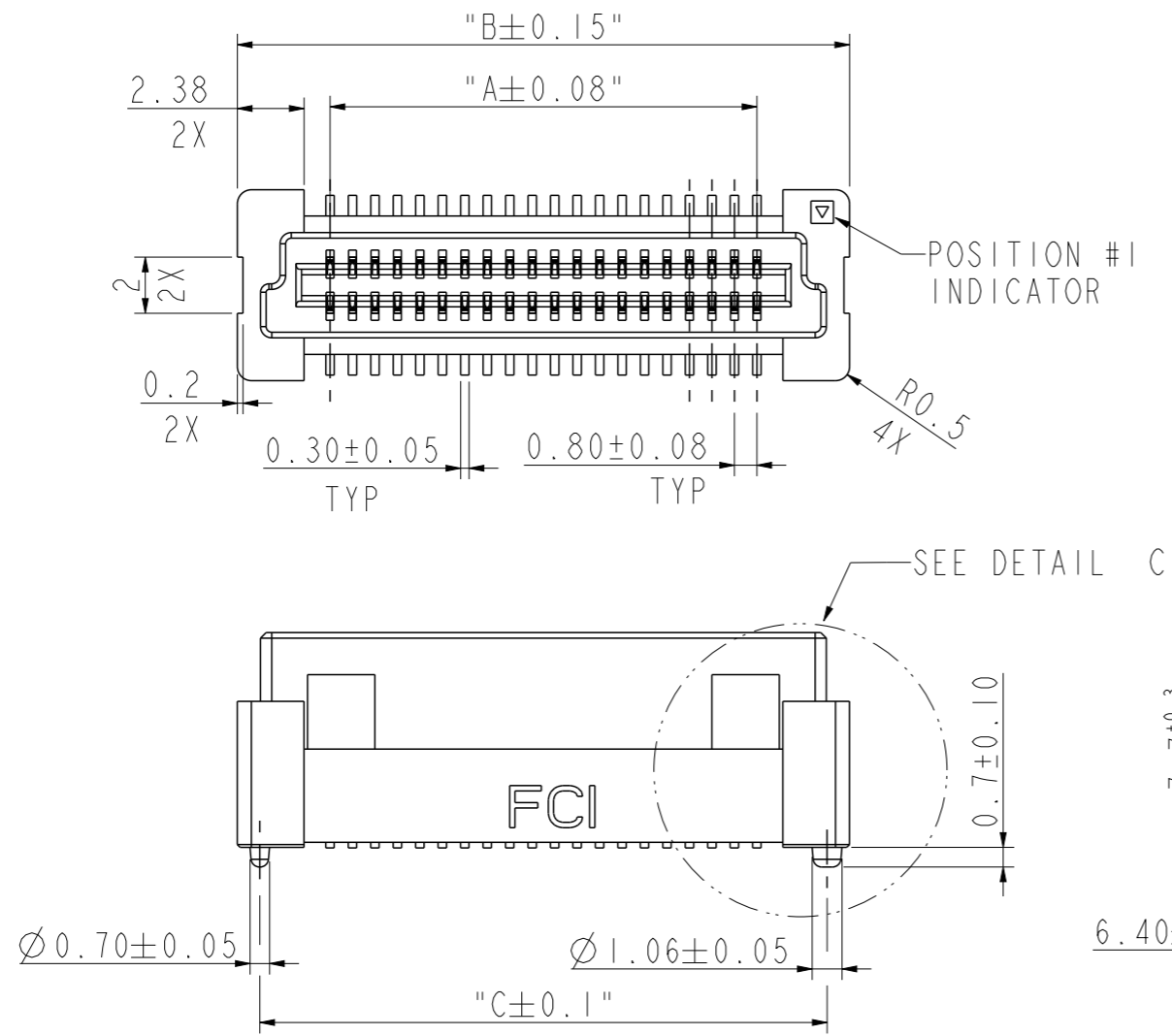
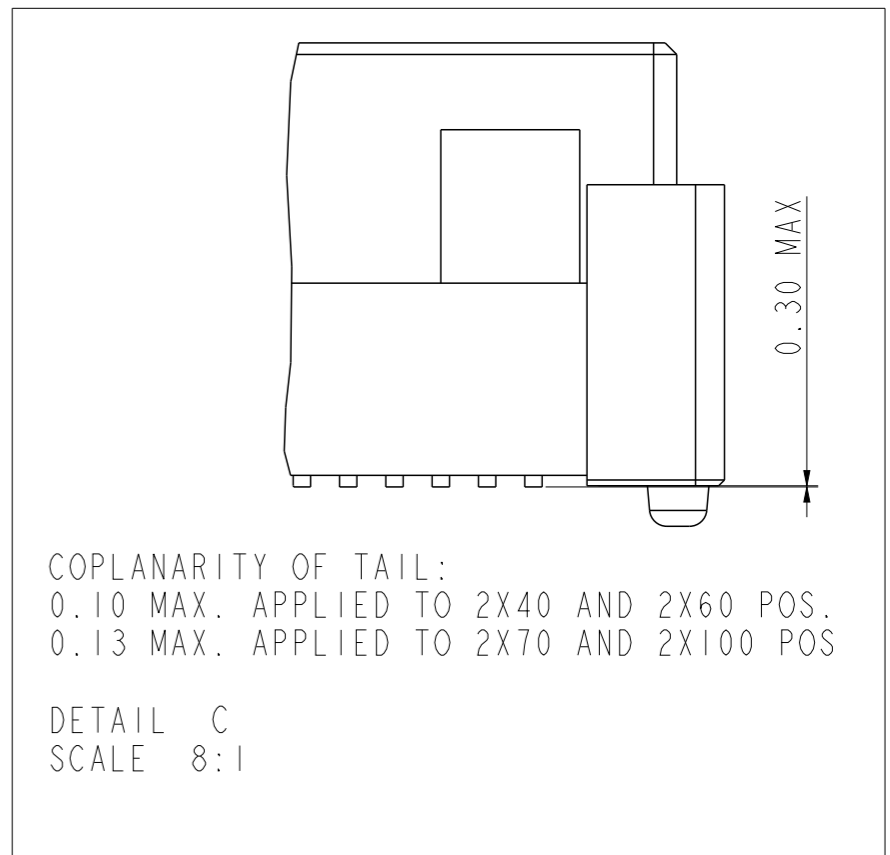

RECEPTACLE 2

spec ref	-	dr	Eric Huang	2016/08/02	projection	mm	size	A3	scale	1:1	
tolerance std	ISO 406 ISO 1101	eng	Bob Gu	2020/12/02			ecn no	ELX-N-38183-1	rel level	Released	
TOLERANCES UNLESS OTHERWISE SPECIFIED		chr	-	-			product family	-			
surface	linear	0.X	±0.3	Amphenol FCI	BERGSTAK+ 0.8mm		dwg no	10139781		rev	J
		0.XX	±0.15		RECEPTACLE CONN						
	angular	0°	±2°		cat. no.	-					Product - Customer Drw

© 2016 AFCI
 Amphenol FCI

PRODUCT NO.	NUMBER OF POSITIONS	DIMENSION		
		A	B	C
10139781-043*****	2X20	15.2	21.8	20.2
10139781-063*****	2X30	23.2	29.8	28.2
10139781-083*****	2X40	31.2	37.8	36.2
10139781-103*****	2X50	39.2	45.8	44.2
10139781-123*****	2X60	47.2	53.8	52.2
10139781-143*****	2X70	55.2	61.8	60.2
10139781-163*****	2X80	63.2	69.8	68.2
10139781-183*****	2X90	71.2	77.8	76.2
10139781-203*****	2X100	79.2	85.8	84.2

DATE CODE: XXXXXX
 DAY(01~31)
 MONTH(01~12)
 YEAR(00~99)

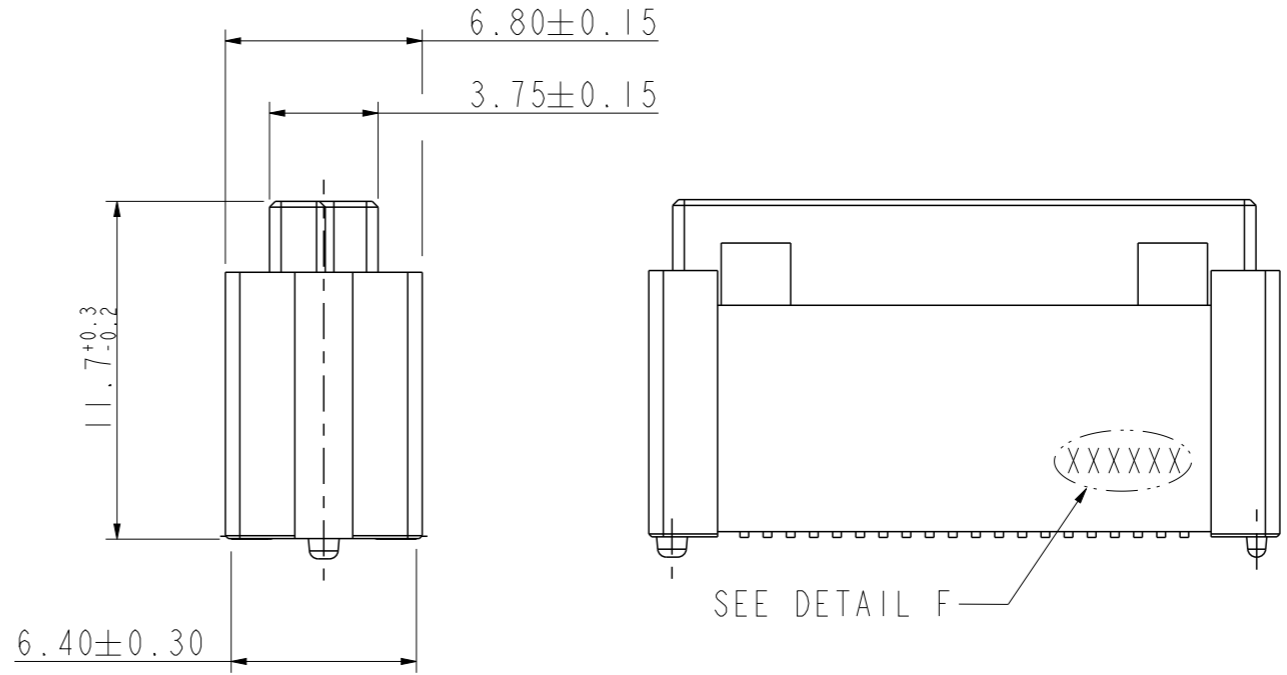
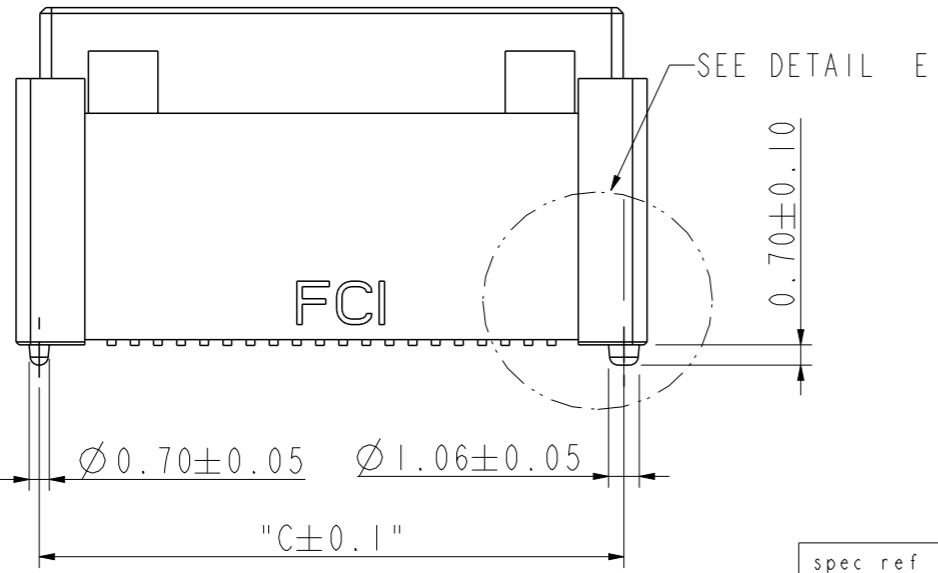
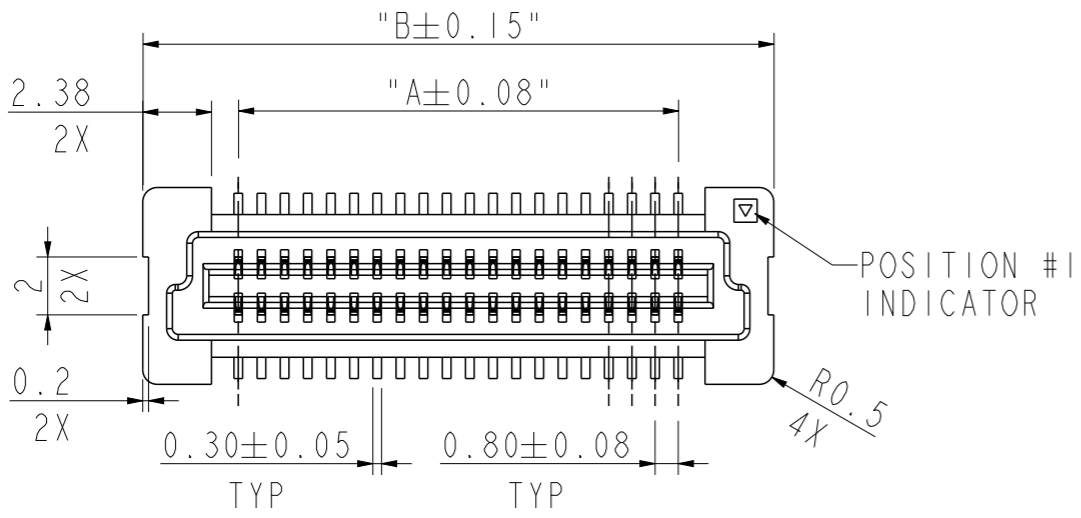
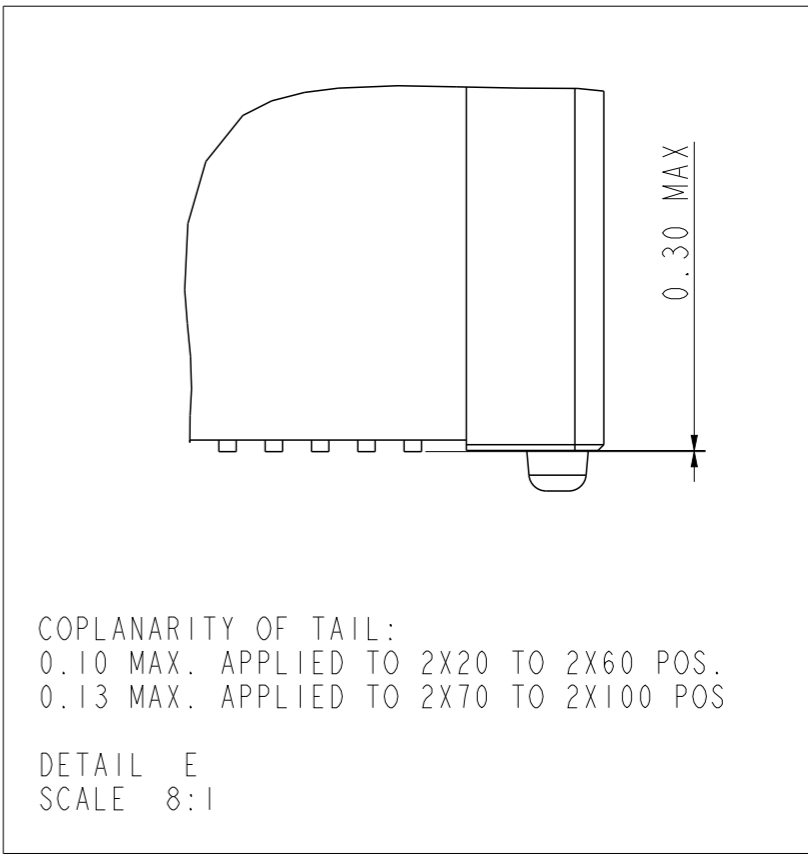

spec ref	-	dr	Eric Huang	2016/08/02	projection	mm	size	A3	scale	4:1
tolerance std	ISO 406 ISO 1101	eng	Bob Gu	2020/12/02			ecn no	ELX-N-38183-1		
TOLERANCES UNLESS OTHERWISE SPECIFIED		chr	-	-			rel level	Released		
surface	linear	appr	Tim Yao	2020/12/04	product family	-	BERGSTAK+ 0.8mm	dwg no	10139781	
ISO 1302	angular	Amphenol FCI		RECEPTACLE CONN	cat. no.	-	Product - Customer Drw	rev	J	
									sheet 5 of 7	

© 2016 AFCI Amphenol FCI

PRODUCT NO.	NUMBER OF POSITIONS	DIMENSION		
		A	B	C
10139781-024*****	2X10	7.2	13.8	12.2
10139781-044*****	2X20	15.2	21.8	20.2
10139781-064*****	2X30	23.2	29.8	28.2
10139781-084*****	2X40	31.2	37.8	36.2
10139781-104*****	2X50	39.2	45.8	44.2
10139781-124*****	2X60	47.2	53.8	52.2
10139781-144*****	2x70	55.2	61.8	60.2
10139781-164*****	2x80	63.2	69.8	68.2
10139781-184*****	2X90	71.2	77.8	76.2
10139781-204*****	2X100	79.2	85.8	84.2

DATE CODE: XXXXXX



DETAIL H
SCALE 5:1

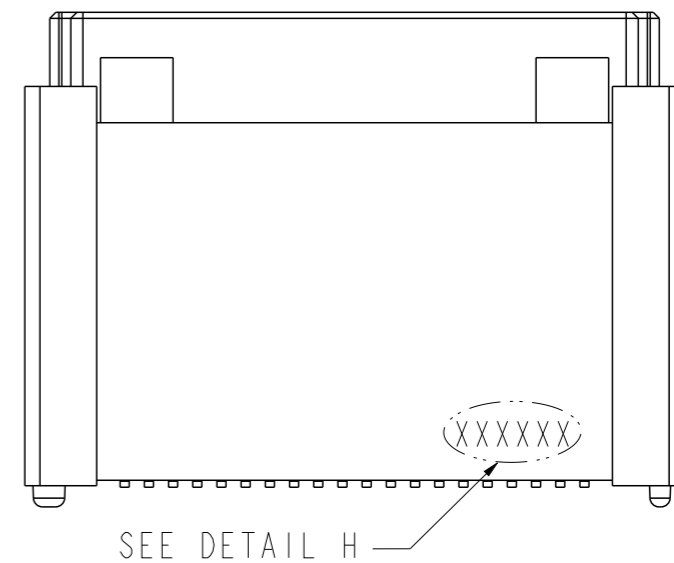
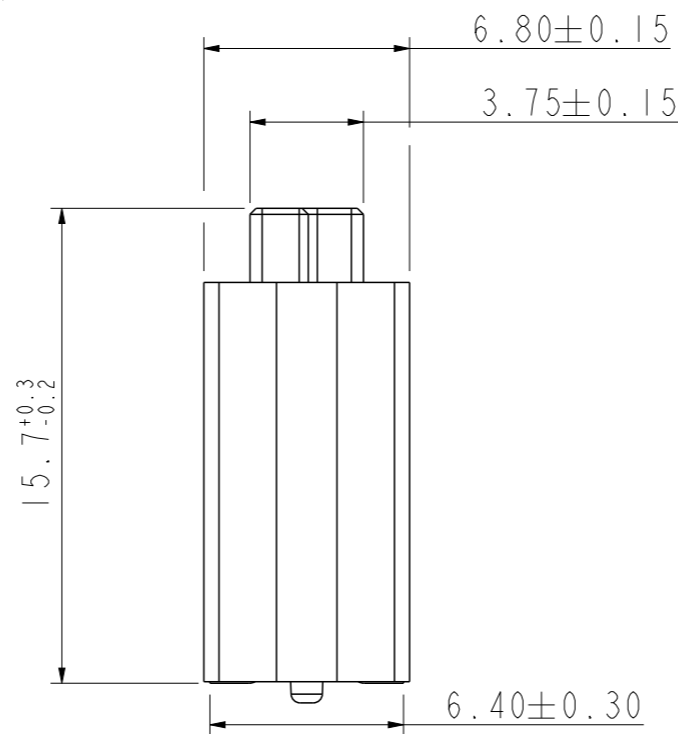
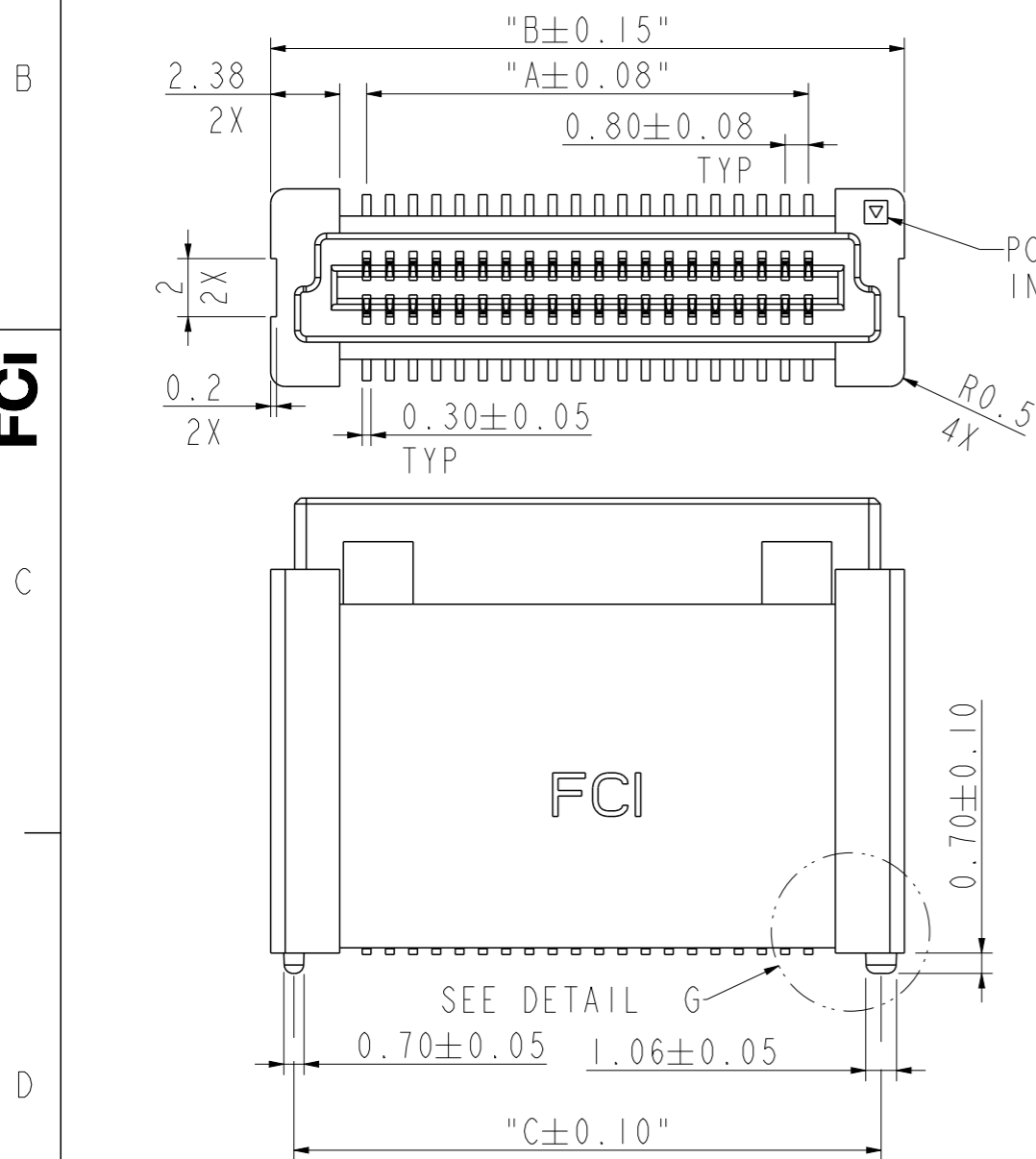
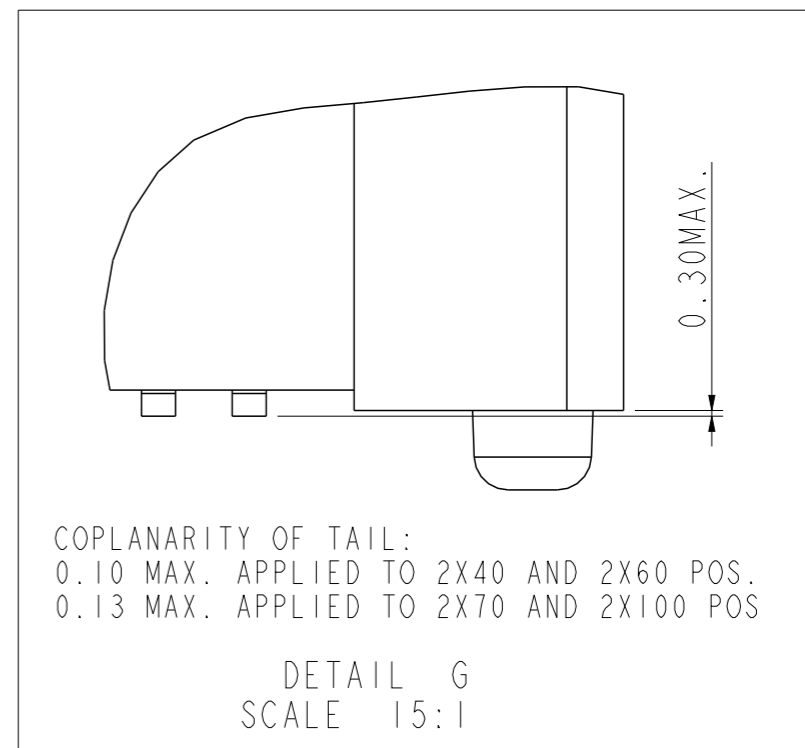

spec ref	-	dr	Eric Huang	2016/08/02	projection	mm	size	A3	scale	4:1
tolerance std	ISO 406 ISO 1101	eng	Bob Gu	2020/12/02			ecn no	ELX-N-38183-1		
surface	linear	chr	-	app			Tim Yao	2020/12/04	product family	-
	angular	0°	±0.3	Amphenol FCI			BERGSTAK+ 0.8mm	dwg no	10139781	
		±0.15	±0.08	RECEPTACLE CONN			rev	J		
ISO 1302		0°	±2°	cat. no.	-	Product - Customer Drw	sheet 6 of 7			

RECEPTACLE 2 & 3 & 4

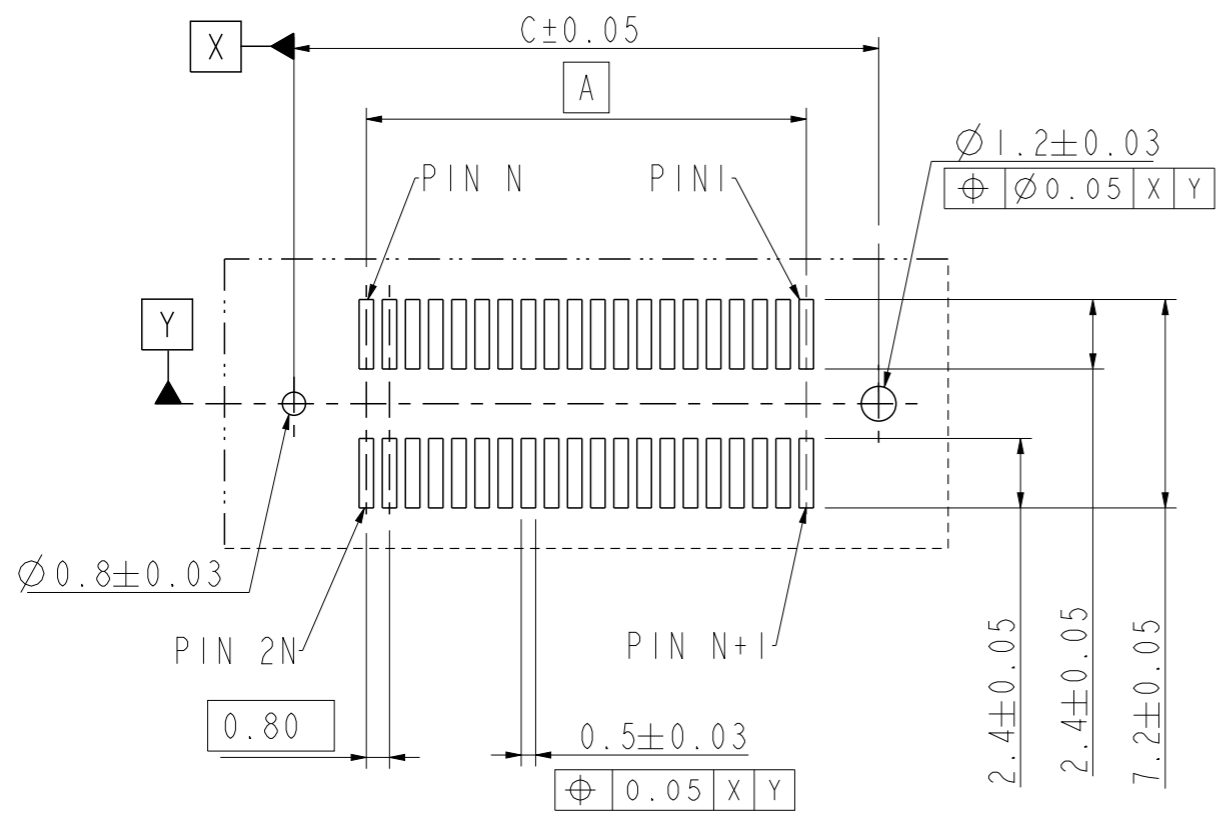

RECOMMENDED PCB LAYOUT WITH PEGS

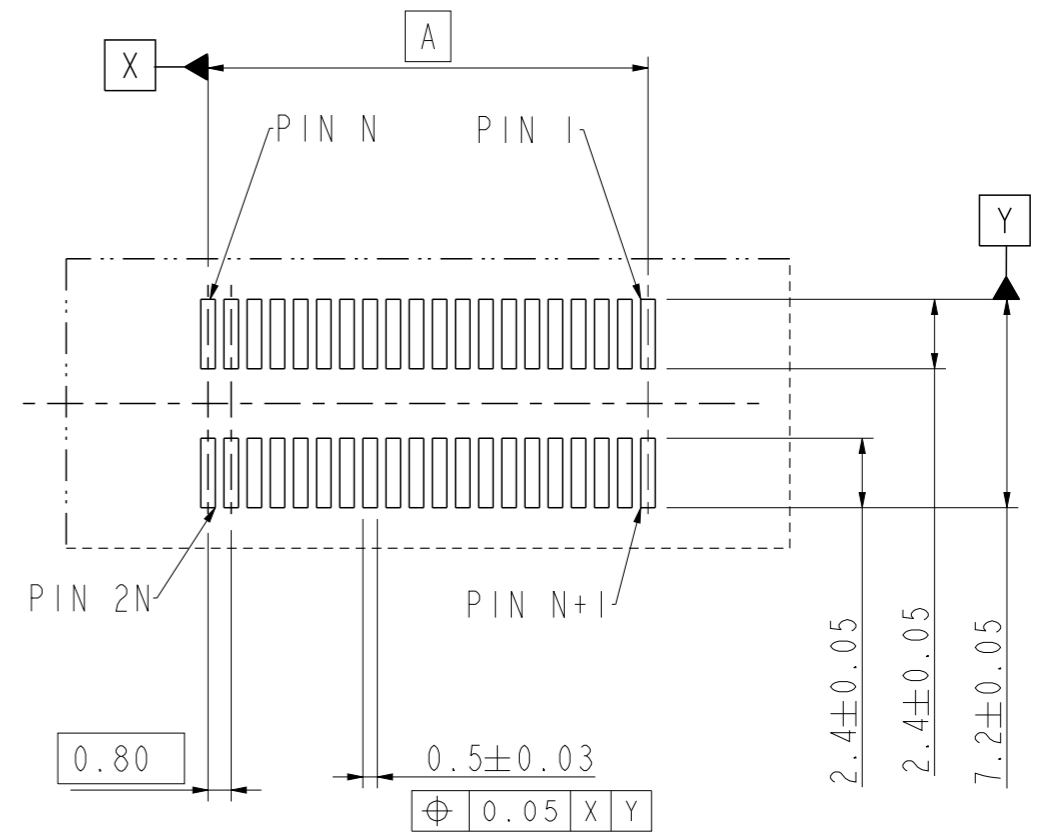

RECOMMENDED PCB LAYOUT WITHOUT PEGS

Amphenol FCI

© 2016 AFCI

spec ref	-	dr	Eric Huang	2016/08/02	projection	mm	size	A3	scale	1:1	
tolerance std	ISO 406 ISO 1101	eng	Bob Gu	2020/12/02			ecn no	ELX-N-38183-1			
TOLERANCES UNLESS OTHERWISE SPECIFIED		chr	-	-			rel level	Released			
surface	linear	appr	Tim Yao	2020/12/04	product family	-	dwg no	10139781		rev	J
ISO 1302	angular			BERGSTAK+ 0.8mm	cat. no.		-	Product - Customer Drw	sheet 7 of 7		
					RECEPTACLE CONN						