

CUSTOMER PRINT

PART NUMBER: 18982-XPG-5XX

**NOTES:**

1. PARTS ARE TO BE BULK PACKED.
2. CONTACTS ARE ASSEMBLED INTO CONNECTOR.
3. ALL DIMENSIONS ARE FOR REFERENCE ONLY.

ASS'Y P/N	CONTACT QTY.	KEY STYLE
18982-5PG-5XX	5 - # 26	A-KEY
18982-6PG-5XX	6 - # 26	B-KEY
18982-7PG-5XX	7 - # 26	A-KEY

GROMMET SIZE  
NUMBER OF CONTACTS

ASS'Y P/N	CABLE O.D.
18982-XPG-518	0.175 - 0.185 [4.4-4.7]
18982-XPG-521	0.205 - 0.215 [5.2-5.5]
18982-XPG-522	0.215 - 0.225 [5.5-5.7]

GROMMET SIZE  
NUMBER OF CONTACTS

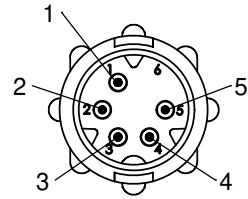

**FACE VIEW**  
18982-5PG-5XX  
5 POSITION  
A-KEY

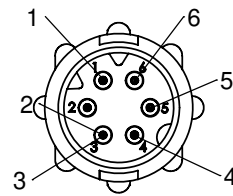

**FACE VIEW**  
18982-6PG-5XX  
6 POSITION  
B-KEY

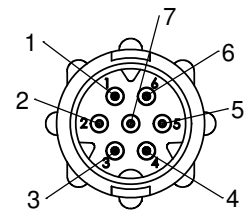

**FACE VIEW**  
18982-7PG-5XX  
7 POSITION  
A-KEY

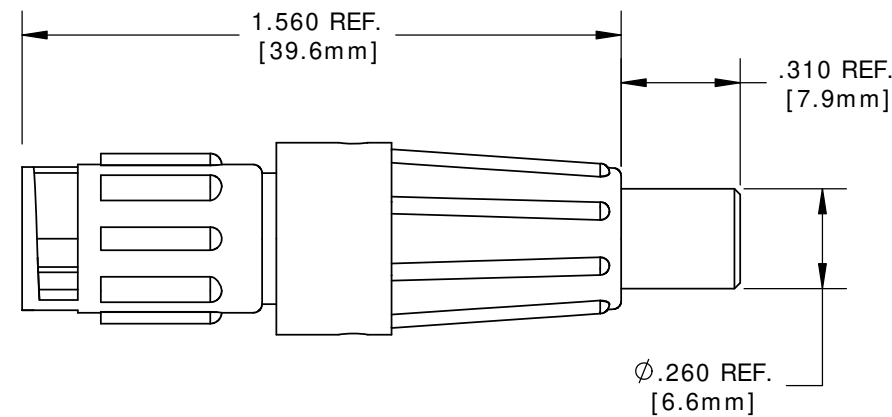
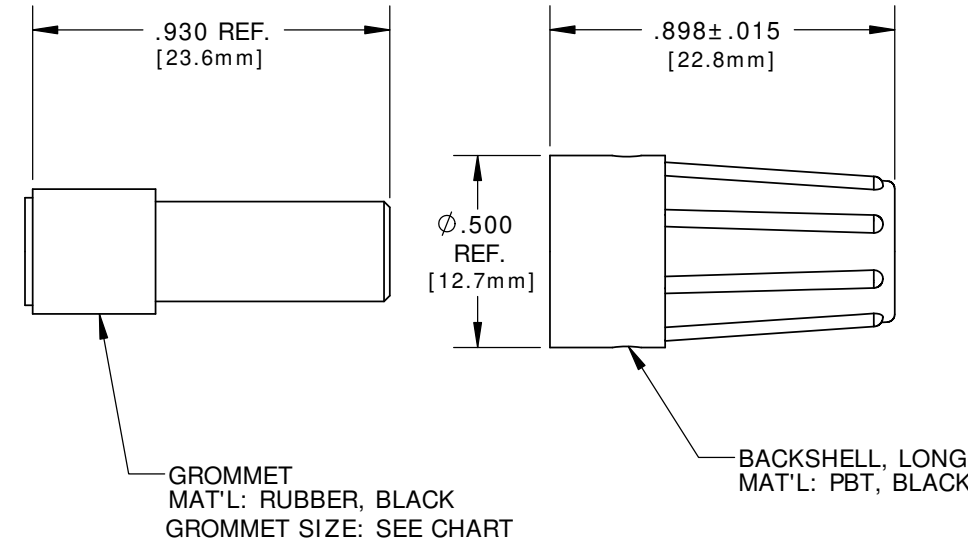
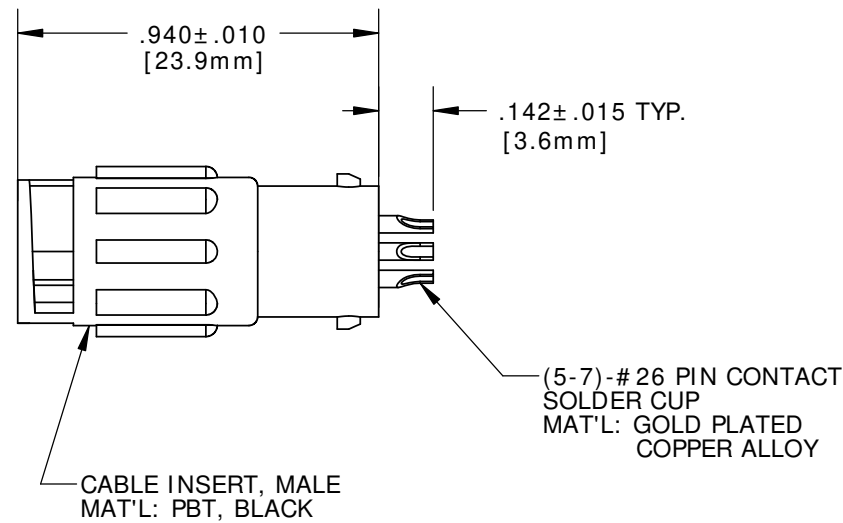

**ASSEMBLED KIT VIEW**  
FOR CUSTOMER REFERENCE

**CUSTOMER APPROVAL**

THIS DOCUMENT CONTAINS CONFIDENTIAL INFORMATION PROPRIETARY TO CONXALL CORPORATION. ANY REPRODUCTION, DISCLOSURE, OR USE OF THIS DOCUMENT / INFORMATION IS EXPRESSLY PROHIBITED UNLESS AUTHORIZED IN WRITING BY CONXALL CORPORATION.

APPROVED BY: \_\_\_\_\_

DATE: \_\_\_\_\_

**RoHS COMPLIANT**

BRACKETS [ ] INDICATE METRIC DIMENSIONS.

E	MA	10-27-17	UPDATED MANUFACTURING DRAWING PER ECR 9211 #1
D	AN	01-10-14	CORRECTED BACKSHELL DIM. FROM 0.892 TO 0.898 PER ECR 8074 REL.5
C	AN	09-07-12	DRAWING P/N WAS 18982-XPG-XXX; REMOVED SHORT BACKSHELL ASSEMBLIES; ADDED MATERIALS AND TOLERANCES. PER DOR 12-E149SL #29 / ECR 8074 REL. 4
B	PD	09-01-11	UPDATE MANUFACTURING DRAWING PER ECR 7959
A	PAK	03-24-10	DRAWING CREATED PER DOR 06-E168CS
REV.	INIT.	DATE	DESCRIPTION
ALL INFORMATION ILLUSTRATED IS THE PROPERTY OF CONXALL CORPORATION. UNAUTHORIZED DUPLICATION OR DISTRIBUTION OF THIS DOCUMENT IS PROHIBITED.		ORIG. DRAWN BY: PAK	DATE: 03-11-10
ALL UNITS ARE IN FEET, INCHES, FRACTION OF INCHES AND DECIMALS.		CHECKED BY:	<p>601 E. WILDWOOD VILLA PARK, IL 60181</p>
-		APPROVED BY:	
SCALE	SIZE	SHEET	TITLE:
NTS	B	1 OF 1	IN-LINE CONNECTOR KIT #26 PIN CONTACT, SOLDER CUP MICRO-CON-X, A-KEY & B-KEY STANDARD PRODUCT
FILE:	DIRECTORY:	PART NUMBER:	CUSTOMER:
18982-XPG-5XX	SLW	18982-XPG-5XX	
			REV E