

PN:1-7 as shown

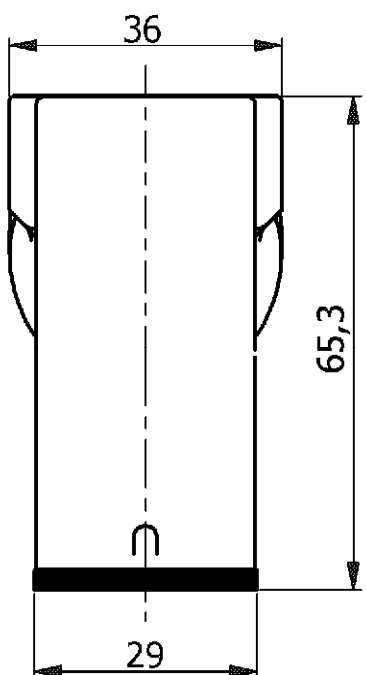

NOTES

- 1 PACKAGING QUANTITY: 5 PIECES PER BOX
- 2 MATERIAL: HOUSING: ALUMINIUM DIE CAST ALLOY
SEALS: NEPRENE
- 3 SURFACE: VARNISH GREY
ALUMINIUM OXIDE +
VARNISH BLACK
- 4 VARNISH ON THE INSIDE NOT NECESSARY

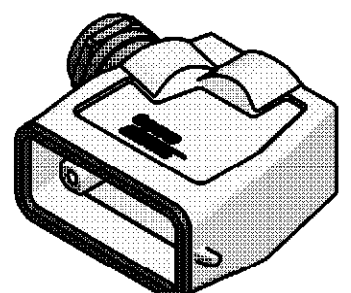
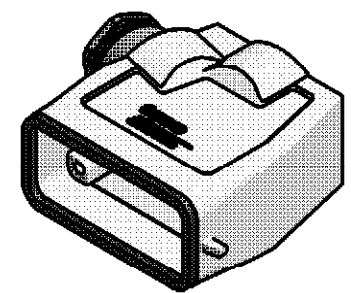

**PN:1-7
Ordering Text:
HD.15.STS.1.16**

**PN:2-7
Ordering Text:
HD-K.15.STS.1.16**

OBSELETE

1	2	3	4	5	PG 16	REMARKS	
1	Gland Fitting	Brass	Nickel Plated	Blue	5	PG 16	
-	Cable Fitting Round	Brass	Nickel Plated	Blue	4	PG 16	
1	Profile Seal	Neoprene	-	Black	3	-	
1	Hood	Aluminium	Aluminium oxide	Black	2	-	
-	Hood	Aluminium	-	Grey	1	-	
2-7	1-7	DESCRIPTION	MATERIAL	SURFACE	COLOR	ITEM NO.	REMARKS

THIS DRAWING IS A CONTROLLED DOCUMENT FOR AMP INCORPORATED. IT IS SUBJECT TO CHANGE AND THE CONTROLLING ENGINEERING ORGANIZATION SHOULD BE CONTACTED FOR THE LATEST REVISION. DIESSES ZEICHNUNGSDOKUMENT WIRD DURCH AMP INCORPORATED KONTROLLIERT. AENDERUNGEN, DIE DEM TECHNISCHEN FORTSCHRITT DIENEN, SIND VORGEHALTEN. DEN JEWELIS LETZTGUELTIGEN AENDERUNGSSTAND ERFAHREN SIE AUF ANFRAGE.

DIMENSIONS: DIMENSIONEN: mm	TOLERANCES UNLESS OTHERWISE SPECIFIED: ALLGEMEINTOLERANZEN n. ISO 8015 - mH-E n. ISO 2768 - 140 n. DIN 16901-
	0 PLC # 1 PLC # 2 PLC # 3 PLC # ANGLES / WINKEL #
MATERIAL	FINISH / OBERFLAECHE / FARBE
2	3

DWN	R.SRINIVAS	5/3/2006			
CHK	R.SRINIVAS	5/3/2006			
APVD	T.SCHNURPFEIL	5/3/2006	NAME		
PRODUCT SPEC. / PRODUKTSPEZ.			HOOD		
APPLICATION SPEC. / VERARBEITUNGSSPEZ.			HD.15.STS.1.16		
SIZE	CAGE CODE	DRAWING NO. / ZEICHNUNGS-NR.	RESTRICTED TO NUR FUER		
A3	00779	1102425			
CUSTOMER DRAWING / KUNDENZEICHNUNG			SCALE / MASSSTAB	SHEET / BLATT	OF / VON
			1:1	1	1
			REV. B2		

Z:\HIS\EGGMA05416\HD_15\ASSEMBLY\COPY1102425_C_1102425_B1.dwg