

HONEYWELL
PART NUMBER

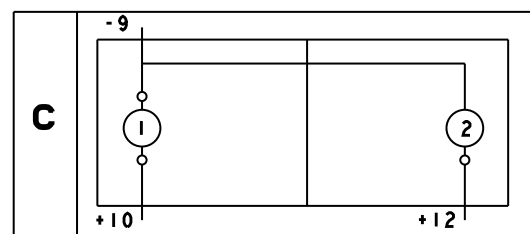

REV	DOCUMENT	CHANGED BY	CHECK
B	0062802	VKR 24MAR10	CMH

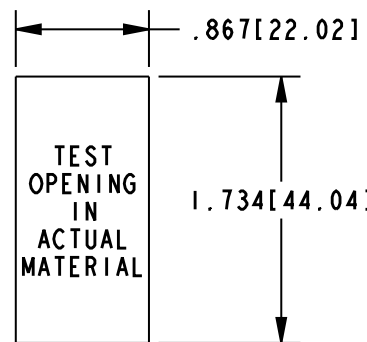
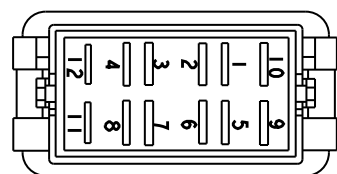
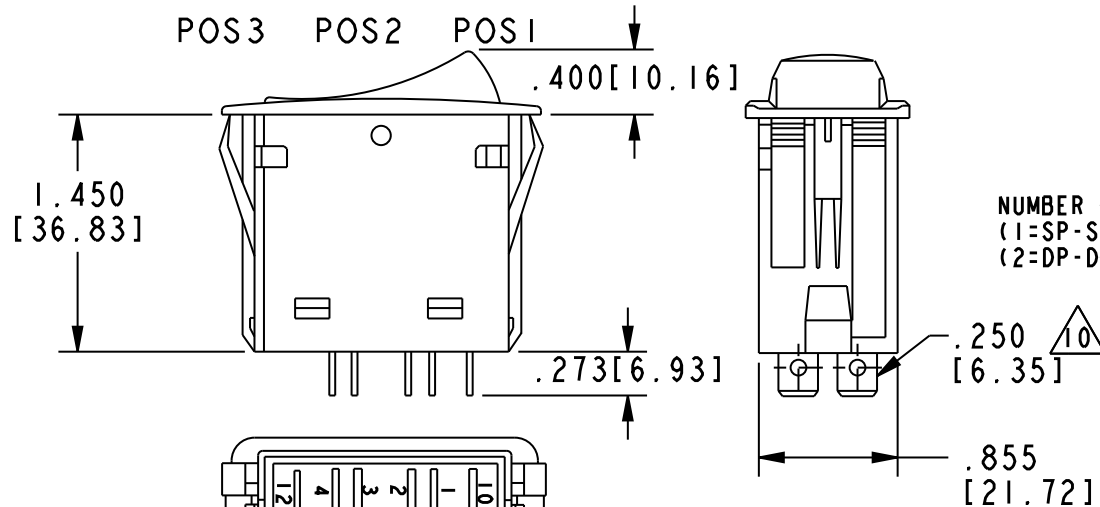
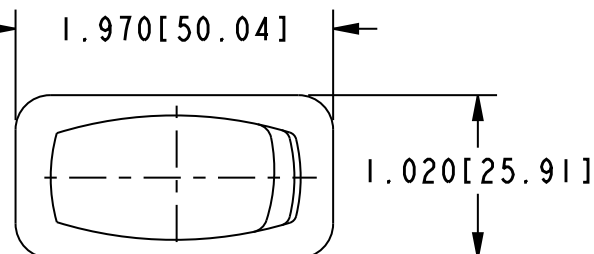

LAMP ⁷
(A=AMBER, G=GREEN, R=RED, N=NONE)

ILLUMINATION STYLE ⁹

CIRCUITRY ⁵

NUMBER OF POLES
(1=SP-SINGLE POLE, USES TERMINAL 1-2-4)
(2=DP-DOUBLE POLE, USES TERMINALS 1-2-4 AND 5-6-8)

TERMINAL STYLE ¹⁰

.250 [6.35] WIDE QUICK
CONNECT TABS ¹⁰
.187 [4.76] WIDE QUICK
CONNECT TABS ¹⁰

	CIRCUIT MADE WITH ROCKER IN ³		
	POSITION 3 (1&2, 5&6)	POSITION 2	POSITION 1 (2&4, 6&8)
1	ON	OFF	ON
2	OFF	NONE	ON
3	ON	NONE	ON
4	(OFF)	NONE	ON
5	(ON)	OFF	ON
6	OFF	NONE	(ON)
7	(ON)	OFF	(ON)
8	(ON)	NONE	ON

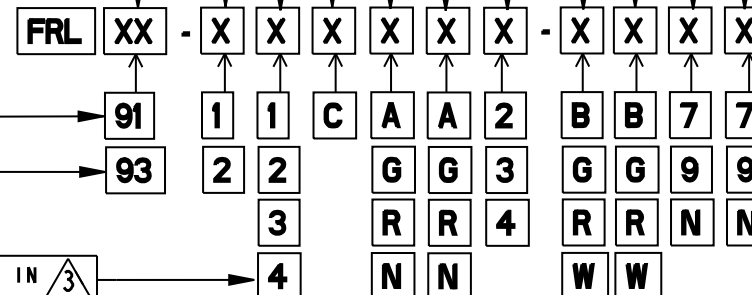

LAMP ⁸
(A=AMBER, G=GREEN, R=RED, N=NONE)

LED VOLTAGE
(2=6V, 3=12V, 4=24V)

ACTUATOR COLOR
(B=BLACK, G=GRAY, R=RED, W=WHITE)

BASE/BEZEL COLOR
(B=BLACK, G=GRAY, R=RED, W=WHITE)

LENS STYLE AND COLOR ⁷
7 = LARGE WHITE TRANSLUCENT.
9 = WHITE TRANSPARENT BAR.
N = NONE

LENS STYLE AND COLOR ⁸
7 = LARGE WHITE TRANSLUCENT.
9 = WHITE TRANSPARENT BAR.
N = NONE

ELECTRICAL RATING & APPROVALS ¹⁰
FOR .250 WIDE TABS: 20A, 12V
FOR .187 WIDE TABS: 15A, 12V

NOTES

- 1 - OPERATING TEMPERATURE RANGE: -40°F TO +185°F (-40°C TO +85°C)
- 2 - ELECTRICAL LIFE: 50,000 CYCLES MOMENTARY, 100,000 CYCLES MAINTAINED.
- 3 - MECHANICAL LIFE: 250,000 CYCLES MIN
- ⁴ - SEE DIAGRAM FOR CATALOGING SCHEME
- ⁵ - PARENTHESIS DENOTE MOMENTARY ACTION
- ⁶ - SEALED TO IP67
- ⁷ - ABOVE TERMINALS 9 AND 10
- ⁸ - ABOVE TERMINALS 11 AND 12
- ⁹ - REFER TO CIRCUIT DIAGRAMS
- ¹⁰ - TERMINAL WIDTH AND ELECTRICAL RATING DEPENDENT ON STYLE SELECTED

DESIGN UNITS: INCH		
TOLERANCES UNLESS NOTED:		
NO PLACES	X	± .040
ONE PLACE	.X	± .030
TWO PLACE	.XX	± .015
THREE PLACE	.XXX	± .015
FOUR PLACE	.XXXX	± .0005
ANGLES	X	± 2°
THIRD ANGLE PROJECTION		

DRAWN	CR	13 JUN 05
CHECK	RJ	13 JUN 05
THIS DRAWING COVERS A PROPRIETARY ITEM AND IS THE PROPERTY OF HONEYWELL. THIS DRAWING IS NOT TO BE COPIED OR USED WITHOUT THE PERMISSION OF HONEYWELL.		
INTERPRET PER ASME Y14.5M-1994 OTHER HONEYWELL ENGINEERING STANDARDS MAY APPLY		
Pro/ENGINEER	2D	

Honeywell			
TITLE SWITCH, ROCKER			
SIZE	TYPE	DRAWING NAME	REV
B	I	FRL SERIES CHART 1	B
SCALE	NTS	SHEET	1 OF 1