

used for: D-SUB

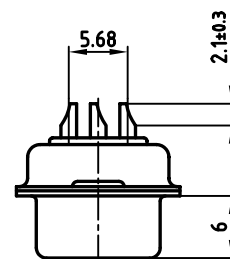

NOTES:

1. METALSHELLS: STEEL; min. 320µ" TIN
2. INSULATORS: PBT GF UL 94 V-0, BLACK
3. CONTACTS: COPPER ALLOY
PLATING: 8µ" HARD GOLD OVER min. 50µ" NICKEL
4. CONNECTOR IS PART MARKED: 301A10079X CONEC Y/WW

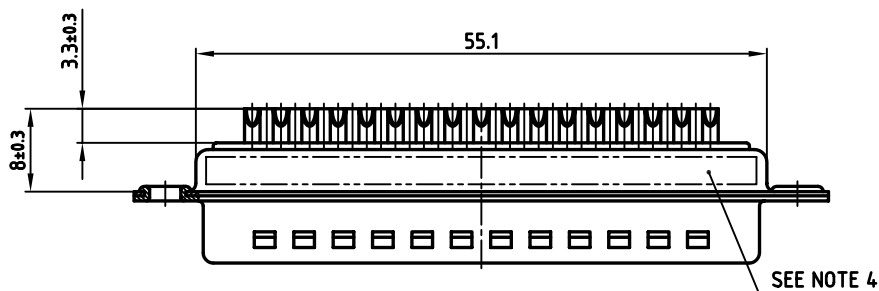
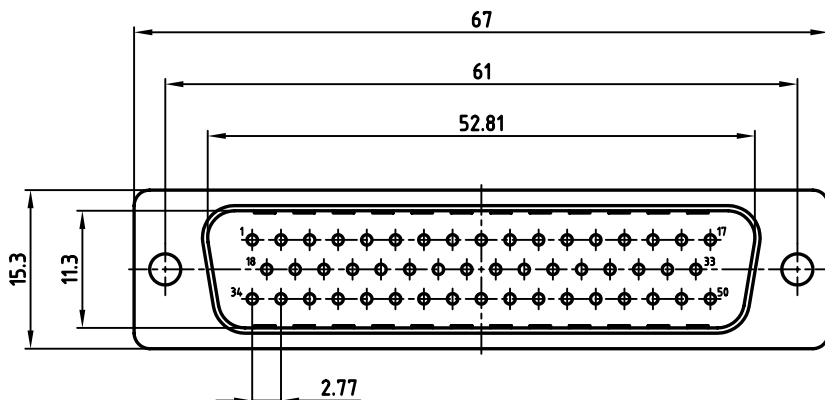

APPROVAL * FREIGABE * DEBLOCAGE * AUTORIZACION * APPROVAL	
CUSTOMER APPROVAL DATE:	
NAME:	TITLE:
COMPANY NAME:	
APPROVAL * FREIGABE * DEBLOCAGE * AUTORIZACION * APPROVAL	

THIS DRAWING MAY NOT BE COPIED OR REPRODUCED IN ANY WAY, AND MAY NOT BE PASSED ON TO A THIRD PARTY, WITHOUT WRITTEN PERMISSION. OWNERSHIP AND COPYRIGHT OF CONEC GmbH. DO NOT ALTER CAD DRAWING BY HAND

rev.	description	date	name

tolerance	dim. in mm	scale: 2:1
material:		SEE NOTES
2003	date	name
drawn	27.05.	Lehmenkühler
appd.	27.05.	Kühle
norm		
d-old		
		title: D-SUB MALE 50pos. SOLDER CUP with stamped contacts
		dwg no: AutoCAD 2000
		DIN-A 3
		sh: 1/1
part no: 16K1A961		part no: 301A10079X