

SHOWN WITH FLB-P7X-001

REVISIONS			
REV	DESCRIPTION, ECN, EAR NO.	DATE	APPD
D	COLOR CODING UPDATED	JUN23/20	S.M
E	PART NUMBER UPDATED	AUG11/20	S.M

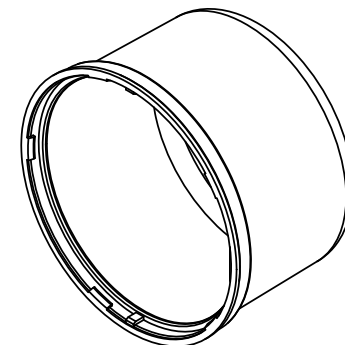

NOTES:
MATERIALS:
HOUSING: POLYCARBONATE, UL 94- 5V A RATED
COLOR AS PER PART NUMBERING SYSTEM

FLB-C70-XX X-001

HEIGHT

XX	"H"	"Y"
35	35 mm	24.9 mm
50	50 mm	39.9 mm
60	60 mm	49.9 mm
75	75 mm	64.9 mm
10	100 mm	89.9 mm
13	130 mm	119.9 mm

COLOUR

- 1 - GREY
- 2 - CLEAR
- 3 - RED
- 4 - BLACK
- 5 - WHITE
- 6 - TRANSLUCENT

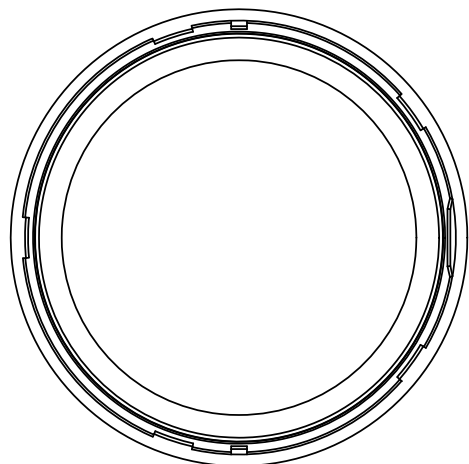

AMPHENOL PART NUMBER: FLB-C70-XXX-001



UNLESS SPECIFIED OTHERWISE	DRAWN	S.MUGAN	MAY 14/20
PRIMARY UNITS MILLIMETERS	CHECKED	A.GREEN	MAY 14/20
SECONDARY	M.E. APPD		
REFERENCE IN PARENTHESES	Q.A. APPD		
GENERAL TOLERANCES	DWG APPR.		
1 DECIMAL PLACE ± 0.2	ENG. REL. NO.		
2 DECIMAL PLACES	REF.		
3 DECIMAL PLACES	THIRD ANGLE PROJECTION		
ANGULAR DEGREES	DO NOT SCALE DRAWING		

Amphenol Canada Corp.			
Commercial Products			
FLB SERIES			
DOME COVER			
MULTIPLE HEIGHTS			
RoHS COMPLIANT			
DWG. NO.	P-FLB-C70-XXX-001		REV E
CODE ID NO.	03554	DWG SIZE: X	SCALE: 1:1 SHEET 1 OF 1