

THIS DRAWING IS A CONTROLLED DOCUMENT.

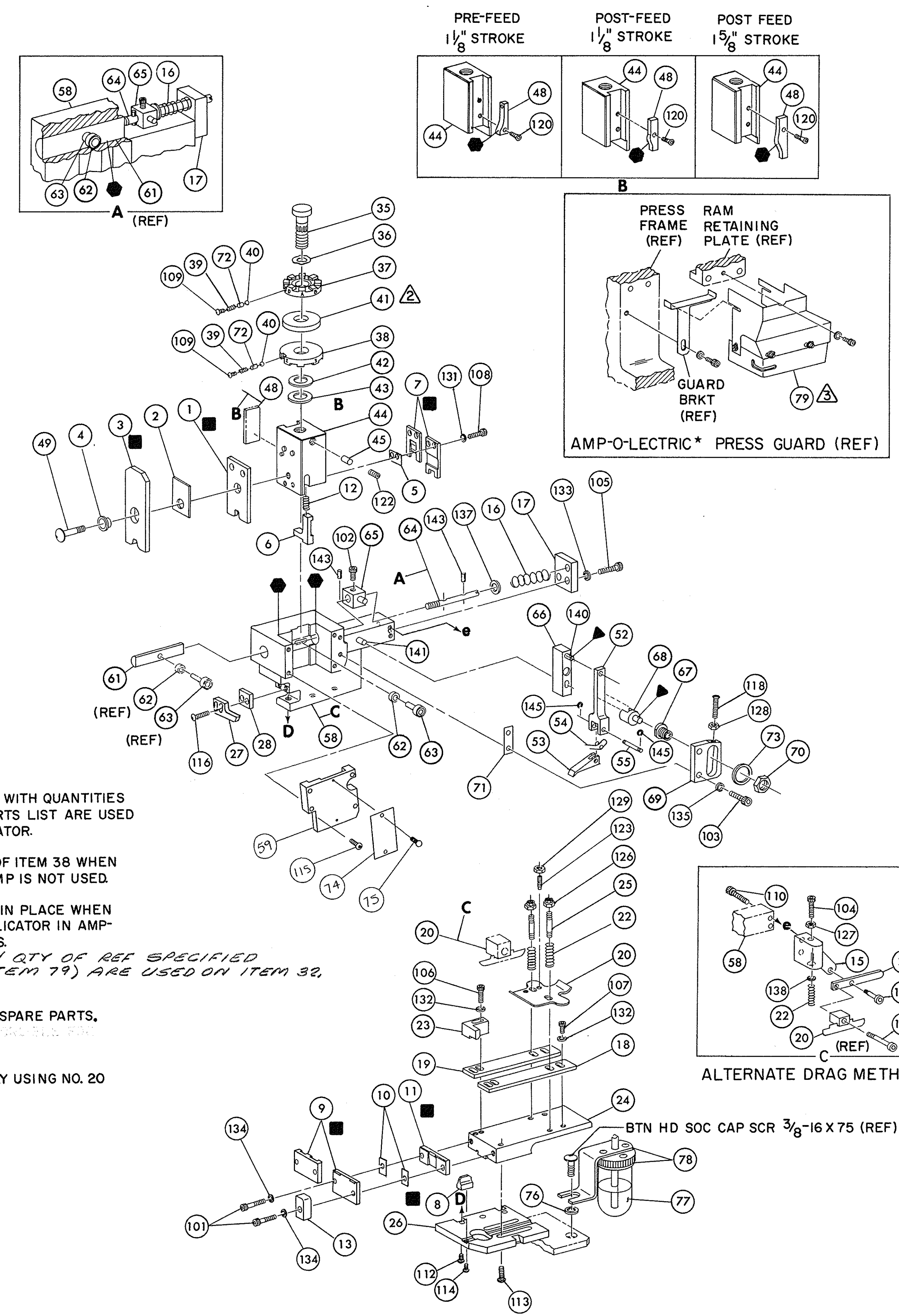

NOTES:

- 1. ONLY THE ITEMS WITH QUANTITIES SPECIFIED ON PARTS LIST ARE USED ON THIS APPLICATOR.
- 2. USED IN PLACE OF ITEM 38 WHEN INSULATION CRIMP IS NOT USED.
- 3. GUARD MUST BE IN PLACE WHEN OPERATING APPLICATOR IN AMP-O-LECTRIC PRESS.
- 4. PARTS WITH QTY OF REF SPECIFIED (EXCEPT ITEM 79) ARE USED ON ITEM 32.

- KEY:**
- RECOMMENDED SPARE PARTS.
 - ▲ LUBRICATE DAILY USING NO. 20 MACHINE OIL.
 - GREASE LIGHTLY.

REF	21045-3	RING, RETAINING 'C' (.187 DIA) FEED PIN	145	REF	454220-1	CAP, RAM	59
				REF	453736-1	HOUSING	58
REF	5-21028-1	PIN, SLOT SPG (.12 DIA X .50) FD ADJ ROD	143				57
			142				56
REF	1-21030-7	PIN, DOWEL (.187 DIA X 1.50) HOUSING	141	REF	240624-1	PIN, FEED FINGER	55
REF	1-21030-1	PIN, DOWEL (.187 DIA X .50) LEVER	140	REF	691499-1	SPRING, FEED FINGER	54
			139	REF	240635-1	FINGER, FEED	53
	22260-5	WASHER, FLAT (NO 6) DRAG SPRING	138	REF	240634-1	LEVER, TERMINAL	52
REF	21899-4	WASHER, FLAT (5/16 DIA) SCR ADJ	137				51
			136				50
REF	21024-5	WASHER, LOCK (NO 10) FEED ADJ PLATE	135	1	7-21002-9	BOLT, CRIMPER	49
2	21024-5	WASHER, LOCK (NO 10) SHEAR PLATES	134	1	690501-4	CAM, POST FEED 15/8 STROKE	48
REF	21024-5	WASHER, LOCK (NO 10) FEED ROD GUIDE	133				47
4	21024-4	WASHER, LOCK (NO 8) STRIP GUIDE	132				46
2	21024-4	WASHER, LOCK (NO 8) SHEAR BLADE	131	1	690191-1	PLUG, NYLON	45
			130	1	455674-2	RAM	44
2	21018-4	NUT, HEX MACH (4-40) DRAG	129	1	690125-1	WASHER, LAMINATED	43
REF	21068-5	NUT, HEX MACH (6-32) FD ADJ PLATE	128	1	690124-1	WASHER, RAM	42
	21018-7	NUT, HEX MACH (10-32) DRAG SPRING	127				41
2	21022-2	NUT, HEX SELF-LKG (8-32) DRAG STUD	126	2	23241-6	BALL, STEEL	40
	5-21004-7	SCR, SKT HD SHLD (250 DIA X .25) DRAG ARM	125	2	690170-1	SPRING, COMPRESSION	39
	21004-5	SCR, SKT HD SHLD (250 DIA X 1.00) DRAG	124	1	690142-1	DISC, INSULATION	38
2	4-21078-8	SCR, SKT SET OVAL POINT (4-40 X .75) DRAG	123	1	4-690141-1	DISC, WIRE	37
1	21009-2	SCR, SKT SET (1/4-20 X 25) (LOC-WEL) RAM	122	1	22480-5	WASHER, SPRING	36
			121	1	690212-1	POST, RAM	35
1	2-21003-0	SCR, FLAT HD SKT CAP (6-32 X .50) CAM	120				34
			119				33
REF	3-21064-2	SCR, RD HD MACH (6-32 X 1.50) FEED ADJ	118	1	458980-1	APPLICATOR, BASIC (SUB ASSY)	32
			117				31
2	2-21002-2	SCR, BTN HD SKT CAP (8-32 X .50) STRIPPER	116				30
REF	2-21002-9	SCR, BTN HD SKT CAP (10-32 X .75) HSG CAP	115				29
1	22733-8	SCR, BTN HD SKT CAP (8-32 X .38) (LOC-WEL) ANVIL	114	1	3-690451-2	SPACER, STRIPPER	28
4	3-21002-3	SCR, BTN HD SKT CAP (1/4-20 X .50) STR GDE PL	113	1	240639-1	STRIPPER	27
REF	1-24073-9	SCR, BTN HD SKT CAP (1/4-20 X .75) BASE PL	112	REF	455676-1	PLATE, BASE	26
			111	2	22354-8	DRAG, STUD	25
	2-21000-4	SCR, SKT HD CAP (6-32 X 1.00) DRAG ADAPTOR	110	1	455678-1	PLATE, STRIP GUIDE	24
2	23030-1	SCR, SKT HD CAP (6-32 X .25) (LOC-WEL) CP DISC	109				23
2	2-21000-5	SCR, SKT HD CAP (8-32 X .25) SHEAR BLADE	108	2	4-22281-1	SPRING, DRAG	22
3	7-21000-4	SCR, SKT HD CAP (8-32 X .31) STRIP GUIDE	107		240636-1	LEVER, DRAG	21
1	7-21000-9	SCR, SKT HD CAP (8-32 X .31) STRIP GUIDE	106	1	454177-1	DRAG, STOCK	20
REF	3-21000-7	SCR, SKT HD CAP (10-32 X .75) FD ROD GUIDE	105	1	453030-8	GUIDE, STRIP (REAR)	19
	3-21000-9	SCR, SKT HD CAP (10-32 X 1.00) DRAG SPRING	104	1	453031-8	GUIDE, STRIP (FRONT)	18
REF	3-21000-6	SCR, SKT HD CAP (10-32 X .62) FD ADJ PLATE	103	REF	454178-1	GUIDE, FEED ROD	17
REF	3-21000-4	SCR, SKT HD CAP (10-32 X .38) PIVOT BLK	102	REF	4-22284-9	SPRING, FEED RETURN	16
2	3-21000-8	SCR, SKT HD CAP (10-32 X .88) SHEAR PLATE	101			ADAPTER, DRAG	15
REF	455745-1	GUARD WINDOW	79				14
	465184-9	LUBRICATOR ASSY	78			SPACER, HOLD DOWN	13
	455985-1	OIL, LUBRICATING	77			SPRING, HOLD DOWN	12
	454406-1	SPACER, LUB BRACKET	76	1	240644-1	PLATE, REAR SHEAR	11
2	21017-2	SCR, DRIVE (#2 X .19) ID PLATE	75			SPACER, SHEAR PLATE	10
1	461264-1	PLATE, ID	74	1	453061-1	PLATE, FRONT SHEAR	9
REF	458109-1	WASHER, FLAT (SPECIAL)	73	1	8-240693-1	ANVIL	8
2	690603-1	SPRING, ASSIST	72	1	453060-1	BLADE, SLUG	7
REF	690517-1	SPACER	71			HOLD DOWN, TERMINAL	6
	22594-8	NUT, HEX	70	1	5-240641-8	SPACER, SHEAR BLADE	5
	240628-1	PLATE, ADJ	69	1	238009-1	SPACER, TUBULAR	4
	240626-1	SHAFT, PIVOT	68	1	3-456134-9	CRIMPER, INSULATION	3
	240633-1	BUSHING	67	1	455888-1	SPACER, INSULATION	2
	455680-1	LEVER, INTERMEDIATE	66	1	456402-2	CRIMPER, WIRE	1
	240629-1	BLOCK, PIVOT	65				
	240632-2	SCREW, ADJ	64				
	240659-3	PIN, CAM ROLLER	63				
	240658-1	CAM, ROLLER	62				
REF	454398-1	ROD, FEED	61				

CRIMPING DATA				APPLICATOR WILL APPLY	
PAD LTR	CRIMP HEIGHT	WIRE SIZE	WIRE STRIP LENGTH		
A	.031	26 OR 24			61653
B	NOT USED				1742057
C	NOT USED				
D	NOT USED				

CRIMP	SIZE	TYPE	FEED	APPL INST
WIRE	.055	F		A18039
INSUL	.090	F	437	
WIRE RANGE	26-24			
INSULATION RANGE	.035-.065			

REMARKS	NO	REV
APPL USED ON MACHINE PART NO	MACH SERIAL NO	DISTRIBUTION
CUSTOMER NAME	APPL SERIAL NO	ORIGINAL
ADDRESS	PURCHASE ORDER	CUSTOMER COPY
CITY	ENG APP	FIELD ENG COPY

RELEASED FOR PUBLICATION 02/27/1997 BY AMP INCORPORATED. ALL RIGHTS RESERVED.

SET UP PAGE 10-1
 458638-1379
 ECN 0150-0394-04 MY/EE 3-04
 0150-9660-99 CE/EE 10-99
 0150-6575-25 US/EE 11-95
 ECN A157688 WS/EE 11-88
 REV FOR REV R5477 2/20/1994
 NAME MINIATURE QUICK CHANGE APPLICATOR
 END FEED (RING)
 AMP INCORPORATED Harrisburg, Pa.
 No 466185-1
 CUSTOMER AND ASSEMBLY DRAWING