

REVISION HISTORY			
REV	DESCRIPTION	DATE	APPROVED
-	NRN 45756	04/21	SEE PDM
A	DCN 50729	05/21	
B	DCN 51513	04/22	

# PRODUCT DATA DRAWING

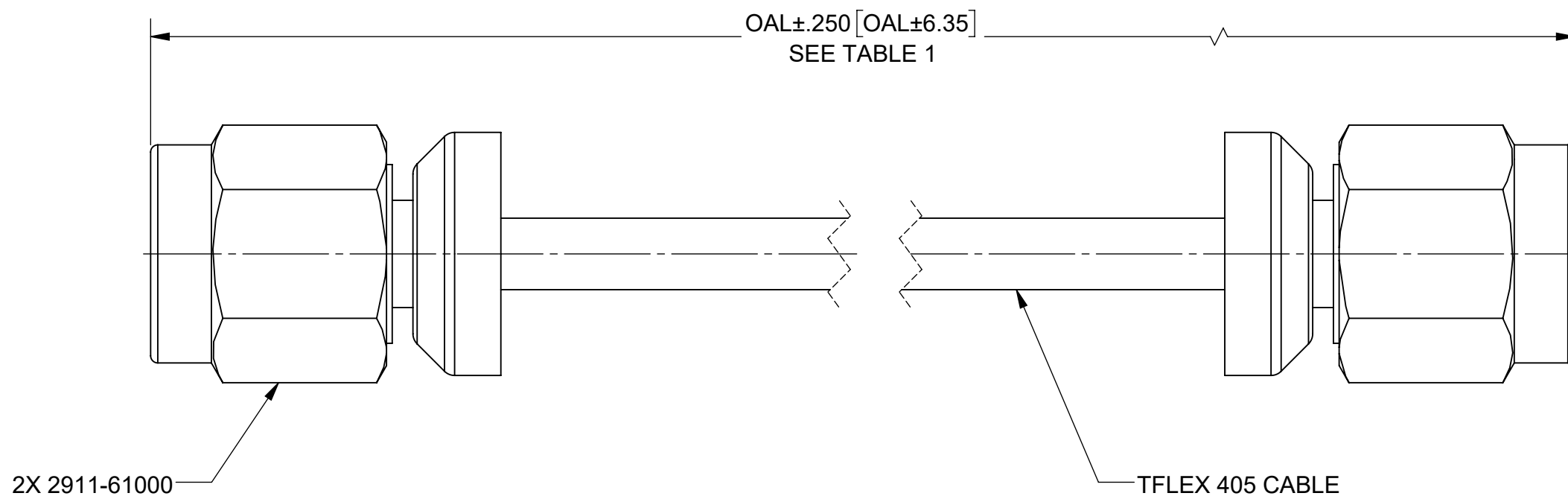
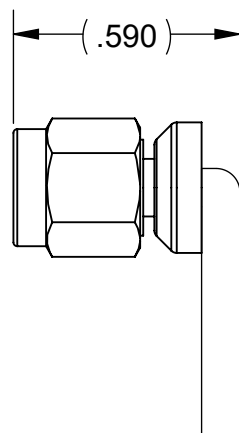

SV P/N	OAL
7029-3637	6.000"
7029-3638	12.000"

**MATERIAL:**

CONNECTORS: 2X 2911-61000 (SMA STRAIGHT MALE LOW PROFILE RF)

CABLE: 200-70-139 (TFLEX 405 HF CABLE)

**PERFORMANCE:**

IMPEDANCE: 50 OHMS  
 FREQ. RANGE: DC TO 18 GHZ

MATERIAL: PER BOM	DIMENSIONS ARE IN INCHES TOLERANCES:	UNLESS OTHERWISE SPECIFIED	<p>Amphenol www.svmicrowave.com</p>
FINISH: PER BOM	FRACTIONAL: $\pm 1/64$ ANGULAR: X° $\pm 1'0''$ X°X' $\pm 15''$ DECIMAL: X $\pm .030$ .XX $\pm .010$ .XXX $\pm .005$	1) ALL DIMENSIONS ARE AFTER PLATING. 2) BREAK CORNERS & EDGES .005 R. MAX. 3) CHAM. 1ST & LAST THREADS. 4) SURFACE ROUGHNESS 63 / MIL-STD-10. 5) DIA.'S ON COMMON CENTERS TO BE CONCENTRIC WITHIN .005 T.I.R. 6) REMOVE ALL BURRS	
PROPRIETARY THE INFORMATION CONTAINED IN THIS DRAWING IS THE SOLE PROPERTY OF SV MICROWAVE, INC. ANY REPRODUCTION IN PART OR AS A WHOLE WITHOUT THE WRITTEN PERMISSION OF SV MICROWAVE, INC IS PROHIBITED.	INTERPRET DIMENSIONS AND TOLERANCES PER ASME Y14.5M - 1994 THIRD ANGLE PROJECTION 	DRAWN: TSW 04/20/21 CHECKED: SEE PDM APPROVED: SEE PDM E.M. SIMULATION: N/A	TITLE: SMA STR. M TO SMA STR. M TFLEX405 LOW PROFILE RF CABLE ASSEMBLY SIZE DWG. NO. B 7029-3637-3638 SCALE: 5:1