

"High Frequency Ceramic Solutions"

2.45 GHz Band Pass Filter

P/N 2450BP41D100B

Detail Specification 02/12/2003

Page 1 of 2

| Part Number | Frequency (MHz) | Insertion Loss | Attenuation (min.) | Return Loss | Ripple |
|---------------|-----------------|----------------|--|-------------|-------------|
| 2450BP41D100B | 2450 ± 50 | 1.3 dB max | 30 dB @ 880 - 915 MHz 30 dB @ 1.71 - 1.785 GHz 20 dB @ 1.85 - 1.91 GHz 25 dB @ 4.8 - 5.0 GHz 20 dB @ 7.2 - 7.5 GHz | 9.5 dB min. | 0.7 dB max. |

| Input Power | Group Delay | Impedance | Operating Temperature Range |
|---------------|-------------|-----------|-----------------------------|
| 500 mWatt max | 5 nsec max | 50 Ω | -40 to +85°C |

Mechanical Dimensions

| | L | W | T | a | b | c |
|--------|--------------|--------------|--------------|--------------|--------------|--------------|
| Inches | 0.126 ± .008 | 0.098 ± .008 | 0.059 ± .004 | 0.016 ± .008 | 0.024 ± .008 | 0.012 ± .006 |
| mm | 3.2 ± 0.2 | 2.5 ± 0.2 | 1.5 ± 0.1 | 0.4 ± 0.2 | 0.6 ± 0.2 | 0.30 ± 0.15 |

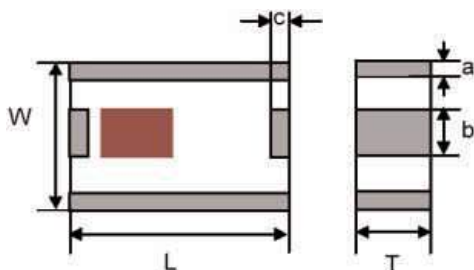

Terminal Configuration

| No. | Function | No. | Function |
|-----|----------|-----|----------|
| 1 | GND | 3 | GND |
| 2 | OUT | 4 | IN |

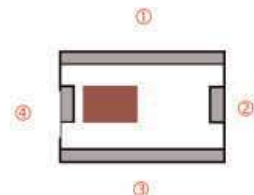

Mounting Considerations

Pats should be mounted with colored side facing UP.

Line width should be designed to provide 50Ω impedance matching characteristics.

Units: mm

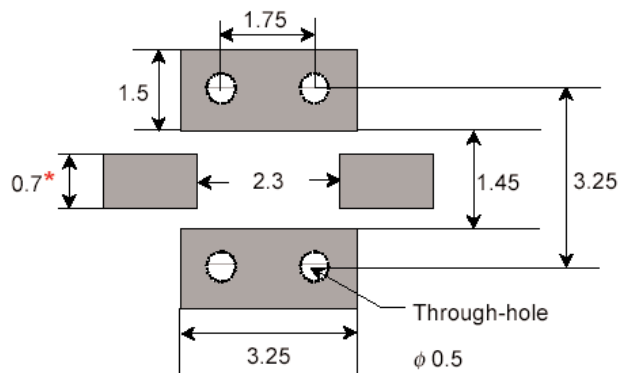

Johanson Technology, Inc. reserves the right to make design changes without notice.
All sales are subject to Johanson Technology, Inc. terms and conditions.

“High Frequency Ceramic Solutions”

2.45 GHz Band Pass Filter

Detail Specification 02/12/2003

P/N 2450BP41D100B

Page 1 of 2

