

REVISIONS			
REV	DESCRIPTION, ECN, EAR NO.	DATE	APP'D
A	PROPOSAL	02/23/17	L.CHAN
B	PER ECN07263	DEC25/17	L.CHAN
C	UPDATE DRAWING	NOV10/17	L.CHAN
D	MODIFY THE LAYOUT	JUL31/18	L.CHAN

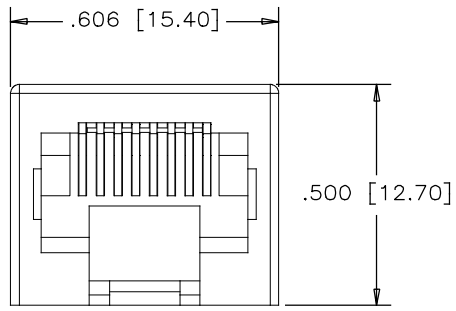

FRONT VIEW

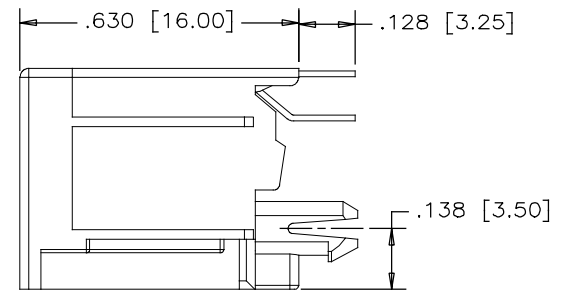

SIDE VIEW

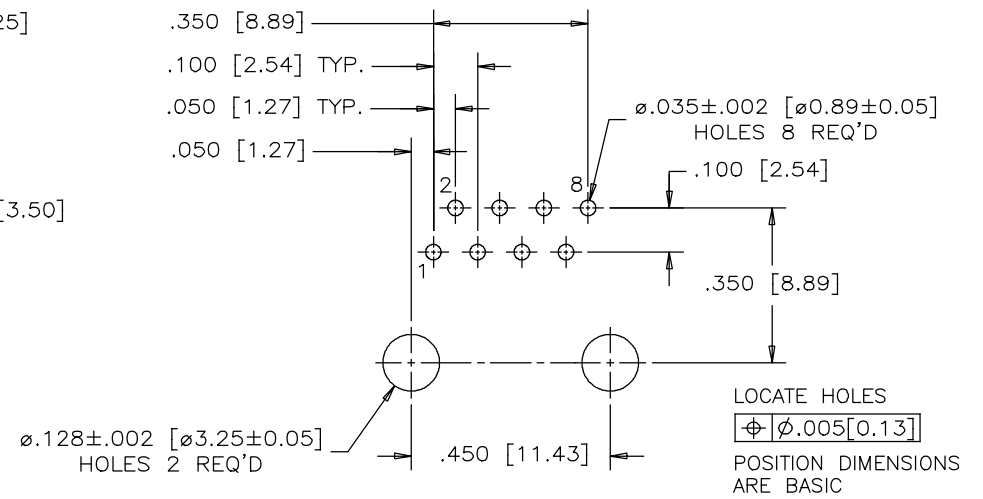

RECOMMENDED P.C.B. LAYOUT
 (COMPONENT SIDE OF BOARD)
 TOLERANCE: ± 0.05 (TOP VIEW)

MATERIALS:
 PLASTIC HOUSING: ENGINEERING THERMOPLASTIC
 FLAMMABILITY RATING UL94V-0, COLOR: BLACK.

CONTACTS:
 PHOSPHOR BRONZE
 PLATING: SELECTIVE GOLD PLATING ON MATING SURFACES
 SEE AMPHENOL PART NUMBER FOR DETAIL.
 50 μ " [1.27 MICRONS]
 MIN. NICKEL UNDERPLATE.
 100 μ " [2.54 MICRONS]
 MIN. MATTE-TIN OR GOLD FLASH ON CONTACT TAILS.

RECOMMENDED SOLDERING TEMPERATURE:
 WAVE SOLDERING AT 240°C MAXIMUM FOR 5 SEC MAXIMUM

PART NUMBER: RJE06-188-0X10

GOLD PLATING:
 1 = 6 μ "
 2 = 15 μ "
 3 = 30 μ "
 4 = 50 μ "

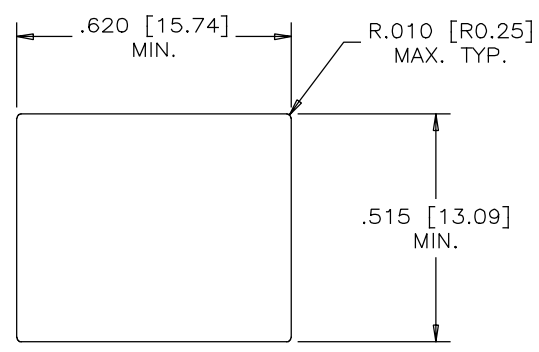

RECOMMENDED PANEL CUTOUT



UNLESS SPECIFIED OTHERWISE	DRAWN L.CHAN	DATE 02/23/01	Amphenol Canada Corp. Commercial Products
PRIMARY UNITS MILLIMETER	CHECKED J.SI	02/23/01	
SECONDARY INCH	M.E. APP'D		TITLE
REFERENCE IN PARENTHESES	Q.A. APP'D		RJE06 SERIES, 8 POSITION 8 CONTACT, VERTICAL MOUNT, UNSHIELD WITHOUT FLANGE - RoHS COMPLIANT
GENERAL TOLERANCES	DWG APPR.		DWG. NO.
1 DECIMAL PLACE ± 0.38	ENG. REL. NO.		P-RJE06-188-0X10
2 DECIMAL PLACES ± 0.25	REF. EAR#: 11306		REV
3 DECIMAL PLACES ± 0.20	THIRD ANGLE PROJECTION	DO NOT SCALE DRAWING	D
ANGULAR DEGREES $\pm 1.0^\circ$			CODE ID NO. 03554 DWG SIZE: C SCALE: N/A SHEET 1 OF 1