

REVISIONS

P	LTR	DESCRIPTION	DATE	DWN	APVD
G1		NOTE 1 0.76μm PLATING UPDATE (PdNi+AuFLASH)	11JUL2023	BGC	PS

POS. PER ROW	L +0.3 -0.5	PART-NO.
2	5.08	825457 -2
3	7.62	-3
4	10.16	-4
5	12.70	-5
6	15.24	-6
7	17.78	-7
8	20.32	-8
9	22.86	-9
10	25.40	1-
11	27.94	1-
12	30.48	1-
13	33.02	1-
14	35.56	1-
15	38.10	1-
16	40.64	1-
17	43.18	1-
18	45.72	1-
19	48.26	1-
20	50.80	2-
21	53.34	2-
22	55.88	2-
23	58.42	2-
24	60.96	2-
25	63.50	2-
26	66.04	2-
27	68.58	2-
28	71.12	2-
29	73.66	2-
30	76.20	3-
31	78.74	3-
32	81.28	3-
33	83.82	3-
34	86.36	3-
35	88.90	3-
36	91.44	3-
37	93.98	3-
38	96.52	3-
39	99.06	3-
40	101.60	4-
41	104.14	4-
42	106.68	4-
43	109.22	4-
44	111.76	4-
45	114.30	4-
46	116.84	4-
47	119.38	4-
48	121.92	4-
49	124.46	4-
50	127.00	5- 825457 -0

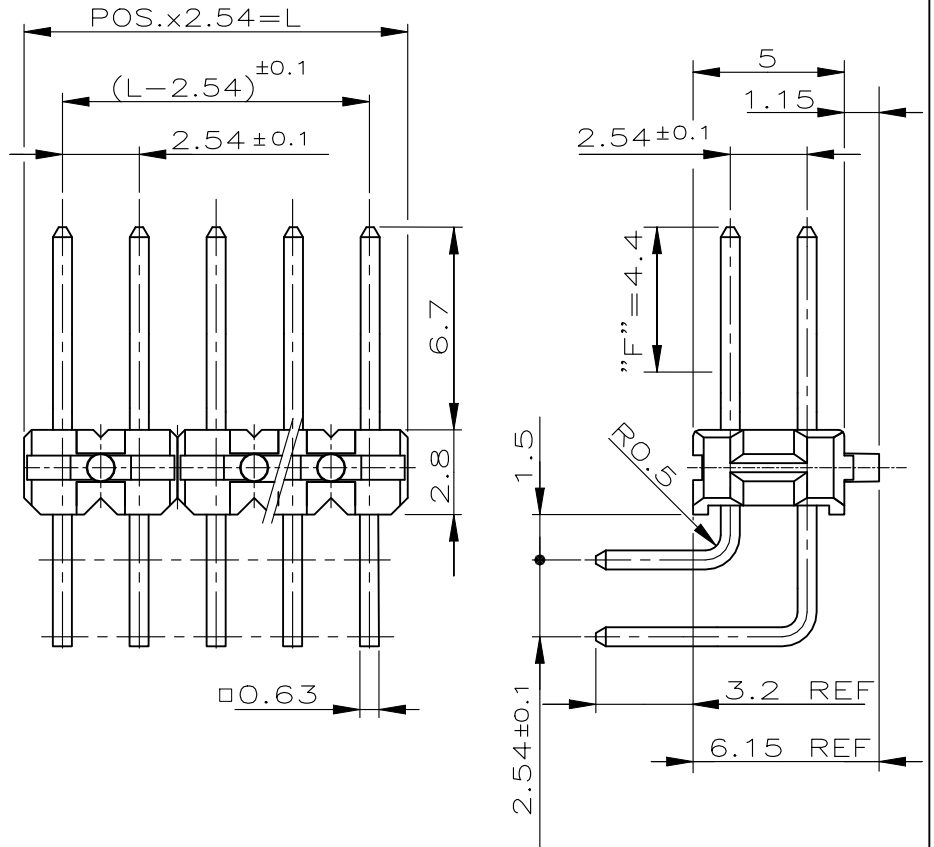

① MATING SIDE: Min 0.76μm (PdNi + Au FLASH) IN ZONE "F" OVER Min 1.27μm Ni
 (Alternative plating - Min 0.76μm Au OVER Min 1.27μm Ni)
 SOLDER SIDE : 3-5μm TIN OVER 1.27μm NICKEL AT SOLDER AREA

② OBSOLETE PARTS

③ OBSOLETE PARTS: OBSOLETE CIS STREAMLINING PER D.RENAUD/D.SINISI

CONTACT PIN	CuZn	①
HOUSING	PBT GV	GREEN
DESCRIPTION	MATERIAL	REMARK

REMOVE BURRS,
BREAK SHARP EDGES

TE Connectivity. All Rights Reserved.



DIMENSIONS: mm	DWN	05FRB1995	MATERIAL	SEE TABLE	FINISH	SEE TABLE
	CHK	17DE1995	TE Connectivity			
TOLERANCES UNLESS OTHERWISE SPECIFIED: ± 0.2 mm	APVD	-				
0 PLC ± -	PRODUCT SPEC	108-18012	NAME	AMPMODU II PIN HEADER 90 DEGREE, DUAL ROW		
1 PLC ± -	APPLICATION SPEC	-	SIZE	CAGE CODE	DRAWING NO	RESTRICTED TO
2 PLC ± -			A4	00779	③-825457	-
3 PLC ± -						
4 PLC ± -						
ANGLES ± -	WEIGHT	-				
	CUSTOMER DRAWING		SCALE	4:1	SHEET	1 OF 1
						REV G1