

1

2

3

4

NOTES:

- 1-Material:phosphor bronze,thickness 0.20
- 2-Finish on contact area:see table
finish on termination:bright tin over nickel
- 3-Wire range:24-28 AWG
- 4-Max outer dia of wire insulator:1.02 mm
- 5-Current carrying capacity per contact:
 - 3.Amps max when crimped to #24 AWG
 - 2 Amps max when crimped to #26 AWG
 - 1 Amps max when crimped to #28 AWG
- 6-After 5 insertions into connector,
contact retention must be 5 pounds axial load min
- 7-When contact is crimped to 24 AWG,the insulation
support crimped height must be 1.78 mm max to ensure
a proper insertion into housing
- 6-Packaging:Box of 500 contacts

NOTE : ROHS INFORMATIONS

The LF products meet European union directives and other
country regulations as described in GS-22-008
Terminations plating spec : 2um Nickel min + 2um Sn min
Packaging Spec : see GS-14-920

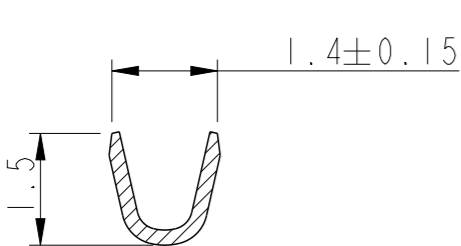
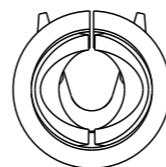
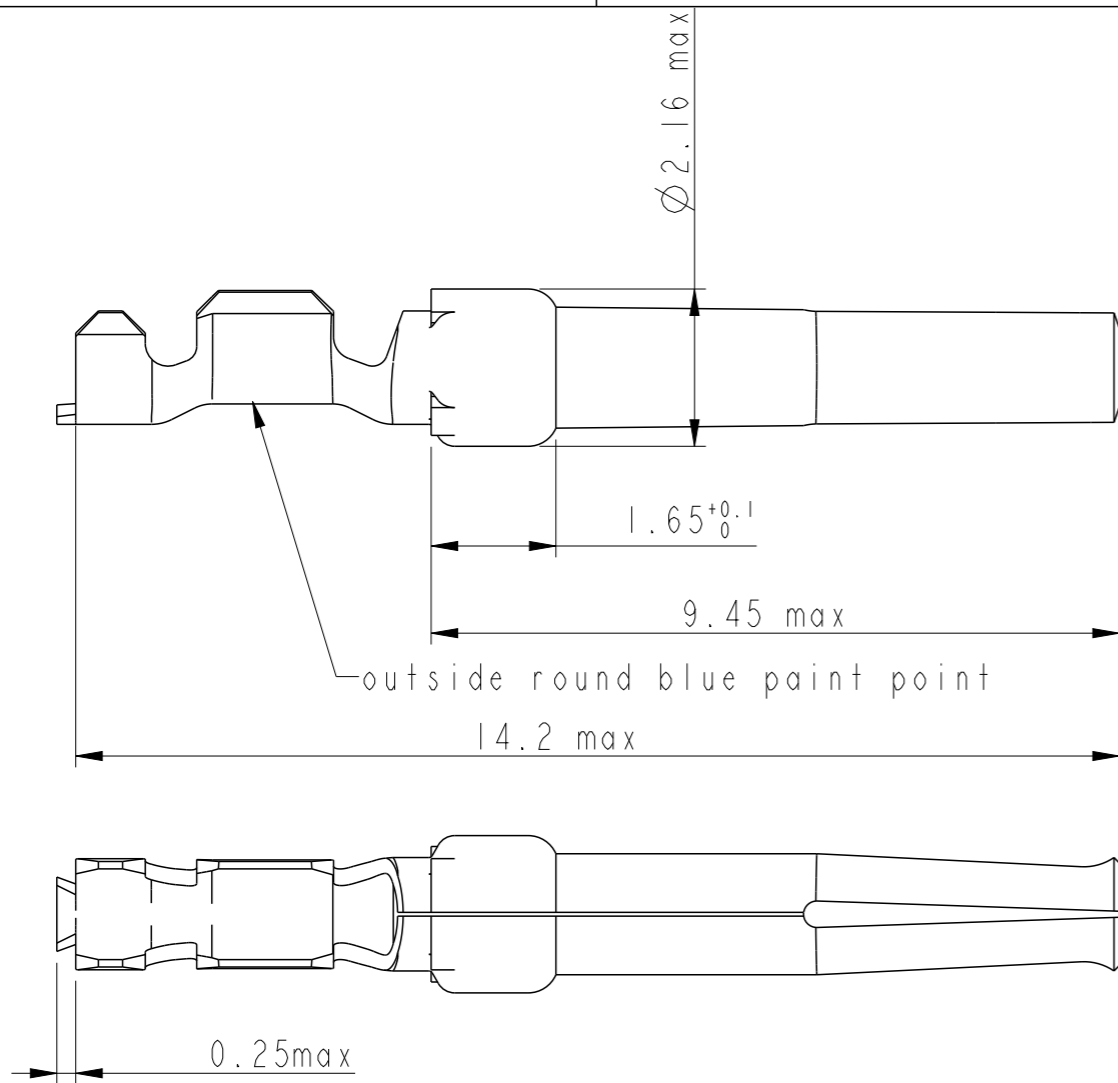

SECTION A-A

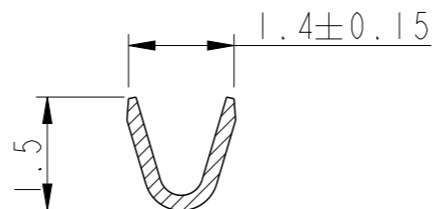

SECTION B-B

PART NUMBER	Plating
8656451067LF	0.4μ Au / GXT
8656451067	0.4μ Au / GXT

www.fciconnect.com		surface - ✓ ISO 1302	tolerance std ISO 406 ISO 1101	projection mm
TOLERANCES UNLESS OTHERWISE SPECIFIED				
Dr	C JARRY	1997-01-28	ANGULAR	size A3
Eng	ABHILASH M R	2009-07-07	LINEAR	Scale 10:1
Chr	ABHILASH M R	2009-07-07	0° ±2°	ECN 111-0003
Appr	SUDHIR VARMA	2009-07-07	Product family	Spec ref
FCi		CRIMP SOCKET		Rev. J
		#Wire 24-28 Ø1.02 max		dwg no C01-8656-0418
catalog no		CUSTOMER		sheet 1 of 1

rev	ecn no	dr	date
C	LS06-196	MPE	27/11/2006
D	LS08-0127	MPE	13/05/2008
E	LS08-0216	MPE	26/11/2008
F	109-0128	AMR	2009-07-07
G	109-0152	AMR	2009-07-29
H	110-0070	AMR	2010-03-09
J	111-0003	AMR	2011-01-06

1

2

3



Copyright FCI.