

NUMBER 576131

3RD ANGLE (AMERICAN) PROJECTION

DIMENSIONS IN FIGURES. DO NOT SCALE PRINT DIMENSIONS TRUS | IN INCH.

.010 RADS $\pm .005$ TYP
[D.25 + 0.127]

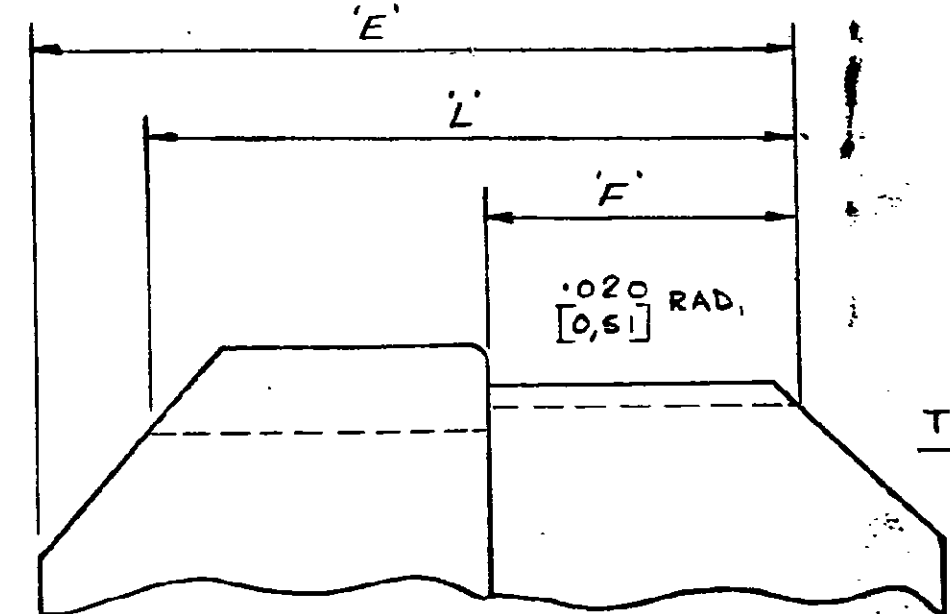
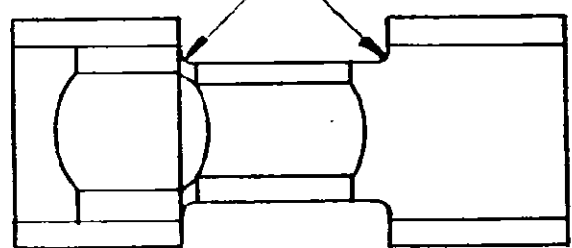

TYPE III

NOTES

- 1) FINISH GRIND AFTER HEAT TREAT
- 2) WHEN DIM B IS USED, PART TO BE CUT OUT ALONG DOTTED LINE AS SHOWN.

TYPE I

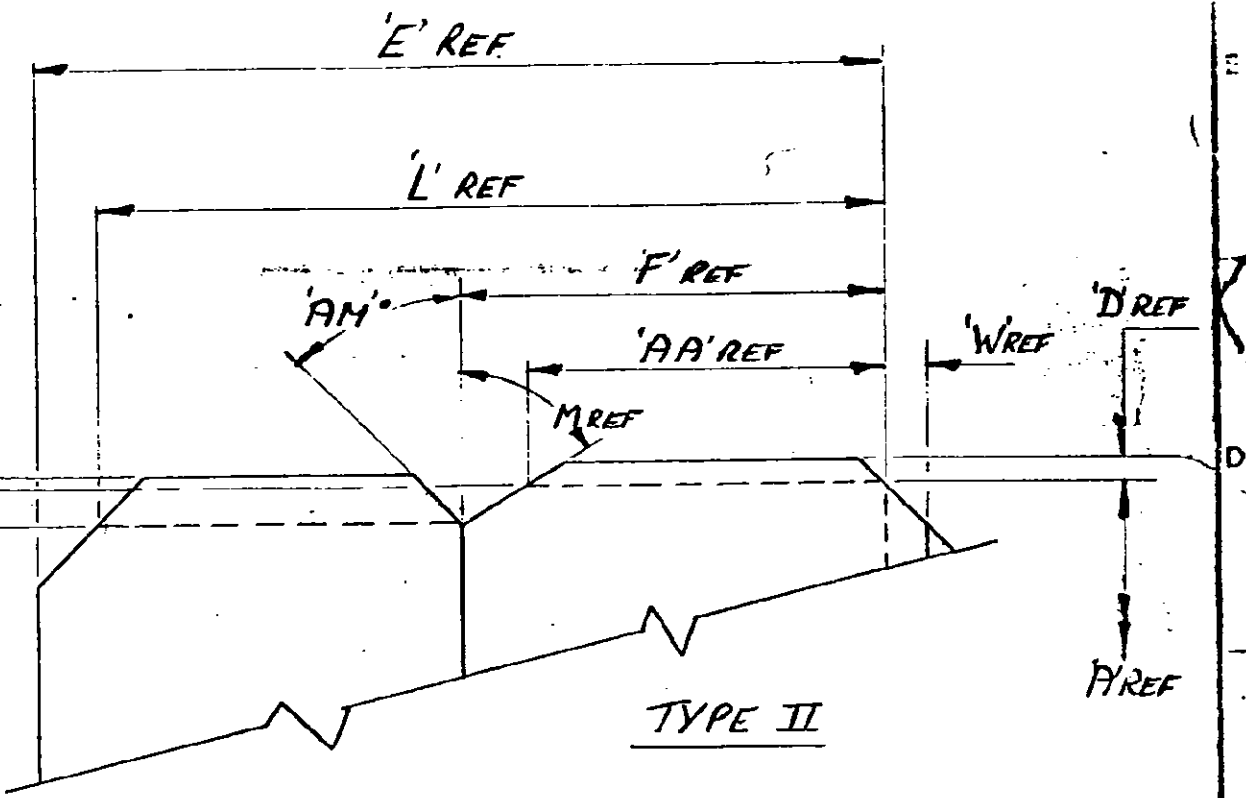
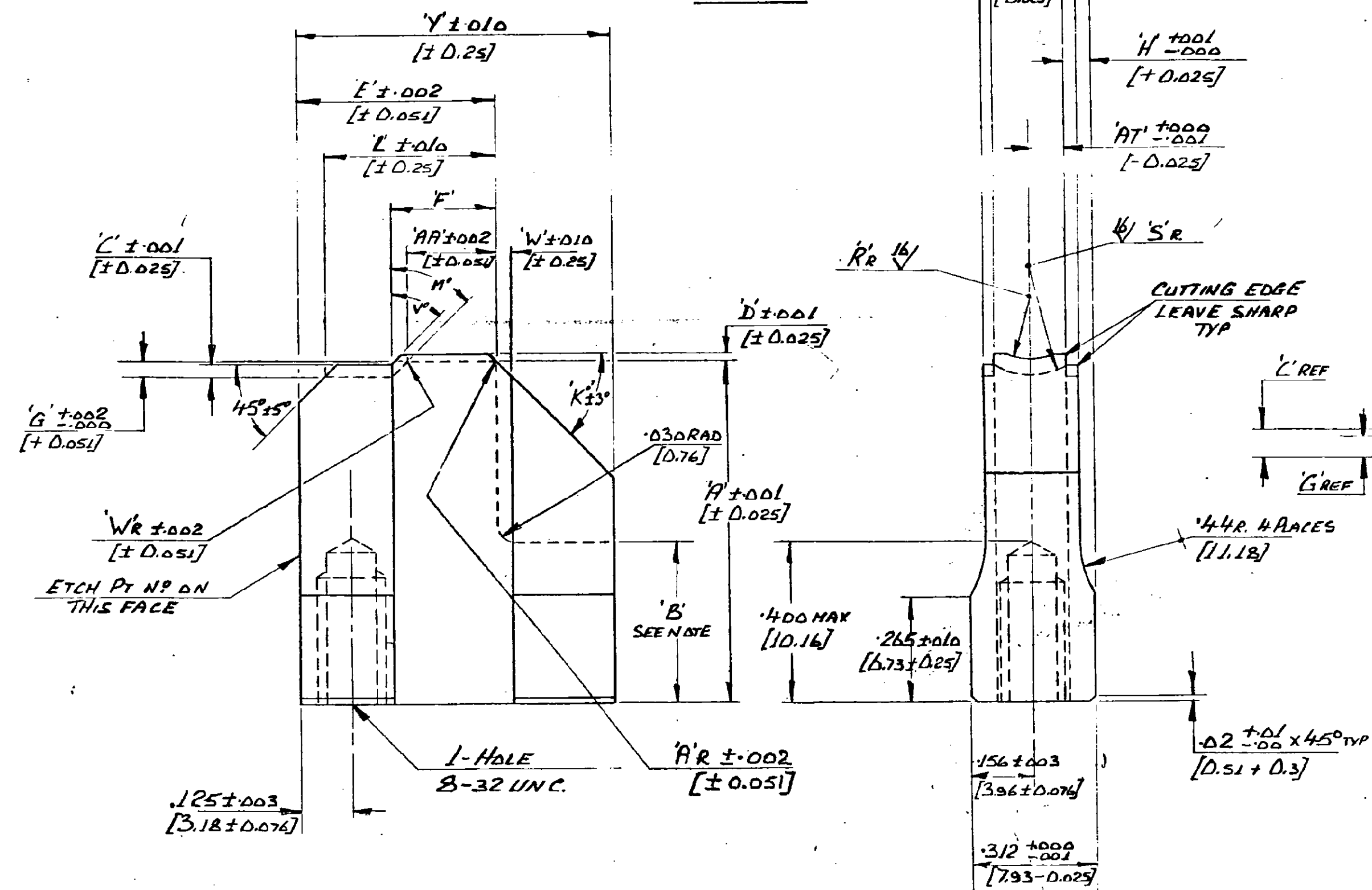

TYPE II

SHEET 1 OF 5

This information is confidential and is disclosed to you on condition that you will not disclose it to any other person without written authorization from AIRCRAFT-MARINE PRODUCTS (GREAT BRITAIN) LTD.

REV	DATE	BY	CHKD	DESCRIPTION	REV	DATE	BY	CHKD	DESCRIPTION
1	10-24-50	W.C.		1-4 ADDED	1	10-24-50	W.C.		1-4 ADDED
2	11-1-50	W.C.		REV AS PER ECN	2	11-1-50	W.C.		REV AS PER ECN
3	11-1-50	W.C.		1-2 DIM J WAS .091	3	11-1-50	W.C.		1-2 DIM J WAS .091
4	11-1-50	W.C.		REV AS PER ECN	4	11-1-50	W.C.		REV AS PER ECN
5	11-1-50	W.C.		1-0 DIM WERE 1.00	5	11-1-50	W.C.		1-0 DIM WERE 1.00
6	11-1-50	W.C.		REV AS PER ECN	6	11-1-50	W.C.		REV AS PER ECN
7	11-1-50	W.C.		AS PER ECN	7	11-1-50	W.C.		AS PER ECN
8	11-1-50	W.C.		AS PER ECN	8	11-1-50	W.C.		AS PER ECN
9	11-1-50	W.C.		AS PER ECN	9	11-1-50	W.C.		AS PER ECN
10	11-1-50	W.C.		AS PER ECN	10	11-1-50	W.C.		AS PER ECN
11	11-1-50	W.C.		AS PER ECN	11	11-1-50	W.C.		AS PER ECN
12	11-1-50	W.C.		AS PER ECN	12	11-1-50	W.C.		AS PER ECN
13	11-1-50	W.C.		AS PER ECN	13	11-1-50	W.C.		AS PER ECN
14	11-1-50	W.C.		AS PER ECN	14	11-1-50	W.C.		AS PER ECN
15	11-1-50	W.C.		AS PER ECN	15	11-1-50	W.C.		AS PER ECN
16	11-1-50	W.C.		AS PER ECN	16	11-1-50	W.C.		AS PER ECN
17	11-1-50	W.C.		AS PER ECN	17	11-1-50	W.C.		AS PER ECN
18	11-1-50	W.C.		AS PER ECN	18	11-1-50	W.C.		AS PER ECN
19	11-1-50	W.C.		AS PER ECN	19	11-1-50	W.C.		AS PER ECN
20	11-1-50	W.C.		AS PER ECN	20	11-1-50	W.C.		AS PER ECN
21	11-1-50	W.C.		AS PER ECN	21	11-1-50	W.C.		AS PER ECN
22	11-1-50	W.C.		AS PER ECN	22	11-1-50	W.C.		AS PER ECN
23	11-1-50	W.C.		AS PER ECN	23	11-1-50	W.C.		AS PER ECN
24	11-1-50	W.C.		AS PER ECN	24	11-1-50	W.C.		AS PER ECN
25	11-1-50	W.C.		AS PER ECN	25	11-1-50	W.C.		AS PER ECN
26	11-1-50	W.C.		AS PER ECN	26	11-1-50	W.C.		AS PER ECN
27	11-1-50	W.C.		AS PER ECN	27	11-1-50	W.C.		AS PER ECN
28	11-1-50	W.C.		AS PER ECN	28	11-1-50	W.C.		AS PER ECN
29	11-1-50	W.C.		AS PER ECN	29	11-1-50	W.C.		AS PER ECN
30	11-1-50	W.C.		AS PER ECN	30	11-1-50	W.C.		AS PER ECN
31	11-1-50	W.C.		AS PER ECN	31	11-1-50	W.C.		AS PER ECN
32	11-1-50	W.C.		AS PER ECN	32	11-1-50	W.C.		AS PER ECN
33	11-1-50	W.C.		AS PER ECN	33	11-1-50	W.C.		AS PER ECN
34	11-1-50	W.C.		AS PER ECN	34	11-1-50	W.C.		AS PER ECN
35	11-1-50	W.C.		AS PER ECN	35	11-1-50	W.C.		AS PER ECN
36	11-1-50	W.C.		AS PER ECN	36	11-1-50	W.C.		AS PER ECN
37	11-1-50	W.C.		AS PER ECN	37	11-1-50	W.C.		AS PER ECN
38	11-1-50	W.C.		AS PER ECN	38	11-1-50	W.C.		AS PER ECN
39	11-1-50	W.C.		AS PER ECN	39	11-1-50	W.C.		AS PER ECN
40	11-1-50	W.C.		AS PER ECN	40	11-1-50	W.C.		AS PER ECN
41	11-1-50	W.C.		AS PER ECN	41	11-1-50	W.C.		AS PER ECN
42	11-1-50	W.C.		AS PER ECN	42	11-1-50	W.C.		AS PER ECN
43	11-1-50	W.C.		AS PER ECN	43	11-1-50	W.C.		AS PER ECN
44	11-1-50	W.C.		AS PER ECN	44	11-1-50	W.C.		AS PER ECN
45	11-1-50	W.C.		AS PER ECN	45	11-1-50	W.C.		AS PER ECN
46	11-1-50	W.C.		AS PER ECN	46	11-1-50	W.C.		AS PER ECN
47	11-1-50	W.C.		AS PER ECN	47	11-1-50	W.C.		AS PER ECN
48	11-1-50	W.C.		AS PER ECN	48	11-1-50	W.C.		AS PER ECN
49	11-1-50	W.C.		AS PER ECN	49	11-1-50	W.C.		AS PER ECN
50	11-1-50	W.C.		AS PER ECN	50	11-1-50	W.C.		AS PER ECN

MATERIAL 100-43 R.P. 5L-56 112-157

HEAT TREAT III-U.S.

FINISH 32J

REMOVE BURRS, BREAK SHARP EDGES .015 [0.38] R. MAX.
90 ± .02 [0.51]
9000 ± .005 [0.013]
ANGLES: ± 0° 30'

FIRST USED WIRE RANGE CLASS TYPE

SCALE NTS

AMP industrial A DIVISION OF AIRCRAFT-MARINE PRODUCTS (GREAT BRITAIN) LTD. STANMORE, MIDDLESEX

LOC E C No. 576131 SHY 1 OF 5 1BZ

NAME COMB ANIP MINI APPLICATOR

REVISION RECORD

576131

This information is confidential and is disclosed to you on the basis of a disclosure made by you to other than AMP Personnel with the exception of those persons who are authorized to receive such information from AMP AIRCRAFT MARINE PRODUCTS (GREAT BRITAIN) LTD.

PART N°	T	N	AT	AA	F	L	E	Y	G	M°	V°	WR	C	SR	D	Rr	J	H	W	A	K	B	AM°	AR	DATE	FIRST USED	DR	CL	TYPE
576131-1	INS=0.55 H/H=1.4	0.96	0.275	1.20	1.37	2.50	4.78	5.93	0.10	60°	-	-	0.028	0.090	0.002	0.090	1.08	1.29	0.63	0.20	45°	-	30°	#	-	576012			II
576131-2	INS=1.20 H/H=3.04	1.76	0.60	1.25	1.45	3.43	4.68	5.93	0.20	45°	-	-	0.20	1.87	0.10	1.25	0.68	0.96	0.63	0.20	45°	-	45°	#	10-4-69	576015			II
576131-3	INS=0.62 H/H=1.57	0.76	0.31	1.25	1.35	2.80	4.68	5.93	0.10	45°	-	-	0.05	0.90	-	-	1.18	1.25	0.63	0.20	45°	-	45°	#	16-5-69	576019			II
576131-4	INS=0.90 H/H=2.29	1.16	0.45	1.64	1.84	3.12	4.68	5.93	0.20	45°	-	-	0.13	0.90	0.06	0.90	0.98	1.11	0.63	0.20	45°	-	45°	#	-	576025			II
576131-5	INS=0.51 H/H=1.3	0.51	0.255	1.15	1.25	2.80	4.68	5.93	0.10	45°	-	-	-	-	-	-	1.30	1.30	0.63	0.20	45°	-	-	#	-	576026			I
576131-6	INS=1.50 H/H=3.57	2.46	0.90	2.00	2.20	4.40	4.78	5.93	0.20	45°	-	-	0.20	1.87	0.19	1.87	0.33	0.66	0.63	0.10	45°	-	45°	#	-	576037			II
576131-7	INS=1.40 H/H=3.56	2.06	0.70	1.90	2.20	4.40	4.68	5.93	0.20	45°	-	-	0.22	1.56	0.11	1.87	0.53	0.66	0.20	0.20	45°	-	45°	#	-	576037			II
576131-8	INS=0.62 H/H=1.57	0.96	0.31	1.25	1.37	2.80	4.68	5.93	0.12	45°	-	-	0.08	0.90	-	-	1.08	1.25	0.63	0.20	45°	-	45°	#	-	576046			II
576131-9	INS=0.80 H/H=2.03	1.06	0.40	1.25	1.41	2.80	4.68	5.93	0.16	45°	-	-	0.13	0.90	0.06	0.90	1.03	1.16	0.63	0.20	45°	-	45°	#	-	576047			II
1-576131-0	INS=0.90 H/H=2.29	1.00	0.45	1.35	1.52	3.00	4.68	5.93	0.18	45°	-	-	0.20	0.50	0.07	0.90	1.06	1.11	-	0.20	45°	-	-	#	-	576018			I
1-576131-1	INS=1.20 H/H=3.05	2.46	0.60	1.55	1.95	4.22	4.68	5.93	0.50	39°	-	-	0.22	3.00	0.10	1.25	0.33	0.96	0.63	0.20	60°	-	51°	#	-	-	-		II
1-576131-2	INS=0.80 H/H=2.03	1.26	0.40	1.25	1.37	4.08	4.68	5.93	0.12	45°	-	-	0.11	1.25	0.06	0.90	0.93	1.16	0.30	0.20	45°	-	45°	#	-	576091			II
1-576131-3	INS=0.70 H/H=1.77	1.16	0.35	1.25	1.39	2.80	4.68	5.93	0.14	45°	-	-	0.10	1.25	0.03	0.90	0.98	1.21	0.30	0.20	45°	-	45°	#	-	576096			II
1-576131-4	INS=1.00 H/H=2.54	1.51	0.50	2.18	2.70	4.68	4.68	5.93	0.45	49°	NOT REQD	NOT REQD	0.13	1.87	0.07	1.25	0.80	1.06	0.63	0.20	45°	NOT REQD	30°	#	18-9-73	576519			II
1-576131-5	INS=0.80 H/H=2.03	1.51	0.40	1.70	1.70	3.50	4.68	5.93	0.10	NOT REQD	NOT REQD	NOT REQD	0.39	0.77	0.06	0.90	0.80	1.16	0.30	0.20	45°	NOT REQD	NOT REQD	#	-	576500 & 576500-1			III
1-576131-6	INS=1.55 H/H=3.94	2.06	0.75	1.93	2.45	3.90	3.90	7.50	0.50	60°	NOT REQD	NOT REQD	0.25	1.25	0.13	1.87	0.53	0.78	0.50	0.20	45°	NOT REQD	30°	#	-	576519-1			II
1-576131-7	INS=0.80 H/H=2.03	1.06	0.40	1.40	1.57	3.05	4.78	5.70	0.10	60°	NOT REQD	NOT REQD	0.23	0.55	0.06	0.90	1.03	1.16	0.25	0.20	45°	NOT REQD	30°	#	-	576032			II
1-576131-8	INS=1.20 H/H=3.05	1.66	0.60	2.18	2.70	4.68	4.68	5.93	0.30	60°	NOT REQD	NOT REQD	0.17	1.87	0.11	1.25	0.73	0.96	0.63	0.20	45°	NOT REQD	30°	#	-	576519			II
1-576131-9	INS=1.00 H/H=2.54	2.06	0.50	1.25	1.45	3.43	4.68	5.93	0.20	45°	NOT REQD	NOT REQD	0.20	2.50	0.07	1.25	0.53	1.06	0.63	0.20	45°	NOT REQD	30°	#	-	576015-2			II
2-576131-0	INS=0.90 H/H=2.29	1.16	0.45	1.40	1.57	3.05	4.78	5.70	0.10	60°	NOT REQD	NOT REQD	0.17	0.45	0.08	0.90	0.98	1.11	0.25	0.20	45°	NOT REQD	30°	#	-	576032-2			II
2-576131-1	INS=0.90 H/H=2.29	1.76	0.45	1.10	1.45	3.12	4.68	5.93	0.20	60°	NOT REQD	NOT REQD	0.19	1.87	0.07	0.90	0.68	1.11	0.63	0.20	45°	NOT REQD	30°	#	-	576549			II
2-576131-2	INS=1.10 H/H=2.79	2.06	0.55	1.70	2.10	3.50	4.80	5.93	0.20	60°	NOT REQD	NOT REQD	0.20	2.50	0.09	1.25	0.53	1.01	0.35	0.20	45°	NOT REQD	30°	#	-	576533-4 576533-5			II
2-576131-3	INS=0.80 H/H=2.03	1.40	0.40	1.70	2.10	3.50	4.80	5.93	0.20	60°	NOT REQD	NOT REQD	0.29	0.77	0.06	0.90	0.86	1.16	0.35	0.20	45°	NOT REQD	30°	#	-	576533-6 576533-7			II
2-576131-4	INS=0.80 H/H=2.03	1.30	0.40	1.25	1.45	3.43	4.68	5.93	0.20	45°	NOT REQD	NOT REQD	0.11	1.25	0.06	0.90	0.91	1.16	0.63	0.20	45°	-	45°	#	-	576015-3			II
2-576131-5	INS=1.40 H/H=3.56	2.50	0.70	1.85	2.55	4.25	4.70	5.93	0.70	45°	NOT REQD	NOT REQD	0.24	3.00	0.11	1.87	0.31	0.86	0.25	0.20	45°	NOT REQD	45°	#	6-2-80	576566			II
2-576131-6	INS=0.90 H/H=2.29	0.96	0.45	1.25	1.45	3.43	4.68	5.93	0.20	45°	NOT REQD	NOT REQD	0.07	1.25	0.08	0.90	1.08	1.11	0.63	0.20	45°	NOT REQD	45°	#	9-3-82	576009-1			II
2-576131-7	INS=1.40 H/H=3.56	2.50	0.70	1.50	2.00	4.25	4.70	5.93	0.20	45°	NOT REQD	NOT REQD	0.24	3.00	0.11	1.87	0.31	0.86	0.25	0.20	45°	NOT REQD	NOT REQD	#	19-12-83	1-576009-2			II

DIMENSIONS IN INCHES. DO NOT SCALE PRINT EXPANSIONS THUS [] IN MM.

SHEET 2 OF 5

SEE SHEET 1

MATERIAL	HEAT TREAT	FINISH
SEE SHT 1	SEE SHT 1	SEE SHT 1
UNLESS OTHERWISE SPECIFIED	REMOVE BURRS, BREAK SHARP EDGES 0.1 [0.2] R. MAX.	0.0005 [0.01] ANGLES ± 0.2°
FIRST USED	WIRE RANGE	CLASS
AREA	AMP Industrial	
NAME	C 576131 SHT 2 OF 5	
DATE	1/4/82	
APP'D	COMB ANVIL	

PRINT DIST. +
 A
 B
 C
 D
 E
 F
 G
 NUMBER 576131
 This information is confidential and is disclosed to you on condition that no further disclosure is made by you to other than AMP Personnel without written authorization from AMP OF GREAT BRITAIN LTD.

PART N°	T	N	AT	AA	F	L	E	Y	G	M°	V°	Wr	C	Sr	D	Rr	J	H	W	A	K°	B	AM°	AR	DATE	FIRST USED	DR CK	TYPE
2-576131-8	INS MM	.140 3.55	.250 6.35	.070 1.78	.182 4.62	.219 5.56	.377 9.57	.462 11.73	.593 15.06	.020 0.51	60°	≤	.024 0.61	.300 7.62	.011 0.28	.187 4.75	.031 0.79	.086 2.18	.037 0.94	.829 21.06	45°	≤	45°	—	6-3-85	576047-2	S.T.	II
2-576131-9	INS MM	.080 2.03	.160 4.06	.040 1.02	—	.177 4.49	.287 7.29	.468 11.89	.593 15.06	—	—	—	.014 0.35	.187 4.75	.006 0.15	.090 2.29	.076 1.93	.116 2.95	.020 0.51	.829 21.05	45°	—	—	—	18-4-85	576590	S.T.	III
3-576131-0	INS MM	.080 2.03	.180 4.57	.040 1.02	—	.191 4.85	.296 7.52	.464 12.29	.593 15.06	—	—	—	.019 0.48	.187 4.75	.006 0.15	.090 2.29	.066 1.68	.116 2.95	—	.829 21.06	45°	—	—	—	8-8-85	576017-8	R/L	III
3-576131-1	INS MM	.090 2.29	—	.045 1.14	—	—	.200 5.08	.479 12.17	.489 12.42	—	—	—	—	—	.016 0.41	.045 1.14	—	.111 2.82	—	.829 21.05	45°	—	—	—	13-8-85	576441	S.T.	N/A
3-576131-2	INS MM	.080 2.03	—	.040 1.02	—	—	.130 3.30	.468 11.89	.593 12.70	—	—	—	—	—	.006 0.15	.090 2.29	—	.116 2.95	—	.829 21.06	45°	—	—	—	18-10-85	576062-4	S.T.	N/A
3-576131-3	INS MM	.190 4.83	.240 6.10	.095 2.41	.178 4.52	.230 5.84	.485 12.32	.700 17.78	.023 0.58	60°	—	—	.025 0.64	.240 6.10	.021 0.53	.187 4.75	.036 0.91	.061 1.55	.061 1.55	.829 21.06	45°	—	30°	—	4-11-86	576038-6	S.T.	II
3-576131-4	INS MM	.070 1.78	.110 2.79	.035 0.89	.163 4.14	.180 4.57	.350 8.89	.480 12.19	.593 15.06	.010 0.25	60°	—	.009 0.23	.125 3.18	.004 0.10	.090 2.29	.101 2.57	.121 3.07	.025 0.63	.829 21.06	45°	—	30°	—	4-11-86	1-576533-3	S.T.	II
3-576131-5	INS MM	.110 2.79	.130 3.30	.055 1.40	.192 4.88	.207 5.26	.375 9.53	.468 11.89	.593 15.06	.015 0.38	45°	—	.024 0.61	.065 1.65	.009 0.23	.125 3.18	.091 2.31	.101 2.57	.063 1.60	.829 21.06	45°	—	30°	—	4-11-86	1-576017-9	S.T.	II
3-576131-6	INS MM	.090 2.29	.130 3.30	.045 1.14	—	.165 4.19	.363 9.22	.488 12.40	.593 15.06	—	—	—	.008 0.20	.125 3.18	.008 0.20	.090 2.29	.091 2.31	.111 2.82	.020 0.51	.829 21.06	45°	—	—	—	4-11-86	576009-3	S.T.	III
3-576131-7	INS MM	.120 3.05	.165 4.19	.060 1.52	.178 4.52	.210 5.33	.375 9.53	.468 11.89	.593 15.06	.032 0.81	45°	—	.005 0.13	.187 4.75	.011 0.28	.125 3.18	.074 1.88	.096 2.44	.040 1.02	.829 21.06	45°	—	45°	—	3-7-87	2-576017-4	S.T.	II
3-576131-8	INS MM	.090 2.29	.110 2.79	.045 1.14	.135 3.43	.152 3.86	.300 7.62	.488 12.40	.593 15.06	.018 0.46	45°	—	.011 0.28	.125 3.18	.008 0.20	.090 2.29	.101 2.57	.111 2.82	—	.829 21.06	45°	—	—	—	8-9-87	576018-5	S.T.	I
3-576131-9	INS MM	.120 3.05	.165 4.19	.060 1.52	.178 4.52	.210 5.33	.375 9.53	.468 11.89	.593 15.06	.032 0.81	45°	—	.005 0.13	.187 4.75	.011 0.28	.125 3.18	.074 1.88	.096 2.44	.040 1.02	.829 21.06	45°	—	45°	—	21-11-89	4-576017-5	S.T.	II
4-576131-0	INS MM	.090 2.29	.110 2.79	.045 1.14	.110 2.79	.145 3.68	.312 7.92	.468 11.89	.593 15.06	.020 0.51	60°	—	.023 0.58	.055 1.40	.007 0.18	.090 2.29	.101 2.57	.111 2.82	.063 1.60	.809 20.55	45°	—	45°	—	11-10-88	576527-5	S.T.	II
4-576131-1	INS MM	.110 2.79	.120 3.05	.055 1.40	—	.174 4.42	.375 9.53	.468 11.89	.593 15.06	—	45°	—	.017 0.43	.081 2.06	.009 0.23	.125 3.18	.096 2.44	.101 2.57	.062 1.57	.829 21.06	60°	—	45°	—	11-10-88	3-576017-6	S.T.	II
4-576131-2	INS MM	.070 1.78	.120 3.05	.035 0.89	.130 3.30	.150 3.80	.316 8.03	.488 12.40	.591 15.00	.020 0.51	45°	—	.027 0.69	.060 1.52	.004 0.10	.090 2.29	.096 2.44	.121 3.07	.020 0.51	.829 21.06	45°	—	45°	—	11-10-88	576019-4	S.T.	II
4-576131-3	INS MM	.062 1.57	.100 2.54	.031 0.79	.154 3.90	.163 4.15	.333 8.45	.486 12.34	.593 15.06	.010 0.25	45°	—	.020 0.51	.050 1.27	.003 0.08	.090 2.29	.106 2.69	.125 3.18	.030 0.76	.829 21.06	45°	—	45°	—	11-10-88	4-576533-4	S.T.	II
4-576131-4	INS MM	.110 2.79	.155 3.94	.055 1.40	—	.174 4.42	.375 9.53	.468 11.89	.593 15.06	—	45°	—	.028 0.71	.095 2.41	.009 0.23	.125 3.18	.079 2.00	.101 2.57	.062 1.57	.829 21.06	60°	—	45°	—	14-10-88	576009-6	S.H.	II
4-576131-5	INS MM	.090 2.29	.150 3.81	.045 1.14	—	.215 5.46	.375 9.53	.468 11.89	.593 15.06	—	45°	—	.037 0.94	.075 1.90	.008 0.20	.090 2.29	.081 2.06	.111 2.82	.062 1.57	.829 21.06	45°	—	45°	—	14-10-88	576064-0	S.H.	II
4-576131-6	INS MM	.140 3.56	.240 6.10	.070 1.78	.165 4.19	.225 5.71	.460 11.68	.478 12.14	.593 15.06	.060 1.52	45°	—	.042 1.07	.135 3.43	.006 0.15	.125 3.18	.036 0.91	.086 2.18	.031 0.79	.829 21.06	45°	—	45°	—	20-10-88	576074-2	S.H.	II
4-576131-7	INS MM	.160 4.06	.170 4.32	.080 2.03	.190 4.83	.205 5.21	.395 10.03	.488 12.40	.593 15.06	.015 0.38	45°	—	.017 0.43	.187 4.75	.013 0.33	.187 4.75	.071 1.80	.076 1.93	.062 1.57	.829 21.06	45°	—	45°	—	24-11-89	7-576017-3	S.T.	II
4-576131-8	INS MM	.090 2.29	.140 3.56	.045 1.14	.138 3.50	.165 4.19	.295 7.49	.488 12.40	.591 15.00	.028 0.71	45°	—	.034 0.86	.070 1.78	.008 0.20	.090 2.29	.086 2.18	.111 2.82	.020 0.51	.829 21.06	45°	—	45°	—	9-11-88	576019-5	S.H.	II
4-576131-9	INS MM	.110 2.79	.150 3.81	.055 1.40	.192 4.88	.207 5.26	.375 9.53	.468 11.89	.593 15.06	.015 0.38	45°	—	.029 0.74	.088 2.24	.009 0.23	.125 3.18	.081 2.06	.101 2.57	.063 1.57	.829 21.06	45°	—	30°	—	10-11-88	1-576017-9	S.H.	II
5-576131-0	INS MM	.070 1.78	.110 2.79	.035 0.89	.140 3.56	.157 3.99	.305 7.75	.478 12.14	.570 14.48	.010 0.25	60°	—	.019 0.48	.063 1.60	.003 0.08	.090 2.29	.101 2.57	.121 3.07	.025 0.64	.829 21.06	45°	—	30°	—	25-11-88	576002-6	S.H.	II
5-576131-1	INS MM	.090 2.29	.110 2.79	.045 1.14	—	.195 4.95	.355 9.02	.468 11.89	.593 15.06	—	45°	—	.023 0.58	.055 1.40	.005 0.13	.090 2.29	.101 2.57	.111 2.82	.062 1.57	.829 21.06	45°	—	45°	—	14-12-88	4-576017-0	S.H.	II

DIMENSIONS IN INCHES DO NOT SCALE PRINT
DIMENSIONS IN MM 1 IN MM

SEE SHEET ONE

MATERIAL	HEAT TREAT	FINISH
SEE SH 1	SEE SH 1	SEE SH 1
UNLESS OTHERWISE SPECIFIED		
REMOVE BURRS, BREAK SHARP EDGES 015 (0.38) R MAX	0.005 (0.013)	0.005 (0.013)
ANGLES ± 0° 30'		
FIRST USED	WIRE RANGE	CLASS
PP	AREA	SCALE
DR S. Farris	W. J. G. 1/26	TERMINAL HOUSE, STANMORE, MIDD.
CHK J. D. Pitt	1/26	of Great Britain Ltd.
APP S. Farris	1/26	576131 SH 3 OF 3 182
ISS	REVISION RECORD	ECN
		DATE
		NAME
		COMBINATION ANVIL - MINI-APPLICATOR

NAME, PART NO. & VENDOR SYMBOL IN AREA X.....
 (INCLUDE DASH NO. & REV. LETTER)
 PART MUST BE DEMARKETISED.

LEGAL, HEALTH, SAFETY AND ENVIRONMENTAL CONSTRAINTS
 MAY APPLY TO THE MATERIALS SPECIFIED ON THIS
 DOCUMENT REFER TO ENGINEERING MATERIAL SPEC. 100-2012.

576131
 NUMBER

PART NO.		T	N	AT	AA	F	L	E	Y	G	M°	V°	WR	C	SR	D	RR	J	H	W	A	K°	B	AM°	AR	DATE	FIRST USED	DR CK	TYPE	
5-576131-2	INS MM	.130 3.30	.170 4.32	.065 1.65	.166 4.22	.182 4.62	.340 8.64	.478 12.14	.593 15.06	.016 0.41	45°	#	#	.039 0.99	.091 2.31	.014 0.36	.125 3.18	.071 1.80	.091 2.31	.063 1.60	.829 21.06	45°	#	45°	#	2-12-88	576074-3	SM	II	
5-576131-3	INS MM	.090 2.29	.130 3.30	.045 1.14	.154 3.91	.169 4.29	.305 7.75	.486 12.34	.593 15.06	.015 0.38	45°	#	#	.022 0.56	.079 2.01	.008 0.20	.090 2.29	.091 2.31	.111 2.82	.030 0.76	.829 21.06	45°	#	45°	#	15-12-88	6-576533-1	SM	II	
5-576131-4	INS MM	.120 3.05	.150 3.81	.060 1.52	.150 3.81	.165 4.19	.312 7.92	.468 11.89	.593 15.06	.015 0.38	45°	#	#	.027 0.69	.091 2.31	.010 0.25	.125 3.17	.081 2.06	.096 2.44	.063 1.60	.829 21.06	45°	#	45°	#	19-12-88	576527-7	SM	II	
5-576131-5	INS MM	.120 3.05	.220 5.59	.060 1.52	#	.256 6.50	.424 10.77	.478 12.14	.593 15.06	#	45°	#	#	.022 0.56	.250 6.35	.011 0.28	.125 3.17	.046 1.17	.096 2.44	.043 1.09	.829 21.06	45°	#	45°	#	19-1-89	#	SM	II	
5-576131-6	INS MM	.090 2.29	.140 3.56	.045 1.14	.195 4.95	.221 5.61	.390 9.91	.478 12.14	.593 15.06	.015 0.38	60°	#	#	.031 0.79	.073 1.85	.007 0.18	.090 2.29	.086 2.18	.111 2.82	.040 1.02	.829 21.06	45°	#	30°	#	6-2-89	3-576017-4		II	
5-576131-7	INS MM	.110 2.79	.210 5.33	.055 1.40	.170 4.32	.210 5.33	.350 8.89	.480 12.19	.593 15.06	.020 0.51	60°	#	#	#	#	.009 0.23	.125 3.17	.051 1.30	.101 2.56	.035 0.89	.829 21.06	45°	#	30°	#	7-2-89	4-576533-2		II	
5-576131-8	INS MM	.120 3.05	.190 4.83	.060 1.52	.178 4.52	.210 5.33	.375 9.52	.468 11.89	.593 15.06	.034 0.86	45°	#	#	.005 0.13	.041 1.04	.109 2.77	.011 0.28	.125 3.17	.061 1.55	.096 2.44	.040 1.02	.829 21.06	45°	#	45°	#	7-2-89	3-576017-3		II
5-576131-9	INS MM	.110 2.79	.180 4.57	.055 1.40	.175 4.45	.201 5.10	.374 9.50	.468 11.89	.591 15.01	.025 0.63	45°	#	#	.019 0.48	.187 4.75	.005 0.13	.125 3.17	.061 1.55	.101 2.56	.063 1.60	.829 21.06	45°	#	45°	.020 0.51	25-7-89	7-576047-4		II	
6-576131-0	INS MM	.120 3.05	.180 4.57	.060 1.52	.178 4.52	.210 5.33	.375 9.53	.468 11.89	.593 15.06	.032 0.81	45°	#	#	.005 0.13	.022 0.56	.109 2.77	.011 0.28	.125 3.18	.066 1.68	.096 2.44	.040 1.02	.829 21.06	45°	#	45°	#	2-8-89	#	SM	II
6-576131-1	INS MM	.120 3.05	.180 4.57	.060 1.52	#	.276 7.01	.444 11.28	.498 12.65	.593 15.06	#	45°	#	#	.015 0.38	.125 3.18	.006 0.15	.125 3.17	.066 1.68	.096 2.44	.043 1.09	.829 21.06	45°	#	45°	.020 0.51	14-2-89	#		II	
6-576131-2	INS MM	.070 1.78	.110 2.79	.035 0.89	.140 3.56	.160 4.06	.343 8.71	.452 11.48	.593 15.06	.020 0.51	45°	#	#	.020 0.51	.061 1.55	.003 0.08	.090 2.29	.101 2.56	.121 3.07	.063 1.60	.829 21.06	45°	#	45°	#	14-2-89	4-576533-6		II	
6-576131-3	INS MM	.150 3.81	.200 5.08	.075 1.90	.159 4.04	.190 4.83	.350 8.89	.461 11.71	.593 15.06	.031 0.79	45°	#	#	.048 1.22	.109 2.77	.013 0.33	.187 4.75	.056 1.42	.081 2.06	.061 1.55	.829 21.06	45°	#	45°	#	14-2-89	4-576533-9		II	
6-576131-4	INS MM	.090 2.29	.140 3.56	.045 1.14	#	.210 5.33	.400 10.16	.478 12.14	.593 15.06	#	#	#	#	.029 0.74	.076 1.93	.007 0.18	.090 2.29	.086 2.18	.111 2.82	.075 1.90	.829 21.06	45°	#	45°	#	15-2-89	4-576017-2		II	
6-576131-5	INS MM	.120 3.05	.180 4.57	.060 1.52	.157 3.99	.173 4.39	.331 8.41	.488 12.39	.591 15.01	.016 0.41	45°	#	#	#	#	.011 0.28	.125 3.17	.066 1.68	.096 2.44	.031 0.79	.829 21.06	45°	#	45°	#	21-2-89	6-576533-0		II	
6-576131-6	INS MM	.120 3.05	.170 4.32	.060 1.52	#	.246 6.25	.414 10.51	.468 11.89	.593 15.06	#	45°	#	#	.037 0.94	.095 2.41	.006 0.15	.125 3.17	.071 1.80	.096 2.44	.043 1.09	.829 21.06	45°	#	45°	#	21-2-89	5-576017-1		II	
6-576131-7	INS MM	.070 1.78	.110 2.79	.035 0.89	.140 3.56	.157 3.99	.305 7.75	.478 12.14	.570 14.48	.010 0.25	60°	#	#	.019 0.48	.063 1.60	.003 0.08	.090 2.29	.101 2.56	.121 3.07	.063 1.60	.829 21.06	45°	#	30°	#	21-2-89	576032-3		II	
6-576131-8	INS MM	.080 2.03	.110 2.79	.040 1.02	.145 3.68	.167 4.24	.354 8.99	.459 11.66	.591 15.01	.013 0.33	60°	#	#	.024 0.61	.054 1.37	.006 0.15	.090 2.29	.101 2.56	.116 2.95	.031 0.79	.829 21.06	60°	#	30°	#	22-2-89	3-576017-5		II	
6-576131-9	INS MM	.090 2.29	.220 5.59	.045 1.14	.140 3.56	.175 4.44	.312 7.92	.478 12.14	.593 15.06	.020 0.51	60°	#	#	.022 0.56	.250 6.35	.007 0.18	.090 2.29	.046 1.17	.111 2.82	.031 0.79	.809 20.55	45°	#	30°	#	24-2-89	#		II	
7-576131-0	INS MM	.090 2.29	.140 3.56	.045 1.14	.144 3.66	.174 4.42	.315 8.00	.484 12.30	.593 15.06	.030 0.76	45°	#	#	.031 0.79	.073 1.85	.008 0.20	.090 2.29	.086 2.18	.111 2.82	.047 1.19	.829 21.06	45°	#	45°	#	28-2-89	3-576047-1		II	
7-576131-1	INS MM	.070 1.78	.130 3.30	.035 0.89	.131 3.33	.150 3.81	.250 6.35	.467 12.37	.593 15.06	.020 0.51	45°	#	#	.028 0.71	.068 1.73	.004 0.10	.090 2.29	.091 2.31	.121 3.07	.031 0.79	.829 21.06	45°	#	30°	#	1-3-89	3-576047-3		II	
7-576131-2	INS MM	.070 1.78	.120 3.05	.035 0.89	.140 3.56	.152 3.86	.320 8.13	.478 12.14	.593 15.06	.012 0.30	45°	#	#	.025 0.63	.063 1.60	.003 0.08	.090 2.29	.096 2.44	.121 3.07	.030 0.76	.829 21.06	45°	#	45°	#	13-3-89	576001-6		II	
7-576131-3	INS MM	.155 3.94	.210 5.33	.078 1.98	.195 4.95	.225 5.71	.440 11.18	.478 12.14	.700 17.78	.030 0.76	45°	#	#	.022 0.59	.187 4.75	.013 0.33	.187 4.75	.051 1.30	.079 2.01	.031 0.79	.829 21.06	45°	#	45°	#	8-5-89	576042-3		II	
7-576131-4	INS MM	.090 2.29	.140 3.56	.045 1.14	.150 3.81	.176 4.47	.350 8.89	.478 12.14	.593 15.06	.015 0.38	60°	#	#	.035 0.89	.069 1.75	.007 0.18	.090 2.29	.086 2.18	.111 2.82	.031 0.79	.829 21.06	60°	#	30°	#	22-6-89	576046-2		II	
7-576131-5	INS MM	.090 2.29	.140 3.56	.045 1.14	.181 4.60	.198 5.03	.375 9.52	.478 12.14	.593 15.06	.010 0.25	60°	#	#	.028 0.71	.079 2.00	.006 0.15	.090 2.29	.086 2.18	.111 2.82	.030 0.76	.829 21.06	45°	#	30°	#	3-7-89	5-576017-0		II	
7-576131-6	INS MM	.080 2.03	.120 3.05	.040 1.02	.125 3.18	.137 3.48	.408 10.36	.468 11.89	.593 15.06	.012 0.30	45°	#	#	.025 0.64	.063 1.60	.006 0.15	.090 2.29	.096 2.44	.116 2.95	.030 0.76	.829 21.06	45°	#	45°	#	7-7-89	576091-2		II	
7-576131-7	INS MM	.070 1.78	.090 2.29	.035 0.89	#	.150 3.81	.312 7.92	.478 12.14	.593 15.06	#	#	45°	#	.015 0.38	.048 1.22	.004 0.10	.090 2.29	.111 2.82	.121 3.07	.030 0.76	.829 21.06	45°	#	45°	#	2-03-90	576059-3		II	

3rd ANGLE AMERICAN PROJECTION
 DIMENSIONS IN METRIC
 DO NOT SCALE PRINT

This information is unclassified and is disclosed to the public without restriction.
 unless it is shown to be otherwise.
 AMP OF GREAT BRITAIN LTD.

PRINT
 DIST.
 - B+

SEE SHEET 1		SEE SHEET 1		SEE SHEET 1	
MATERIAL					
HEAT TREAT					
FINISH					
UNLESS OTHERWISE SPECIFIED					
REMOVE BURRS, BREAK SHARP EDGES 0.38R MAX.					
0.0 - ± 0.51 0.000 - ± 0.013					
0.00 - ± 0.13 ANGLES = ± 0° 30'					
FIRST USED		SCALE		TERMINAL HOUSE, STAMORE, H100X.	
SEE TABLE				AMP of Great Britain Ltd.	
DR. S.J. Tassie		12/1/89		NAME	
CHK. J. V. Fisher		12/1/89		ANVIL - COMBINATION	
APP. S.J. Tassie		12/1/89		REV	
REV	ENGINEER	ECN	DATE	SHT 4 OF 5	LOC E
					NUMBER 576131

MARK PART NO. & VENDOR SYMBOL IN AREA X.....
 (INCLUDE DASH NO. & REV. LETTER)
 PART MUST BE REIDENTIFIED.

LEGAL, HEALTH, SAFETY AND ENVIRONMENTAL CONSTRAINTS
 MAY APPLY TO THE MATERIALS SPECIFIED ON THIS
 DOCUMENT REFER TO ENGINEERING MATERIAL SPEC. 180-2012.

NUMBER 576131

3rd ANGLE AMERICAN PROJECTION
 DIMENSIONS IN METRIC
 DO NOT SCALE PRINT

This information is confidential and is disclosed to you on condition that you will not disclose it to any other person without the written authority of AMP of Great Britain Ltd.

AMP OF GREAT BRITAIN LTD.

PART NO.		T	N	AT	AA	F	L	E	Y	G	M°	V°	WR	C	SR	D	RR	J	H	W	A	K°	B	AM°	AR	DATE	FIRST USED	DR CK	TYPE
7-576131-8	INS	.070	.110	.035	.140	.157	.305	.478	.570	.010	60°	#	#	.019	.062	.003	.090	.101	.121	.025	.829	45°	#	30°	#	14-9-89	576001-7	SM	II
	MM	1.78	2.79	0.89	3.56	3.99	7.75	12.14	14.48	0.25			#	0.48	1.57	0.08	2.29	2.57	3.07	0.64	21.06								
7-576131-9	INS	.110	.160	.055	#	.174	.375	.468	.593	#	45°	#	#	.033	.091	.009	.125	.076	.101	.062	.829	60°	#	45°	#	22-9-89	5-576017-2	SM	II
	MM	2.79	4.06	1.40	#	4.42	9.53	11.89	15.06	#			#	0.84	2.31	0.23	3.18	1.93	2.57	1.57	21.06								
8-576131-0	INS	.062	.100	.031	.135	.161	.300	.478	.593	.015	60°	#	#	.019	.053	.003	.090	.106	.125	.063	.829	45°	#	45°	#	8-5-90	576590-3	SM	II
	MM	1.57	2.54	0.79	3.43	4.09	7.62	12.14	15.06	0.30			#	0.48	1.34	0.08	2.29	2.69	3.18	1.60	21.06								
8-576131-1	INS	.110	.165	.055	.178	.194	.375	.468	.593	.016	45°	#	#	.015	.187	.009	.125	.074	.101	.040	.829	45°	#	45°	#	8-5-90	2-576017-4	SM	II
	MM	2.79	4.19	1.40	4.52	4.93	9.53	11.89	15.06	0.41			#	0.38	4.75	0.23	3.18	1.88	2.57	1.02	21.06								
8-576131-2	INS	.090	.140	.045	.128	.157	.243	.461	.593	.030	45°	#	#	.031	.073	.008	.090	.086	.111	.048	.829	45°	#	45°	#	15-5-90	6-576533-8	SM	II
	MM	2.29	3.56	1.14	3.25	3.99	6.17	11.71	15.06	0.76			#	0.79	1.85	0.20	2.29	2.18	2.82	1.22	21.06								
8-576131-3	INS	.180	.270	.090	.220	.254	.445	.468	.593	.020	60°	#	#	.028	.300	.019	.187	.021	.066	.060	.829	45°	#	45°	#	18-6-90	1-576038-5	SM	II
	MM	4.57	6.86	2.29	5.59	6.45	11.30	11.89	15.06	0.51			#	0.71	7.62	0.48	4.75	0.53	1.68	1.52	21.06								
8-576131-4	INS	.080	.140	.040	#	.160	.350	.468	.593	#	45°	#	#	.034	.070	.006	.090	.086	.116	.062	.829	45°	#	45°	#	26-6-90	576077-3	SM	II
	MM	2.03	3.56	1.02	#	4.06	8.89	11.89	15.06	#			#	0.86	1.78	0.15	2.29	2.18	2.95	1.57	21.06								
8-576131-5	INS	.120	.180	.060	#	.246	.414	.468	.593	#	45°	#	#	.049	.090	.027	.060	.066	.096	.043	.829	45°	#	45°	#	24-7-90	7-576017-8	SM	II
	MM	3.05	4.57	1.52	#	6.25	10.52	11.89	15.06	#			#	1.24	2.29	0.69	1.52	1.68	2.44	1.09	21.06								
8-576131-6	INS	.110	.160	.055	.158	.170	.367	.468	.593	.012	45°	#	#	.031	.094	.004	.125	.076	.101	.070	.829	45°	#	45°	#	13-9-90	8-576017-0	SM	II
	MM	2.79	4.06	1.40	4.01	4.32	9.32	11.89	15.06	0.20			#	0.79	2.39	0.10	3.15	1.93	2.57	1.78	21.06								
8-576131-7	INS	.120	.180	.060	#	.205	.355	.448	.593	#	45°	#	#	.049	.090	.027	.060	.066	.096	.082	.829	45°	#	45°	#	27-11-90	1-576064-8	SM	II
	MM	3.05	4.57	1.52	#	5.21	9.02	11.38	15.06	#			#	1.24	2.29	0.69	1.52	1.68	2.44	2.08	21.06								
8-576131-8	INS	.100	.150	.050	.181	.198	.375	.478	.593	.010	60°	#	#	.037	.076	.007	.125	.081	.106	.030	.829	45°	#	30°	#	8-3-91	576520-4	SM	II
	MM	2.54	3.81	1.27	4.60	5.03	9.53	12.14	15.06	0.25			#	0.94	1.93	0.18	3.18	2.06	2.69	0.76	21.06								
C 576131-9	INS	.100	.130	.050	.181	.198	.375	.478	.593	.010	60°	#	#	.014	.125	.007	.125	.091	.106	.030	.829	45°	#	30°	#	13-3-91	576520-2	SM	II
	MM	2.54	3.30	1.27	4.60	5.03	9.53	12.14	15.06	0.25			#	0.36	3.18	0.18	3.18	2.31	2.69	0.76	21.06								
9-576131-0	INS	.110	.180	.055	.192	.207	.375	.468	.593	.015	45°	#	#	.045	.094	.009	.125	.066	.101	.063	.829	45°	#	45°	#	26-3-91	7-576017-0	SM	II
	MM	2.79	4.57	1.40	4.88	5.26	9.53	11.89	15.06	0.38			#	1.14	2.39	0.23	3.18	1.68	2.57	1.60	21.06								
9-576131-1	INS	.130	.180	.065	.166	.182	.340	.478	.593	.016	45°	#	#	.049	.090	.014	.125	.066	.091	.063	.829	45°	#	45°	#	24-5-91	576074-5	SM	II
	MM	3.30	4.57	1.65	4.22	4.62	8.64	12.14	15.06	0.41			#	1.24	2.29	0.36	3.18	1.68	2.31	1.60	21.06								
9-576131-2	INS	.080	.140	.040	#	.174	.316	.458	.593	#	45°	#	#	.028	.079	.007	.090	.086	.116	#	.829	45°	#	45°	#	24-5-91	576525-1	SM	II
	MM	2.03	3.56	1.02	#	4.42	8.03	11.63	15.06	#			#	0.71	2.01	0.18	2.29	2.18	2.95	#	21.06								
9-576131-3	INS	.080	.160	.040	#	.174	.316	.458	.593	#	45°	#	#	.014	.187	.007	.090	.076	.116	#	.829	45°	#	45°	#	24-5-91	576525-2	SM	II
	MM	2.03	4.06	1.02	#	4.42	8.03	11.63	15.06	#			#	0.36	4.75	0.18	2.29	1.93	2.95	#	21.06								
9-576131-4	INS	.160	.210	.080	.175	.190	.413	.478	.591	.026	30°	#	#	.044	.083	.033	.069	.051	.076	.043	.829	45°	#	30°	#	13-8-91	4-576019-2	SM	II
	MM	4.06	5.33	2.03	4.45	4.83	10.49	12.14	15.01	0.66			#	1.12	2.11	0.84	1.75	1.30	1.93	1.10	21.06								
9-576131-5	INS	.120	.170	.060	#	.201	.374	.468	.591	.025	#	#	#	.037	.095	.019	.048	.071	.096	.043	.829	45°	#	45°	#	13-8-91	4-576019-1	SM	II
	MM	3.05	4.32	1.52	#	5.11	9.50	11.89	15.01	0.64			#	0.94	2.41	0.48	1.22	1.80	2.44	1.10	21.06								
9-576131-6	INS	.090	.120	.045	.140	.160	.343	.452	.591	.020	45°	#	#	.026	.062	.015	.042	.096	.111	.063	.829	45°	#	45°	#	13-8-91	4-576019-0	SM	II
	MM	2.29	3.05	1.14	3.56	4.06	8.71	11.48	15.01	0.51			#	0.66	1.57	0.38	1.07	2.44	2.82	1.60	21.06								
9-576131-7	INS	.090	.150	.045	.181	.198	.375	.478	.593	.010	60°	#	#	.037	.076	.006	.090	.081	.111	.030	.829	45°	#	30°	#	24-9-91	9-576017-6	SM	II
	MM	2.29	3.81	1.14	4.60	5.03	9.53	12.14	15.06	0.25			#	0.94	1.93	0.15	2.29	2.06	2.82	0.76	21.06								
9-576131-8	INS	.190	.210	.095	#	.235	.430	.468	.593	#	45°	#	#	.020	.250	.021	.187	.051	.061	.031	.829	45°	#	45°	#	23-10-91	9-576017-8	SM	II
	MM	4.83	5.33	2.41	#	5.97	10.92	11.89	15.06	#			#	0.51	6.35	0.53	4.75	1.30	1.55	0.79	21.06								
9-576131-9	INS	.090	.140	.045	.125	.145	.343	.468	.593	.020	45°	#	#	.035	.069	.007	.090	.086	.111	.063	.829	45°	#	45°	#	21-1-92	576009-8	SM	II
	MM	2.29	3.56	1.14	3.18	3.68	8.71	11.89	15.06	0.51			#	0.89	1.75	0.18	2.29	2.18	2.82	1.60	21.06								

MATERIAL	HEAT TREAT	FINISH
SEE SHEET 1	SEE SHEET 1	SEE SHEET 1
UNLESS OTHERWISE SPECIFIED } REMOVE BURRS, BREAK SHARP EDGES 0.38R MAX. 0.0 = ± 0.51 0.000 = ± 0.013 0.00 = ± 0.13 ANGLES = ± 0° 30'		
FIRST USED SEE TAB-E	SCALE	TERMINAL HOUSE, STANMORE, MIDOX.
J. P. F. 12/89	1/10/89</	