

RECOMMENDED P.C. BOARD LAYOUT: COMPONENT SIDE
 .070/(1.78) MAX. THICK P. C. BOARD
 VIEWED FROM COMPONENT SIDE

- NOTES:
- MATERIALS:
 HOUSING:
 *1=NYLON 6/6, UL94 V-2, COLOR: NATURAL
 *2=NYLON 6/6, UL94 V-0, COLOR: NATURAL
 TERMINALS:
 COPPER ALLOY
 - TERMINAL PLATING:
 228=.000030/(0.00076) MIN. SELECT GOLD AND.000100/(0.00254) MIN.
 SELECT MATTE TIN OVER .000050/(0.00127) MIN. NICKEL OVERALL.
 222=.000100/(0.00254) MIN. MATTE TIN OVER .000050/(0.00127) MIN. NICKEL.
 - PRODUCT SPECIFICATION: PS-44476-001
 - PACKAGING:
 DUAL ROW PER PK-5566-001
 SINGLE ROW PER PK-5566-002
 - PART MATES WITH MINI-FIT JR. RECEPTACLE NO. 5557.
 - PARTS ARE NOT TO BE MATED OR UN-MATED WHILE CIRCUITS ARE LIVE.
 - SEE CHART ON SHEET 3 FOR PARTS WITH PEGS REMOVED.
 - RIB INDICATES CIRCUIT NO. 1.
 - PARTS WILL HAVE "HCS" MARKING.
 - PART IS NOT DESIGNED FOR CURRENT SHARING.
 - PART CONFORMS TO CLASS "B" REQUIREMENTS OF COSMETIC SPECIFICATION PS-45499-002.
 - THIS DIMENSION IS .490/(12.45) FOR 3 CIRCUIT PARTS.

SEE SHEET 2 FOR 2 THRU 24 CIRCUIT DUAL ROW
 SEE SHEET 3 FOR OPTIONS

CKT SIZE	DIM A	DIM B
3	.543 (13.80)	.331 (8.40)
4	.709 (18.00)	.496 (12.60)
5	.874 (22.20)	.661 (16.80)
6	1.039 (26.40)	.827 (21.00)
7	1.205 (30.60)	.992 (25.20)
8	1.370 (34.80)	1.157 (29.40)
9	1.535 (39.00)	1.323 (33.60)
10	1.701 (43.20)	1.488 (37.80)
11	1.866 (47.40)	1.654 (42.00)
12	2.031 (51.60)	1.819 (46.20)

CHANGE PLATING EC NO: UCP2012-1560 DRVN: NGUYEN 2012/01/05 CHKD: J. BELL 2012/01/05 APPR: F. SMITH 2012/02/02	QUALITY SYMBOLS ▽=0 ▽=0 ▽=0	GENERAL TOLERANCES (UNLESS SPECIFIED) mm INCH	DIMENSION STYLE IN/MM	SCALE 4:1	DESIGN UNITS METRIC	THIRD ANGLE PROJECTION
		4 PLACES ± --- ± --- 3 PLACES ± --- ± .38 2 PLACES ± 0.15 ± --- 1 PLACE ± --- ± ---	DRAWN BY POLGAR DATE 2001/12/03 CHECKED BY BANDURA DATE 2001/12/06 APPROVED BY FSMITH DATE 2012/02/02	VERT. HEADER ASSEMBLY, SELECTIVELY LOADED HCS, MINI-FIT JR. SERIES		
		ANGULAR ± 1/2°	MATERIAL NO. SEE CHART DOCUMENT NO. SD-44472-001	MOLEX INCORPORATED		
		DRAFT WHERE APPLICABLE MUST REMAIN WITHIN DIMENSIONS	SIZE C	THIS DRAWING CONTAINS INFORMATION THAT IS PROPRIETARY TO MOLEX INCORPORATED AND SHOULD NOT BE USED WITHOUT WRITTEN PERMISSION		

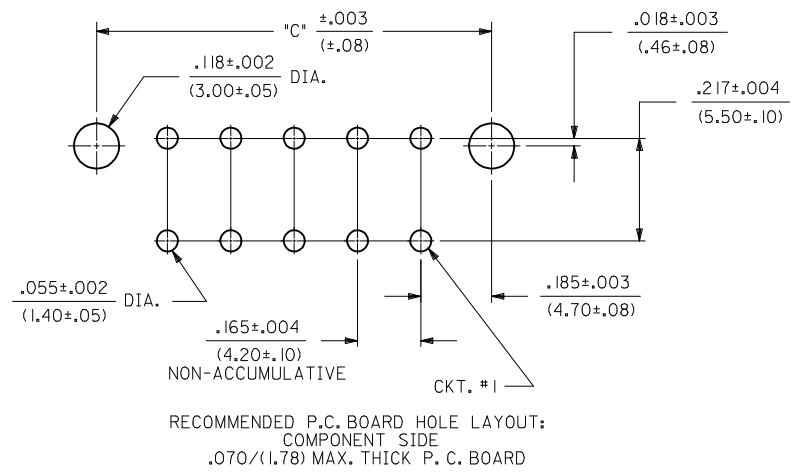
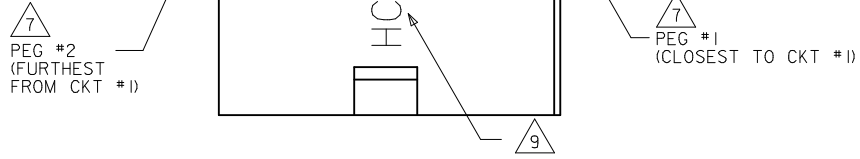

CIRCUIT SIZE	DIM. "A"	DIM. "B"	DIM. "C"
2	.21 (5.4)	—	.370 (9.4)
4	.38 (9.6)	.17 (4.2)	.535 (13.6)
6	.54 (13.8)	.33 (8.4)	.701 (17.8)
8	.71 (18.0)	.50 (12.6)	.866 (22.0)
10	.87 (22.2)	.66 (16.8)	1.031 (26.2)
12	1.04 (26.4)	.83 (21.0)	1.197 (30.4)
14	1.20 (30.6)	.99 (25.2)	1.362 (34.6)
16	1.37 (34.8)	1.16 (29.4)	1.528 (38.8)
18	1.54 (39.0)	1.32 (33.6)	1.693 (43.0)
20	1.70 (43.2)	1.49 (37.8)	1.858 (47.2)
22	1.87 (47.4)	1.65 (42.0)	2.024 (51.4)
24	2.03 (51.6)	1.82 (46.2)	2.189 (55.6)

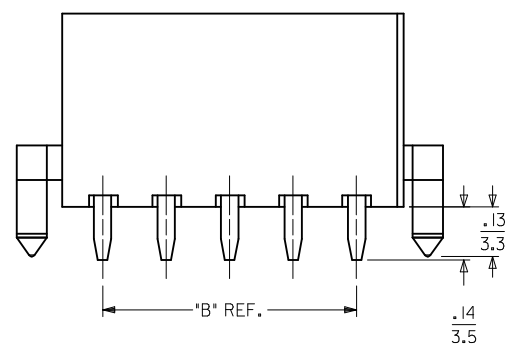
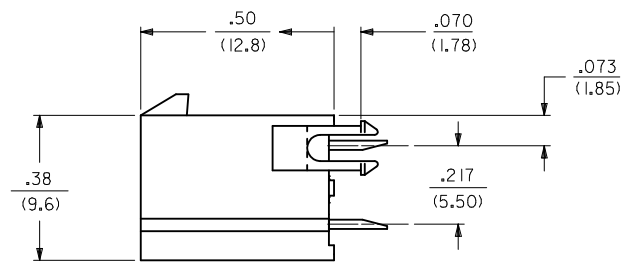
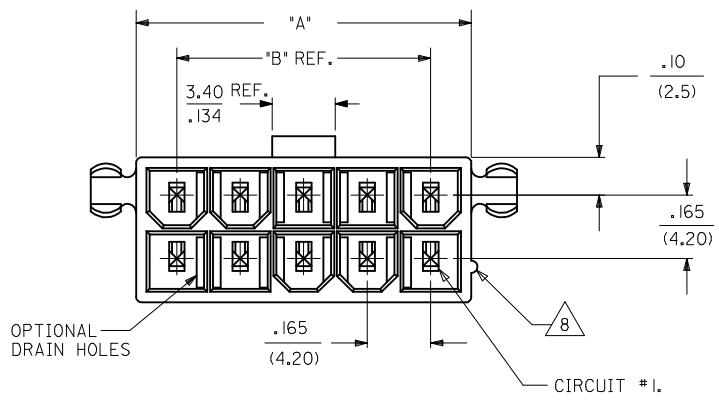

SEE SHEET 1 FOR 3 THRU 12 CIRCUIT SINGLE ROW
SEE CHART ON SHEET 3 FOR OPTIONS

SEE SHEET 1 EC NO: UCP2012-1560 DRAWN BY: DRWINHNGUYEN 2012/01/05 CHKD: JBELL 2012/01/05 APPR: FSMITH 2012/02/02	QUALITY SYMBOLS $\nabla = 0$ $\nabla = 0$ $\nabla = 0$	GENERAL TOLERANCES (UNLESS SPECIFIED)		DIMENSION STYLE IN/MM	SCALE 4:1	DESIGN UNITS METRIC	THIRD ANGLE PROJECTION																
		<table border="1"> <thead> <tr> <th></th> <th>mm</th> <th>INCH</th> </tr> </thead> <tbody> <tr> <td>4 PLACES</td> <td>± .005</td> <td>± .0002</td> </tr> <tr> <td>3 PLACES</td> <td>± .005</td> <td>± .0002</td> </tr> <tr> <td>2 PLACES</td> <td>± 0.15</td> <td>± .005</td> </tr> <tr> <td>1 PLACE</td> <td>± .005</td> <td>± .0002</td> </tr> </tbody> </table>			mm	INCH	4 PLACES	± .005	± .0002	3 PLACES	± .005	± .0002	2 PLACES	± 0.15	± .005	1 PLACE	± .005	± .0002	DRAWN BY: POLGAR DATE: 2001/12/03	CHECKED BY: BANDURA DATE: 2001/12/06	TITLE VERT. HEADER ASSEMBLY, SELECTIVELY LOADED HCS, MINI-FIT JR.SERIES		
			mm	INCH																			
		4 PLACES	± .005	± .0002																			
3 PLACES	± .005	± .0002																					
2 PLACES	± 0.15	± .005																					
1 PLACE	± .005	± .0002																					
ANGULAR ±1/2°		APPROVED BY: FSMITH DATE: 2012/02/02	MOLEX INCORPORATED																				
DRAFT WHERE APPLICABLE MUST REMAIN WITHIN DIMENSIONS		SEE CHART		MATERIAL NO.	DOCUMENT NO.	SHEET NO. 2 OF 3																	
THIS DRAWING CONTAINS INFORMATION THAT IS PROPRIETARY TO MOLEX INCORPORATED AND SHOULD NOT BE USED WITHOUT WRITTEN PERMISSION																							

MATERIAL NUMBER	CKT. SIZE	ROWS	U.L. RATING	DRAIN HOLES	PEGS	FOR PLATING SEE NOTE 2 ON SHEET 1. S = STANDARD LENGTH M = MAKE FIRST/BREAK LAST V = VOID CIRCUIT																							
						1	2	3	4	5	6	7	8	9	10	11	12	13	14	15	16	17	18	19	20	21	22	23	24
444723000	3	SINGLE	94V-2	YES	YES	S222	V	S222	-	-	-	-	-	-	-	-	-	-	-	-	-	-	-	-	-	-			
444723001	3	SINGLE	94V-0	YES	YES	S222	V	S222	-	-	-	-	-	-	-	-	-	-	-	-	-	-	-	-	-	-			
444723002	20	DUAL	94V-0	NO	NO	V	S222	S222	V	S222	S222	S222	V	S222	S222	V	S222	S222	V	S222	S222	V	S222	S222	V	-			
444723003	20	DUAL	94V-0	NO	NO	S222	S222	S222	V	S222	S222	S222	V	S222	S222	S222	V	S222	S222	V	S222	S222	V	S222	S222	V			
444723004	8	DUAL	94V-2	YES	YES	S222	S222	S222	S222	V	S222	S222	S222	-	-	-	-	-	-	-	-	-	-	-	-	-			
444723005	8	DUAL	94V-0	YES	YES	S222	S222	S222	S222	V	S222	S222	S222	-	-	-	-	-	-	-	-	-	-	-	-	-			
444723006	10	DUAL	94V-0	YES	YES	S222	M222	M222	M222	S222	S222	M222	M222	M222	S222	-	-	-	-	-	-	-	-	-	-	-			

SEE SHEET 1 FOR 3 THRU 12 CIRCUIT SINGLE ROW
 SEE SHEET 2 FOR 2 THRU 24 CIRCUIT DUAL ROW

SEE SHEET 1 EC NO: UCP2012-1560 DRW: NGUYEN 2012/01/05 CHKD: BELL 2012/01/05 APPR: FSMITH 2012/02/02	QUALITY SYMBOLS	GENERAL TOLERANCES (UNLESS SPECIFIED)	DIMENSION STYLE	SCALE	DESIGN UNITS	THIRD ANGLE PROJECTION
	▽=0	mm INCH	IN/MM	1:1	METRIC	
	▽=0	4 PLACES ± --- ± ---	DRAWN BY DATE	TITLE		
	▽=0	3 PLACES ± --- ±.38	POLGAR 2001/12/03	VERT. HEADER ASSEMBLY, SELECTIVELY LOADED HCS, MINI-FIT JR.SERIES		
	2 PLACES ±0.15 ± ---	CHECKED BY DATE	MATERIAL NO.			
	1 PLACE ± --- ± ---	BANDURA 2001/12/06	SD-44472-001			
	ANGULAR ±1/2°	APPROVED BY DATE	SHEET NO.			
	DRAFT WHERE APPLICABLE MUST REMAIN WITHIN DIMENSIONS	FSMITH 2012/02/02	3 OF 3			
		MATERIAL NO.	THIS DRAWING CONTAINS INFORMATION THAT IS PROPRIETARY TO MOLEX INCORPORATED AND SHOULD NOT BE USED WITHOUT WRITTEN PERMISSION			
		SEE CHART				