

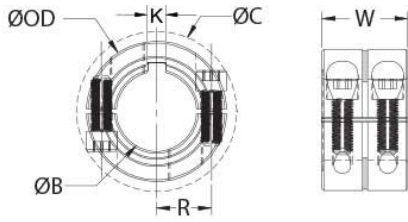

MWSPK-16-SS

Ruland MWSPK-16-SS, 16mm Double Wide Shaft Collar, 303 Stainless Steel, Two-Piece Clamp Style with Keyway, 34mm OD, 27.6mm Width



Description

Ruland MWSPK-16-SS is a two-piece shaft collar with a 16mm bore, 5mm keyway, 34mm OD, and 27.6mm width. The clamp style design does not mar the shaft, is easy to remove, and is indefinitely adjustable. It is commonly used for guiding, spacing, stopping, mounting, and component alignment. Equipment manufacturers benefit from the tightly controlled face to bore perpendicularity (TIR of ? .05mm). Perpendicularity is critical for alignment when the shaft collar is used as a load bearing face, mechanical stop, or for mounting components such as gears or bearings. Proprietary processes have been developed by Ruland to maintain superior fit, finish, and holding power. MWSPK-16-SS is stamped with the Ruland name and bore size for ease of identification. This double wide shaft collar has 25% higher axial holding power than a round bore of equivalent size. It can also be used as a short rigid coupling for applications where a traditional rigid coupling is too long. Forged screws test beyond DIN 912 12.9 standards to ensure maximum holding power. Halves are mated throughout the manufacturing process for proper fit and alignment. MWSPK-16-SS is machined from solid bar stock to a fine burr free finish and sourced exclusively from North American mills. Ruland uses 303 stainless steel with hardware of like material for consistent corrosion resistance. Stainless steel hardware undergoes a proprietary surface treatment process to prevent galling. It is RoHS3 and REACH compliant and manufactured in our Marlborough, MA factory under strict controls using proprietary processes.

Product Specifications

Bore (B)	16 mm	Bore Tolerance	+0.050 mm / +0.012 mm
Keyway (K)	5 mm	Width (W)	27.6 mm
Outer Diameter (OD)	34 mm	Width Tolerance	+0.076 mm / -0.254 mm
Clearance Diameter (C) MAX	39.3 mm	Recommended Gap	1.59 mm
Recommended Shaft Tolerance	+0.000 mm / -0.013 mm	Forged Clamp Screw	M5
Screw Material	18-8 300 Series Stainless Steel	Hex Wrench Size	4.0 mm
Screw Finish	Bright	Seating Torque	5.4 Nm
Screw Location (R)	12.50 mm	Number of Screws	4 ea
Material Specification	Type 303 Austenitic, Non-Magnetic Bar	Temperature	-40°F to 350°F (-40°C to 176°C)
Finish Specification	Bright, No Plating	Moment of Inertia	0.0730 lb-in ²
Manufacturer	Ruland Manufacturing	Country of Origin	USA
Weight (lbs)	0.296700	UPC	634529305669
UNSPC	31162811	Tariff Code	8483.60.8000
Note 1	Performance ratings are for guidance only. The user must determine suitability for a particular application.		
Prop 65	⚠ WARNING This product can expose you to the chemical Nickel (metallic)		

Installation Instructions

1. Use the MWSPK-16-SS double wide shaft collar as it is received.
2. Wipe the bore clean.
3. Apply a thin coat of light oil to the shaft.
4. Tighten the screws in two stages, starting with the inside screws. Using a torque wrench with 4 mm bit, tighten the inside screws to 2.7 Nm which is half the recommended seating torque. Repeat for the outside screws, again tightening to half of the recommended seating torque.
5. On two-piece couplings be sure to maintain the gap between the two halves during installation.
6. Tighten the screws to the full recommended seating torque of 5.4 Nm following the same pattern, starting with the inside screws first.