

Flush-type connector - SACC-DSI-M8FS-4CON-L-180 - 1694376

Please be informed that the data shown in this PDF Document is generated from our Online Catalog. Please find the complete data in the user's documentation. Our General Terms of Use for Downloads are valid (<http://download.phoenixcontact.com>)



Sensor/actuator flush-type connector, female, 4-pos., M8, rear/screw mounting with M12 thread, with straight solder connection



Key commercial data

Packing unit	1
Minimum order quantity	1
Catalog page	Page 38 (PC-2011)
GTIN	 4 017918 178659
Custom tariff number	85366990
Country of origin	GERMANY

Technical data

General data

Rated current at 40°C	4 A
Rated voltage	30 V
Number of positions	4
Volume resistance	≤ 3 mΩ
Insulation resistance	≥ 100 MΩ
Ambient temperature (operation)	-25 °C ... 85 °C

General characteristics

Standards/regulations	M8 plug-in connector IEC 61076-2-104
Coding	A - standard
Surge voltage category	II
Pollution degree	3
Degree of protection	IP67
Contact material	CuSn
Contact surface material	Au
Contact carrier material	PUR
Material, knurls	Nickel-plated brass
Sealing material	NBR

Flush-type connector - SACC-DSI-M8FS-4CON-L-180 - 1694376

Technical data

General characteristics

Mounting type	Rear mounting M12 x 1 With flat nut
Connection method	Solder pins
Status display	No

Classifications

eclass

eCl@ss 4.0	27140815
eCl@ss 4.1	27140815
eCl@ss 5.0	27143423
eCl@ss 5.1	27143423
eCl@ss 6.0	27143423
eCl@ss 7.0	27449001

etim

ETIM 2.0	EC001297
ETIM 3.0	EC002061
ETIM 4.0	EC002061

unspsc

UNSPSC 6.01	31251501
UNSPSC 7.0901	31251501
UNSPSC 11	31251501
UNSPSC 12.01	31251501
UNSPSC 13.2	31251501

Approvals

Approvals

Approvals

UL Recognized / cUL Recognized / GOST / GOST / cULus Recognized

Ex Approvals

Approvals submitted

Approval details

Flush-type connector - SACC-DSI-M8FS-4CON-L-180 - 1694376

Approvals

UL Recognized	
Nominal current I _N	4 A
Nominal voltage U _N	125 V

cUL Recognized	
Nominal current I _N	4 A
Nominal voltage U _N	125 V

GOST	
------	--

GOST	
------	--

cULus Recognized	
------------------	--

Drawings

Dimensioned drawing

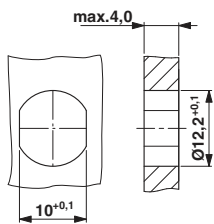

Schematic diagram

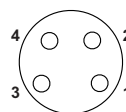

Pin assignment M8 socket, 4-pos., view female side

Housing cutout for M8 flush-type connector, socket, one-section

Flush-type connector - SACC-DSI-M8FS-4CON-L-180 - 1694376

Drilling diagram

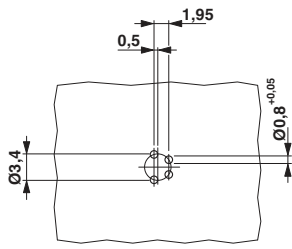

M8 flush-type socket

Dimensioned drawing

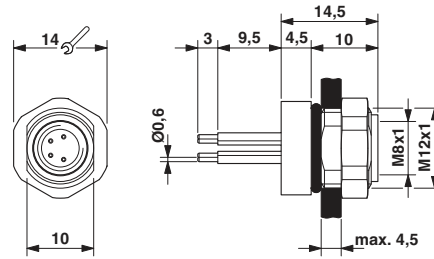

M8 flush-type socket