



DIN 22.5mm

General characteristics

- Cyclic timer with Unequal ON & OFF Time
- 6 Time ranges
- Universal supply voltage
- LED Indications : Power ON, Relay ON
- Finger safe terminals

Certifications : 

Display Specifications

Display	Power ON, Relay ON
---------	--------------------

Input Specifications

Accuracy Setting	±5% of F.S.
Repeat	± 0.5% or 50msec (F.S. = Full scale)

Output Specifications

Relay contact	2 C/O SPDT
Contact rating	5A @ 250V AC or 24V DC resistive

Functional Specification

Modes	Asymmetrical cyclic ON first or OFF first
Time ranges	0 - 1sec / min / hr (ON Time) 0 - 10sec / min / hr (ON Time) 0 - 1sec / min / hr (OFF Time) 0 - 10sec / min / hr (OFF Time)
Resolution	0.1sec
Reset	On power interruption, Reset time <100 msec

Auxiliary Supply Specifications

Supply voltage	20 to 240V AC (50 / 60Hz), 12 to 240V DC
Power consumption	2VA max

Environmental Specification

Temperature Operating	0 to 50°C (32 to 122°F)
Storage	-20 to 75°C (-4 to 167°F)
Humidity (non - condensing)	95% RH

Mechanical Specifications

Mounting	DIN rail
Weight	110gms

Dimensions (All are in mm)

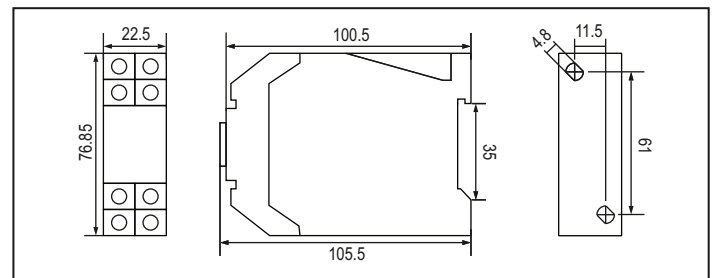

Terminal connections

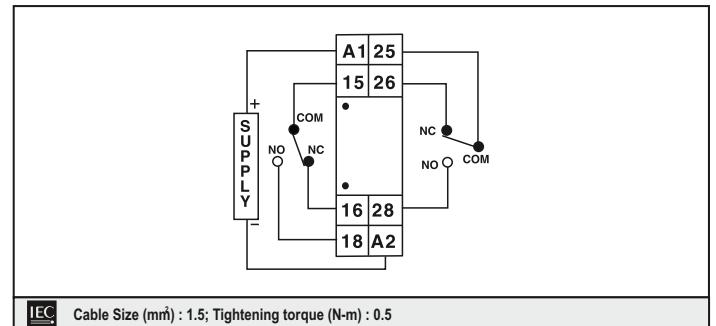

Timing diagrams

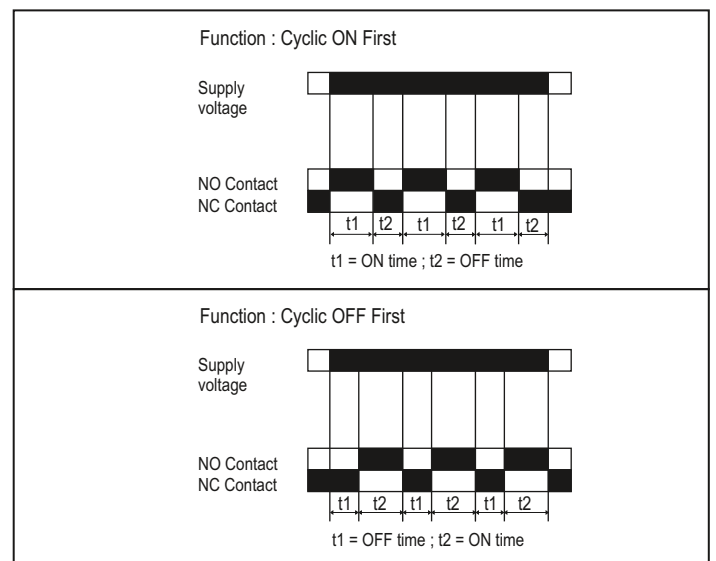

Compliance

Applicable EMI / EMC Standards		
Product Standard : IEC 61326-1		
Category	Reference standards	Testing level
Electrostatic discharge	IEC 61000-4-2	Level-3
Electrical fast transient/ Burst	IEC 61000-4-4	Level-3
Electromagnetic field	IEC 61000-4-3	Level-3
Surge	IEC 61000-4-5	Level-3
Conducted RF	IEC 61000-4-6	Level-2
Rated power frequency	IEC 61000-4-8	Level-4
Voltage dip/ short interruptions	IEC 61000-4-11	Level-3
Conducted emissions	CISPR-11	Class-B
Rated emissions	CISPR-22	Class-A
Emission & Immunity	IEC 61326-1	
Safety	IEC 61010-1	
PFMF (Passing criteria)	IEC 61000-4-8	Class-A

Ordering information

Product code	Supply voltage	Certification
800XC-CU	20 to 240V AC 12 to 240V DC	---
800XC-CE	20 to 240V AC 12 to 240V DC	CE