

10 9 8 7 6 5 4 3 2 1

F
E
D
C
B
A

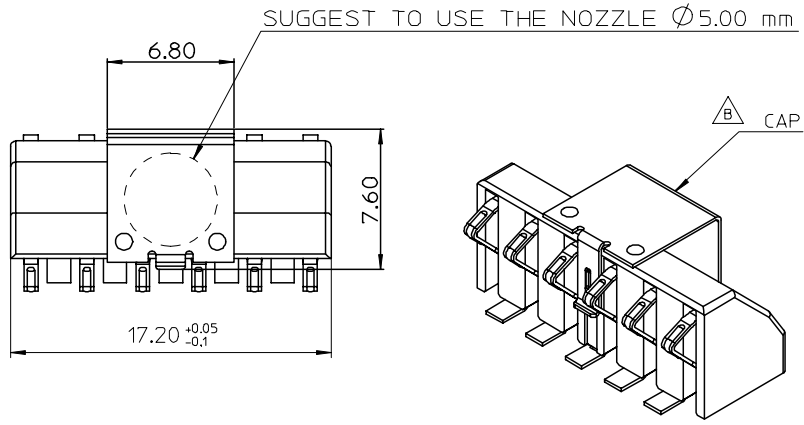

NOTES:
 1.MATERIAL:
 TERMINALS:BERYLLIUM COPPER.
 HOUSING:NYLON 9T,GLASS FIBER FILLED,UL94-0,COLOR:BLACK.
 NAILS:COPPER ALLOY
 CAP:SPTE.
 2.FINISH:
 TERMINALS:
 CONTACT AREA:GOLD(Au),THICKNESS=30 MICROINCH/0.76 MICROMETER MIN.
 UNDER PLATE:NICKEL(Ni).
 SOLDER AREA:TIN(Sn),THICKNESS=100 MICROINCH/2.54 MICROMETER MIN.
 NAILS:
 UNDER PLATE:NICKEL(Ni).
 SOLDER AREA:TIN(Sn),THICKNESS=100 MICROINCH/2.54 MICROMETER MIN.
 3.COPLANARITY TO BE 0.10mm MAX.
 4.PRODUCT SPECIFICATION REFER TO PS-48257-001
 5.TEST SUMMARY REFER TO TS-48257-001
 6.PACKAGING SPECIFICATION REFER TO PK-48257-001
 7.LEAD FREE AND ROHS COMPLIANT PRODUCT
 WEEK CODE: X X X X C

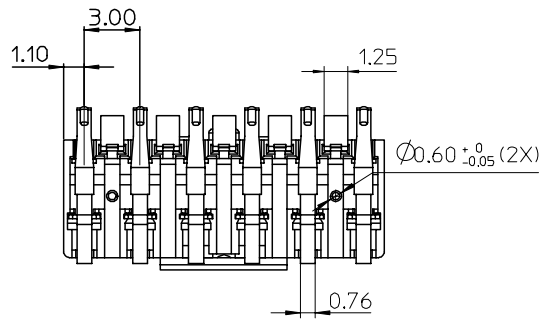
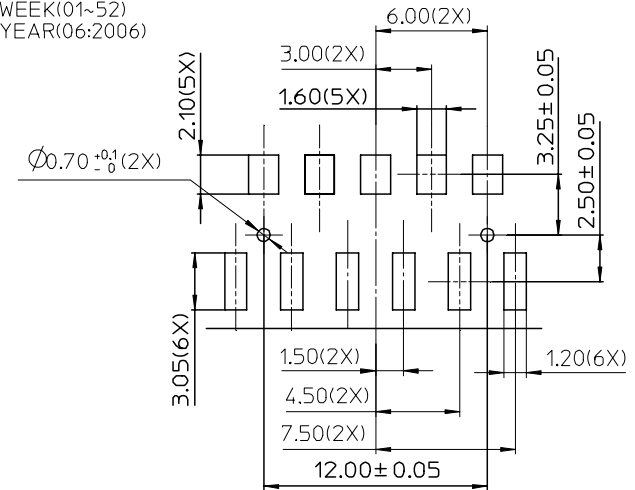
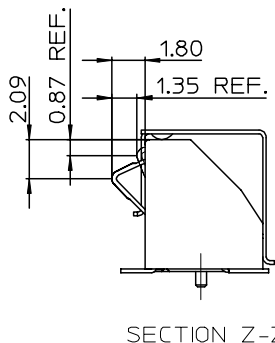
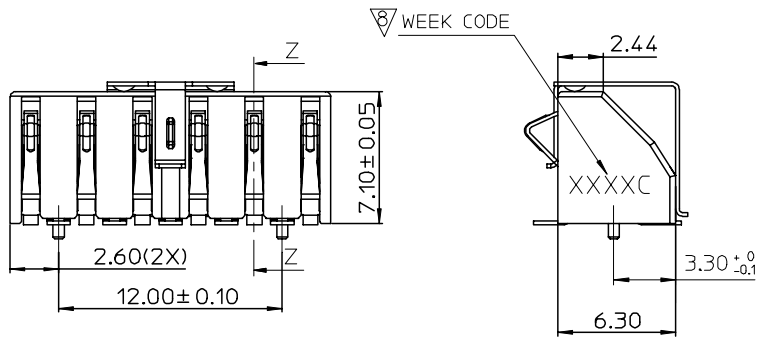

48257-1001	WITHOUT
48257-0001	WITH
MATERIAL NO.	CAP

PER EWR 2007-0101	DESCRIPTION
EC NO: SH2007-0551	
DRWN:ALLIN 2007/03/07	
CHKD: 2007/03/09	
APPR:WMSCHANG 2007/03/09	
REV	

QUALITY SYMBOLS	DESCRIPTION
▽=0	
▽C=0	

GENERAL TOLERANCES (UNLESS SPECIFIED)	MM	INCH
4 PLACES	± ---	± ---
3 PLACES	± ---	± ---
2 PLACES	± 0.25	± ---
1 PLACE	± 0.25	± ---
ANGULAR ± 3 °		
DRAFT WHERE APPLICABLE MUST REMAIN WITHIN DIMENSIONS		

DIMENSION STYLE		SCALE	DESIGN UNITS	THIRD ANGLE PROJECTION
MM ONLY			METRIC	
DRAWN BY	DATE	TITLE		
LIAND CHIANG	2006/05/11	3.00 PITCH BATTERY 6 CKTS SMT		
CHECKED BY	DATE	MOLEX INCORPORATED		
ALLEN LIN	2006/05/12	SD-48257-001		
APPROVED BY	DATE	SHEET NO.		
WILSON CHANG	2006/05/12	1 OF 1		
MATERIAL NO.	DOCUMENT NO.	THIS DRAWING CONTAINS INFORMATION THAT IS PROPRIETARY TO MOLEX INCORPORATED AND SHOULD NOT BE USED WITHOUT WRITTEN PERMISSION		
	SEE TABLE			

9 8 7 6 5 4 3 2 1