

Bus system flat-type plug - SACC-E-FSD-4CON-M16/0,5 SCO - 1535202

Please be informed that the data shown in this PDF Document is generated from our Online Catalog. Please find the complete data in the user's documentation. Our General Terms of Use for Downloads are valid (<http://download.phoenixcontact.com>)



Bus system flush-type socket, PROFINET, 4-pos., M12-SPEEDCON, D-coded, front/screw mounting with M16 thread, with 0.5 m TPE litz wire, 4 x 0.34 mm²



Key commercial data

Packing unit	1
Minimum order quantity	1
Catalog page	Page 28 (PC-2011)
GTIN	 4 046356 026956
Custom tariff number	85366990
Country of origin	GERMANY

Technical data

Mechanical characteristics

Standard - Electrical safety	M12 plug-in connector IEC 61076-2-101
Number of positions	4
Shielded	No
Insertion/withdrawal cycles	≥ 100
Connection method	Individual wires
Length of cable	0.5 m
Ambient temperature (operation)	-25 °C ... 85 °C (Male connector / female connector)
Ambient temperature (operation)	-25 °C ... 90 °C (cable, fixed installation)
Ambient temperature (operation)	(cable, flexible installation)

Material data

Inflammability class according to UL 94	V0
Contact carrier material	PA 66
Contact material	CuZn
Contact surface material	Ni/Au
Cable gland material	Zinc die-cast, nickel-plated

Bus system flat-type plug - SACC-E-FSD-4CON-M16/0,5 SCO - 1535202

Technical data

Material data

Sealing material	NBR
Degree of protection	IP67

Electrical characteristics

Number of positions	4
Nominal voltage UN	250 V
Nominal current IN	4 A
Transmission characteristics (category)	CAT5 (IEC 11801:2002), CAT5e (TIA 568B:2001)
Surge voltage category	II
Pollution degree	3

Classifications

eclass

eCl@ss 4.0	27140815
eCl@ss 4.1	27140815
eCl@ss 5.0	27143423
eCl@ss 5.1	27143423
eCl@ss 6.0	27143423
eCl@ss 7.0	27449001

etim

ETIM 2.0	EC001297
ETIM 3.0	EC002061
ETIM 4.0	EC002061

unspsc

UNSPSC 6.01	31251501
UNSPSC 7.0901	31251501
UNSPSC 11	31251501
UNSPSC 12.01	31251501
UNSPSC 13.2	31251501

Approvals

Approvals

Approvals

UL Recognized

Ex Approvals

Bus system flat-type plug - SACC-E-FSD-4CON-M16/0,5 SCO - 1535202

Approvals

Approvals submitted

Approval details

UL Recognized	
mm ² /AWG/kcmil	26-2
Nominal current I _N	4 A
Nominal voltage U _N	250 V

Drawings

Dimensioned drawing

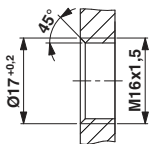

Housing cutout for M16 fastening thread, mounting panel with thread

Dimensioned drawing

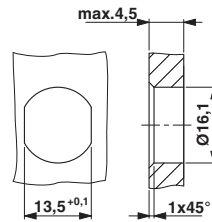

Housing cutout for M16 fastening thread, mounting panel with feed-through hole (alternatively with surface as protection against rotation)

Schematic diagram

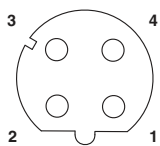

Pin assignment M12 female connector, 4-pos., D-coded, female side

Dimensioned drawing

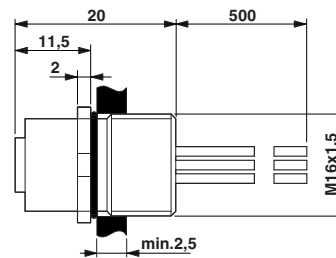

M12 flush-type connector

Bus system flat-type plug - SACC-E-FSD-4CON-M16/0,5 SCO - 1535202

Circuit diagram

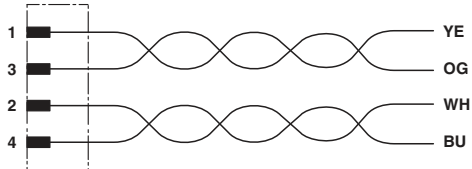

Contact assignment of the M12 socket

© Phoenix Contact 2012 - all rights reserved
<http://www.phoenixcontact.com>