

PART NUMBER	REV	FIRST USED	POWER UNIT	FEED TYPE	DESCRIPTION
1852601-1	A	122500-1	LEADMAKER	AIR FEED	CUTS CARRIER
1852601-2	A	565435-5	BENCH MODEL K	AIR FEED	CUTS CARRIER
1852601-3	A	354500-1	BENCH MODEL G	AIR FEED	CUTS CARRIER
1852601-6	A	122500-1	LEADMAKER	AIR FEED	CONTINUOUS CARRIER
7-1852601-7	A	-	-	-	SPARE PARTS

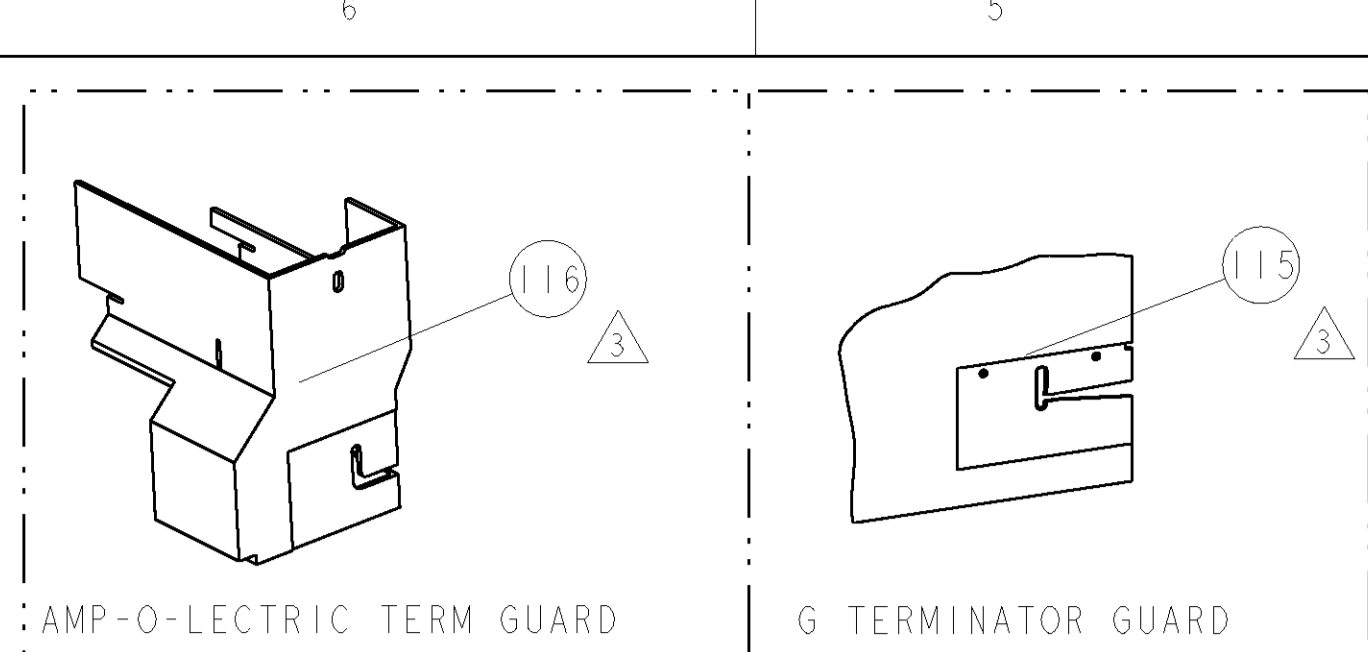

TE P/N		SIEMENS P/N	SIEMENS TERMINAL - TE CRIMP SPECS		REF SETTING
1949569		40132226			
			CRIMP HEIGHT	WIRE SIZE	
			1.17mm+.05/-0.05 [.046+.002/-0.002]	22AWG	C6
			CRIMP	SIZE	TYPE
			WIRE	1.78mm [.070]	F
			INSUL	2.29mm [.090]	F
					Ø 1.600 MAX
WIRE STRIP LENGTH	4.534-4.915	TERM APPL SPEC	NONE	FEED	24.079
				APPLICATOR INSTRUCTIONS	408-8040
				SET UP GAGE	458637-1

LOC	DIST	REVISIONS					
A	66	P	LTN	DESCRIPTION	DATE	DRN	APVD
		A		RELEASED	28DEC2007	RK	TE
		A1		ECR-09-004661	27FEB2009	MY	GB

- △ RECOMMENDED SPARE PARTS
- △ GREASE LIGHTLY
- △ GUARD MUST BE IN PLACE WHEN OPERATING APPLICATOR IN A BENCH MACHINE

*** WARNING**
ON INSTALLATION, SET WIRE DISC TO LARGEST WIRE SIZE SETTING. USE OF SETTINGS BELOW MIN. REQUIRED CRIMP HEIGHT SETTING WILL CAUSE DAMAGE TO CRIMP TOOLING.

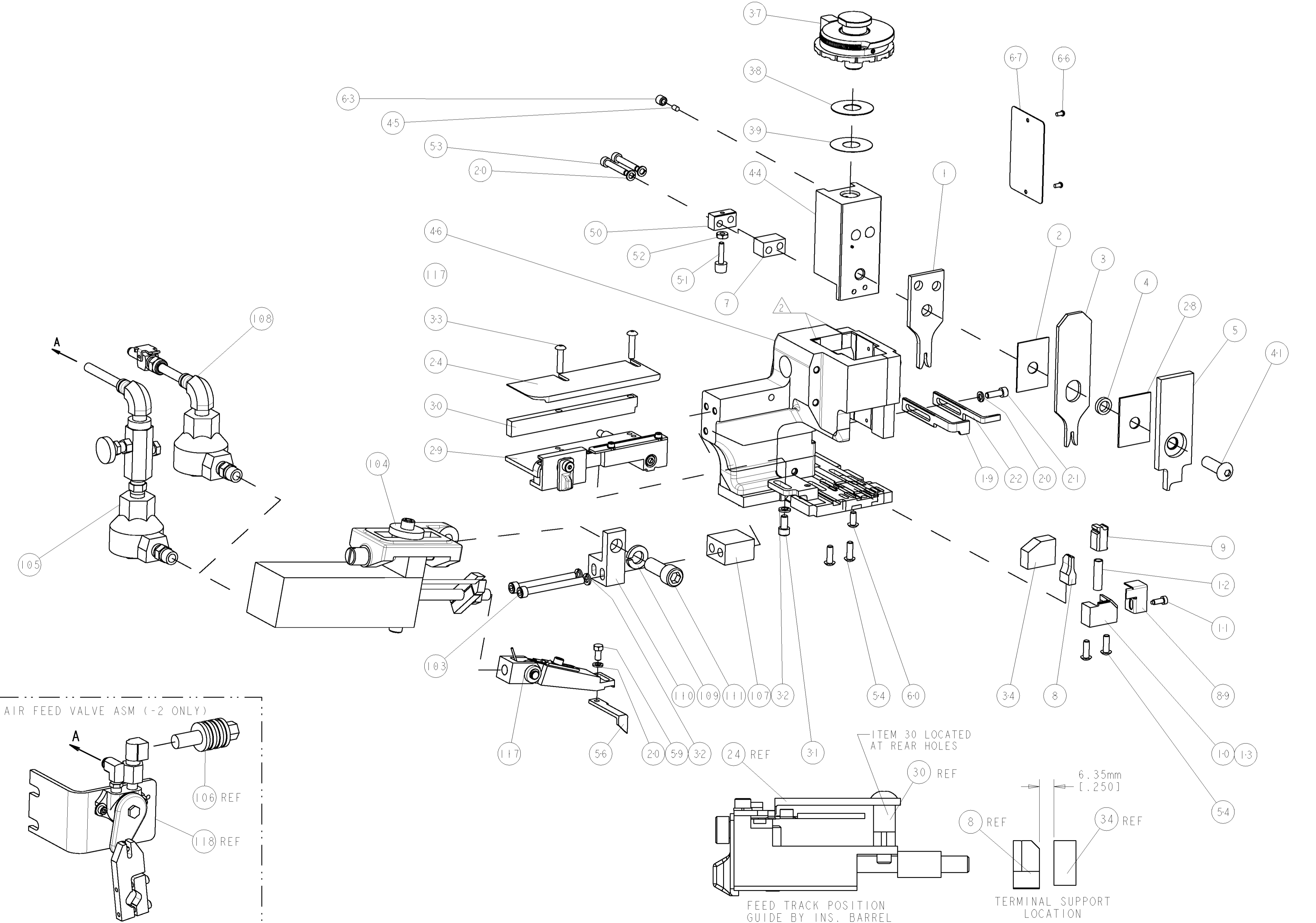

-	-	-	REF	-	-	692655-6	AIR FEED VALVE ASSEMBLY	118
-	1	1	1	1	-	461062-1	FEED FINGER ASSEMBLY	117
-	-	-	REF	-	-	455749-1	GUARD WINDOW	116
-	-	-	REF	-	-	679532-1	INSERT, GUARD	115
-	1	1	1	1	-	3-21001-5	SCR, SKT HD CAP 3/8-16 X 1.000	111
-	1	1	1	1	-	459610-1	MOUNT, FEED BRACKET	110
-	1	1	1	1	-	21024-8	WASHER, SPRG LOCK, REG 3/8	109
-	1	1	-	1	-	692655-7	AIR FEED VALVE ASSEMBLY	108
-	1	1	1	1	-	461690-1	SPACER, AIR FEED	107
-	-	-	REF	-	-	24024-2	VALVE, SHUT OFF	106
-	-	-	1	-	-	692655-5	AIR FEED VALVE ASSEMBLY	105
-	1	1	1	1	-	461065-2	ASSEMBLY, AIR FEED	104
-	2	2	2	2	-	4-21000-3	SCR, SKT HD CAP 10-32 X 2.000	103
-	1	1	1	1	-	318563-1	GUARD, FRONT CHIP	89
-	1	1	1	1	-	4088040	SF APPL INST 408-8040	72
-	1	1	1	1	-	217238-1	GENERAL INSTRUCTION PKG	71
-	1	1	1	1	-	461264-5	PLATE, IDENTIFICATION	67
-	2	2	2	2	-	21017-2	SCREW, DRIVE	66
-	1	1	1	1	-	21009-2	SCR, SET, SELF LOCKING 1/4-20 X .250	63
-	1	1	1	1	-	22733-8	SCR, BHSC, SELF-LOCKING, 8-32 X .375	60
-	1	1	1	1	-	2-22603-0	SCR, HEX HD CAP 8-32 X .312	59
-	1	1	1	1	-	458537-2	PAWL, FEED	56
-	4	4	4	4	-	2-21002-2	SCR, BTN SKT HD CAP 8-32 X .500	54
-	2	2	2	2	-	3-21000-1	SCR, SKT HD CAP 8-32 X 1.000	53
-	1	1	1	1	-	21018-5	NUT, HEX, REG 6-32	52
-	1	1	1	1	-	811242-2	BUMPER, HOLD DOWN	51
-	1	1	1	1	-	690753-1	SPACER, TONKER	50
-	1	1	1	1	-	1633399-1	APPL., BASIC AIR FEED SUB ASSY	46
-	1	1	1	1	-	690191-1	PLUG, NYLON	45
-	1	1	1	1	-	455673-1	RAM, SIDE FEED	44
-	1	1	1	1	-	7-21002-9	SCR, BTN SKT HD CAP 5/16-24 X 1.00	41
-	1	1	1	1	-	690125-1	SHIM SUB-ASSY	39
-	1	1	1	1	-	469367-9	SHIM	38
-	1	1	1	1	-	879103-3	FINE ADJUST HEAD ASSEMBLY	37
-	1	1	1	1	-	690786-1	TERMINAL SUPPORT	34
-	2	2	2	2	-	2-21002-4	SCR, BTN SKT HD CAP 8-32 X .750	33
-	3	3	3	3	-	21024-5	WASHER, SPRG LOCK, REG NO 10	32
-	1	1	1	1	-	3-21000-4	SCR, SKT HD CAP 10-32 X .375	31
-	1	1	1	1	-	1320908-4	SPACER, STRIP GUIDE	30
-	1	1	1	1	-	1-1633091-2	ASSEMBLY, STRIP GUIDE	29
-	1	1	1	1	-	1-455888-0	SPACER, CRIMPER	28
-	1	1	1	1	-	1320928-5	PLATE, STRIP GUIDE	24
-	1	1	1	1	-	690472-2	STRIPPER	22
-	1	1	1	1	-	2-21000-7	SCR, SKT HD CAP 8-32 X .500	21
-	4	4	4	4	-	21024-4	WASHER, SPRG LOCK, REG NO 8	20
-	-	1	1	-	-	691353-1	STRIPPER	19
-	1	1	1	1	-	679625-1	SHEAR HOLDER, FRONT (NO CUT)	13
-	1	1	1	1	-	3-22280-3	SPRING, COMPRESSION	12
-	1	1	1	1	-	690461-1	STOP, SHEAR	11
-	-	1	1	-	-	690459-1	SHEAR HOLDER, FRONT	10
-	1	1	1	1	-	462006-1	FLOATING SHEAR, FRONT	9
1	1	1	1	1	-	3-1633108-1	ANVIL, COMBINATION .070	8
-	1	1	1	1	-	2-240641-6	SPACER	7
-	-	-	-	-	-	-	-	6
-	1	1	1	1	-	2-455889-0	DEPRESSOR, SHEAR	5
-	1	1	1	1	-	238011-9	BLOCK, CRIMPER SPACER	4
1	1	1	1	1	-	4-1424909-4	CRIMPER, INSULATION F	3
-	1	1	1	1	-	455888-6	SPACER, CRIMPER	2
1	1	1	1	1	-	456404-9	CRIMPER, WIRE PREMIUM	1

INCHES	MILLIMETERS	APPROXIMATE WEIGHT	DESCRIPTION	ITEM NO
0	0			
1	25.4			
2	50.8			
3	76.2			
4	101.6			
5	127.0			
6	152.4			
7	177.8			
8	203.2			
9	228.6			
10	254.0			
11	279.4			
12	304.8			
13	330.2			
14	355.6			
15	381.0			
16	406.4			
17	431.8			
18	457.2			
19	482.6			
20	508.0			
21	533.4			
22	558.8			
23	584.2			
24	609.6			
25	635.0			
26	660.4			
27	685.8			
28	711.2			
29	736.6			
30	762.0			
31	787.4			
32	812.8			
33	838.2			
34	863.6			
35	889.0			
36	914.4			
37	939.8			
38	965.2			
39	990.6			
40	1016.0			
41	1041.4			
42	1066.8			
43	1092.2			
44	1117.6			
45	1143.0			
46	1168.4			
47	1193.8			
48	1219.2			
49	1244.6			
50	1270.0			
51	1295.4			
52	1320.8			
53	1346.2			
54	1371.6			
55	1397.0			
56	1422.4			
57	1447.8			
58	1473.2			
59	1498.6			
60	1524.0			
61	1549.4			
62	1574.8			
63	1600.2			
64	1625.6			
65	1651.0			
66	1676.4			
67	1701.8			
68	1727.2			
69	1752.6			
70	1778.0			
71	1803.4			
72	1828.8			
73	1854.2			
74	1879.6			
75	1905.0			
76	1930.4			
77	1955.8			
78	1981.2			
79	2006.6			
80	2032.0			
81	2057.4			
82	2082.8			
83	2108.2			
84	2133.6			
85	2159.0			
86	2184.4			
87	2209.8			
88	2235.2			
89	2260.6			
90	2286.0			
91	2311.4			
92	2336.8			
93	2362.2			
94	2387.6			
95	2413.0			
96	2438.4			
97	2463.8			
98	2489.2			
99	2514.6			
100	2540.0			