

PART NUMBER	CKT SIZE	A	B
87758-0008	8	7.90	6.00

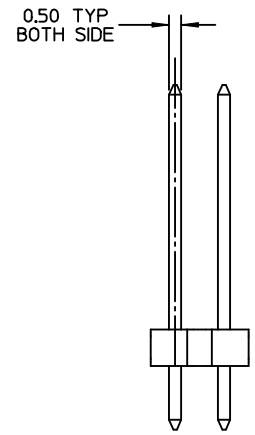
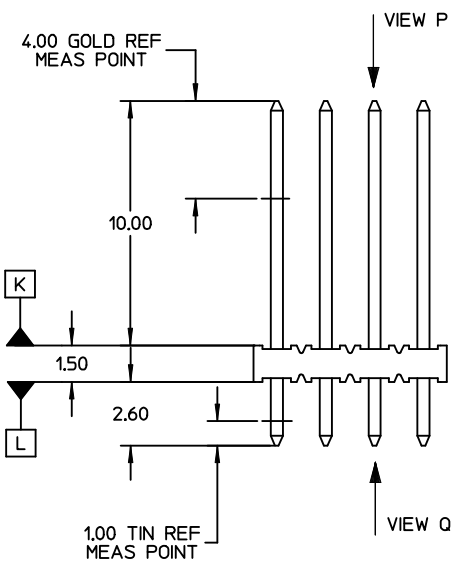
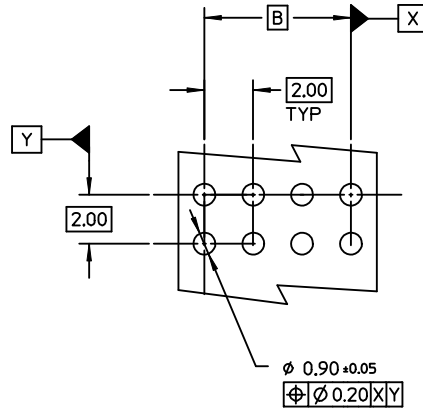
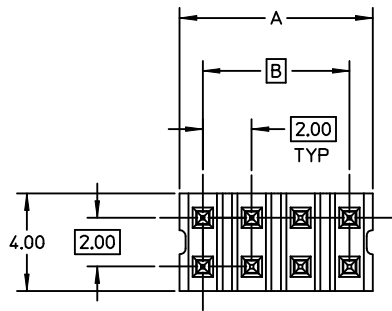

**NOTES:**

- MATERIAL:**  
HOUSING: 30% G.F. NYLON 46, 94V-0, COLOR: BLACK  
PIN: 0.50mm SQ. PHOSPHOR BRONZE 510
- PLATING:**  
15u"/0.38um MIN GOLD IN CONTACT AREA,  
75u"/1.90um MIN TIN IN SOLDER AREA, BOTH OVER  
50u"/1.25um MIN NICKEL OVERALL.
- 8 CKT USED FOR ILLUSTRATION ONLY
- PACKED IN POCKET TRAY
- PIN PUSHOUT FORCE: 1KG MIN IN EITHER DIRECTION
- PRODUCT SPEC PS-87761-100 APPLIES.

$\phi 0.71 \pm 0.07$   
 $\phi \phi 0.30 \text{ (M) K}$



VIEW P

$\phi 0.71 \pm 0.07$   
 $\phi \phi 0.30 \text{ (M) L}$



VIEW Q

EC NO: S2004-0875 DRWN:KSEE 2004/07/13 CHKD:PTLIM 2004/07/13 APPR:SKTOH 2004/07/14	QUALITY SYMBOLS	GENERAL TOLERANCES (UNLESS SPECIFIED)	SCALE NTS	DESIGN UNITS METRIC	THIRD ANGLE PROJECTION	REVISE ON CAD ONLY
	-0 C/-0	mm	INCH	DIMENSION STYLE		TITLE SALES DRAWING 2MM DUAL ROW SINGLE WAFER HDR., VERT. T/H MOLEX INCORPORATED
		4 PLACES ± --- ± ---		MM ONLY	DRAWN BY DATE	
		3 PLACES ± --- ± ---		KSEE 2004/06/28	CHECKED BY DATE	
		2 PLACES ± 0.20 ± ---		PTLIM 2004/07/08	MATERIAL NO.	DOCUMENT NO.
		1 PLACE ± --- ± ---		APPROVED BY DATE	SEE TABLE	SD-87758-146
		ANGULAR ± 3°		SCLW 2004/07/08		SHEET NO. 1 OF 1
		DRAFT WHERE APPLICABLE				
		MUST REMAIN WITHIN DIMENSIONS				