

To _____

No. ZGSM-040403M-01

Date 3rd Apr. '04

Type No.
ERDA2

Data Sheet

EGSM900 Rx SAW Filter	
Application	: Rx Filter for EGSM900
Center Frequency	: 942.5MHz
Size	: 2.0x1.4mm, 5pin-layout
Impedance	: 50-50ohms unbalance-unbalance
Part No.	: EFCH942MTCD1

Issued *A. Tsunekawa*
Check *K. Nishimura*

CIRCUIT COMPONENTS BUSINESS UNIT
MATSUSHITA ELECTRONIC COMPONENTS CO.,LTD
KADOMA, OSAKA, JAPAN

EGSM900 Rx SAW Filter

----- Unbalanced input and unbalanced output -----

Part No. :

Design No. : T942CL1

Parameter		Frequency	Your request			Our Specification			Unit
			Min.	Typ.	Max.	Min.	Typ.	Max.	
Passband			925 ... 960			925 ... 960			MHz
Insertion loss		925 ... 960MHz					1.7	2.4	dB
Ripple in passband		925 ... 960MHz					0.6	1.5	dB
Attenuation	Att1	DC ... 880MHz				30	60		dB
	Att2	880 ... 905MHz				23	32		dB
	Att3	905 ... 915MHz				18	21		dB
	Att4	980 ... 1500MHz				26	32		dB
	Att5	1500 ... 3000MHz				30	46		dB
	Att6	3000 ... 6000MHz				20	29		dB
VSWR	Input	925 ... 960MHz					1.5	2.0	
	Output	925 ... 960MHz					1.5	2.0	
Input impedance (Single Ended)						50			Ohm
Output impedance(Single Ended)						50			Ohm
Maximum drive level								13	dBm
Operating temperature						-30		+85	deg. C
Storage temperature						-40		+85	deg. C

EGSM900 Rx SAW Filter

----- Unbalanced input and unbalanced output -----

Part No. :

Design No. : T942CL1

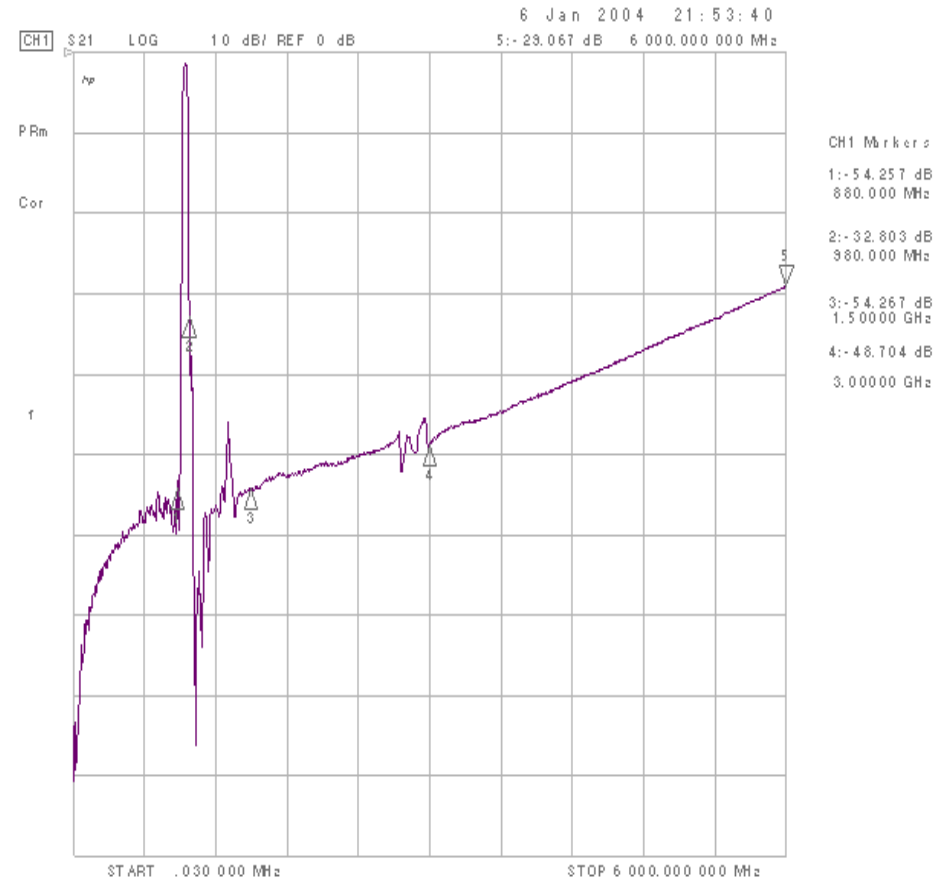
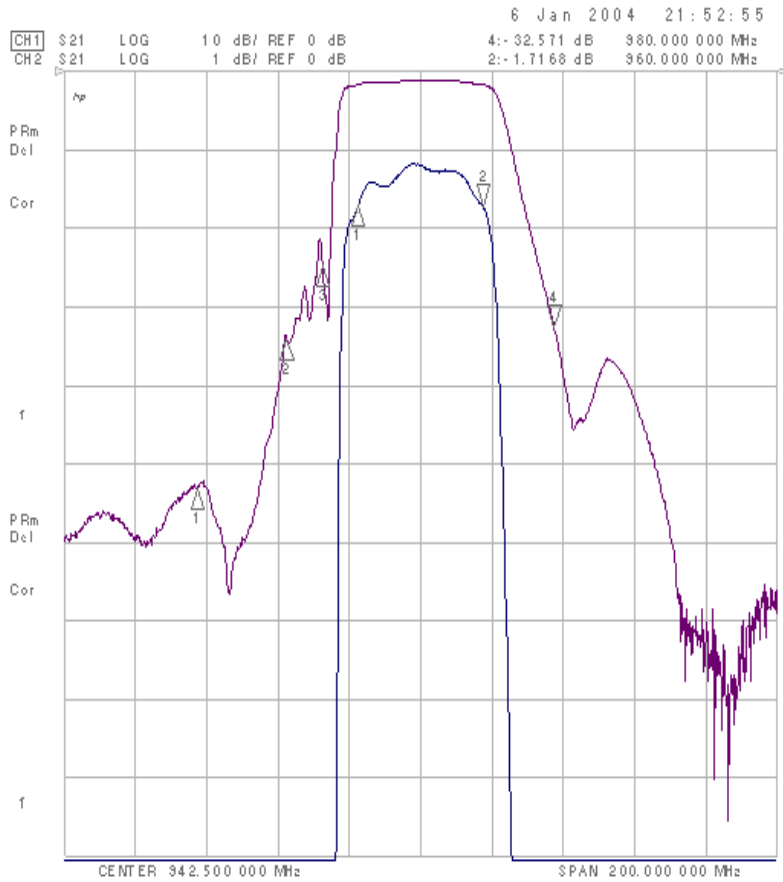

EGSM900 Rx SAW Filter

----- Unbalanced input and unbalanced output -----

Part No. :

Design No. : T942CL1

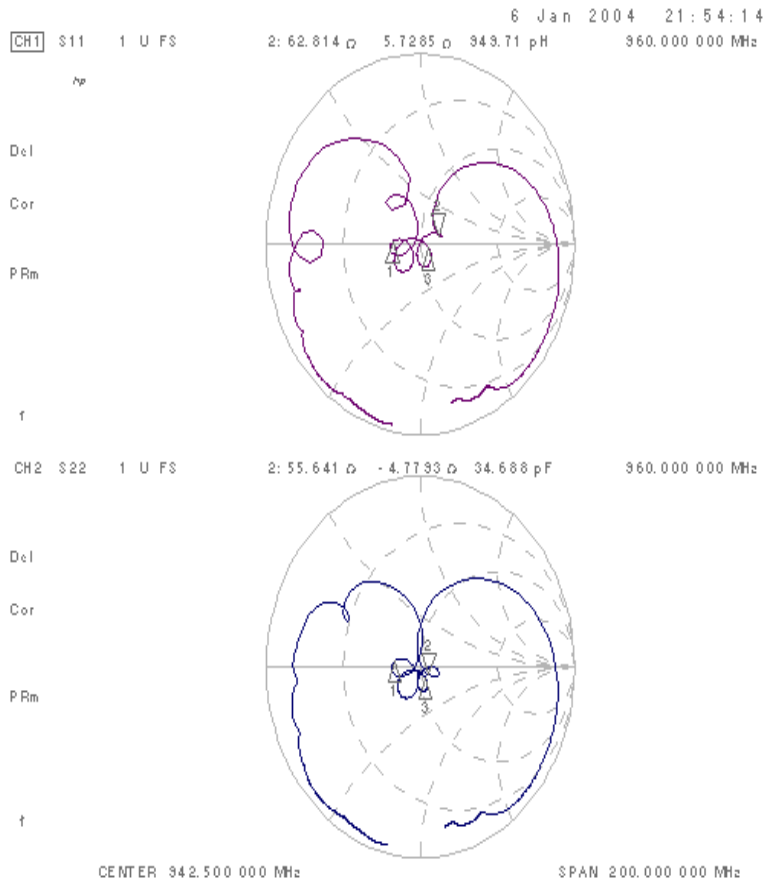

THIRD ANGLE PROJECTION

Tolerance : +/-0.05

Under Development

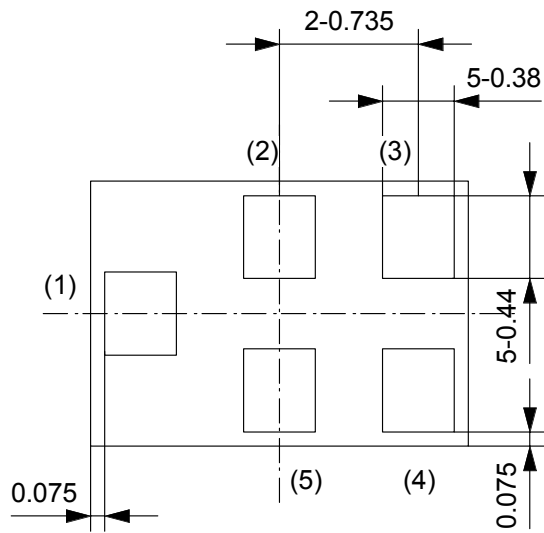
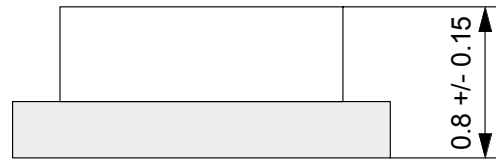
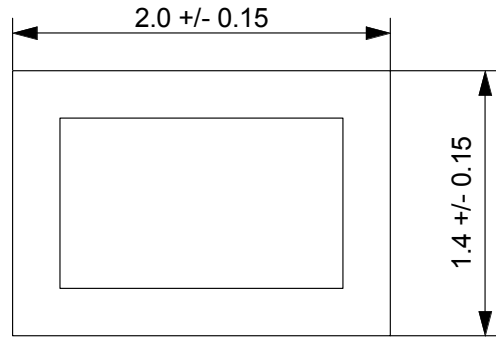

- (1) Input
- (2) GND
- (3) GND
- (4) Output
- (5) GND

Note :
 The design manufacturing process,
 and Specification of this device
 are subject to change without
 notice.

UNLESS OTHERWISE SPECIFIED		
BASIC DIMENSIONS		TOLERANCE
UP TO	INCL	
TO	INCL	
TO	INCL	
TO	INCL	
ABOVE		

--	--	--

ISSUE	REVISIONS	DATE
MATERIAL	FINISH	SCALE
DESIGN		
DRAW		
CHECK		
APPROVAL		
DRAWING NO.		

NAME SAW Filter	TYPE NO.
--------------------	----------

**CERAMIC BUSINESS UNIT, LCR DEVICE COMPANY
 MATSUSHITA ELECTRONIC COMPONENTS CO.,LTD.
 KADOMA, OSAKA, JAPAN**

DO NOT SCALE DRAWING

REVISIONS INDICATED BY Δ

ALL DIMENSIONS ARE IN MILLIMETERS

THIRD ANGLE PROJECTION

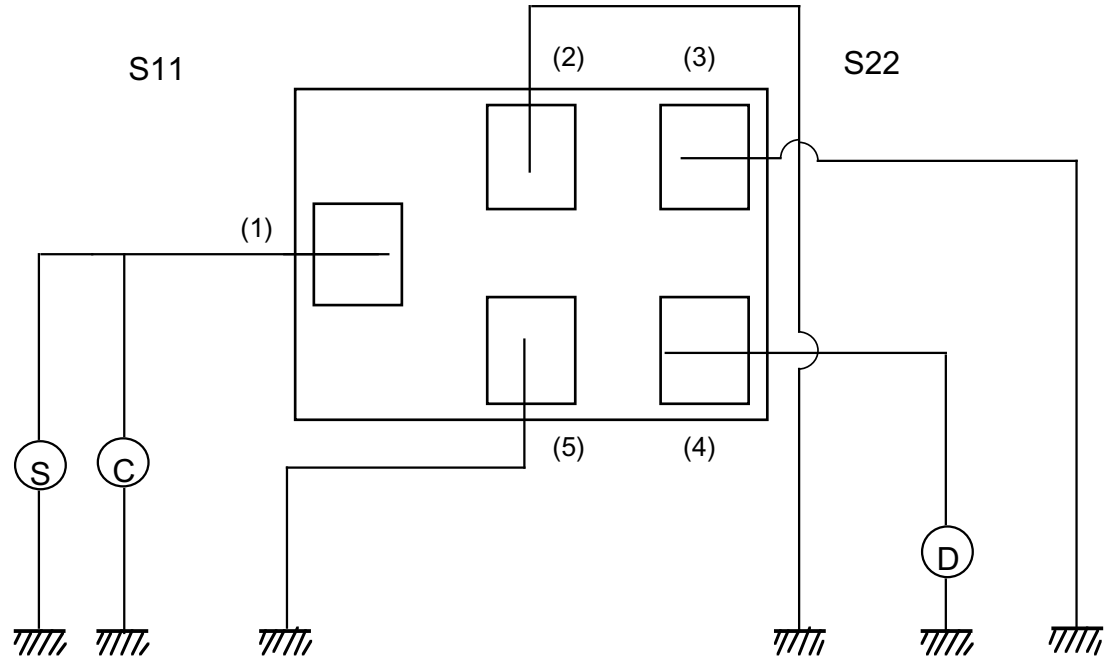

0 Level

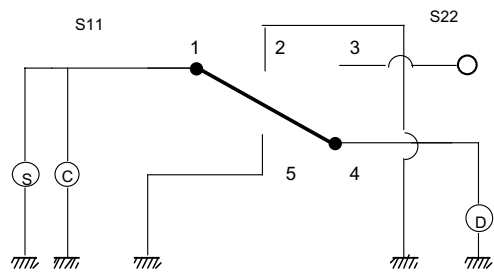

Fig. 2

- S : Standard Signal Generator
(Output Impedance 50 ohm)
- C : Frequency Counter
- D : Detector
(Input Impedance 50 ohm)

UNLESS OTHERWISE SPECIFIED

BASIC DIMENSIONS		TOLERANCE
UP TO	INCL	
TO	INCL	
TO	INCL	
TO	INCL	
ABOVE		

--	--	--

ISSUE	REVISIONS	DATE
MATERIAL FINISH SCALE		
DESIGN		
DRAW		
CHECK		
APPROVAL		
DRAWING NO.		

NAME	TYPE NO.
SAW filter	

CERAMIC BUSINESS UNIT , LCR DEVICE COMPANY
MATSUSHITA ELECTRONIC COMPONENTS CO.,LTD.
KADOMA, OSAKA, JAPAN

THIRD ANGLE PROJECTION

UNLESS OTHERWISE SPECIFIED

BASIC DIMENSIONS		TOLERANCE
UP TO	INCL	
TO	INCL	
TO	INCL	
TO	INCL	
ABOVE		

Recommended land pattern

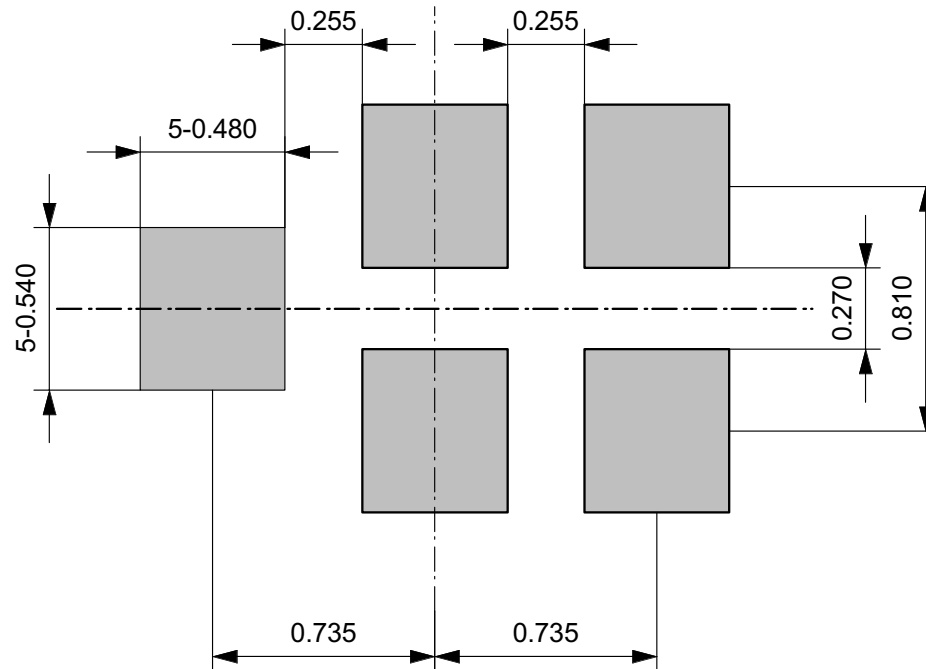

Note :
The design manufacturing process, and Specification of this device are subject to change without notice.

--	--	--

ISSUE	REVISIONS	DATE
MATERIAL	FINISH	SCALE
DESIGN		
DRAW		
CHECK		
APPROVAL		
DRAWING NO.		

NAME	SAW Filter	TYPE NO.
------	------------	----------

**CERAMIC BUSINESS UNIT, LCR DEVICE COMPANY
MATSUSHITA ELECTRONIC COMPONENTS CO.,LTD.
KADOMA, OSAKA, JAPAN**

DO NOT SCALE DRAWING

REVISIONS INDICATED BY Δ

ALL DIMENSIONS ARE IN MILLIMETERS