

THIS DOCUMENT IS SUBJECT TO CHANGE WITHOUT NOTICE. IT IS CONFIDENTIAL AND A PROPERTY OF Amphenol LTW. DISCLOSURE TO THIRD PARTY HAS TO BE AUTHORIZED BY Amphenol LTW.

REV.	ECN NO.	DATE	SIGN	DESCRIPTION
C	C190112	2019/01/15	JC CHEN	Drawings Change
D	C190542	2019/04/09	Huaiyu	Remove PRT_CSYS_DEF
E	C210614	2021/04/26	Xiaofeng	\triangle E X3

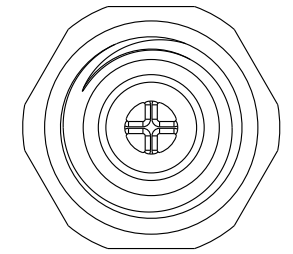
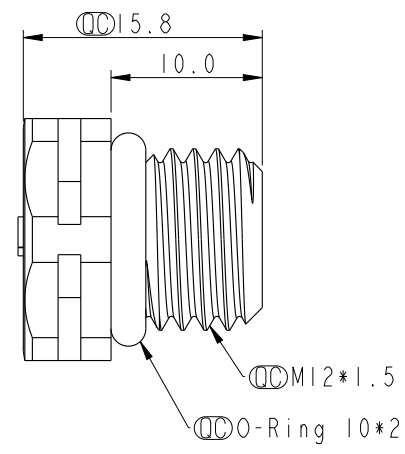
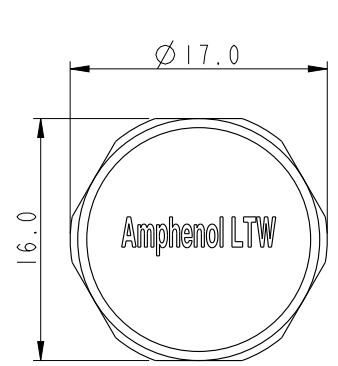
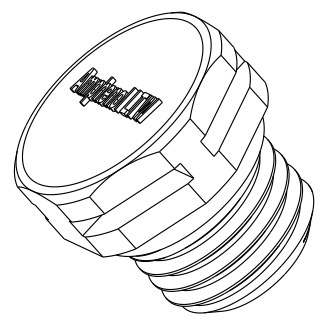

成品料號 (Product no.)	透氣量 ml/min@70mbar	主體顏色 (Body Colour)	O-Ring Color	疏油性 (Oleophobic)	Waterproof Rate
VENT-PSINCR-N8001	>1000	White(Translucent)	Blue	N	IP68/IP69K
VENT-PSINCR-08001	>550	White(Translucent)	Black	Y	IP68/IP69K
VENT-PSINCR-08002	>1000	White(Translucent)	Green	Y	IP68/IP69K
VENT-PSINCR-N8002	>3000	White(Translucent)	Red	N	IP68/IP69K

UNIT: mm			TITLE M12*1.5 VENT
TOLERANCE .X ±0.25 .XX ±0.1 .XXX ±0.05 ANGLES ±1°	SCALE 2:1	SIZE A4	SHEET 1 OF 2
REV. E	WC-REV. A.7	⊙: Inspection item	

Amphenol LTW
安費諾亮泰企業股份有限公司

ITEM NO.	DRAWN BY Huaiyu	DATE 2019-04-09
DWG NO. VENT-PSINCR-XXXXX	CHECKED BY Feng-li	DATE 2019-04-09
CUSTOMER ALTW	APPROVED BY Jerry	DATE 2019-04-09

Screw Nut: Optional part
 No.: APTP-ABKPA012-001
 螺母作為選配件

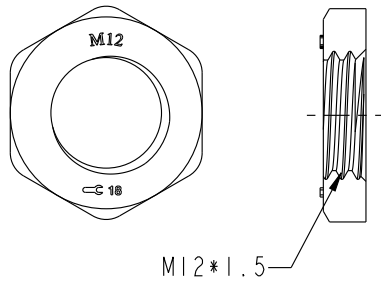

Through-hole

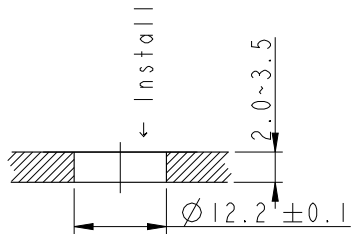

Recommended Panel Cut-Out
 建議開孔尺寸

Threaded-hole

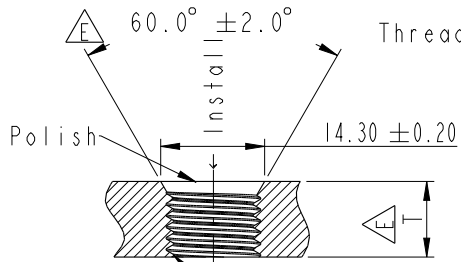

Recommended Panel Cut-Out
 建議開孔尺寸

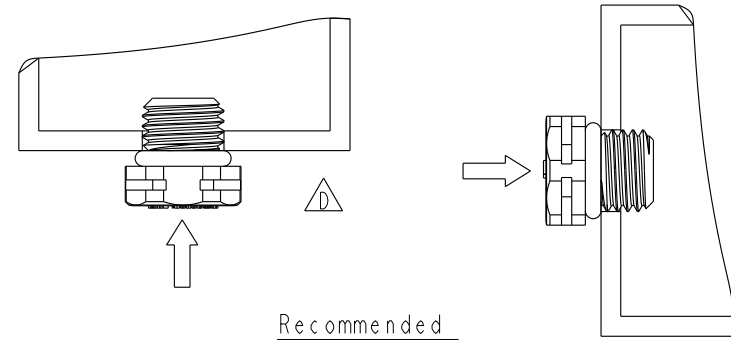

Recommended
 installation orientation
 建議安裝朝向

Note:

- * \varnothing Important Dimension.
- * Cap: PC+ABS, 94V-0, UV Resistance
- * Membrane: ePTFE
- * Body: PC+ABS, 94V-0, UV Resistance
- * O-Ring: Silicone, 94V-0
- * Recommended Torque: 6.0~8.0 Kgf.cm

UNIT: mm

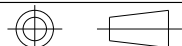

TITLE

M12*1.5 VENT

Amphenol LTW

ITEM NO

DRAWN BY

DATE

DWG NO

CHECKED BY

DATE

CUSTOMER

APPROVED BY

DATE

TOLERANCE
 .X ± 0.25
 .XX ± 0.1
 .XXX ± 0.05
 ANGLES $\pm 1^\circ$

SCALE 2:1

SIZE A4

SHEET 2 OF 2

REV. E

WC-REV. A.7

\varnothing : Inspection item

安費諾亮泰企業股份有限公司

VENT-PSINCR-XXXXX

Feng-li

2019-04-09

ALTW

Jerry

2019-04-09