

P.C.B. HOLE DRILLINGS

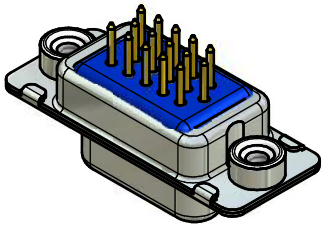
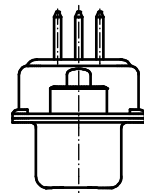
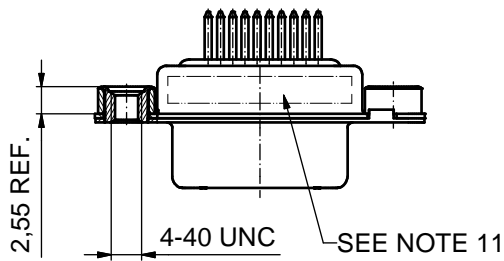
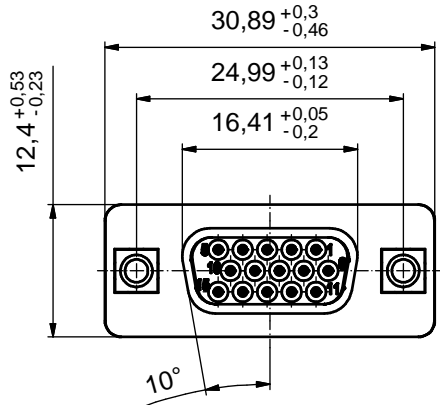
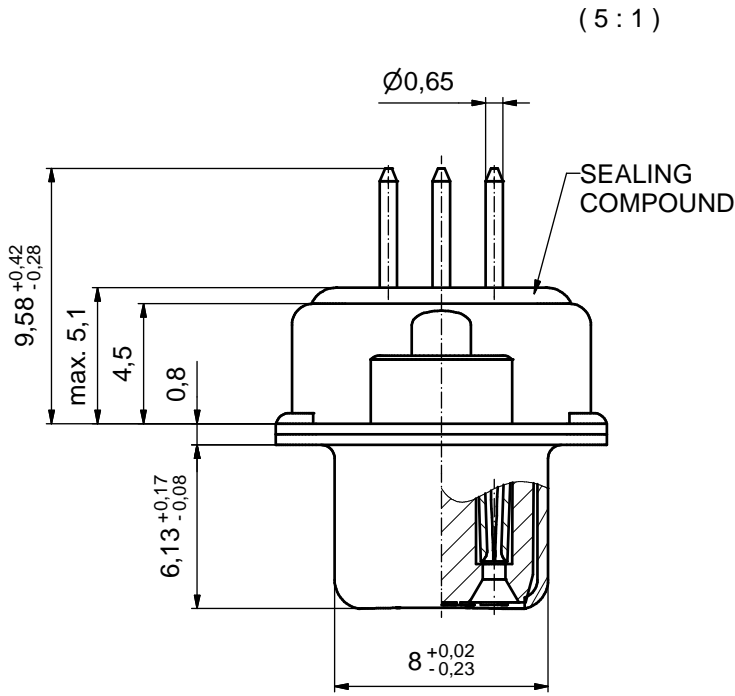

NOTES:

1. RoHS COMPLIANT
2. SUITABLE FOR WAVESOLDERING
3. METALSHELLS: STEEL; min. 315µm TIN over 40-80µm NICKEL
4. INSULATORS: HIGH TEMPERATURE PLASTIC UL 94 V-0, BLACK
5. CONTACTS: COPPER ALLOY  
PLATING: 8µm HARD GOLD over min. 50µm NICKEL
6. THREADED INSERT: COPPER ALLOY; min. 200µm TIN over 80µm NICKEL
7. SLEEVE: COPPER ALLOY; min. 200µm TIN over 80µm NICKEL
8. CAPACITANCE: 370pF ± 20%
9. DIELECTRIC WITHSTANDING VOLTAGE: 300 VDC
10. MAXIMUM TORQUE VALUE FOR THREAD: 6 in.LB
11. CONNECTOR IS PART MARKED: 242A18060X CONEC ABC

Directive 2002/95/EC  
„RoHS“  
Compliant

APPROVAL # FREIGABE # DEBLOCAGE # AUTORIZACION # APPROVAL	
CUSTOMER APPROVAL DATE:	
NAME:	TITLE:
COMPANY NAME:	
APPROVAL # FREIGABE # DEBLOCAGE # AUTORIZACION # APPROVAL	

THIS DRAWING MAY NOT BE COPIED OR REPRODUCED IN ANY WAY AND MAY NOT BE PASSED ON TO A THIRD PARTY WITHOUT WRITTEN PERMISSION. OWNERSHIP AND COPYRIGHT OF CONEC GmbH				tolerance		dim. in mm	scale: 2:1 (5:1)	
DO NOT ALTER CAD DRAWING BY HAND				date			material: SEE Notes	
a Origin				name		title:		
rev. description				date		D-SUB HD FILTER FEMALE		
				drawn: 27.05.2008		15 pos. SOLDER PIN STRAIGHT		
				appd.: 27.05.2008		with threaded insert		
				norm		dwg no: Inventor 10		
				d-old		DIN-A3		
				CONEC		sh: 1		
						part no: 242A18060X		

scale: 2:1 (5:1)	
material: SEE Notes	
title:	
D-SUB HD FILTER FEMALE	
15 pos. SOLDER PIN STRAIGHT	
with threaded insert	
dwg no: Inventor 10	
DIN-A3	
sh: 1	
part no: 242A18060X	