

MATERIALS AND FINISHES

BODY REAR ZINC ALLOY  
PLATED TIN

BODY FRONT BRASS  
PLATED NICKEL

CENTER CONTACT PHOSPHOR BRONZE  
PLATED GOLD

OUTER CASING HIGH TEMPERATURE PLASTIC  
KEYING SEE TABLE  
COLOR SEE TABLE

INSULATOR TEFLON

PACKAGING BY TRAY

RETENTION SPECIFICATION

THE FAKRA CONNECTOR SHROUD WILL WITHSTAND  
A LONGITUDINAL FORCE OF 110 N (24.75 LBS)

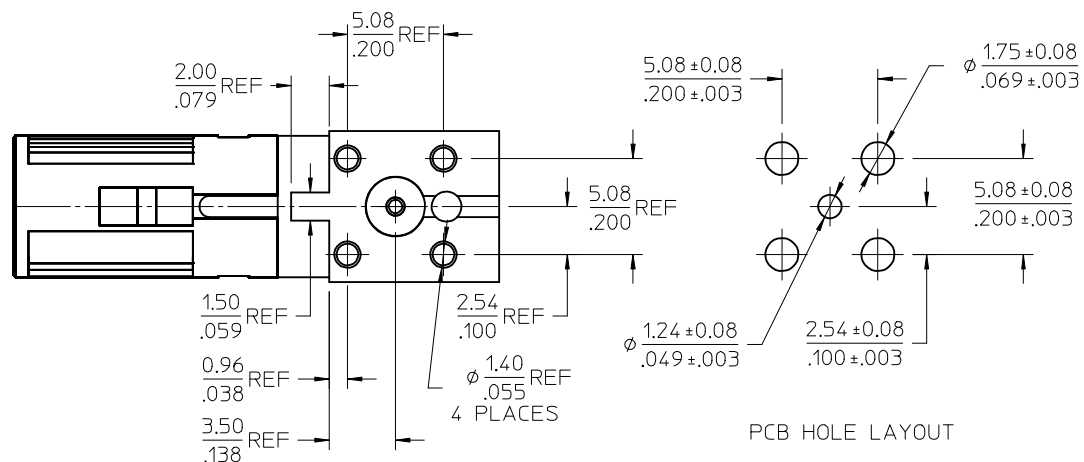
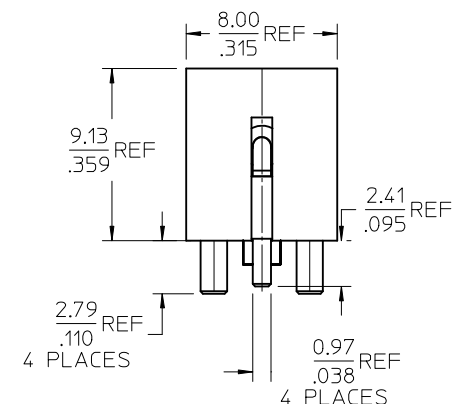
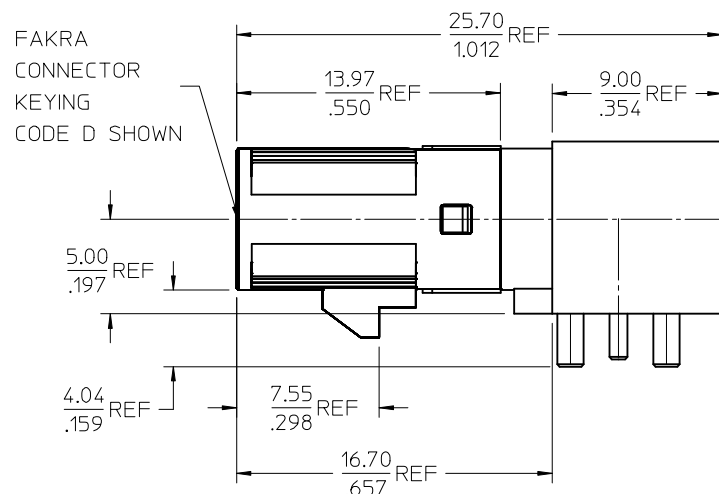
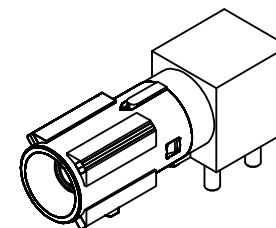

MIL-STD-348A, FIG. 311.1	INTERFACE SPECIFICATION
SPECIFICATION	DESCRIPTION

CHG: NEW RELEASED EC NO: URF2009-0724 DRAWN: MCHANOS 2009/06/11 CHKD: 2009/06/11 APPR: MHIUANG 2009/06/12	QUALITY SYMBOLS ▽=0 ▽=0	GENERAL TOLERANCES (UNLESS SPECIFIED) 4 PLACES ± --- ± --- 3 PLACES ± --- ± --- 2 PLACES ± --- ± --- 1 PLACE ± --- ± --- ANGULAR ± 2°	DIMENSION STYLE MM/IN DRAWN BY: MICHAEL DATE: 2009/05/11 CHECKED BY: JUDY DATE: 2009/05/11 APPROVED BY: MISEN DATE: 2009/05/11	SCALE: METRIC DESIGN UNITS: METRIC THIRD ANGLE PROJECTION	TITLE: SMB JACK, R/A FAKRA, PCB 50 OHMS, REVERSE SHROUD SMB-J/PCB/RA MOLEX MOLEX INCORPORATED	MATERIAL NO. SEE TABLE DOCUMENT NO. SD-73403-531	SHEET NO. 1 OF 2
		DRAFT WHERE APPLICABLE MUST REMAIN WITHIN DIMENSIONS		THIS DRAWING CONTAINS INFORMATION THAT IS PROPRIETARY TO MOLEX INCORPORATED AND SHOULD NOT BE USED WITHOUT WRITTEN PERMISSION			

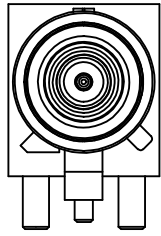

CODE-A

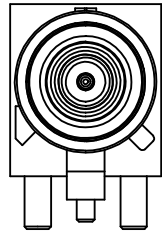

CODE-B

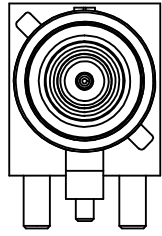

CODE-C

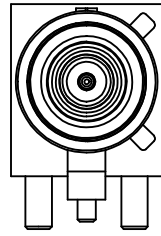

CODE-D

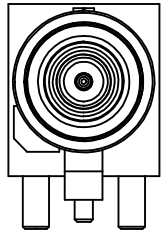

CODE-E

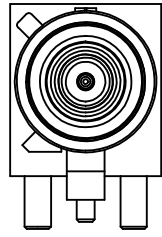

CODE-F

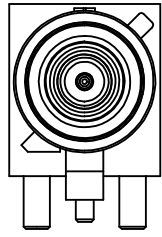

CODE-G

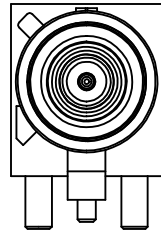

CODE-H

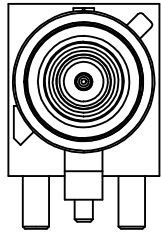

CODE-I

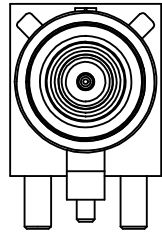

CODE-K

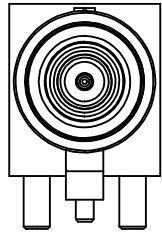

CODE-Z

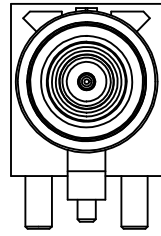

CODE-L

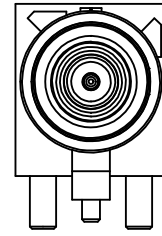

CODE-M

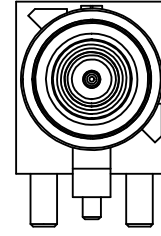

CODE-N

N	PASTEL GREEN	73403-5323
M	PASTEL ORANGE	73403-5322
L	CARMINE RED	73403-5321
Z	WATER BLUE	73403-5320
K	CURRY YELLOW	73403-5319
I	BEIGE	73403-5318
H	VIOLET	73403-5317
G	GRAY	73403-5316
F	BROWN	73403-5315
E	GREEN	73403-5314
D	BORDEAUXVIOLET	73403-5313
C	BLUE	73403-5312
B	NATURAL	73403-5311
A	BLACK	73403-5310
KEYING CODE	COLOR	PART NO.

SEE SHEET 1	QUALITY SYMBOLS
EC NO: URF2009-0724	▽=0
DRWNG: CHAN05 2009/06/11	▽=0
CHKD: 2009/06/11	
APPR: MHUANG 2009/06/12	
REV	DESCRIPTION
A	

GENERAL TOLERANCES (UNLESS SPECIFIED)
4 PLACES ± --- ± ---
3 PLACES ± --- ± ---
2 PLACES ± --- ± ---
1 PLACE ± --- ± ---
ANGULAR ± 2 °
DRAFT WHERE APPLICABLE MUST REMAIN WITHIN DIMENSIONS

DIMENSION STYLE	SCALE	DESIGN UNITS	THIRD ANGLE PROJECTION
MM/IN		METRIC	
DRAWN BY	DATE	TITLE	
MICHAEL	2009/05/11	SMB JACK, R/A FAKRA, PCB 50 OHMS, REVERSED SHROUD SMB-J/PCB/RA	
CHECKED BY	DATE		
JUDY	2009/05/11		
APPROVED BY	DATE		
MISEN	2009/05/11		
MATERIAL NO.	DOCUMENT NO.		
SEE TABLE	SD-73403-531		
SIZE	THIS DRAWING CONTAINS INFORMATION THAT IS PROPRIETARY TO MOLEX INCORPORATED AND SHOULD NOT BE USED WITHOUT WRITTEN PERMISSION		

MATERIAL NO.	DOCUMENT NO.	SHEET NO.
SEE TABLE	SD-73403-531	2 OF 2