



### Electrical Specifications

**Frequency Range:** 3000-12700 MHz  
**Insertion Loss:** 1.5 dB Max  
**VSWR:** 2.0:1 Max  
**Return Loss:** 10 dB Min  
**Rejection:** 40 dB @ DC-2700 MHz  
**Power Handling:** 20 Watts

### Mechanical

**Connector Type:** SMA (F)  
**Dimensions:** 50 x 33 x 11 mm

### Environmental

**Operating Temperature:** -40 to +85° C

### Outline Drawing:

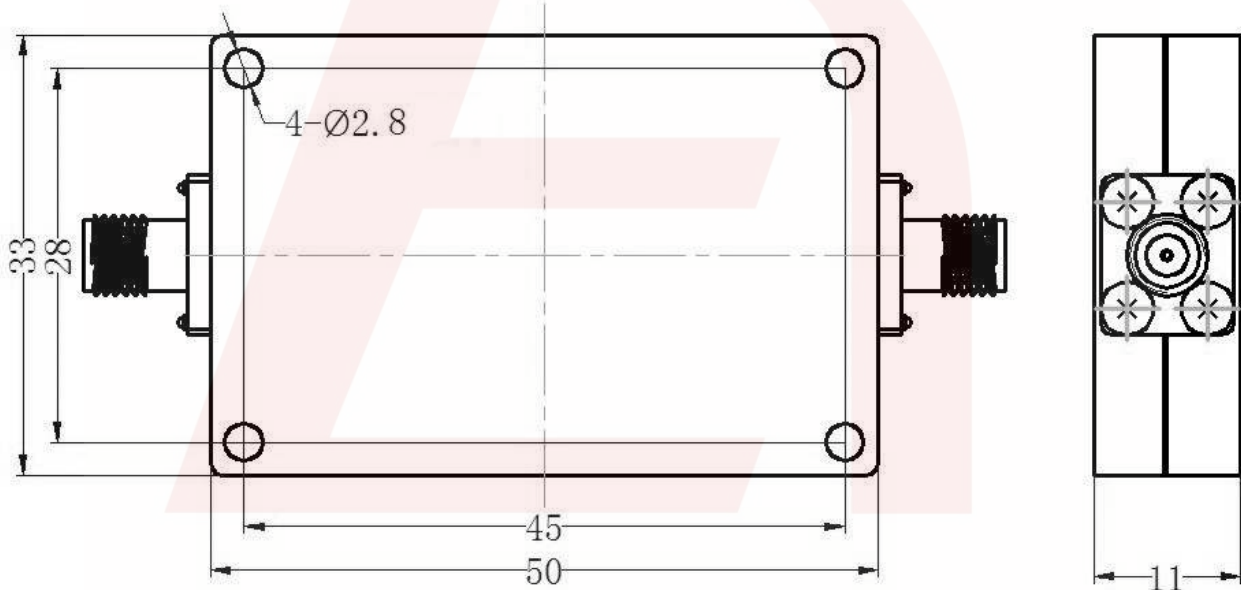

Tolerance:  $\pm 0.3$ .  
Dimension: mm