

MATERIAL NO.	KEY OPTION	TAIL PLATING
76105-0184	LEFT	TIN / LEAD
76105-0185	LEFT	TIN

OBSELETE

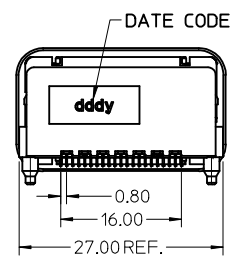
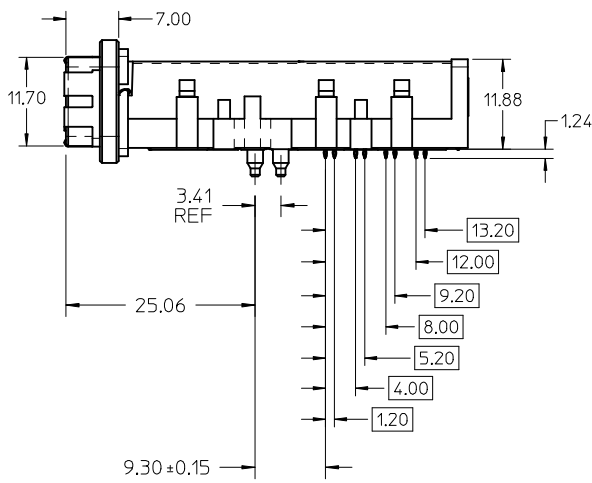
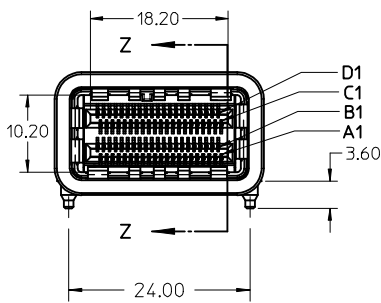
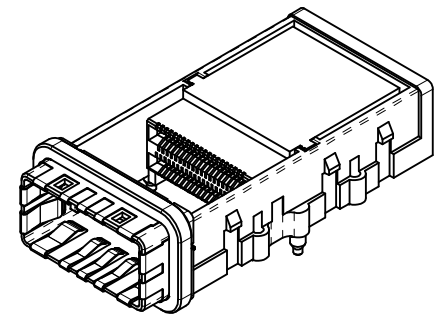
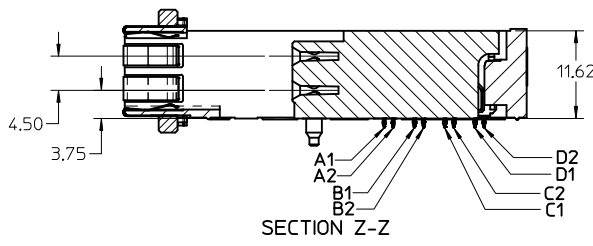
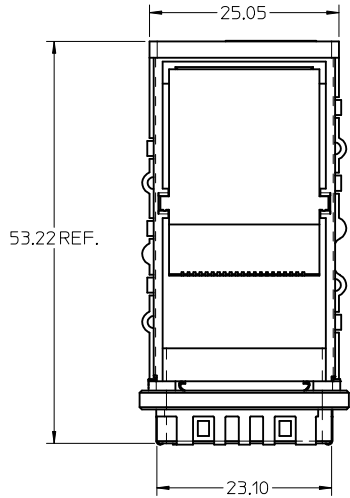

- NOTES:
- MATERIALS:**
CONNECTOR HOUSING: HIGH TEMPERATURE THERMOPLASTIC
GLASS-FILLED, UL 94V-0
EMI HOUSING: NICKEL PLATED DIE CAST ALLOY
EMI GASKET: CONDUCTIVE POLYMER
TERMINALS: COPPER ALLOY
 - PLATING:**
CONTACT AREA: 0.76µm MIN. GOLD OVER 2.54µm MIN. NICKEL
TIN/LEAD TAIL AREA: 0.76µm - 1.52µm TIN/LEAD (90/10)
TIN TAIL AREA: 0.76µm - 1.52µm TIN
OVER 1.27µm MIN NICKEL
 - PACKAGING SPECIFICATION:** TRAY PACK PER PK-76105-001.
 - MOUNTING HARDWARE REQUIRED:** M2x0.4 CAP SCREWS (4)
MOUNTING SCREW LENGTH: BOARD THICKNESS + 4mm MAX

REVISIONS REV DESCRIPTION 1 2 3 4	QUALITY SYMBOLS ▽=0 ▽=0	GENERAL TOLERANCES (UNLESS SPECIFIED) mm INCH 4 PLACES ± --- ± --- 3 PLACES ± --- ± --- 2 PLACES ± 0.25 ± --- 1 PLACE ± --- ± --- ANGULAR ± 1/2°	DIMENSION STYLE MM ONLY	SCALE 2:1	DESIGN UNITS METRIC	THIRD ANGLE PROJECTION
			DRAWN BY DATE JLONG 2009/10/13	CHECKED BY DATE JLONG 2009/10/13	APPROVED BY DATE	MATERIAL NO. SEE CHART
DRAFT WHERE APPLICABLE MUST REMAIN WITHIN DIMENSIONS						
THIS DRAWING CONTAINS INFORMATION THAT IS PROPRIETARY TO MOLEX INCORPORATED AND SHOULD NOT BE USED WITHOUT WRITTEN PERMISSION						

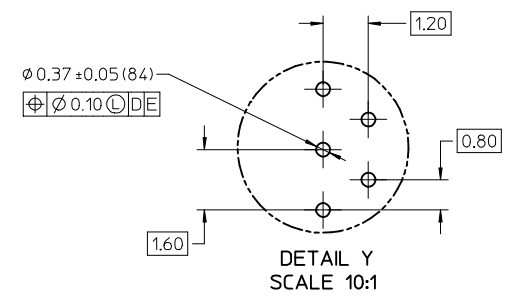
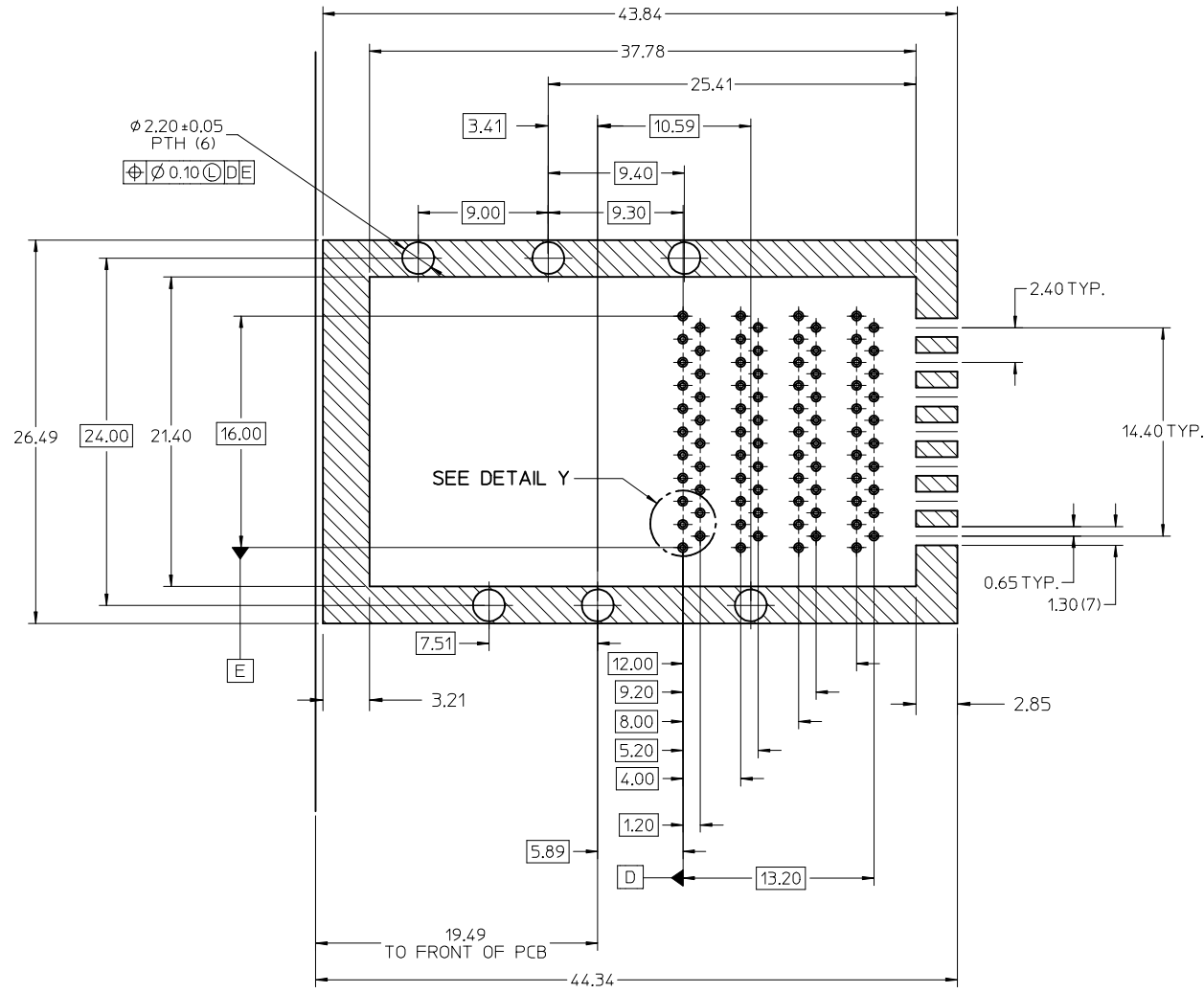

- NOTES:
- CROSS-HATCHED AREA TO BE CONDUCTIVE ON THE PCB.
 - CROSS-HATCHED AREA MUST BE INCORPORATED IN THE FLAT ROCK PRESS-FIT TOOLING.
 - RECOMMENDED DRILL SIZE FOR 0.37 ϕ FINISHED PTH IS 0.48-0.50 mm ϕ (.0189-.0200 in ϕ (#76 DRILL))
 - RECOMMENDED ANNULAR RING AROUND 0.37 ϕ FINISHED PTH IS 0.73 ϕ
 - MINIMUM RECOMMENDED SPACING: 26.50

RECOMMENDED PCB LAYOUT
COMPONENT SIDE SHOWN
PCB THICKNESS: 1.57mm MIN.

SEE SHEET 1 EC NO: UCP2013-0647 DRAWING PRATT 2012/08/28 CHKD: MBANAKIS 2012/08/28 APPR: MBANAKIS 2012/08/30	QUALITY SYMBOLS	GENERAL TOLERANCES (UNLESS SPECIFIED)		DIMENSION STYLE	SCALE	DESIGN UNITS	THIRD ANGLE PROJECTION
	$\nabla=0$	mm	INCH	MM ONLY	4:1	METRIC	
	$\nabla=0$	4 PLACES \pm --- \pm ---	JLONG	DRAWN BY	DATE	TITLE	
		3 PLACES \pm --- \pm ---	JLONG	CHECKED BY	DATE	IPASS PLUS HSC 84 HIGH SPEED CHANNEL 0.8MM I/O	
	2 PLACES ± 0.25 \pm ---		APPROVED BY	DATE	MOLEX INCORPORATED		
	1 PLACE \pm --- \pm ---		ANGULAR $\pm 1/2^\circ$		MATERIAL NO.	DOCUMENT NO.	SHEET NO.
		DRAFT WHERE APPLICABLE MUST REMAIN WITHIN DIMENSIONS		SEE CHART		SD-76105-184	2 OF 4
		THIS DRAWING CONTAINS INFORMATION THAT IS PROPRIETARY TO MOLEX INCORPORATED AND SHOULD NOT BE USED WITHOUT WRITTEN PERMISSION					

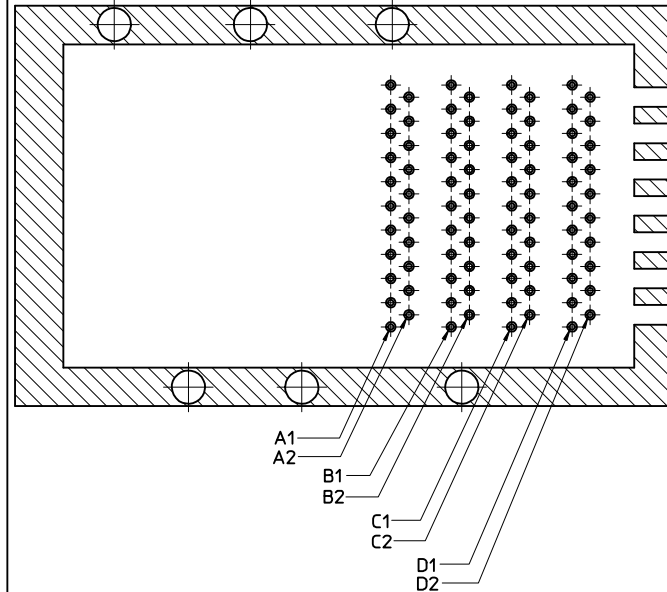
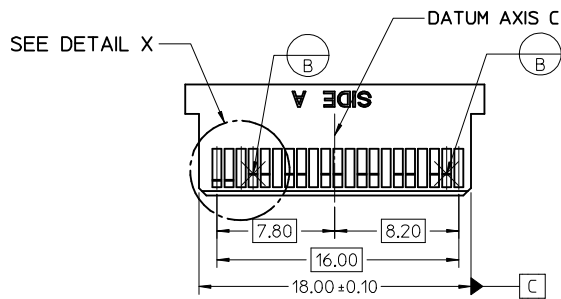
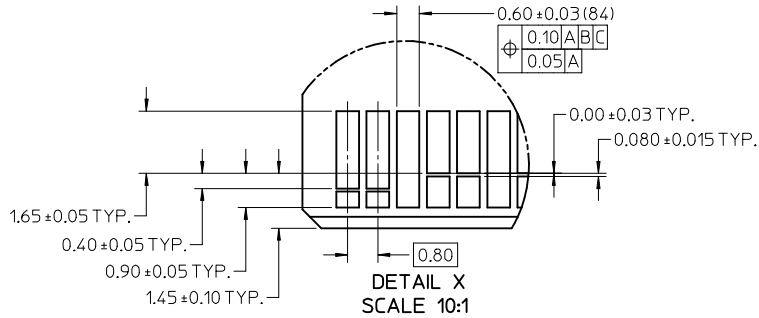
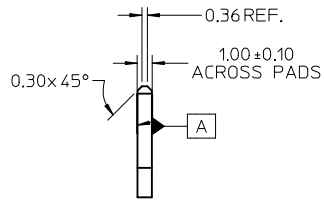
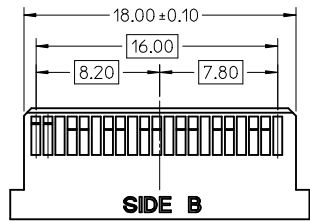

NOTES:

- 0.03 MINIMUM KEEP OUT FOR SOLDER MASK AROUND ALL PADS
- DATUM B TARGETS ARE DEFINED BY THE RESPECTIVE PAD CENTER LINES AND THE LEADING EDGE OF THE TARGET PADS

SEE SHEET 1 EC NO: UCP2013-0617 DRAWING: GRATT 2012/08/28 CHKD: MBANAKIS 2012/08/28 APPR: MBANAKIS 2012/08/30	QUALITY SYMBOLS ▽=0 ▽=0	GENERAL TOLERANCES (UNLESS SPECIFIED)		DIMENSION STYLE MM ONLY	SCALE 4:1	DESIGN UNITS METRIC	THIRD ANGLE PROJECTION		
		4 PLACES ± --- ± ---	3 PLACES ± --- ± ---	2 PLACES ± 0.25 ± ---	1 PLACE ± --- ± ---	DRAWN BY JLONG	DATE 2009/10/13	TITLE IPASS PLUS HSC 84 HIGH SPEED CHANNEL 0.8MM I/O	
		ANGULAR ± 1/2°				CHECKED BY JLONG	DATE 2009/10/13	MOLEX INCORPORATED	
		DRAFT WHERE APPLICABLE MUST REMAIN WITHIN DIMENSIONS				APPROVED BY	DATE	MATERIAL NO. SEE CHART	DOCUMENT NO. SD-76105-184

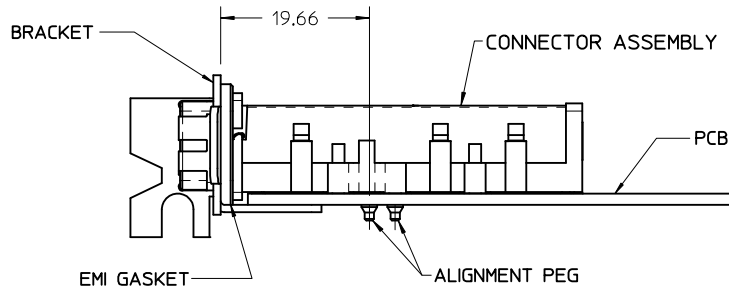
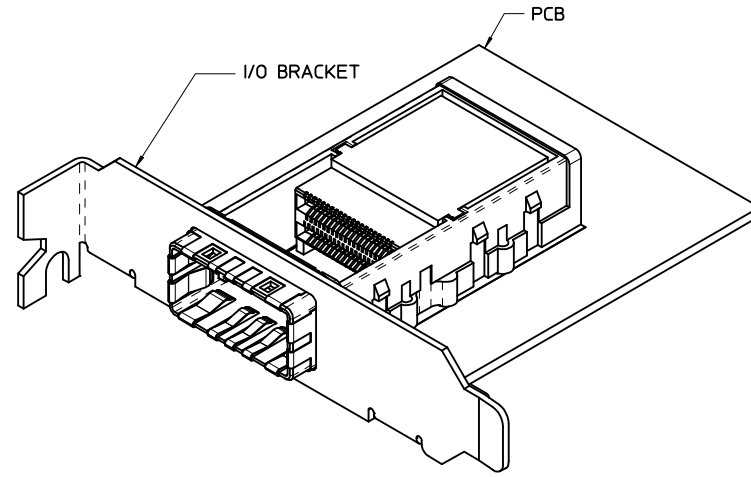

ASSEMBLED VIEW

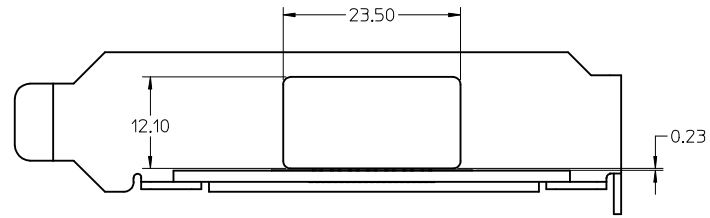

I/O BRACKET CUT-OUT

(NOT SUPPLIED)

SEE SHEET 1 EC NO: UCP2013-0617 DRAWING: GPRATT 2012/08/28 CHKD: MBANAKI S 2012/08/28 APPR: MBANAKI S 2012/08/30	DESCRIPTION REV	QUALITY SYMBOLS	GENERAL TOLERANCES (UNLESS SPECIFIED)	DIMENSION STYLE	SCALE	DESIGN UNITS	THIRD ANGLE PROJECTION															
		$\nabla=0$ $\nabla=0$	<table border="1"> <thead> <tr> <th></th> <th>mm</th> <th>INCH</th> </tr> </thead> <tbody> <tr> <td>4 PLACES</td> <td>± ---</td> <td>± ---</td> </tr> <tr> <td>3 PLACES</td> <td>± ---</td> <td>± ---</td> </tr> <tr> <td>2 PLACES</td> <td>± 0.25</td> <td>± ---</td> </tr> <tr> <td>1 PLACE</td> <td>± ---</td> <td>± ---</td> </tr> </tbody> </table>		mm	INCH	4 PLACES	± ---	± ---	3 PLACES	± ---	± ---	2 PLACES	± 0.25	± ---	1 PLACE	± ---	± ---	MM ONLY	2:1	METRIC	
			mm	INCH																		
		4 PLACES	± ---	± ---																		
3 PLACES	± ---	± ---																				
2 PLACES	± 0.25	± ---																				
1 PLACE	± ---	± ---																				
DRAFT WHERE APPLICABLE MUST REMAIN WITHIN DIMENSIONS	<table border="1"> <thead> <tr> <th>DRAWN BY</th> <th>DATE</th> <th>CHECKED BY</th> <th>DATE</th> <th>APPROVED BY</th> <th>DATE</th> </tr> </thead> <tbody> <tr> <td>JLONG</td> <td>2009/10/13</td> <td>JLONG</td> <td>2009/10/13</td> <td></td> <td></td> </tr> </tbody> </table>	DRAWN BY	DATE	CHECKED BY	DATE	APPROVED BY	DATE	JLONG	2009/10/13	JLONG	2009/10/13			TITLE IPASS PLUS HSC 84 HIGH SPEED CHANNEL 0.8MM I/O								
DRAWN BY	DATE	CHECKED BY	DATE	APPROVED BY	DATE																	
JLONG	2009/10/13	JLONG	2009/10/13																			
MATERIAL NO. SEE CHART	DOCUMENT NO. SD-76105-184	SHEET NO. 4 OF 4																				