

SECTION B-B  
SCALE 4:1

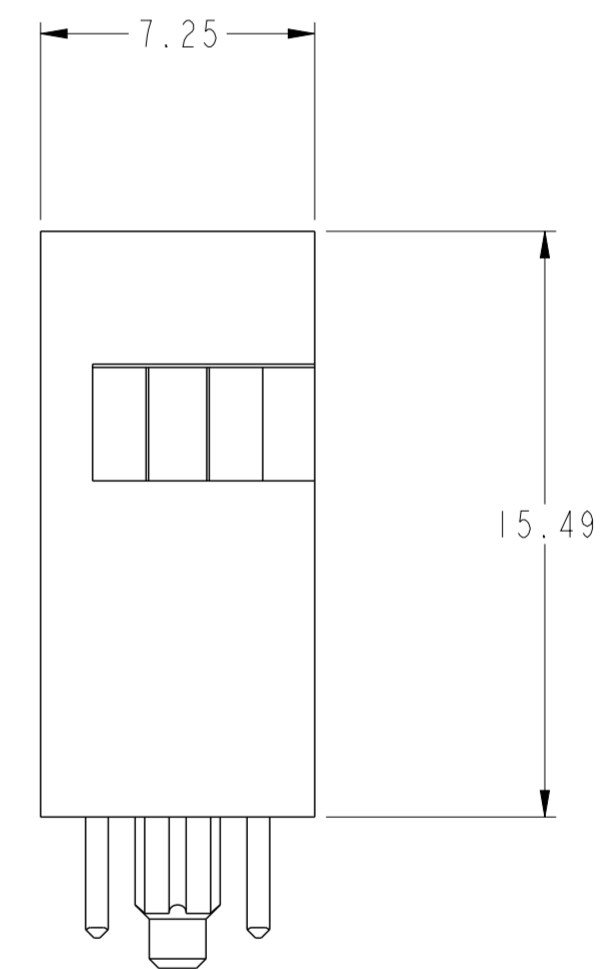

spec ref	-	dr	Hai-Ling Liu	2015/03/20	projection	mm	size	A2	scale	5:1
tolerance std	ASME Y14.5	eng	Hai-Ling Liu	2015/04/10			ecn no	-	product family - rel level	Released
TOLERANCES UNLESS OTHERWISE SPECIFIED		chr	Terris Liu	2015/04/10			rel level	Released		
surface	ASME Y14.5	appr	Pei-Ming Zheng	2015/04/10			cat. no.	-		
linear	0.X ±0.3 0.XX ±0.10 0.XXX ±0.050			title HPCE CTB HEADER VERTICAL 4LP WITH LATCH		dwg no 10134040	rev A			
angular	0° ±2°	<a href="http://www.fci.com">www.fci.com</a>		Product - Customer Draw		sheet 1 of 3				

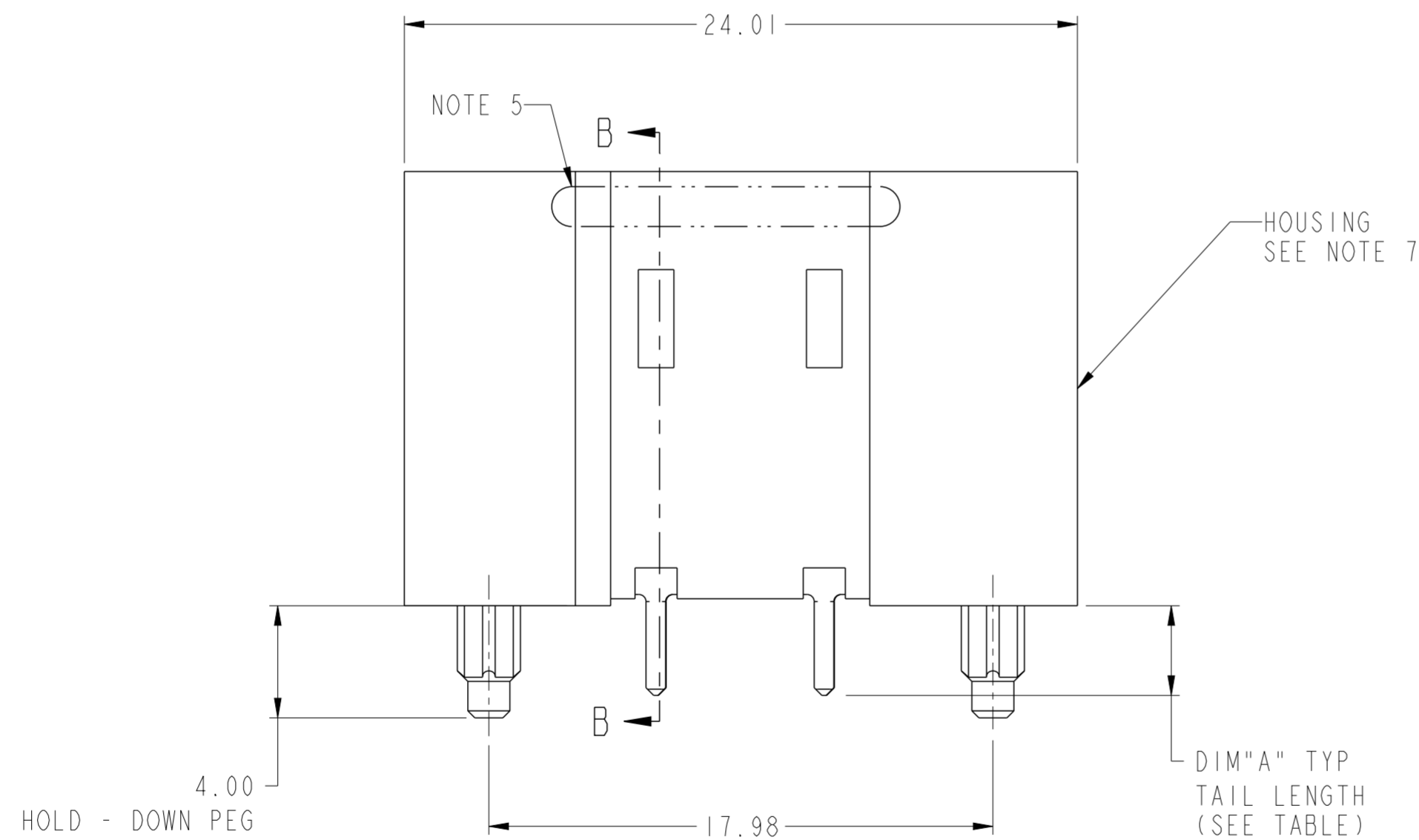

PRODUCT PART NUMBER

10134040-□□□□□LF

BASE PART NUMBER

CONTACT AREA PLATING  
 UNDERPLATED 50u"(1.27um) MIN. NICKEL  
 1: 100u"(2.5um) MIN. Ag  
 2: 30u"(0.760um) MIN. GXT

FIRST MATE LAST BREAK PIN POSITION  
 000: ALL PINS ARE LONG PINS SEE TABLE  
 001: SOME PINS ARE SHORT PINS SEE TABLE

DIM "A", TAIL LENGTH  
 1: 3.00±0.25mm (PCB THK 1.57mm Min PF)  
 2: 3.25±0.25mm (PCB THK 2.36mm +/-0.13mm)  
 3: 2.60±0.25mm (PCB THK 1.57mm +/-0.13mm)

POWER CONTACT	ROW#	P#	DIM "C"±0.25	DIM "A"±0.25	
	ROW A		P1	8.86	3.25
		P2	7.59	3.25	
		P3	8.86	2.60	
		P4	7.59	2.60	
		P9	8.86	3.00	
		P10	7.59	3.00	
ROW B			P1	8.86	3.25
			P2	8.86	3.25
			P3	7.59	2.60
			P4	7.59	2.60
		P9	8.86	3.00	
		P10	7.59	3.00	

NUMBER	END MODULE	POWER CONTACT			END MODULE
		2	1		
000		P1	P1	ROW A	
		P1	P1	ROW B	

NOTES:

- CONNECTOR MATERIALS:  
 HOUSING: HIGH TEMPERATURE THERMAL PLASTIC, BLACK UL 94V-0 COMPLIANT  
 CONTACTS: HIGH PERFORMANCE COPPER ALLOY.
- CONTACT FINISH REF. GS-12-1031 SECTION 5.2
- PRODUCT SPECIFICATION: GS-12-1031
- APPLICATION SPECIFICATION: GS-20-0369
- PRODUCT MARKING (FCI PART NUMBER & DATE CODE) ON HOUSING IN AREA SHOWN.
- PACKAGING MEETS FCI SPECIFICATION GS-14-2272.
- HOUSING COMPONENT WILL WITHSTAND EXPOSURE TO 260°C PEAK TEMPERATURE FOR 60 SECONDS IN A CONVECTION, INFRA-RED, OR VAPOR PHASE REFLOW OVEN.
- COPPER PLATING THICKNESS IN CENTER OF VIA-HOLE CAN BE NO MORE THAN 0.003 LESS THAN OTHER AREAS.
- ALL HOLE SIZES ARE FINISHED HOLE SIZES.
- MOUNTING HOLES ARE UNPLATED  
 $\varnothing 2.25 \pm 0.05$  FOR SOLDER TAILS

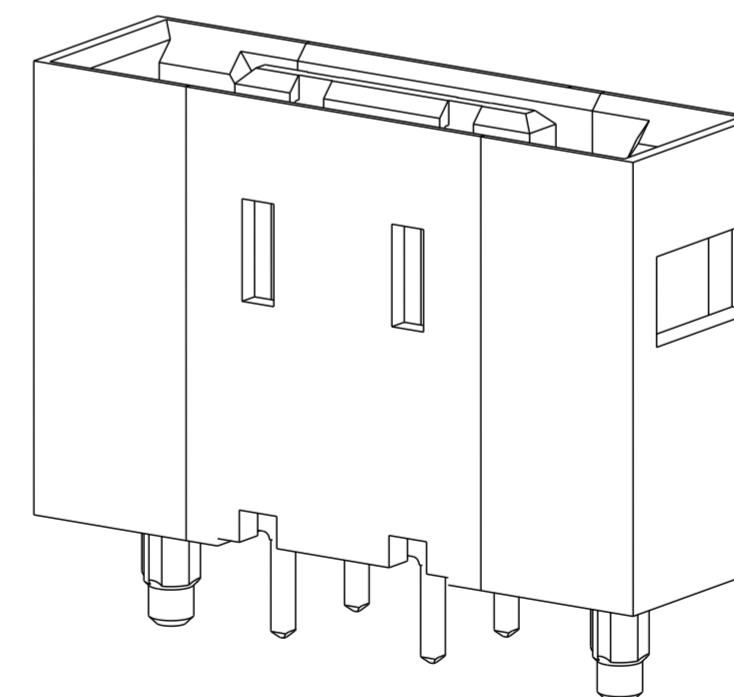

SCALE 4:1

spec ref	-	dr	Hai-Ling Liu	2015/03/20	projection	mm	size	A2	scale	5:1			
tolerance std	ASME Y14.5	eng	Hai-Ling Liu	2015/04/10			ecn no	-					
TOLERANCES UNLESS OTHERWISE SPECIFIED		chr	Terris Liu	2015/04/10			rel level	Released					
surface	linear	appr	Pai-Ming Zheng	2015/04/10	product family	-	rel level	Released					
	0.X	±0.3			TITLE HPCE CTB HEADER VERTICAL 4LP WITH LATCH		dwg no	10134040		rev	A		
	0.XX	±0.10					www.fci.com		cat. no.	Product - Customer Drw		sheet 3 of 3	
	0.XXX	±0.050											
ASME Y14.5	angular	0°	±2°										