

RECOMMENDED CARD INSERTION:
 1: INSERT CARD WITH 30° ANGLE
 2: ROTATE CARD TO HORIZONTAL
 3: WITHDRAW CARD WITH 25° ANGLE

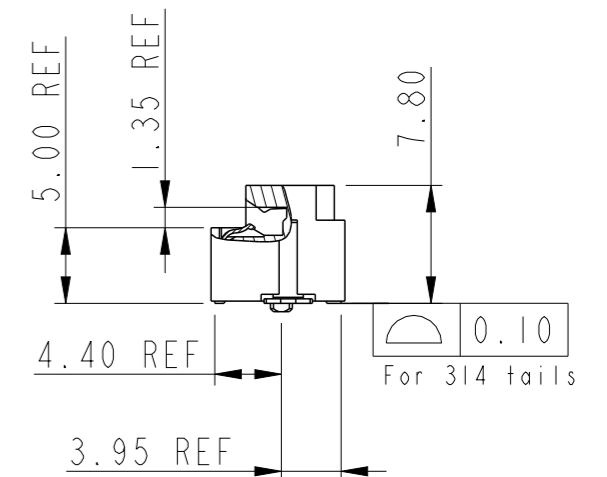

spec ref	-	dr	Zhen-Hua Liu	2020/10/16	projection	mm	size	A3	scale	1:1
tolerance std	ISO 406 ISO 1101	eng	Huang, Xi-Chen	2022/12/07			ecn no	ELX-DG-46684-1		
TOLERANCES UNLESS OTHERWISE SPECIFIED		chr	-	-			rel level	Released		
surface	linear	0.X	±0.3	Amphenol FCI	product family		-	-		rev
		0.XX	±0.20		MXM 3.0 Connector		dwg no	10151114		B
	angular	0°	±2°		RA SMT		cat. no.	-	Product - Customer Drw	sheet 1 of 6

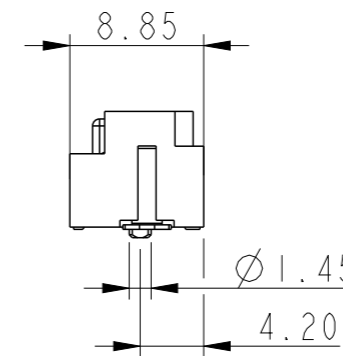
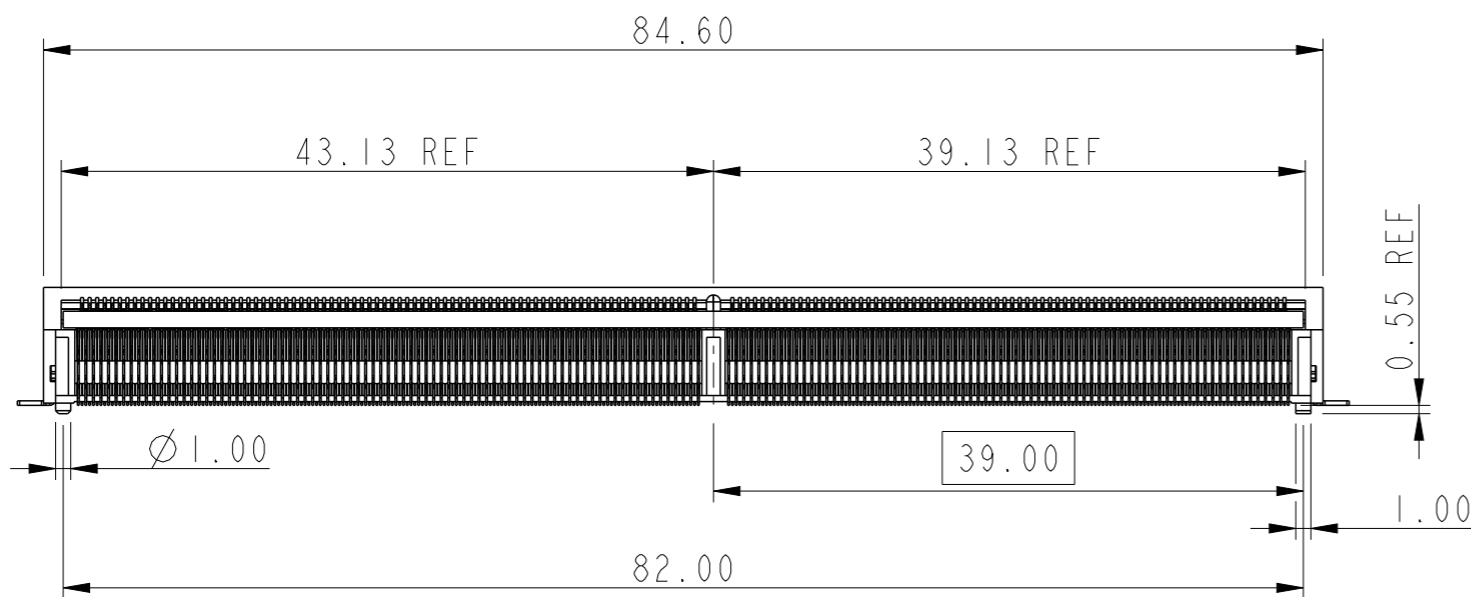
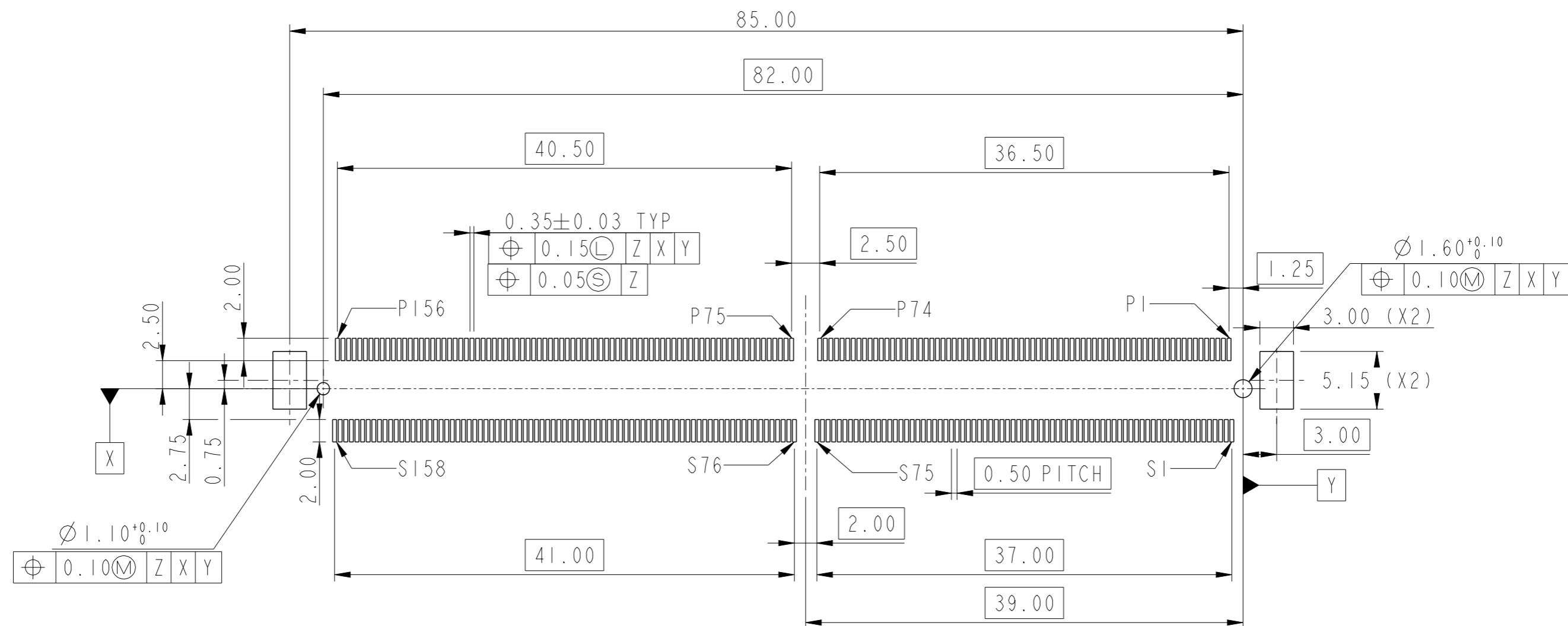

SCALE 5:2

MOTHER BOARD SURFACE (DATUM Z)

RECOMMENDED SMARC PCB LAYOUT

spec ref	-	dr	Zhen-Hua Liu	2020/10/16	projection	mm	size	A3	scale	1:1	
tolerance std	ISO 406 ISO 1101	eng	Huang, Xi-Chen	2022/12/07			ecn no	ELX-DG-46684-1			
TOLERANCES UNLESS OTHERWISE SPECIFIED		chr	-	-			rel level	Released			
surface	linear	appr	Heaven Cen	2022/12/08	product family	-	dwg no	10151114		rev	B
ISO 1302	angular	Amphenol FCI		MXM 3.0 Connector RA SMT		cat. no.	-	Product - Customer Drw	sheet 4 of 6		
	0.X										
	0.XX										
	0.XXX										
	0°										

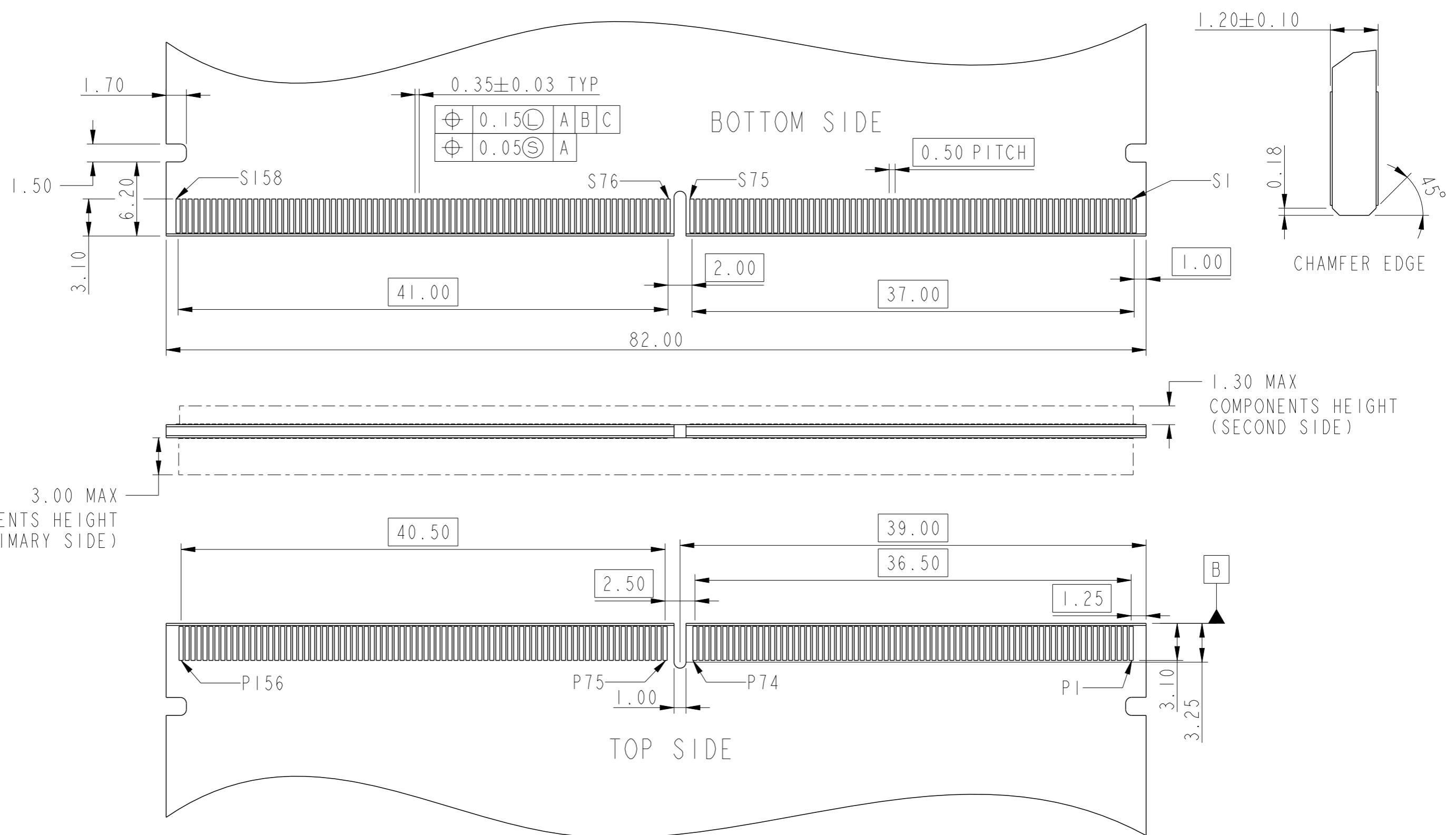

CROSS THE PAD

spec ref	-	dr	Zhen-Hua Liu	2020/10/16	projection	mm	size	A3	scale	1:1			
tolerance std	ISO 406 ISO 1101	TOLERANCES UNLESS OTHERWISE SPECIFIED			eng	Huang, Xi-Chen	2022/12/07	ecn no	ELX-DG-46684-1				
surface	ISO 1302	linear	0.X	±0.3	chr	-	apppr	Heaven Cen	2022/12/08	product family	-	rel level	Released
		angular	0°	±2°	Amphenol FCi	MXM 3.0 Connector	RA SMT	cat. no.	-	Product - Customer Drw	sheet 5 of 6	rev	B

NOTES:

1. MATERIAL:
HOUSING: HIGH TEMPERATURE RESIN, HF, BLACK UL 94V-0
TERMINAL: COPPER ALLOY
HOLD DWON: COPPER ALLOY
2. PRODUCT SPEC: GS-12-1531
3. FINISH:
NICKLE UNDERPLATING
CONTACT AREA: Au PLATING or GXT PLATING
SOLDER TAIL: GOLD FLASH PLATING
- 4, THE HOUSING WILL WITHSTAND EXPOSURE TO 260 °C PEAK TEMPERATURE FOR 10 SECONDS IN A CONVECTION, INFRA-RED OR VAPOR PHASE REFLOW OVEN.
- 5, DATE CODE(SSYYWWD) TO BE LASER MARKED ON THIS SURFACE TEXT TO BE AT LEAST 0.8MM TALL.
6. THE MXM CONNECTOR IS ALSO CAPABLE FOR SMARC MODULE APPLICATION ,PLEASE REFER TO SMARC SPECIFICATION FOR PCB FOOTPRINT&LAYOUT

DATE CODE INFORMATION

PRODUCT NUMBER CODE

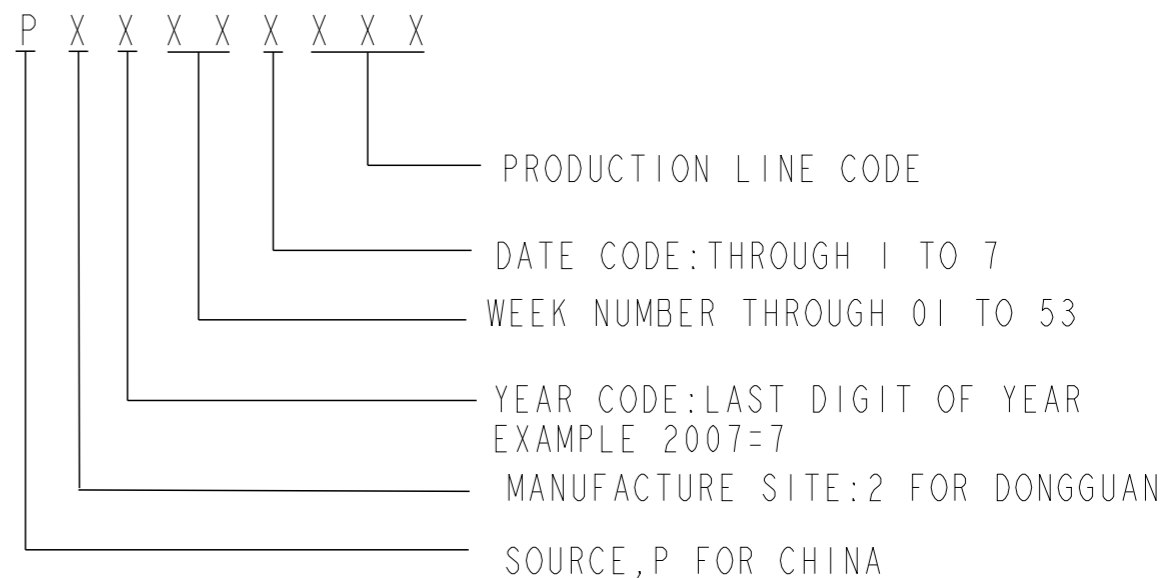
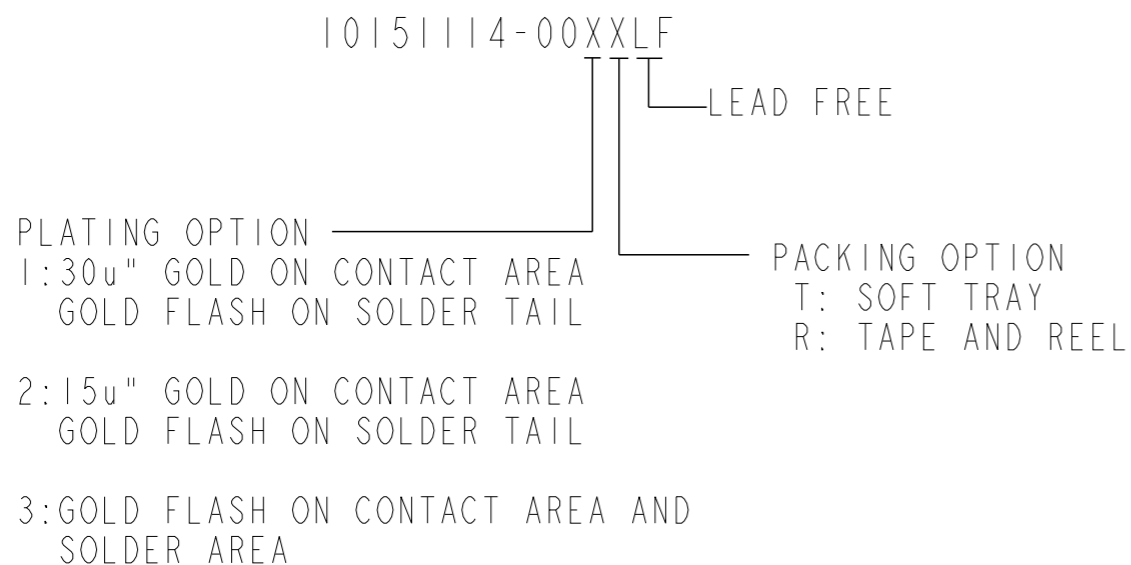

spec ref	-	dr	Zhen-Hua Liu	2020/10/16	projection	mm	size	A3	scale	1:1	
tolerance std	ISO 406 ISO 1101	eng	Huang, Xi-Chen	2022/12/07		← →	ecn no	ELX-DG-46684-1			
TOLERANCES UNLESS OTHERWISE SPECIFIED		chr	-	-			rel level	Released			
surface	linear	appr	Heaven Cen	2022/12/08	product family	-	dwg no	10151114		rev	B
ISO 1302	angular	Amphenol FCI		cat. no.	-		Product - Customer Drw	sheet 6 of 6			
	0.X ±0.3	MXM 3.0 Connector									
	0.XX ±0.20	RA SMT									
	0.XXX ±0.10										
	0° ±2°										